

— FERRO-CONCRETE CARGO VESSELS. —

— No 99, 100, & 101. —

GENERAL ARRANGEMENT.

PRINCIPAL DIMENSIONS:	LENGTH B.P.	208'-0"
	BREADTH B.P.	32'-0"
	DEPTH B.P.	18'-6"

SCALE 1/8" = 1 FOOT.

COMPASS PLATFORM.

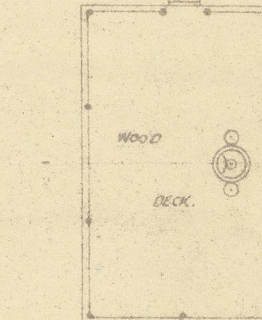

FLYING BRIDGE.

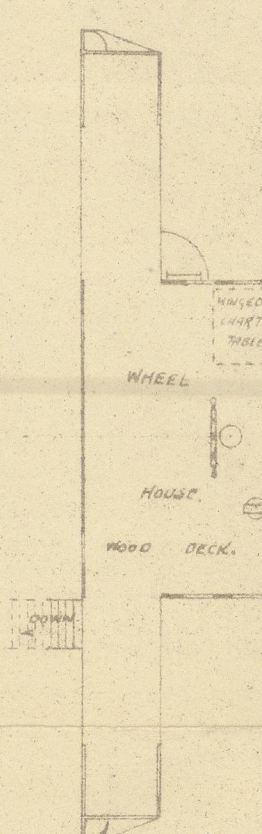

PILOT DECK.

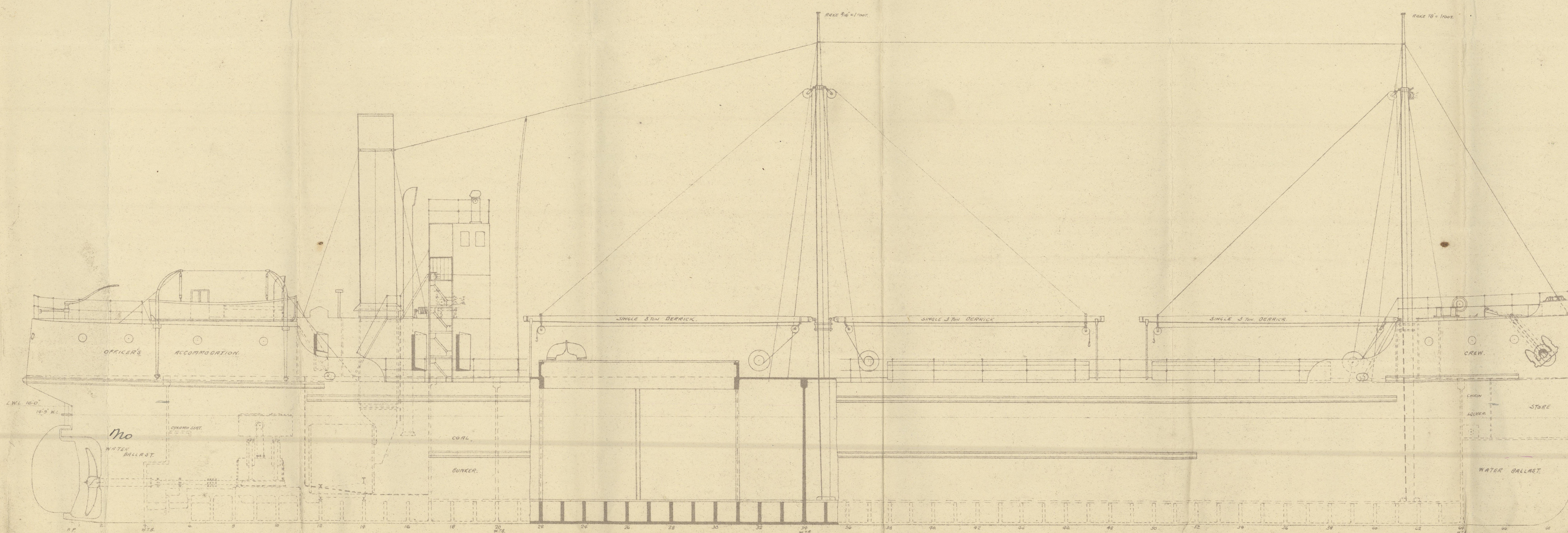
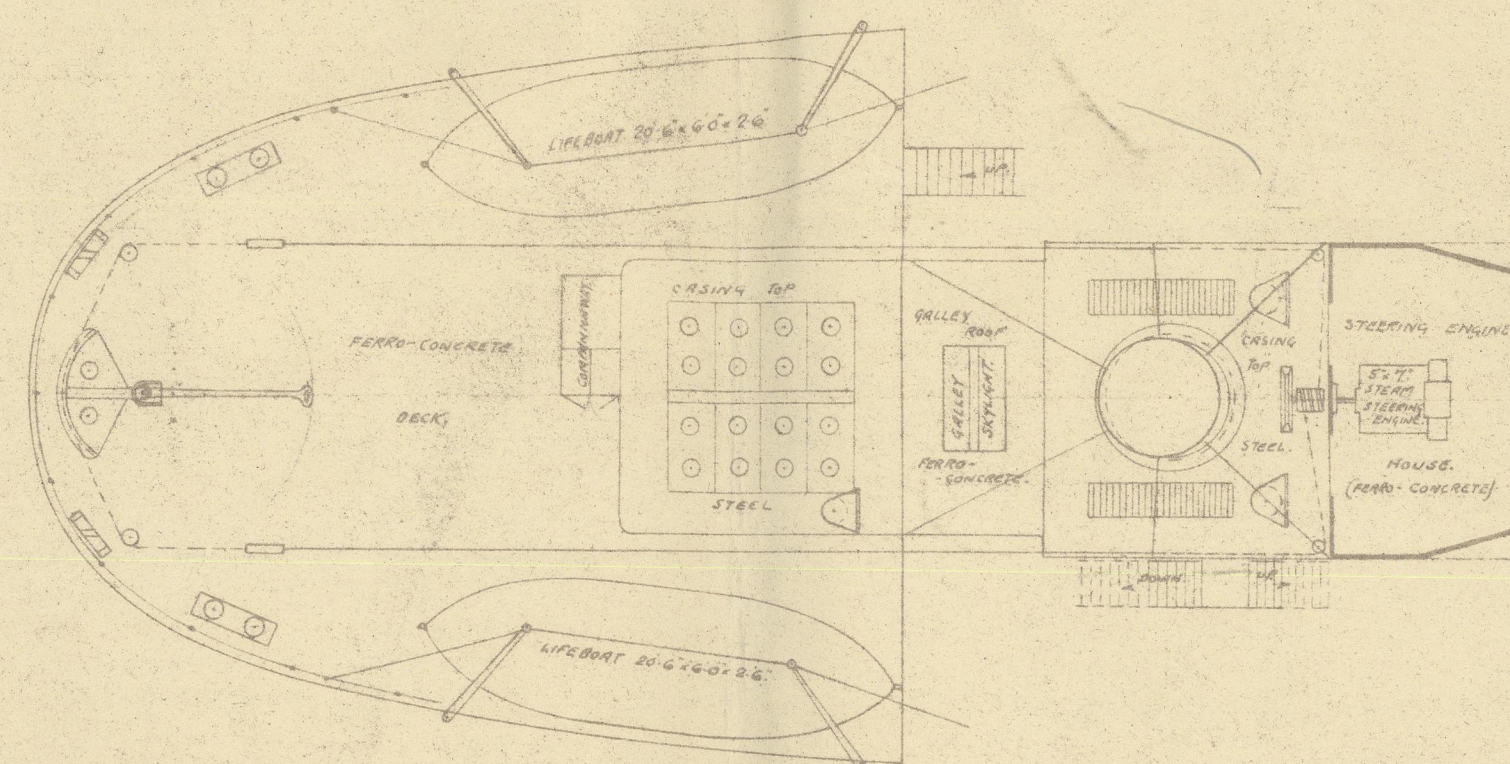

MIDSHIP SECTION  
SCALE 1/8" = 1 FOOT.

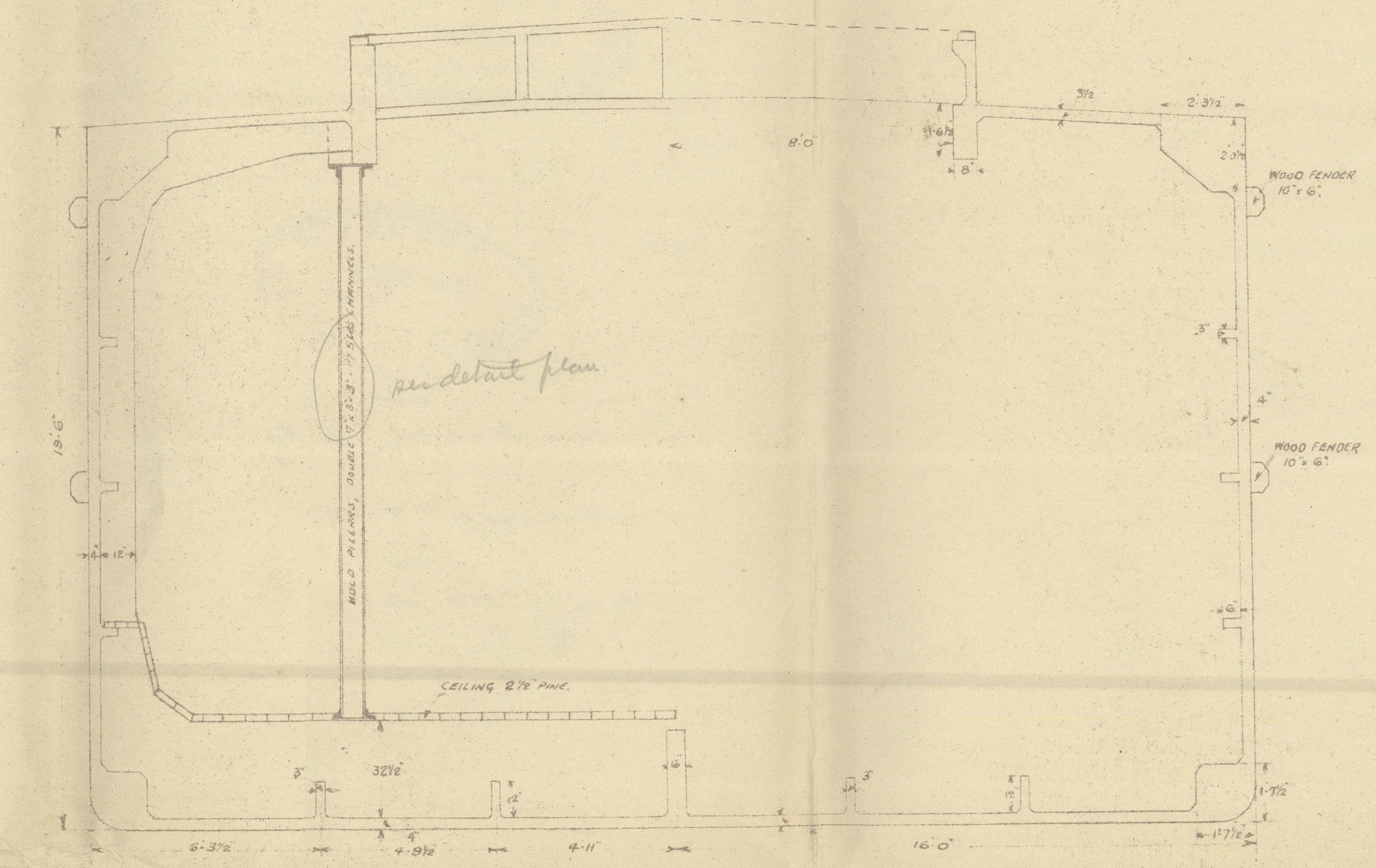

FORECASTLE DECK.

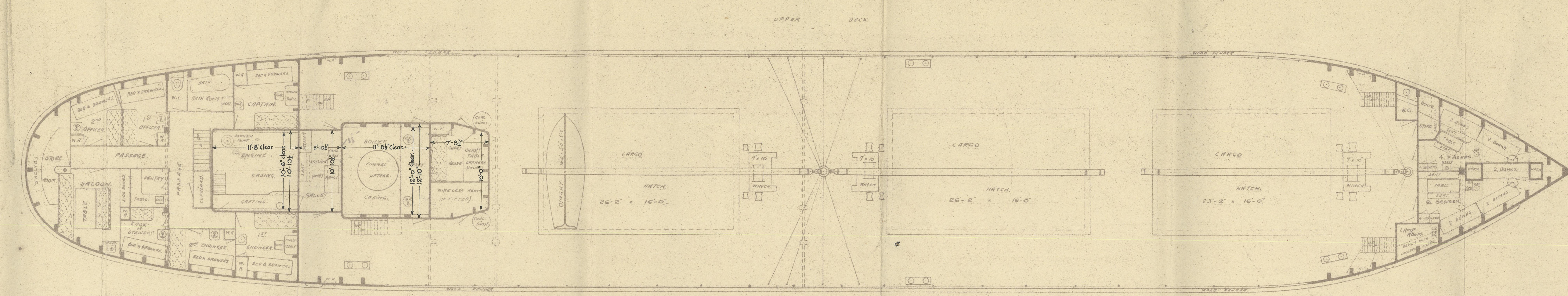
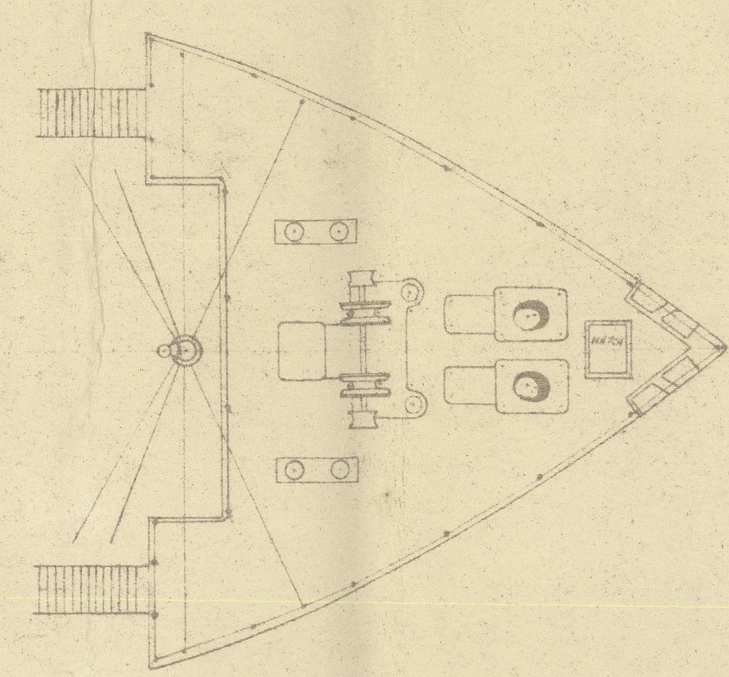

HOLD PLAN.

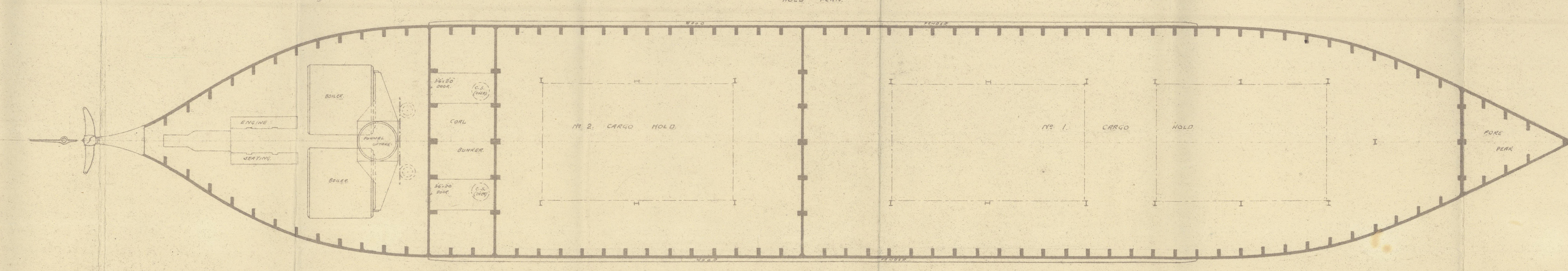

FERRO-CONCRETE SHIP  
CONSTRUCTION CO. LTD.  
Reg. No. 100,970  
Date 11th JULY 1913  
WORKS  
BARROW-IN-FURNESS.

FERRO-CONCRETE SHIP  
CONSTRUCTION CO. LTD.  
YICKERS HOUSE  
BROADWAY, WESTMINSTER, S.W. 1  
11 JUL 13  
WORKS  
BARROW-IN-FURNESS  
CONSTRUCTION COMPANY LIMITED

Plan No 148.

© 2020

Lloyd's Register  
Foundation



(26)

Ferro-concrete. S. L. C. & L?

No. 99. (S.S. "Amisbee")

Cargo. Steamer.

Profile & General arrangement.

