

N<sup>os</sup> 4 & 5.  
OIL FUEL BARGES.

LENGTH	OVERALL	166-3 $\frac{3}{4}$ " X
"	OVER END PLATING	165-3 $\frac{3}{4}$ " X
BREADTH	OVERALL	38-8 $\frac{1}{2}$ "
"	MOULDED	37-8 $\frac{1}{2}$ "
DEPTH	AT CENTRE	8-10 $\frac{1}{2}$ "
"	MOULDED	8-6 $\frac{1}{2}$ "
DRAFT	LOADED	7-7 $\frac{1}{2}$ " AT 1055 TONS (125" FAHR)
RISE OF FLOOR 2"	BEAM CROP 2"	
LENGTH OF EACH OIL COMPART		60-11 $\frac{1}{2}$ " X
TRANSVERSES	SPACED APART	12-0 $\frac{3}{8}$ " X

Class  $\Delta^{\frac{3}{2}}_A$  A - Marge. Carrying Petroleum in bulk  
for Price Service at Tampico

SCALE  $\frac{1}{2}$ " = ONE FOOT.

FRONT ELEVATION OF TRANSVERSES. (12'-0 $\frac{3}{8}$ " APART)

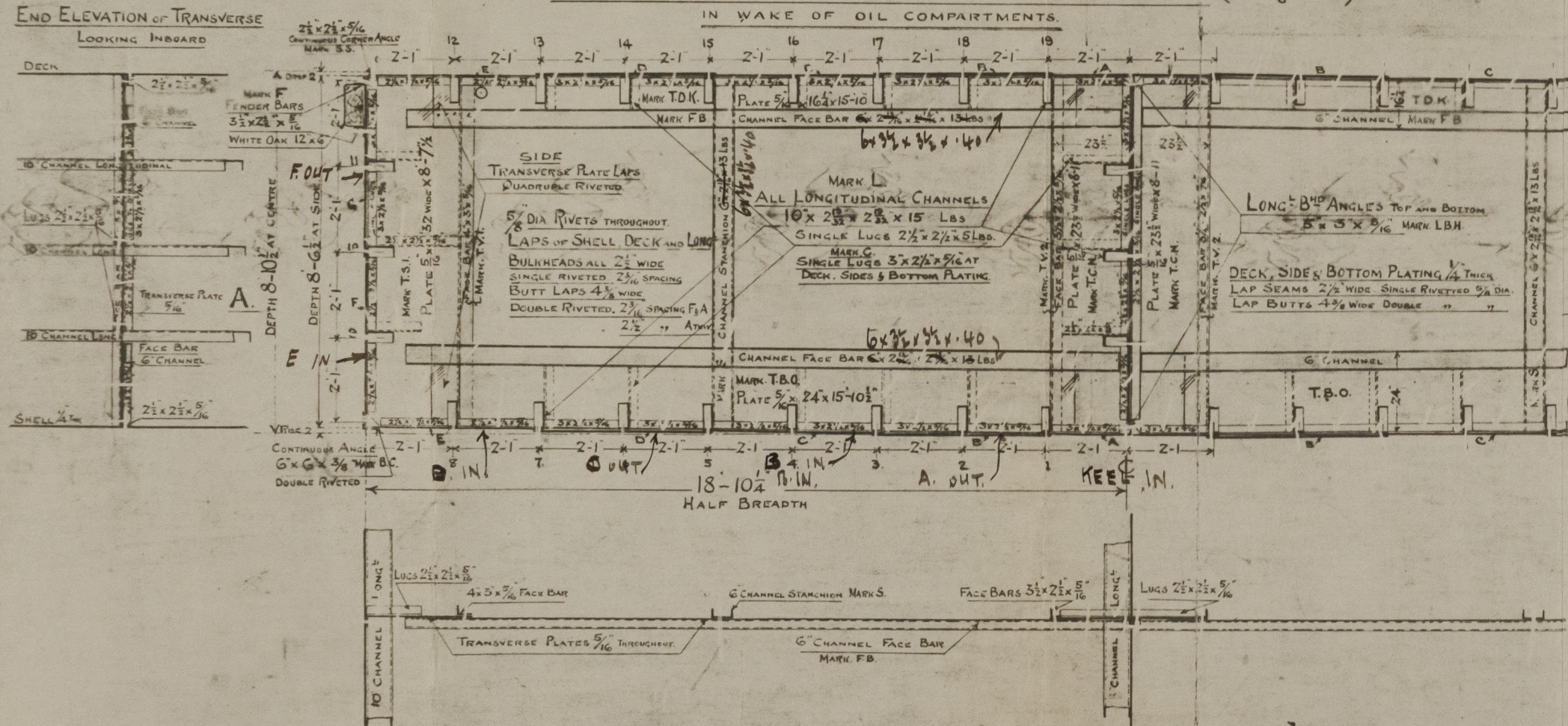

SECTIONAL VIEW THROUGH A-A.

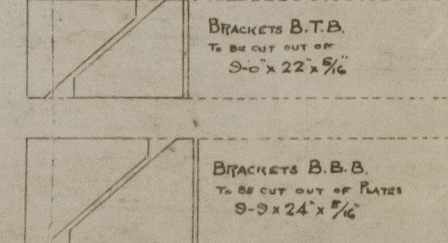
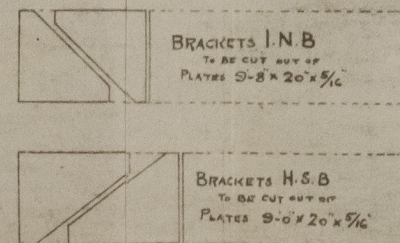

SECTIONAL VIEW THROUGH B-B



SECTION THROUGH BULKHEAD.

SECTION THROUGH END B<sub>2</sub>  
SHOWING BOTTOM BRACKETS.

ough B-B

LOYD'S REGISTER OF SHIPBUILDING

NEW YORK

14 BATTERY PLACE

Approved

9/6/12

TANK-SHIPBUILDING CORP.

NEWBURGH

July 14<sup>th</sup> 1916

Lloyds Register

Foundation

W1253 - 0157



Laur Shipbuilding Corporation  
Nº. 4

Midship Section + Bulkheads.

"NAVE GADORA Nº 75"

New York Rpt. No. 139/5

Amended copy approved plan

RETAIN

W1233 - 0157



© 2020

Lloyd's Register  
Foundation