

PLAN AT "XX"

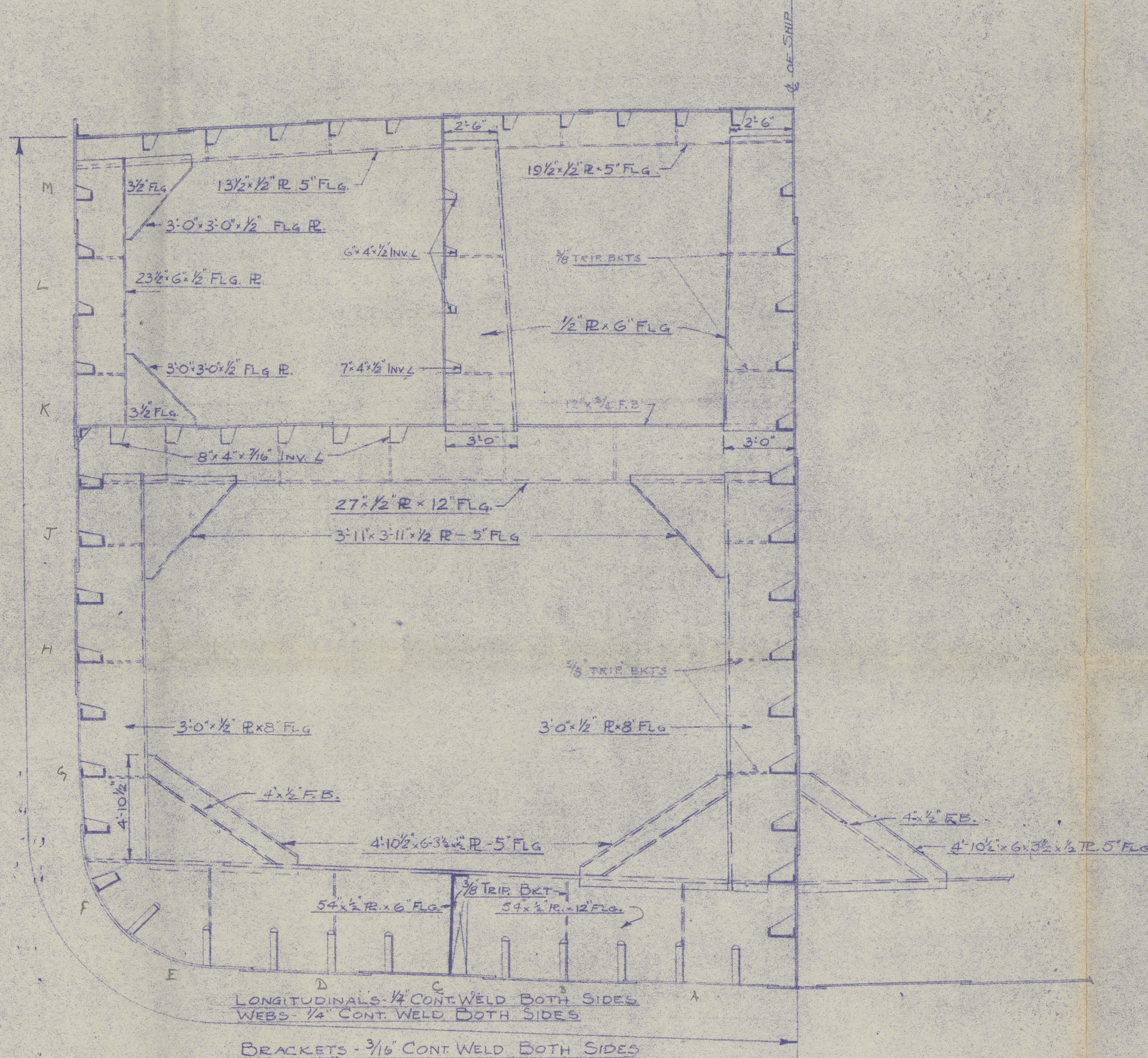

TRANSVERSE No 51
LOOKING AFT

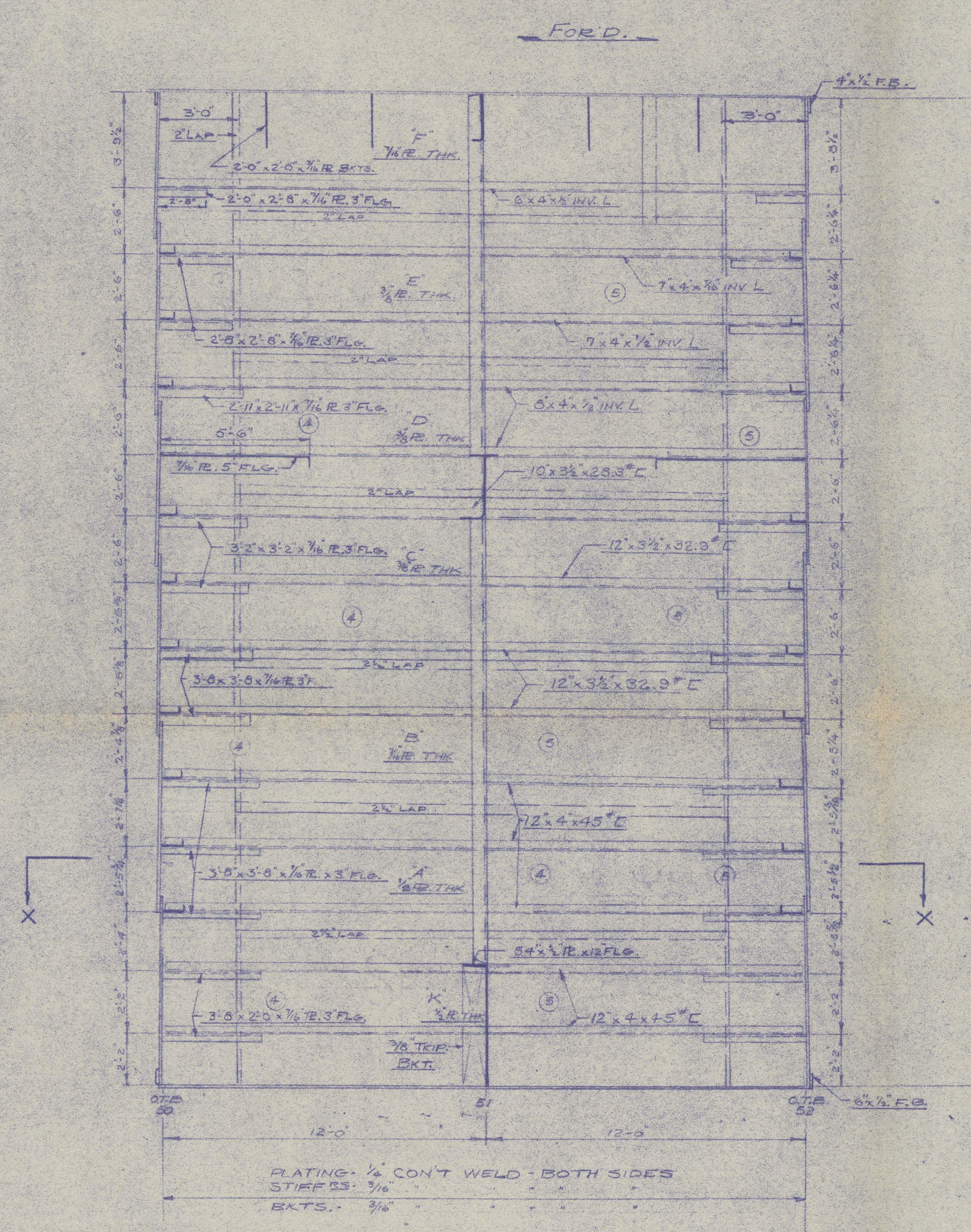

CENTER LINE BULKHEAD



OIL TIGHT BULKHEAD No 52
LOOKING FORWARD

RETAIN

NOTES:
ALL WELDED CONSTRUCTION.

Fort Concord.
JUL 5-7-58
The electric welding must be done with an approved electrode, and the requirements of the Society's RULES FOR THE APPLICATION OF THE ELECTRIC ARC WELDING FOR SHIP CONSTRUCTION must be carried out.



RETAIN

BETHLEHEM STEEL COMPANY INCORPORATED			
SHIPBUILDING DIVISION - BROOKLYN 56TH ST. YARD			
3/8 TOORAK			
SCALE: 1/4" = 1'-0"	CARGO TANK No 7		
MATERIAL	SCANTLINGS		
STYLE			
DRAWN BY	TRACED BY	CHECKED BY	APPROVED BY
H. HOSTEUP		T. J. W.	
6-10-42		6-15-42	

T-242