

7 AUG 1940

**NUMERALS**

"D" FOR NUMERALS = 35.37; FOR PROPORTIONS = 35.87.

D = 35.37  
L = 400

14148 = FIRST N°  
88.66  
400  
35464 = SECOND N°

$\frac{L}{D} = \frac{400}{35.37} = 11.15.$   
 $\frac{L}{D} = \frac{400}{35.87} = 11.15.$

**EQUIPMENT N° 35.995** (LETTER "Z")

3 BOWER ANCHORS (STOCKLESS) 17 1/2 CWTs (EX STOCK)  
225 FMS 2 1/4" STUD LINK CHAIN CABLE  
90 FMS 4 3/4" STEEL WIRE STREAM (1/2 FSWR)  
120 FMS 5" " " TOWLINE (1/2 FSWR)  
HAWERS & WARPS { 2 @ 30 FMS 2 1/2" " " " (1/2 FSWR)  
2 @ 90 FMS 2 1/2" " " " (1/2 FSWR)

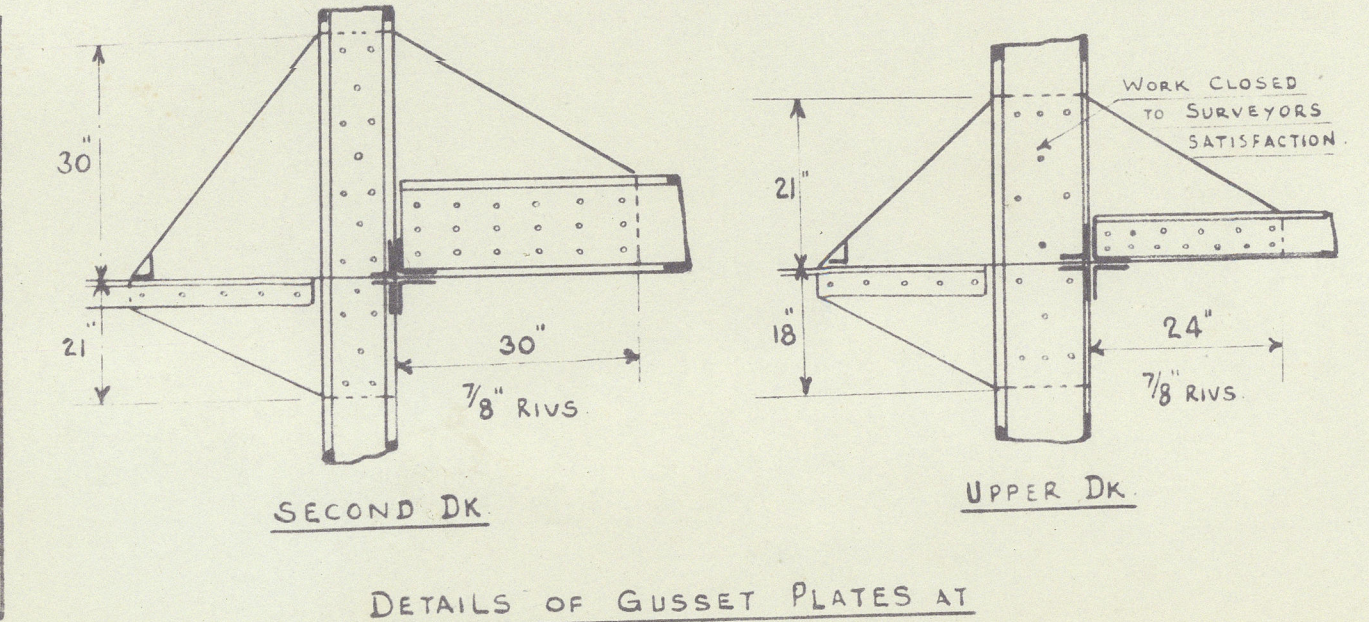
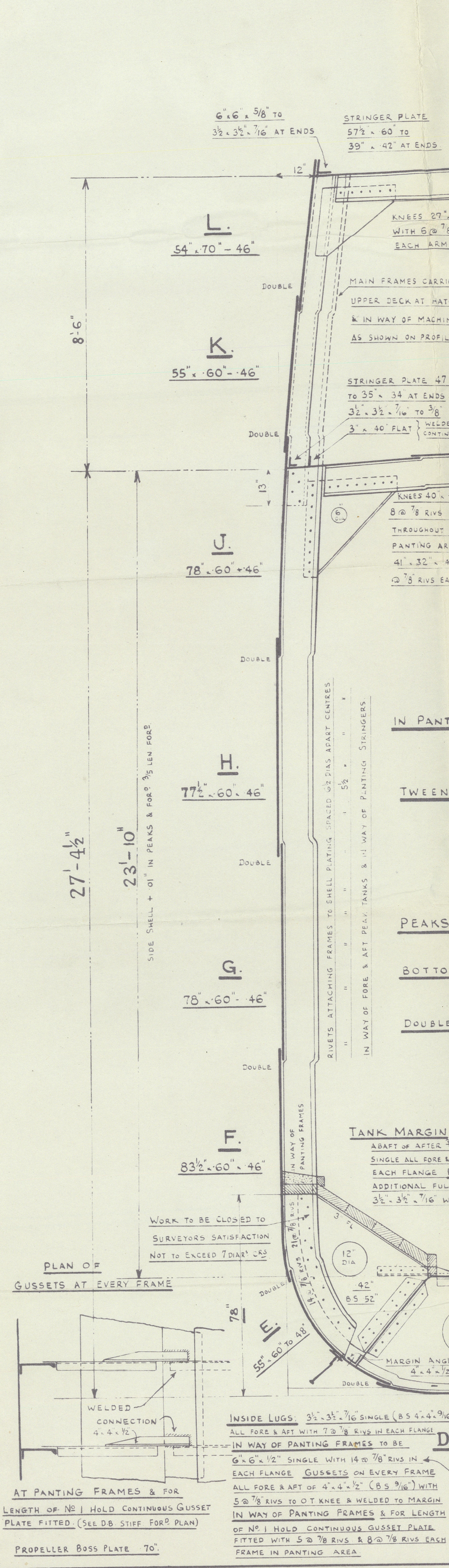

DETAILS OF GUSSET PLATES AT  
UPPER & 2ND DK. HATCH CORNERS.

**N° 524**

**MIDSHIP SECTION.**

DIMENSIONS AS PER RULE.

LENGTH B.P. 400.00'  
BREADTH MLD. 53.29'  
DEPTH MLD. 35.87'

CLASS + 100 A.I. WITH FREEBOARD

SCALE 1/2" = 1 FOOT.

JOHN READHEAD & SONS LTD  
SHIPBUILDERS, ENGINEERS, &c.  
SOUTH SHIELDS

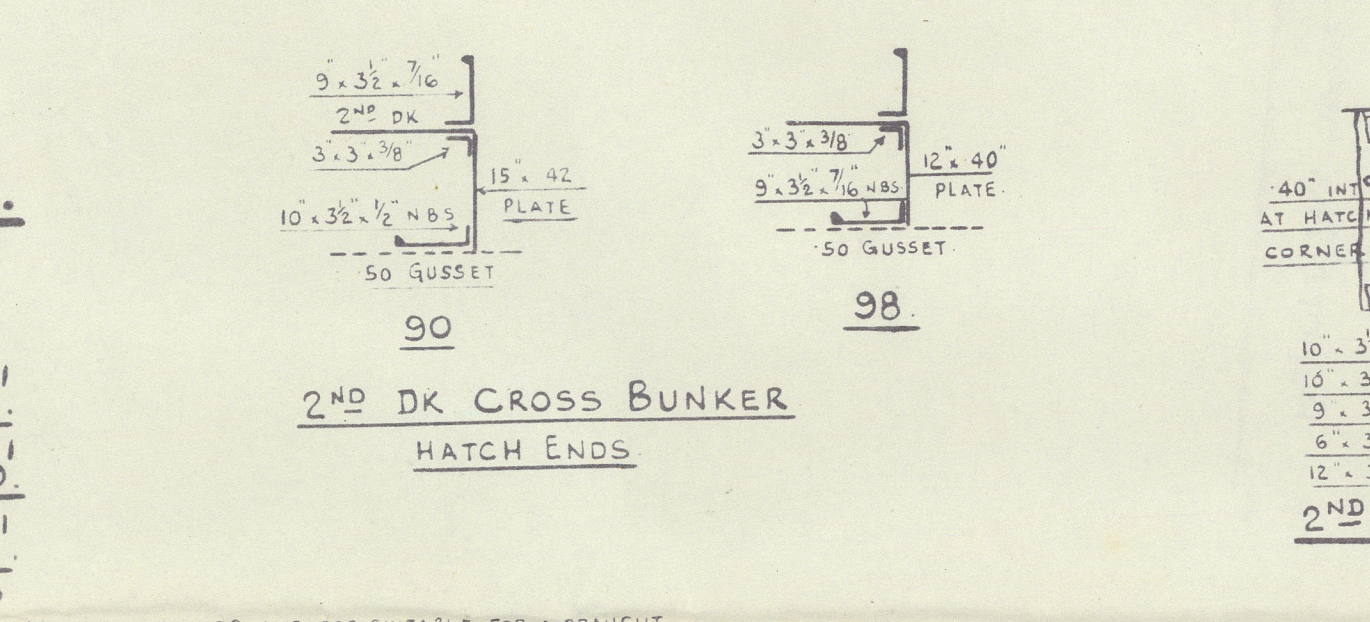

WITH SCANTLING AMENDED SUITABLE FOR A BRIGHT  
OF 10" IN EXCESS OF THAT CORRESPONDING TO THE  
FREEBOARD WHICH COULD BE ASSIGNED TO THE VESSEL  
WITH A TONNAGE OPENING.

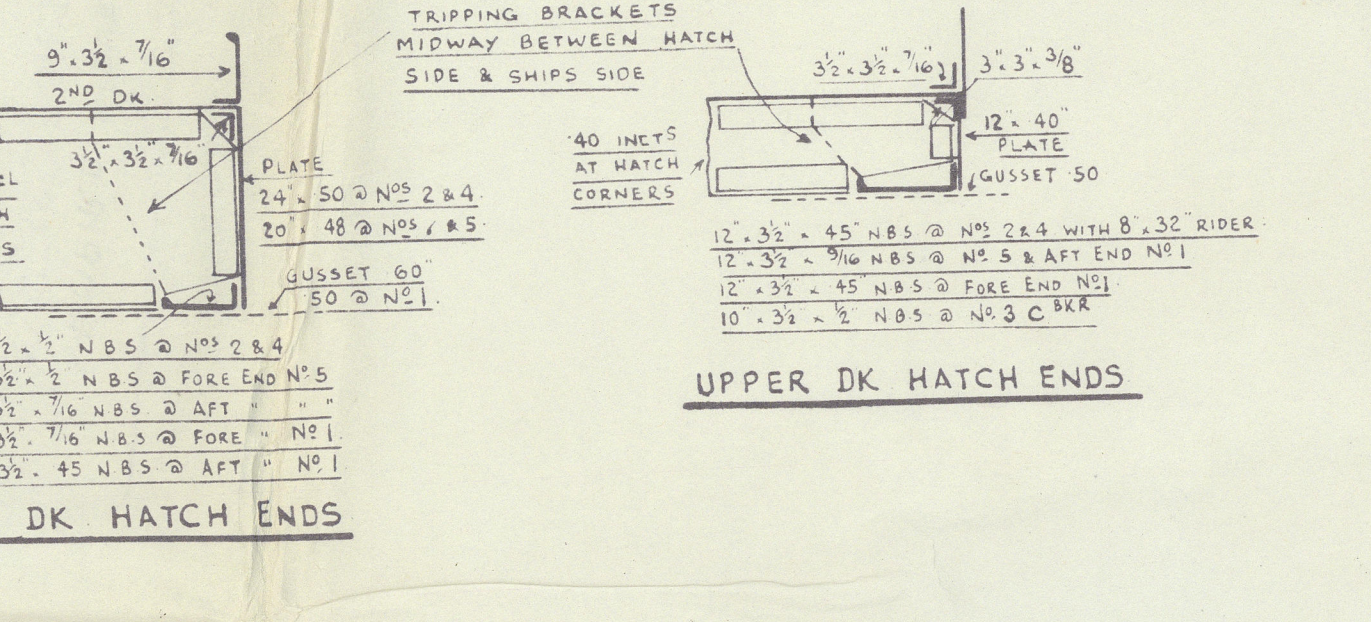

UPPER DK. HATCH ENDS

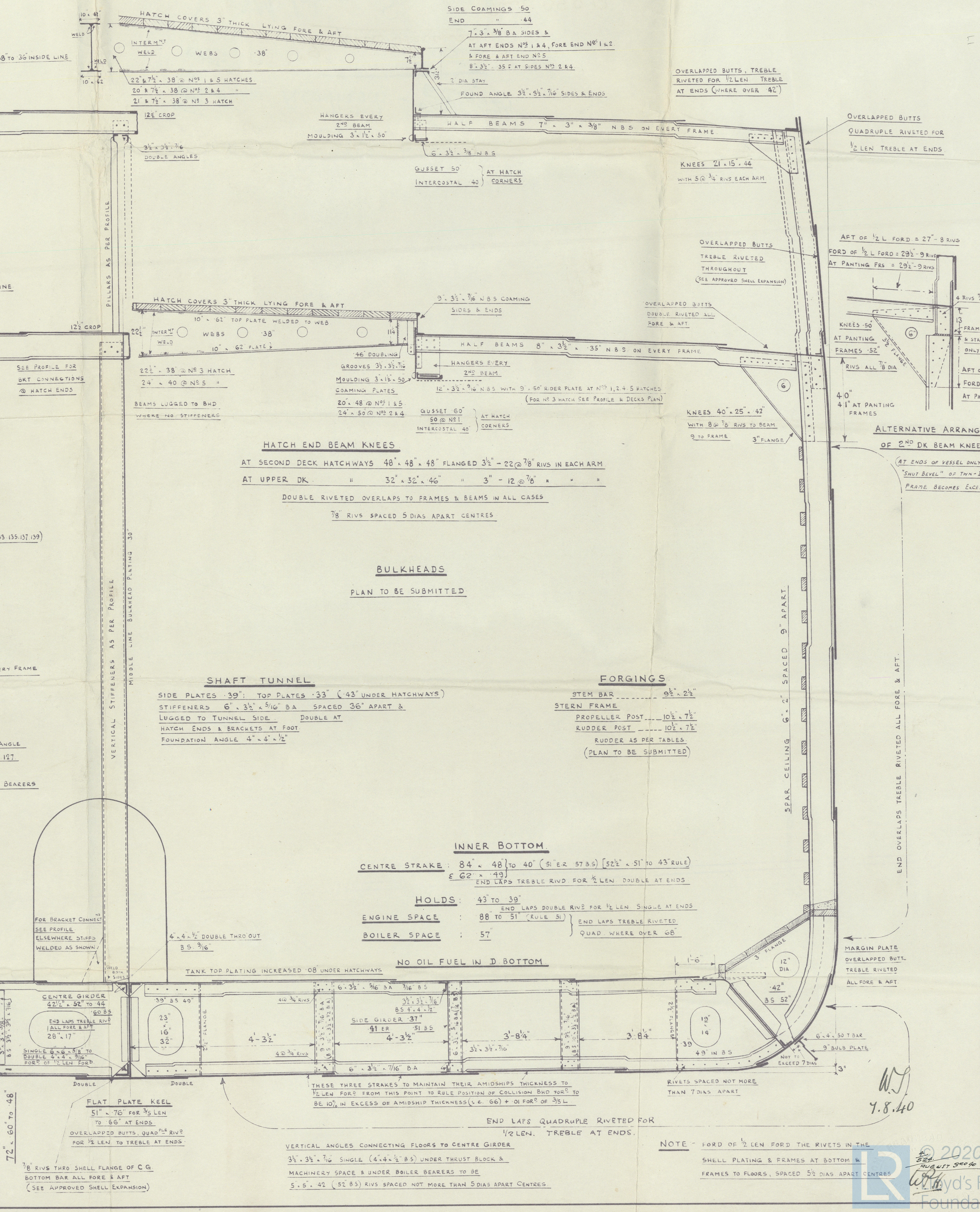

7.8.40

W181-0100



W1181-0100

John Readheads - No 524.

"Empire Stevenson"

Midship Section 9mc 99912.

24

EMPIRE STEVENSON.  
NEWCASTLE ON TYNE  
Report No. 99912.



© 2020

Lloyd's Register  
Foundation