

28/5/24

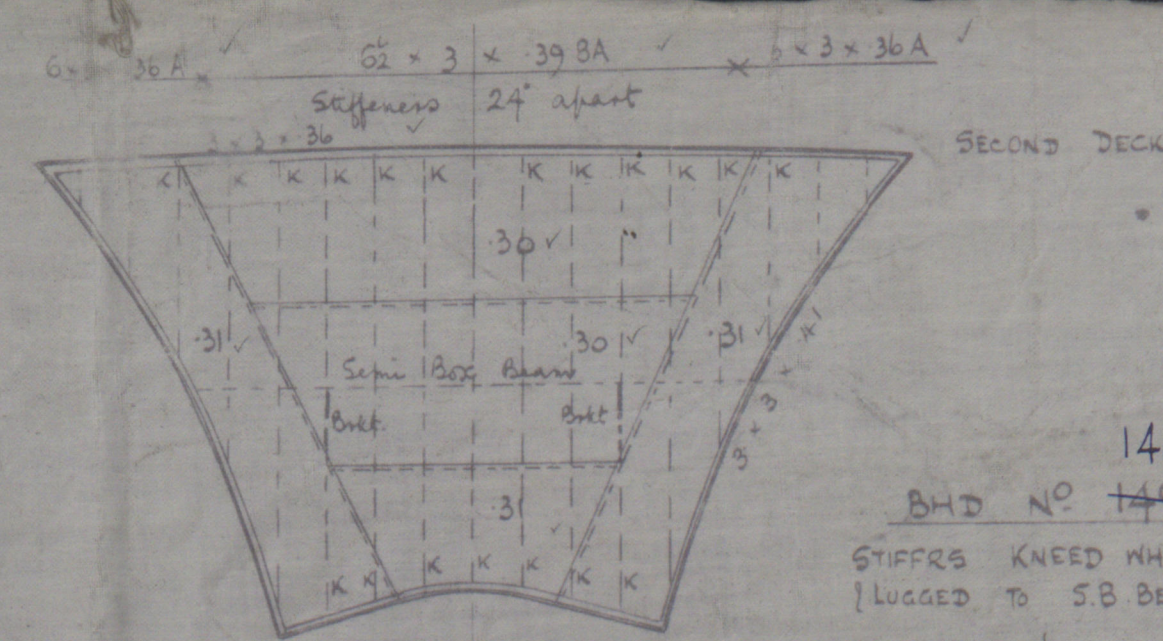

BHD No 145
STOWED KEEL WHERE MARKED K.
LUGGED TO SB BEAM.
Tied to 8 above Crown of Tank.

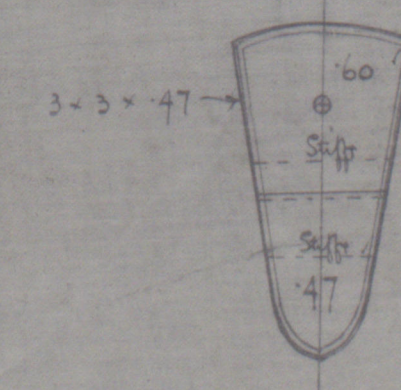

BHD No 155
STOWED KEEL WHERE MARKED K.
LUGGED TO SB BEAM.
Tied to 8 above Crown of Tank.

PROFILE & DECK PLANS. NO. 224 SHIP. 225

400'-0" x 52'-9" x 27'-10"

SCALE 1/8" = 1 FOOT.

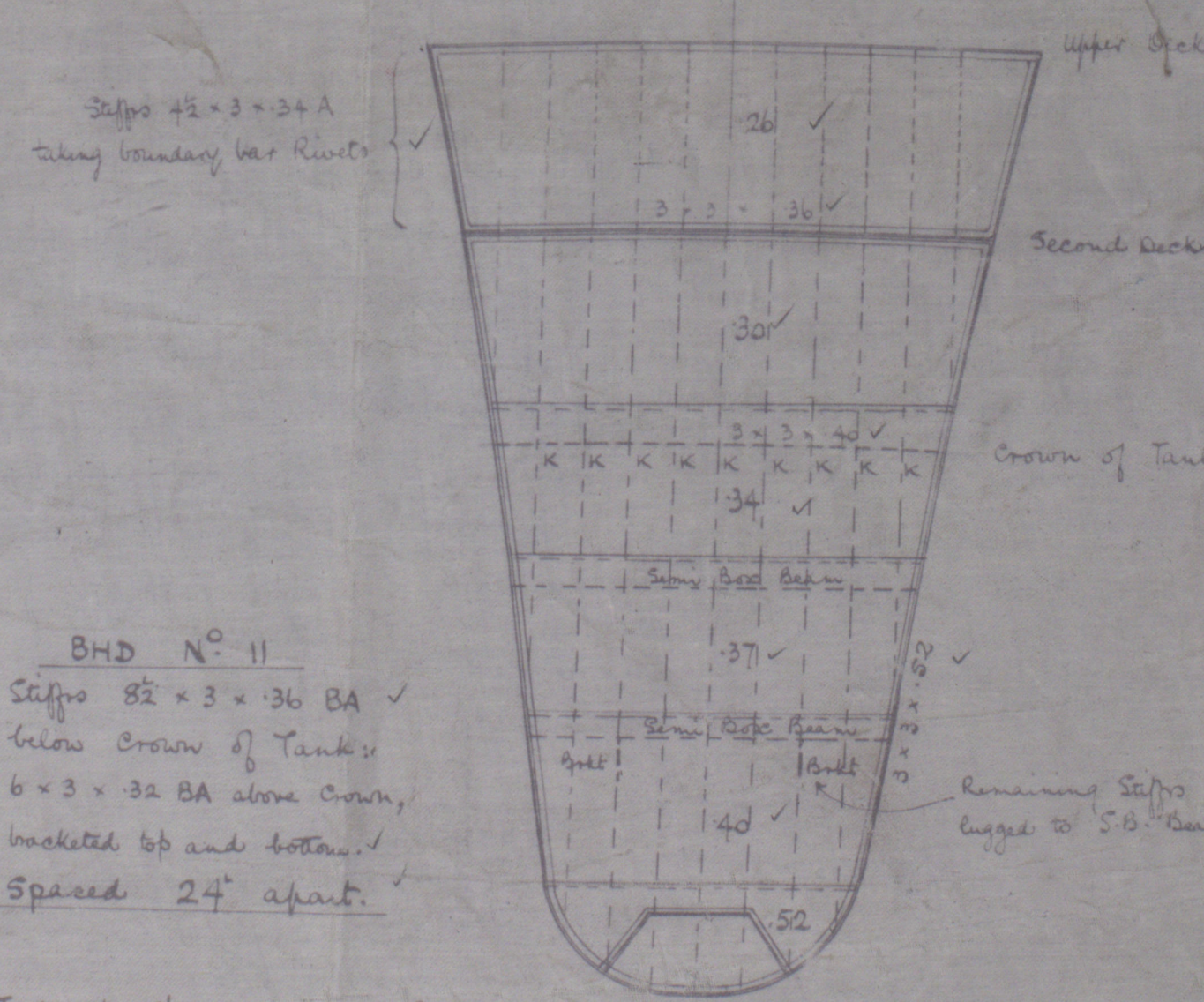

BHD No 11
STOWED KEEL WHERE MARKED K.
LUGGED TO SB BEAM.
Tied to 14 above Crown of Tank.




WILLIAM DOBSON & Co
SHIPBUILDERS
DATE 26/5/24
NEWCASTLE ON TYNE

Messrs Wm Dobson & Co.

N^o 224 & 225

Profile & Deck Plan

N^o 2

West Walls

NEWCASTLE ON TYNE

Report No. 79027

S.S. East Walls.

NEWCASTLE ON TYNE.

Report No. 79668.

RETAIN



© 2020

Lloyd's Register
Foundation