

Lloyd's Register of Shipping.

SURVEYS FOR FREEBOARD.

(CONDITIONS OF ASSIGNMENT.)

Ship's Name "ONOMEA" Port of Survey Baltimore, Maryland
 Official Number - 168052 Surveyor's Signature J. Buchanan
 Nationality and Port of Registry British - Date of Survey 29th & 30th August, 1940

Disposition and dimensions of superstructures, trunks, deckhouses and machinery casings to be inserted in the diagrams and tabular statement: -

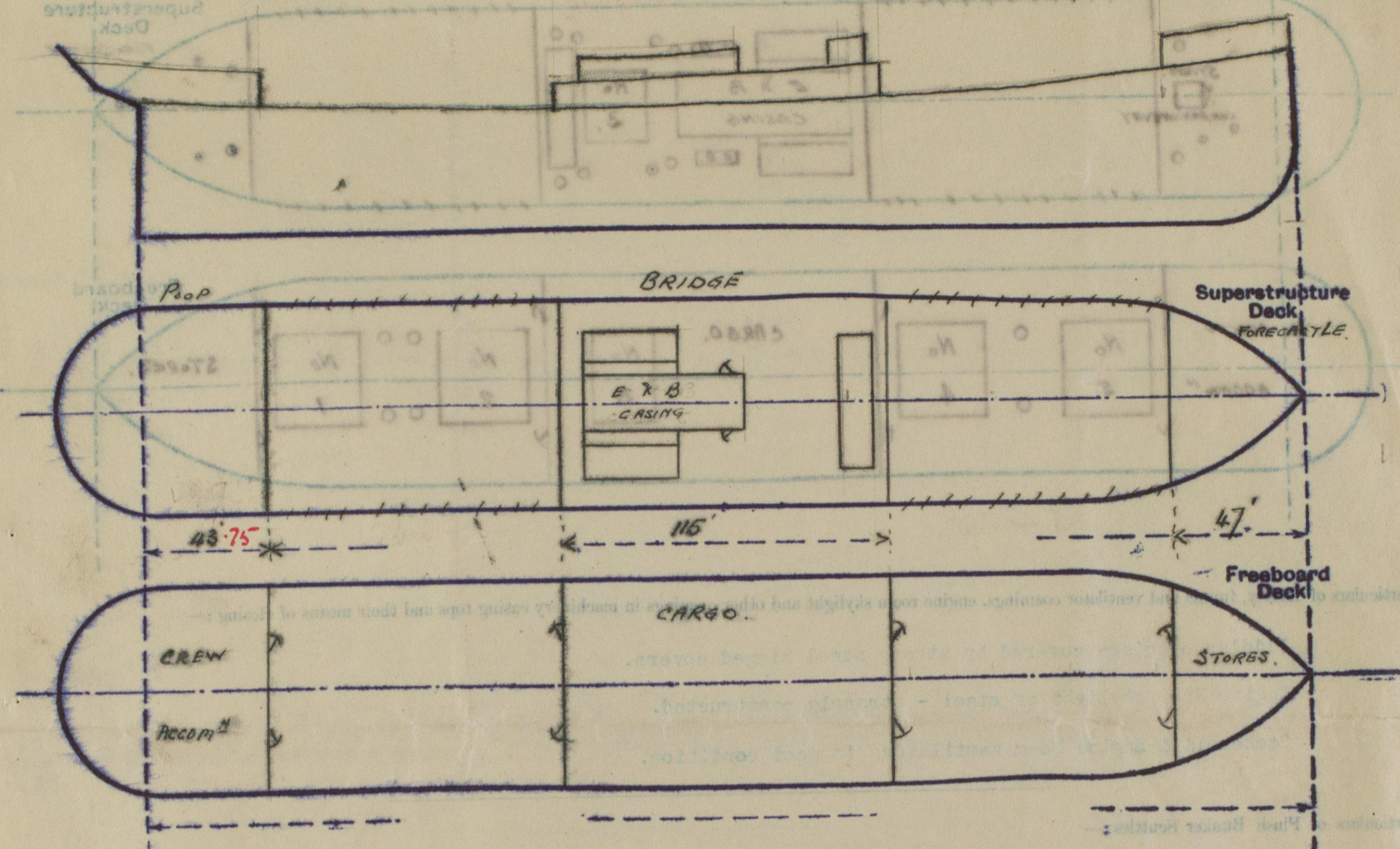

Particulars of Superstructures, Trunks, Casings, Deckhouses.

	Coaming	Plating	Stiffeners	Spacing	End Attachments of Stiffeners	Size of Openings	Height of Sills	Height of Casings
Poop Bulkhead46 ✓	.44	5 x 3½ x .40	31 ✓	None	1 (p.&s.) 5'6" x 2'6"	18 ✓	8'-0" ✓
Raised Quarter Deck Bulkhead ...	-	-	-	-	-	1 (p.&s.)	-	-
Bridge, After Bulkhead40 ✓	.40 ✓	3½ x 3 x .42	30 ✓	None	4'8" x 2'0"	19 ✓	8'-6" ✓
Bridge, Forward Bulkhead46	.40 ✓	10 x 3½ x 3½ x .52 ✓	30	Lugs top and bottom	1 (p.&s.) 6'0" x 4'3"	14 ✓	8'-6" ✓
Forecastle Bulkhead40	.31 ✓	4 x 3 x .40 ✓	28 ✓	None	1 (p.&s.) 5'6" x 2'6"	18 ✓	8'-0" ✓
Trunk, Aft	-	-	-	-	-	-	-	-
Trunk, Forward	-	-	-	-	-	-	-	-
Exposed Machinery Casings on Freeboard or Raised Quarter Decks ...	-	-	-	-	-	-	-	-
Exposed Machinery Casings on Superstructure Decks34 ✓	.32	3½ x 3 x .38 ✓	27 ✓	None at top extends below	1 (p.&s.) 5' x 2'	15 ✓	8'-6"
Machinery Casings within Superstructures not fitted with Class I Closing Appliances	-	-	-	-	-	-	-	-
Deckhouses on Flush Deck Ships ...	-	-	-	-	-	-	-	-

Particulars of Closing Appliances (state if capable of being manipulated from both sides).

Poop Bulkhead	2 Steel Hinged watertight doors - Manipulated from both sides. ✓
Raised Quarter Deck Bulkhead ...	- - -
Bridge, After Bulkhead	2 Steel Hinged watertight doors - Manipulated from both sides. ✓
Bridge, Forward Bulkhead	2 Steel Hinged watertight doors - Screw dogs from outside only. ✓
Forecastle Bulkhead	2 Steel Hinged doors - Manipulated from both sides ✓
Exposed Machinery Casings on Freeboard or Raised Quarter Decks ...	- - -
Exposed Machinery Casings on Superstructure Decks	- - -
Machinery Casings within Superstructures not fitted with Class I Closing Appliances	Steel Hinged doors - Manipulated from both sides. ✓
Deckhouses on Flush Deck Ships ...	- - -

PARTICULARS OF PROTECTION TO OPENINGS, ETC.

The following diagrams should be used to indicate the positions of cargo and coaling hatchways, gangway, cargo and coaling ports, ventilators, companionways, etc., which would affect the seaworthiness of the ship:—

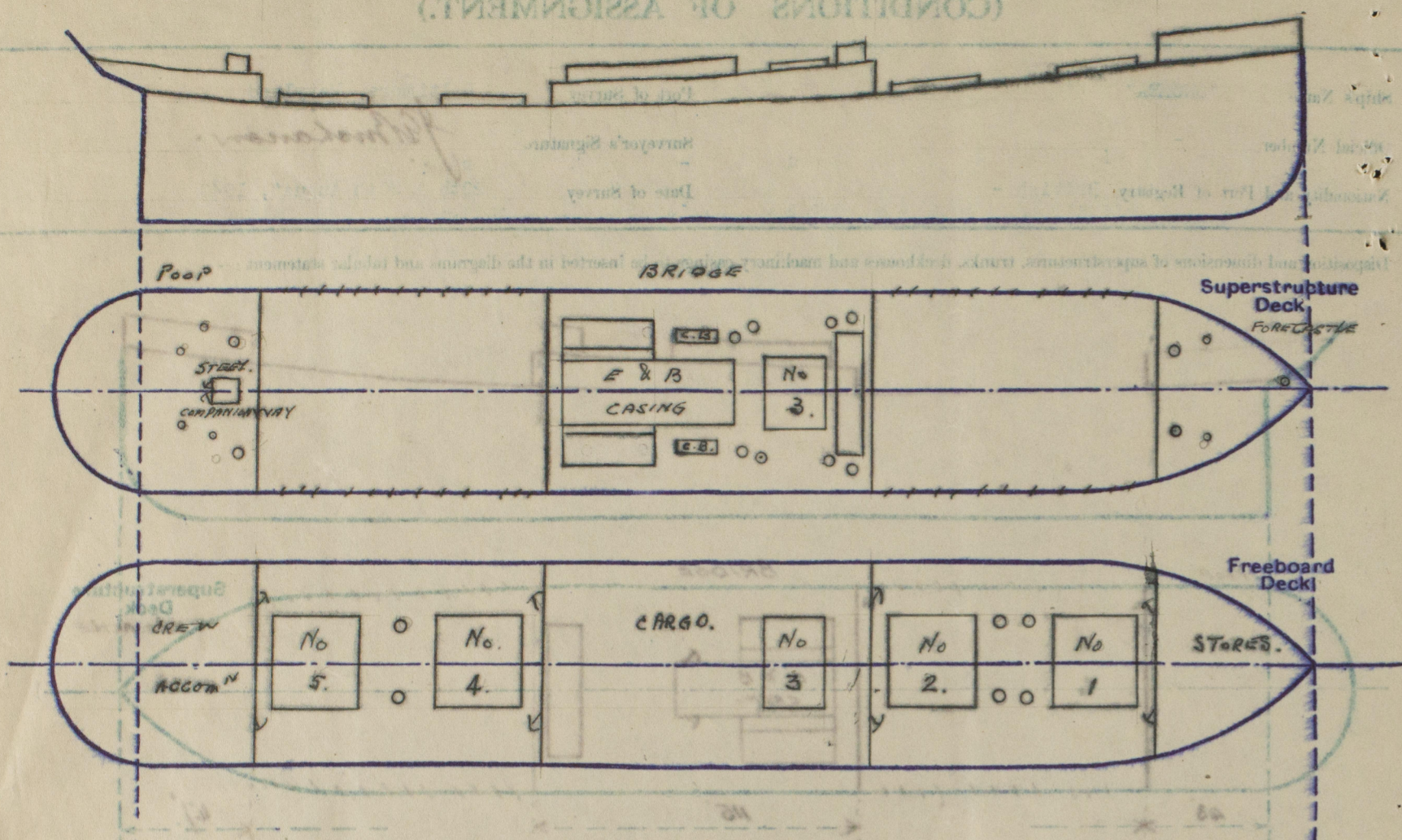

Particulars of fiddle, funnel and ventilator coamings, engine room skylight and other openings in machinery casing tops and their means of closing:—

- Fiddle openings covered by strong steel hinged covers. ✓
- Engine room skylight of steel - strongly constructed. ✓
- Stokehold & Engine Room ventilators in good condition. ✓

Particulars of Plush Bunker Scuttles:—

NONE ✓

Particulars of Companionways:—

- One on Poop Deck leading to Crews' Accommodations. ✓
- Constructed of steel with hinged hardwood door. ✓
- Door sill 20" - Door manipulated from both sides. ✓

Particulars of Ventilators in exposed positions on freeboard and superstructure decks:—

- On Poop - 2 @ 17" dia.- coaming 30" x .44 ✓
4 @ 9" dia.- " 30" x .36 ✓
4 @ 8" dia.- mushroom with screw tops ✓
- On Bridge - 8 @ 20" dia.- coaming 30" x .44 ✓
- On Forecastle - 2 @ 18" dia.- " 36" x .44 ✓
2 @ 9" dia.- " 36" x .36 ✓
1 @ 12" dia.- " 36" x .36 ✓
- After well deck - 2 @ 20" dia.- " 48" x .44 ✓
- Fore well deck - 4 @ 21" dia.- " 48" x .44 ✓

All coamings fitted with wood plugs and canvas covers. ✓

Particulars of Air Pipes in exposed positions on freeboard, raised quarter, or superstructure decks:—

- On Poop - 2 @ 3 1/2" dia. - 20" high ✓
- On Bridge - 4 @ 5" " - 16" " ✓
- On Forecastle - 3 @ 3 1/2" " - 20" " ✓
- After well deck - 2 @ 3 1/2" " (alongside mast) - 6 ft. high
- Fore well deck - 2 @ 3 1/2" " (") - 6 ft. "
- 2 @ 3 1/2" " (at Bridge front) - 6 ft. "

Open ends of air pipes closed with wood ball floats.

Empire Leopard.

PARTICULARS OF PROTECTION TO OPENINGS, ETC.

Particulars of Scuppers and Sanitary Discharge Pipes:—

- Scuppers in well decks - 4" dia. pipe from stringer through sheerstrake. ✓
- Sanitary discharge pipes have flap valves at ship's side and traps at inner end. ✓

Particulars of Side Scuttles:—

- All side scuttles fitted with hinged deadlights and strongly constructed. ✓

Vertical distance of Sill of lowest Side Scuttle above top of keel. There are no side scuttles below upper (freeboard) deck. ✓

Particulars of Guard Rails:—

- On Poop, Bridge and Forecastle decks
- 3 tier rails 3' - 7" high, stanchions spaced about 4' - 6" apart. ✓

Particulars of Gangways, Lifelines, etc.:—

Provision made for fitting lifelines in wells. ✓

Particulars of Freeing Arrangements.

	Length of Bulwark	Height of Bulwark	Size of Freeing Ports	Number each side	Area each side	Rule area each side
After Well ...	103.54	3.75	39" x 19" oval	5	24.4 ft ²	20.7 ft ²
Forward Well ...	101.42	3.75	39" x 19" oval	5	24.4 ft ²	20.3 ft ²

State position of each freeing port ... (After Well:—From Bridge Bhd. - 15', 33', 52', 73', 91' - 14" above deck.
(F. and A. position and height above deck edge) (Forward Well:— " " - 10', 31', 51', 69', 86' - 14" " ")

State whether the freeing ports are fitted with shutters, bars, or rails, and give particulars of such:— 2 horizontal bars on each. ✓

Additional area where sheer is less than standard.

PARTICULARS OF PROTECTION TO OPENINGS, ETC.

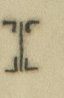
HATCHWAYS ON FREEBOARD AND SUPERSTRUCTURE DECKS.										
	On Freeboard Deck					On Bridge Deck				
Description of Hatchway	No.1	No.2	No.3	No.4	No.5		No.3	Bunker Hatch(p&s)		
Dimensions of Hatchway	29-3x17	31-6x17	15-9x17	29-3x17	27x17		15-9x17	9x2-6		
COAMINGS	Height above Deck ... 36 ✓ Thickness { Sides44 ✓ { Ends44 ✓ Stiffeners ... 7x3 $\frac{1}{2}$ x3 $\frac{1}{2}$ ✓ Brackets, Stays ... 2 ✓	36 ✓ .44 ✓ .44 ✓ channel 3 ✓	10 .44 .44 ✓ None	36 .44 .44 7x3 $\frac{1}{2}$ x3 $\frac{1}{2}$ 2 ✓	36 .44 .44 channel 2 ✓		36 .44 .44 7x3 $\frac{1}{2}$ x3 $\frac{1}{2}$ 1 ✓	24 .48 .40 ✓ -		
HATCH BEAMS	Number ... 5 Spacing ... 4-10 $\frac{1}{2}$ ✓ Scantling and Sketch ... 	6 4-6 ✓ 3 $\frac{1}{2}$ x 3 x .44 14 $\frac{1}{2}$ x .36 ✓ 3 $\frac{1}{2}$ x 3 x .44	3 3-11 $\frac{1}{2}$ ✓ NIL	5 4-10 $\frac{1}{2}$ ✓ 2-3/4	5 4-6 ✓ 2-3/4		3 3-11 $\frac{1}{2}$ ✓ 3 $\frac{1}{2}$ x3x.44 14 $\frac{1}{2}$ x .36 3 $\frac{1}{2}$ x3x.44	- - -		
	Bearing Surface ... 2 <i>Stated by surveyor to be efficient in mean time.</i>	2	2	2-3/4	2-3/4		2	-		
FORE AND AFTERS	Number ... Spacing ... Unsupported Lengths ... Scantling* and Sketch ...		N I L				N I L			
	Bearing Surface ...									
HATCH COVERS	Material ... Thickness ... How fitted ... Bearing Surface ...		Wood 2-3/4 F & A 3 ✓				Wood 2-3/4 F & A 3	✓		
Spacing of Cleats	24 ✓	-	-	24 ✓	-		24	✓		
Number of Tarpaulins	3 ✓	-	-	3 ✓	-		3	✓		
<p>*Are wood fore and afters steel shod at all bearing surfaces? -</p> <p>Are battens and wedges efficient and in good condition? Yes ✓</p> <p>Are tarpaulins in good condition and in accordance with rule requirements? Yes ✓</p> <p>Are lashings provided in accordance with rule requirements? Yes ✓</p> <p><i>Latching bars fitted to No. 1 Hatchway still 11/11.</i></p>										

Particulars of any special features:—

Endorsement at first survey and at surveys for renewal of Certificate:—

The fittings and appliances are in accordance with the particulars shown on this form (or as now modified) and are in good condition.

Particulars of Freeing Arrangements					
Length of Hatchway	Height of Hatchway	Size of Freeing Ports	Number each side	Area each side	Ratio area each side
Forward Well	10' 0"	1' 0" x 1' 0"	2	2' 0"	0.02
Aft Well	10' 0"	1' 0" x 1' 0"	2	2' 0"	0.02
Forward Well	10' 0"	1' 0" x 1' 0"	2	2' 0"	0.02
Aft Well	10' 0"	1' 0" x 1' 0"	2	2' 0"	0.02

Notes:—
1. The area of each freeing port shall be not less than 1 sq. ft. for every 100 sq. ft. of deck area.
2. The height of each freeing port shall be not less than 18 inches.
3. The freeing ports shall be so arranged as to give a clear passage for the escape of water.



© 2020

Lloyd's Register Foundation