

SEZIONE A-A

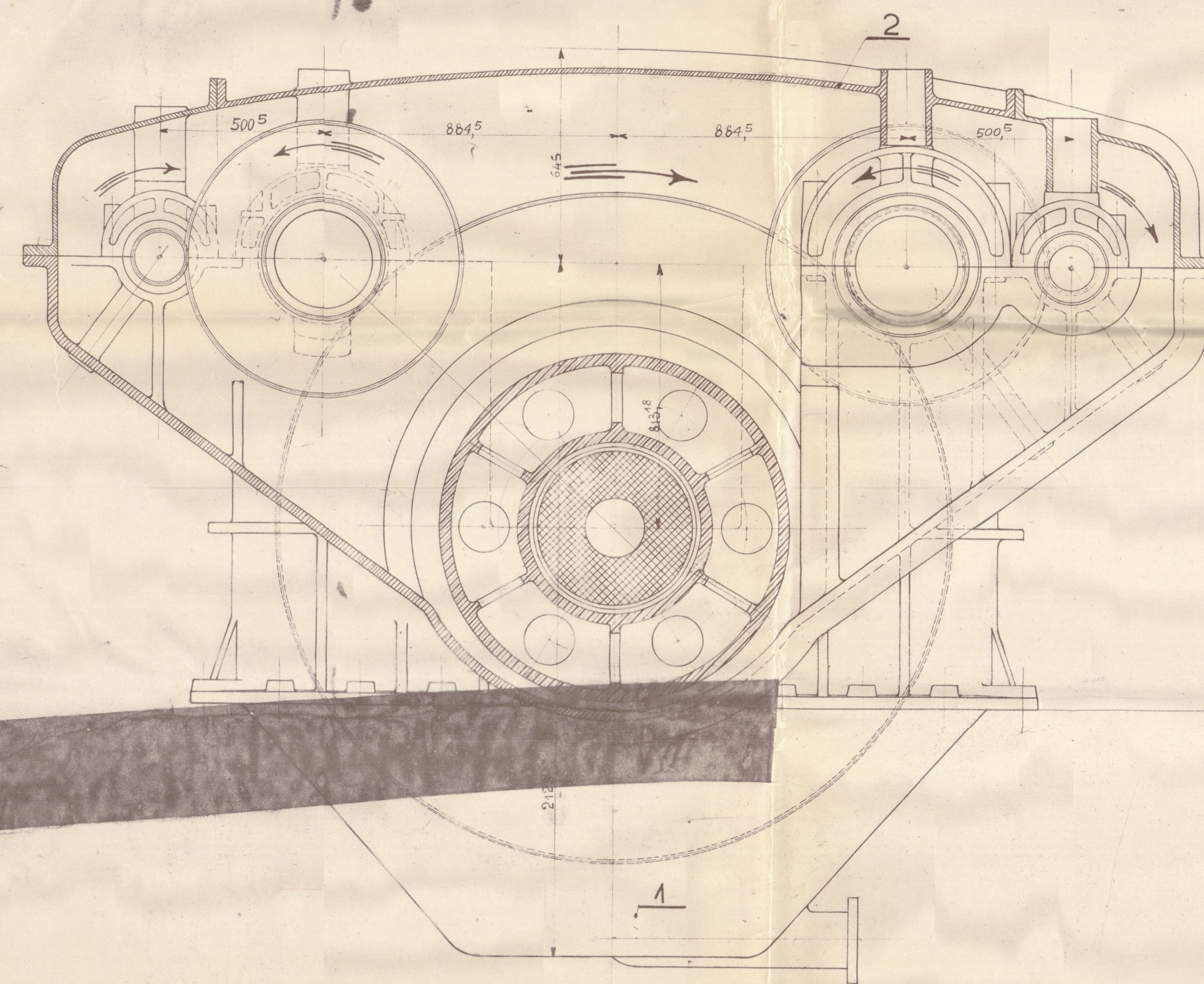

Dettaglio attacco turbina A.P.

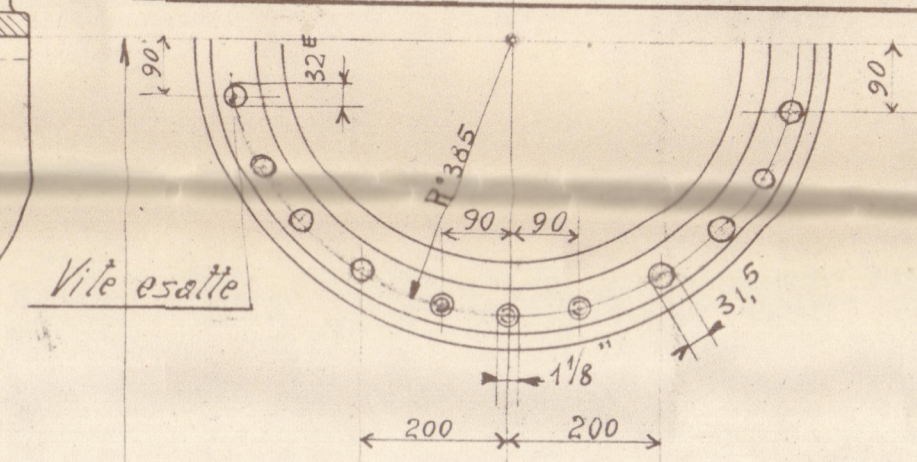

SEZIONE B-B

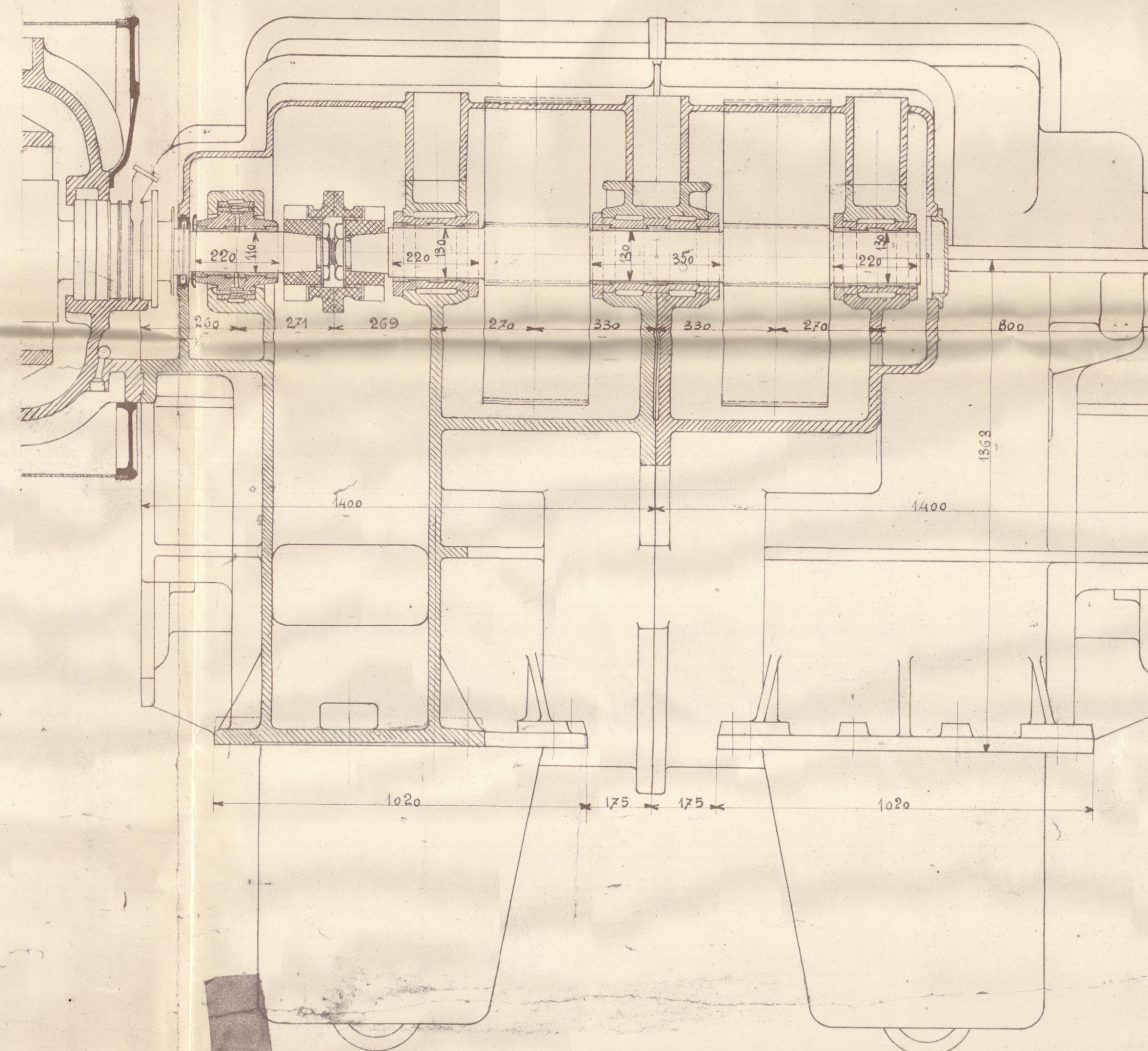

SEZIONE C-C

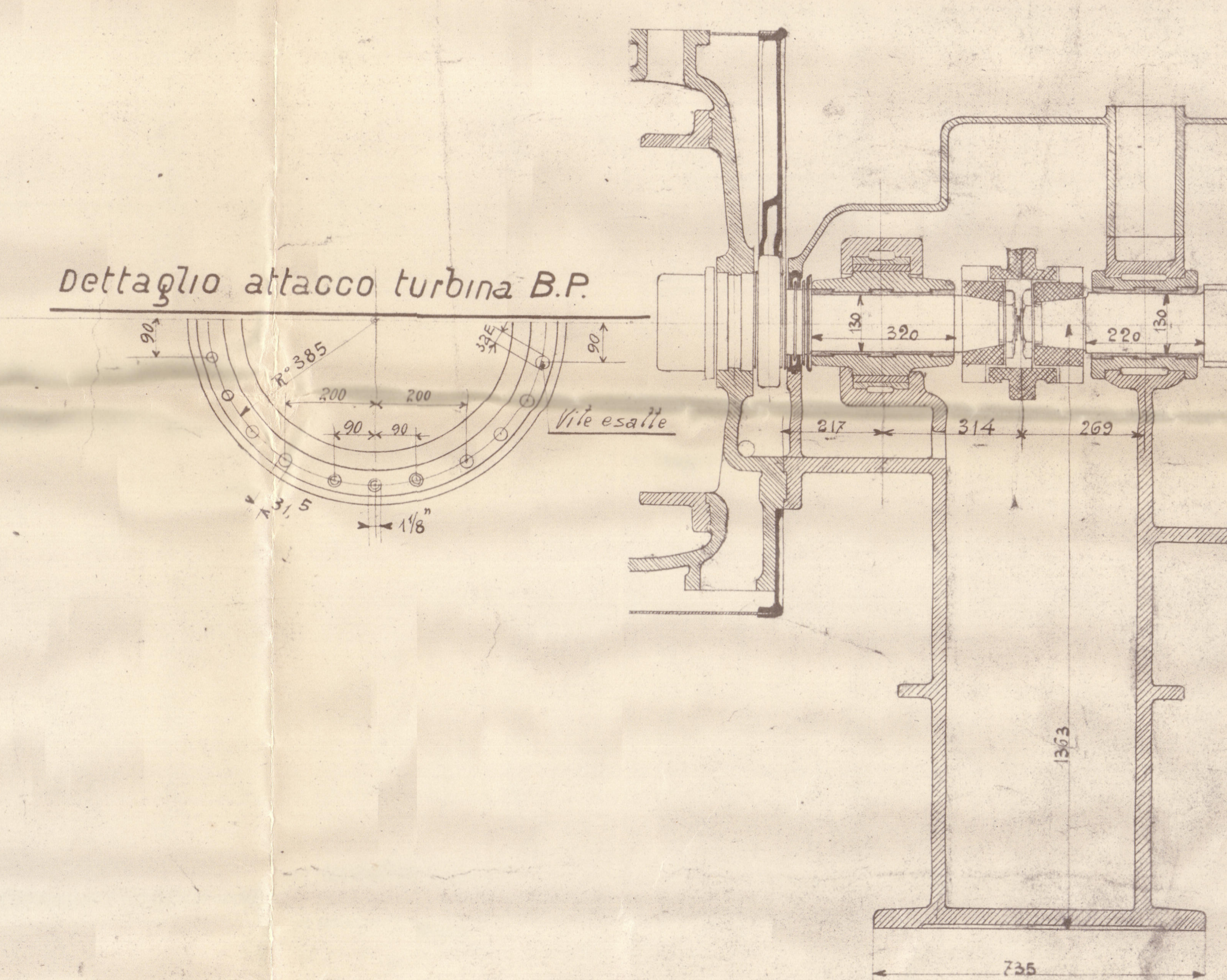

Dettaglio attacco turbina B.P.

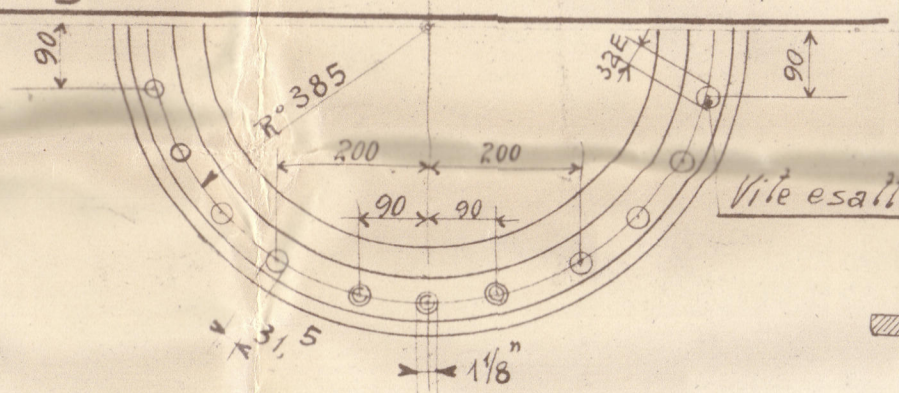

PIANTA

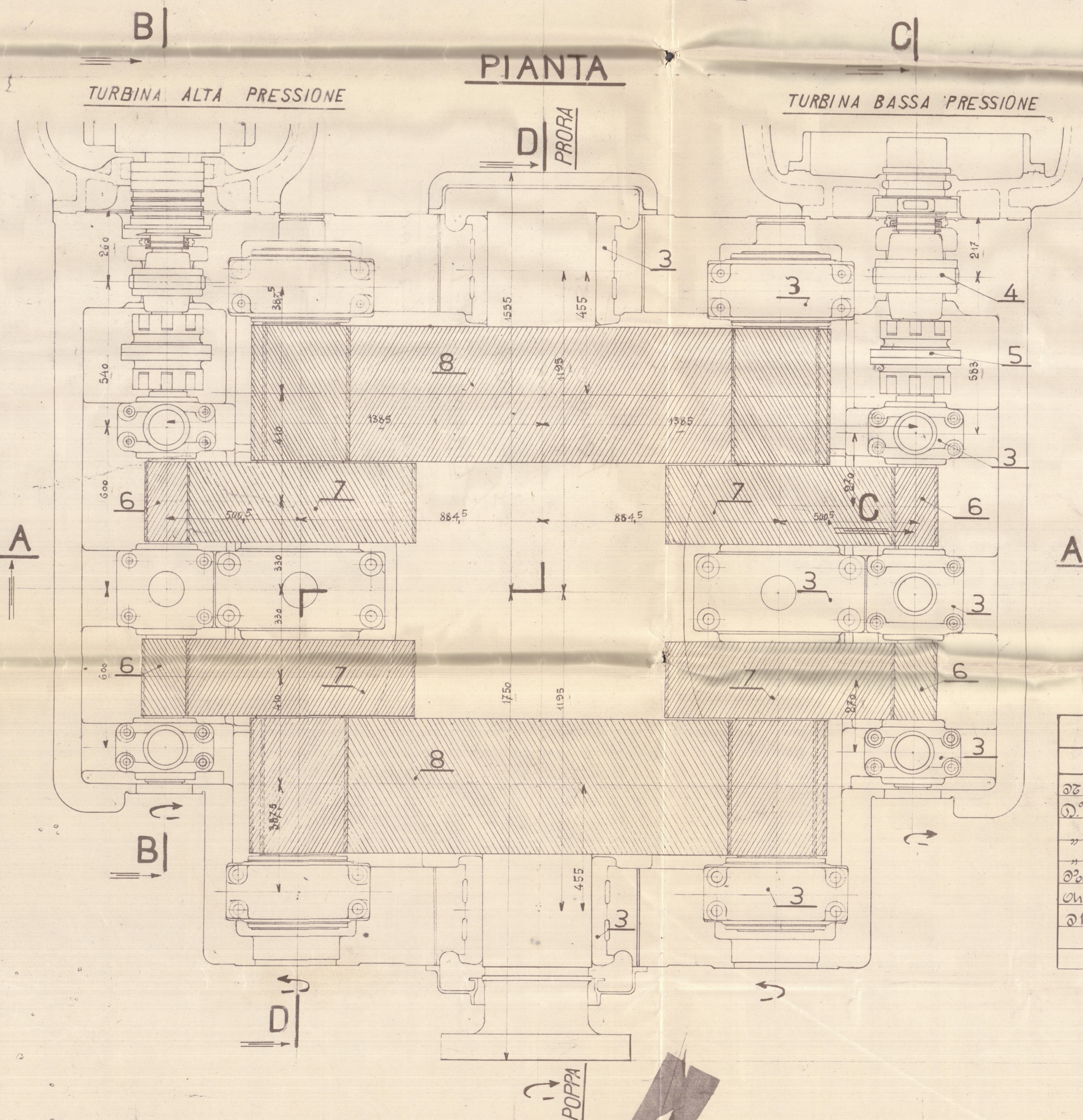

SEZIONE D-D

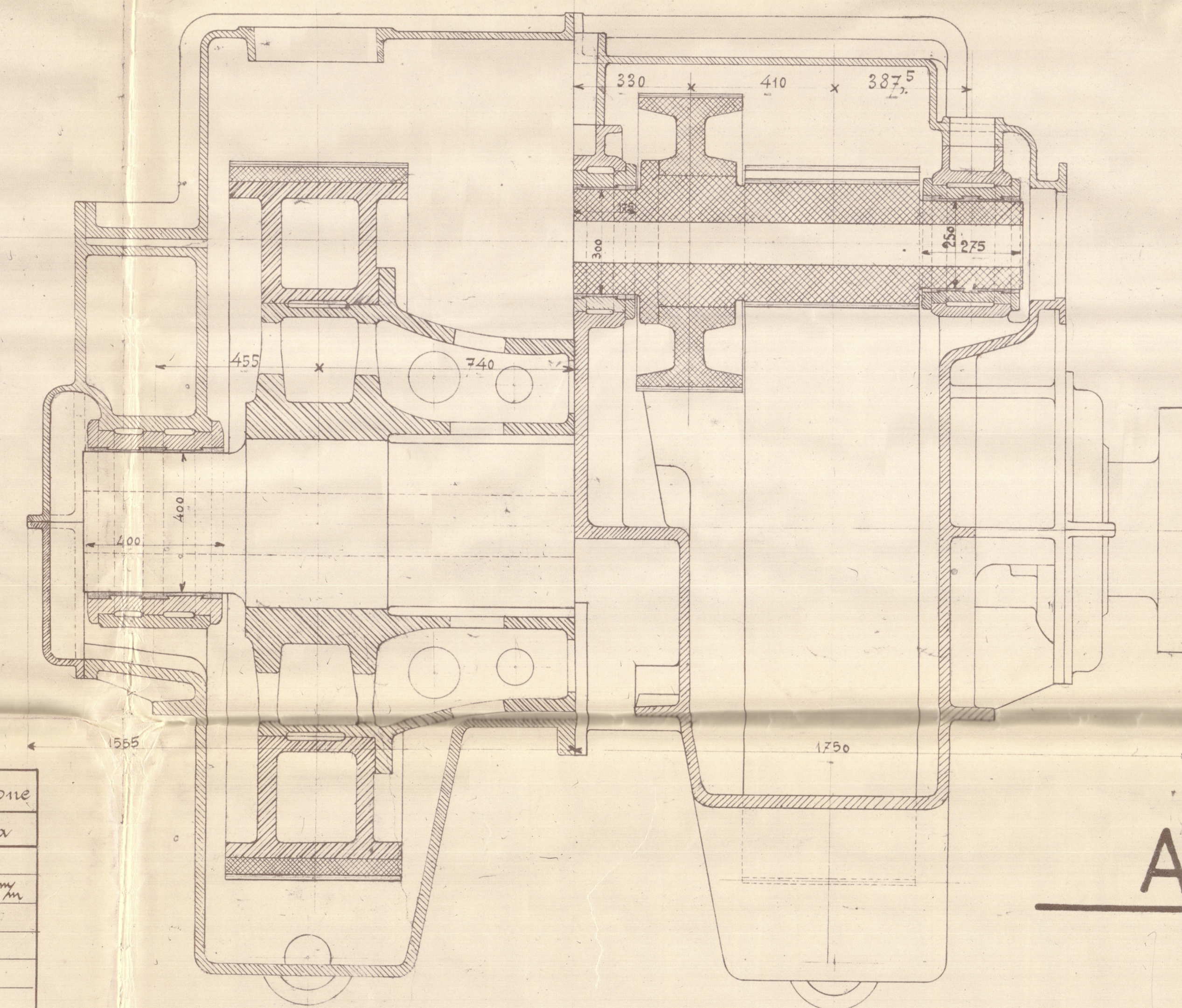

- GHISA
- ACCIAIO FORGIATO
- ACCIAIO FUSO

Leggenda

- 1 Base riduttore
- 2 Coprecchio riduttore
- 3 Cuscinetti riduttore
- 4 " turbine
- 5 giunto
- 6 Pignoni veloci
- 7 Pignoni intermedi
- 8 Ruote grandi

ASSIEME RIDUTTORE

T.V. P. M. 2100 H.P. ASSE.

SCALA 1:10

	Prima riduzione		Seconda riduzione	
	Pignone	Ruota	Pignone	Ruota
Ø Denti	24	130	39	225
Ø primitivo	156 mm	845 mm	351 mm	2092 mm
eslone	165	854	364	2095
utlone	145	834	335	2086
Ø base primitiva	20.72	20.72	28.27	28.27
Angolo spica	30°	30°	30°	30°
Ø Denti e base primitiva in acciaio, ang. 30°, 30°, 30°, 30°.				

Dati potenza

	Potenza	Velocità giri/min	Velocità giri/sec
Ø nominal	2100 HP	2500	79
Ø massimo	3000 HP	2800	89

DISEGNO N° 87439

87439

FRANCO TOSI

FOR

ILVA.

$\frac{S}{S}$ BAGNOLI ~~10~~ 1"

REDUCING APL 2218
GEAR.

Gen Box 3362

LONDON

RETAIN

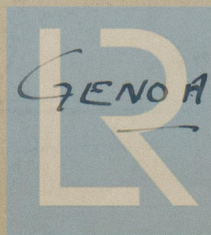

© 2020

Lloyd's Register
Foundation

W1119-0134