

21.12.16

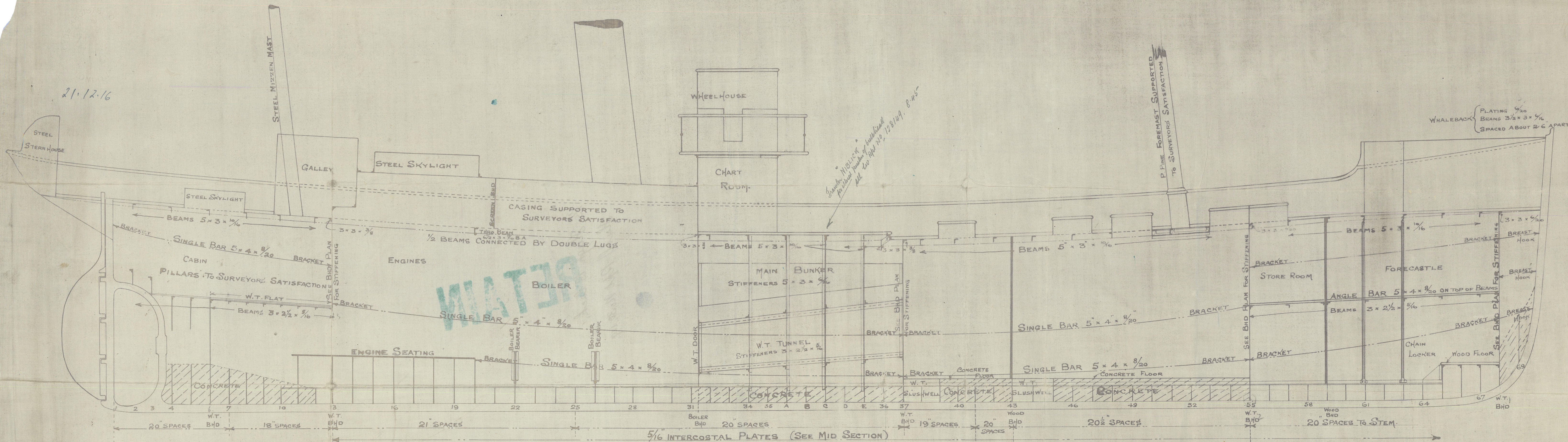

BEAM ARRANGEMENT

PILLARING THROUGHOUT TO SURVEYOR'S SATISFACTION

DIMENSIONS
125'0" B.P. x 22'0" EX x 13'7" MLD

SCALE 1/4" = 1' FOOT

SUBMITTED TO LLOYDS
APPROVED BY LLOYDS

— NOS 340J —

ccp
20.12.16

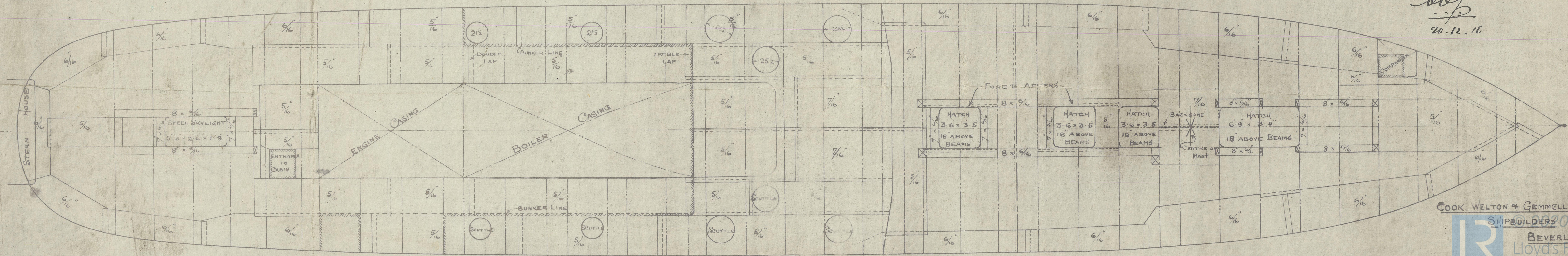

Nº 340 J

PROFILE
+
DECK PLAN

COOK WELTON & GEMMELL



1/5 Hugh Black,
Hull Rpt No 30, 119.

n. 1

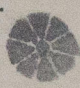
Ogano 

W1108-0046

£. 82.11



© 2020

Lloyd's Register
Foundation