

S/S 'Olympic'

Midship Section
(as fitted)

Gal. 4737

XI109- 0047



© 2020

Lloyd's Register
Foundation

SECTION AT WEB FRAMES

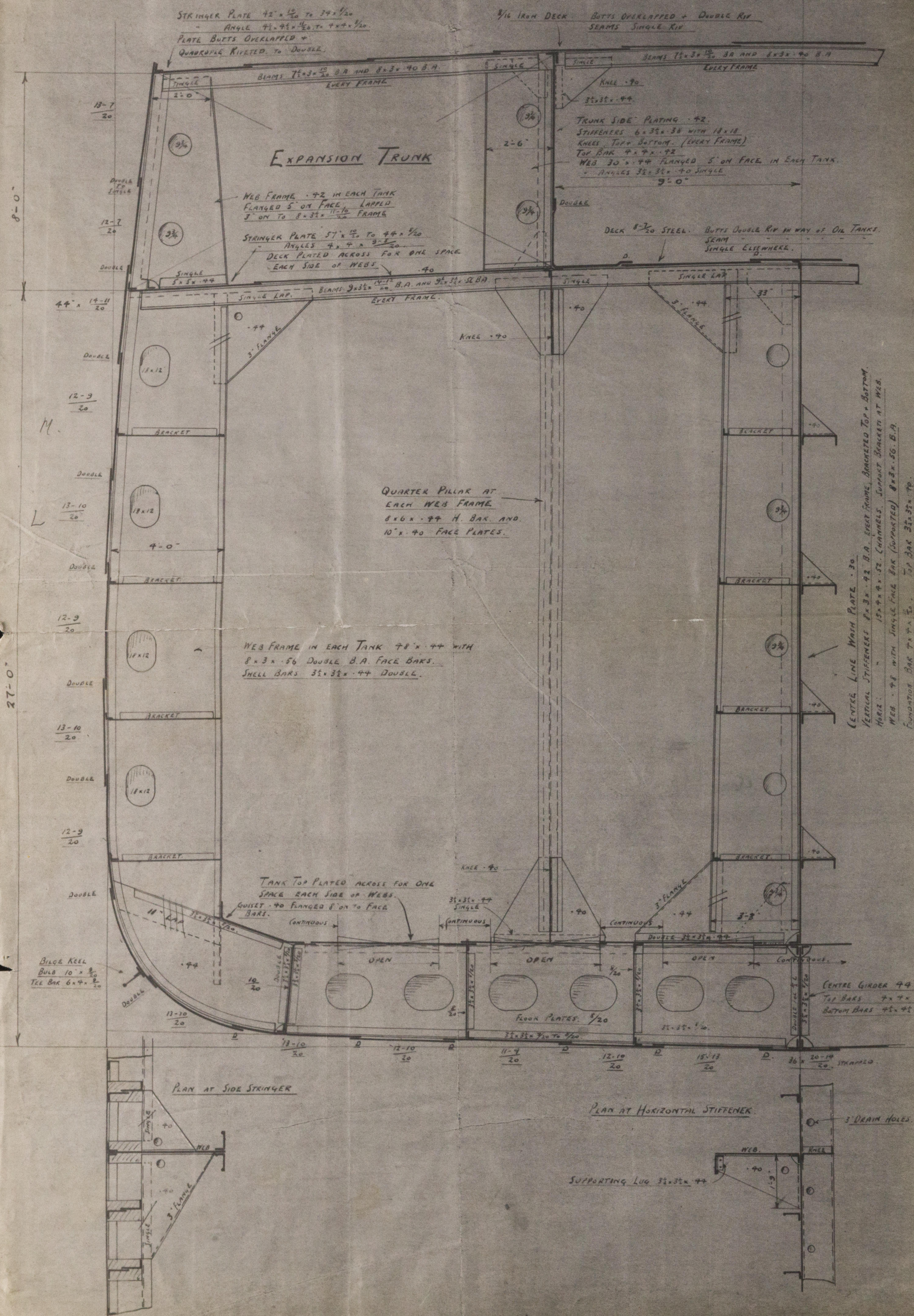

S/S "HARPORT"

To CLASS 100 A.I. AT LLOYDS

SCALE $\frac{1}{2}'' = 1 \text{ FOOT}$

PRINCIPAL DIMENSIONS.
 LENGTH B.P. ----- 370'-0"
 BREADTH EST. ----- 50'-0"
 DEPTH M^d ----- 27'-0"



SECTION CLEAR OF WEB FRAME

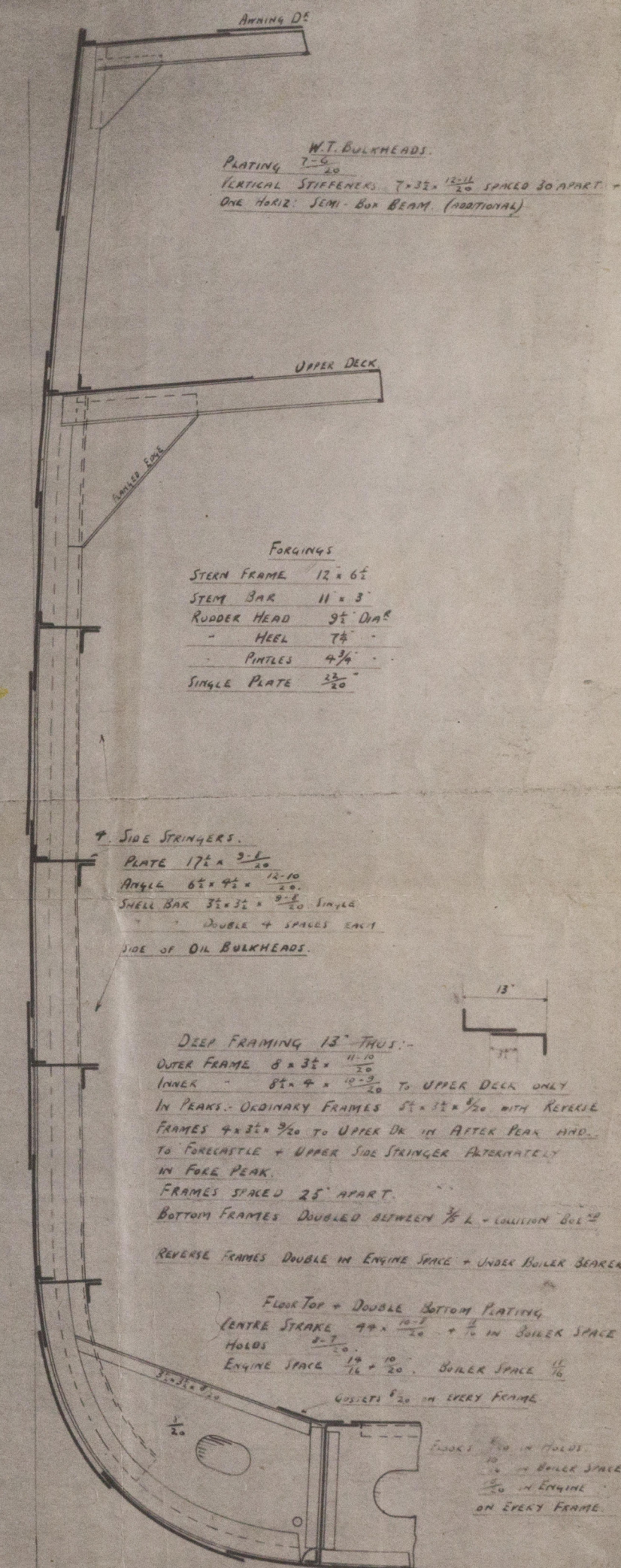

SECTION AT TUNNEL

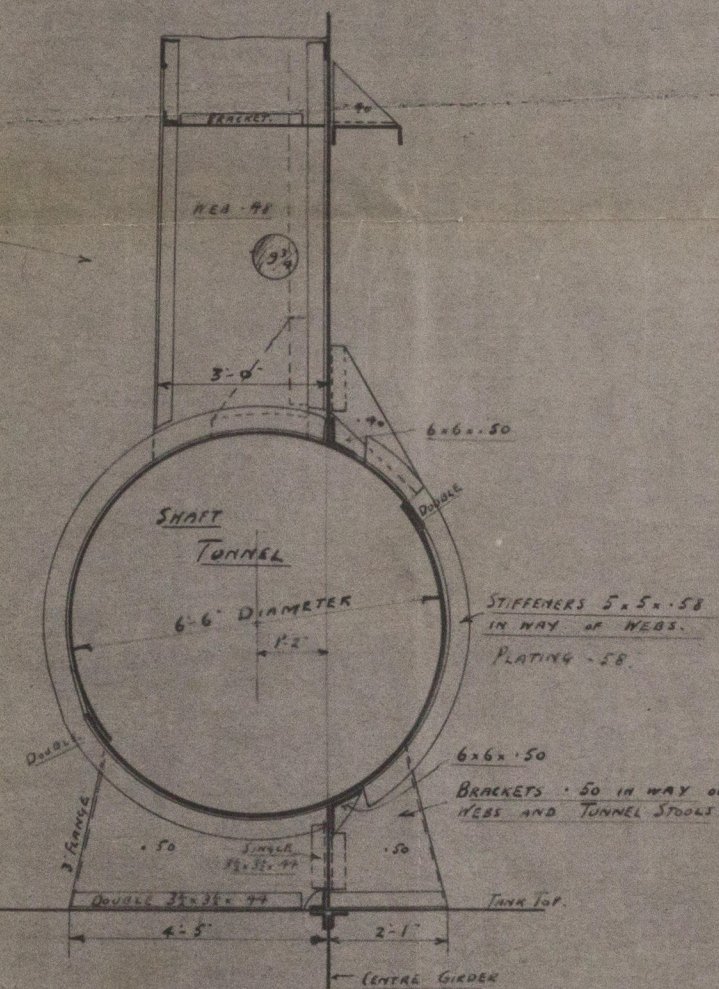

DEEP FRAMING 13" THUS:-

OUTER FRAME $8 \times 3\frac{1}{2}$ " $\frac{11-10}{10}$

INNER 8×4 " $\frac{9-9}{20}$ TO UPPER DECK ONLY

IN PEAKS: ORDINARY FRAMES $8 \times 3\frac{1}{2} \times \frac{1}{2}$ WITH REVERSE FRAMES $4 \times 8 \times \frac{1}{2}$ TO UPPER DECK IN AFTER PEAK AND TO FORECASTLE + UPPER SIDE STRINGER ALTERNATELY IN FORE PEAK.

FRAMES SPACED 25" APART.

BOTTOM FRAMES DOUBLED BETWEEN $\frac{1}{2}$ L - COLLISION BELT

REVERSE FRAMES DOUBLE IN ENGINE SPACE + UNDER BULWER BEARDS.

FLOW TOP + DOUBLE BOTTOM PLATING
 CENTRE STAKE $7\frac{1}{2} \times \frac{10-2}{2} = \frac{1}{2}$ IN BULK SPACE
 HOLDS $\frac{2-1}{2}$
 ENGINE SPACE $\frac{1}{16} \times 20$ BULK SPACE $\frac{1}{16}$
 GUSSETS $\frac{1}{2} \times 20$ ON EVERY FRAME
 STAKE $\frac{1}{16}$ IN HOLDS
 $\frac{1}{16}$ + BULK SPACE
 $\frac{1}{16}$ IN ENGINE
 ON EVERY FRAME

ALL ANGLES VC INCREASED AS PER RULE IN BOWLER SPACE