

T.S.D.Y. "CHELSEA"

LONGITUDINAL SECTION AND DECK PLANS.

SCALE $\frac{1}{4}'' = 1 \text{ FOOT}$.

DIMENSIONS: LENGTH 129'-0" ON DATUM LINE x 23'-0" B.M.D. x 12'-9" D.M.D.

TO CLASS 100 A.I. LLOYD'S YACHT RULES.

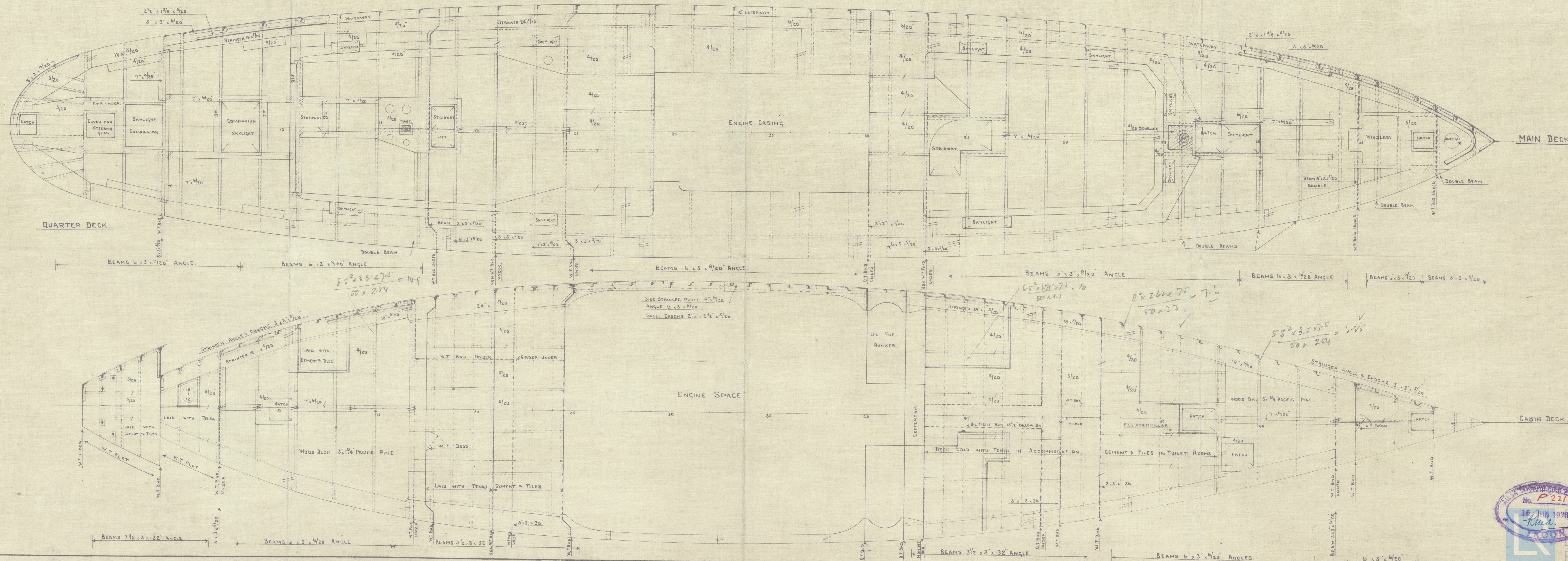
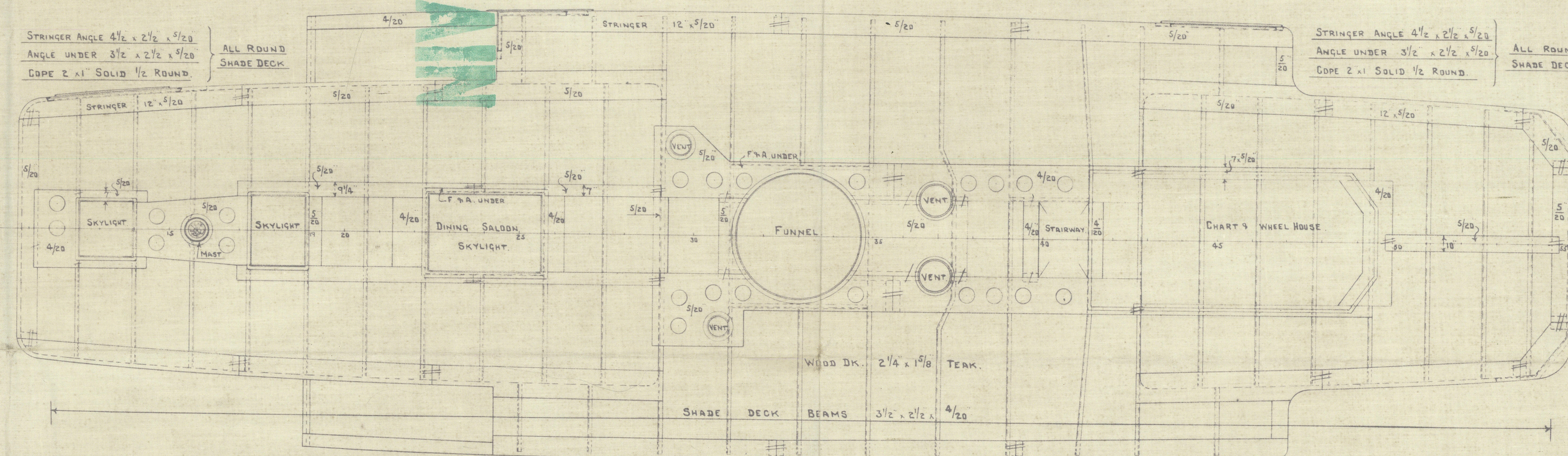

Twin Screw Diesel Yacht "CHELSEA".

Longitudinal Section and Deck Plans as built.

Chelsea

GLASGOW REPORT No 45791



© 2020

Lloyd's Register
Foundation

W1066 - 0035