

SHIP NO 778.
MIDSHIP SECTION.

STEEL TWIN SCREW PASSENGER & CARGO STEAMER.

— FOR —

UPPER YANGTZE RIVER SERVICE.

DIMENSIONS

LENGTH W.L.	164.9'
BREADTH MLD	30'-0"
DEPTH MLD	9'-6"
DRAUGHT LOADED	7'-6"

SCALE $\frac{1}{2}$ " = 1 FOOT.

TO CLASS LLOYD'S A SPECIAL SURVEY FOR LIGHT DRAUGHT RIVER VESSEL.

** A1 For service on the Yangtze River*

EQUIPMENT (AS SPECIFIED)

2 BOWER ANCHORS	12 CWTs (STOCKLESS)
1 SPARE ANCHOR	12 CWTs (")
1 STERN ANCHOR	10 CWTs (")
180 FATHOMS	1 1/2" DIA. STUD CHAIN CABLE
60 "	2 3/4" F.S. WIRE FOR STERN ANCHOR
150 "	2 3/4" F.S. WIRE
4 @ 90 FATHOMS	2 3/4" F.S. WIRE
2 @ 90 FATHOMS	4" MANILA ROPE
120 FATHOMS	2" MANILA ROPE
120 FATHOMS	1" MANILA ROPE

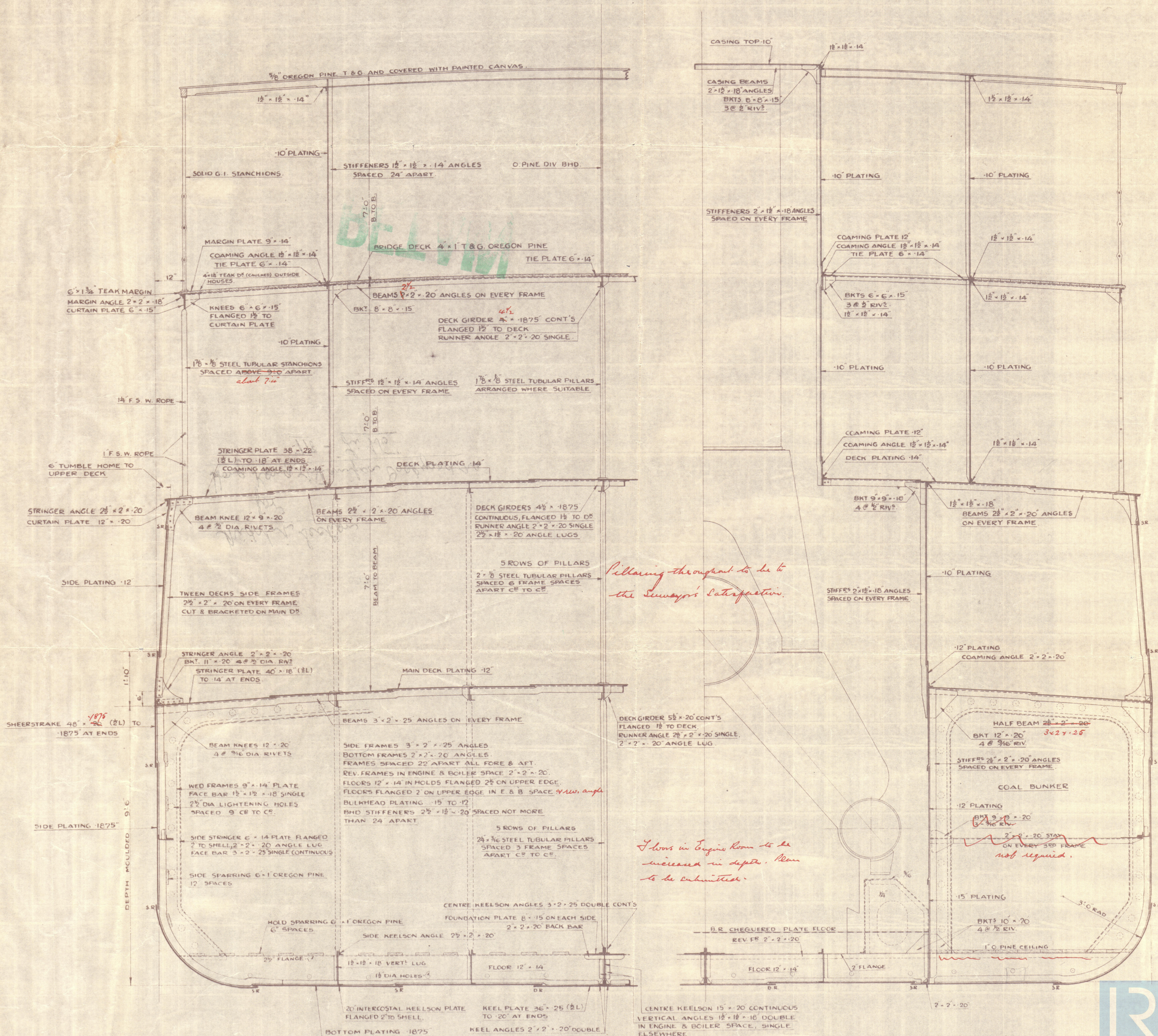

Pillaring throughout to be to the Surveyor's satisfaction.

Stress in Engine Room to be increased in depth. Plan to be submitted.

not required.



HONG KONG & WHAMPOA DOCK CO. LTD.
DRAWING NO 1-37

WID56-0058

W1056-0058

Midship Section

for

Hong Kong Wharves Dockyard no

778 - "Li Wo"

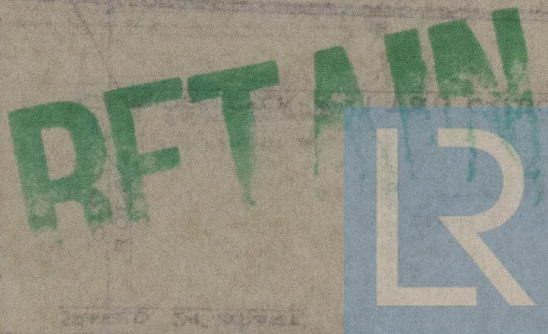

© 2020

Lloyd's Register
Foundation