

115/112

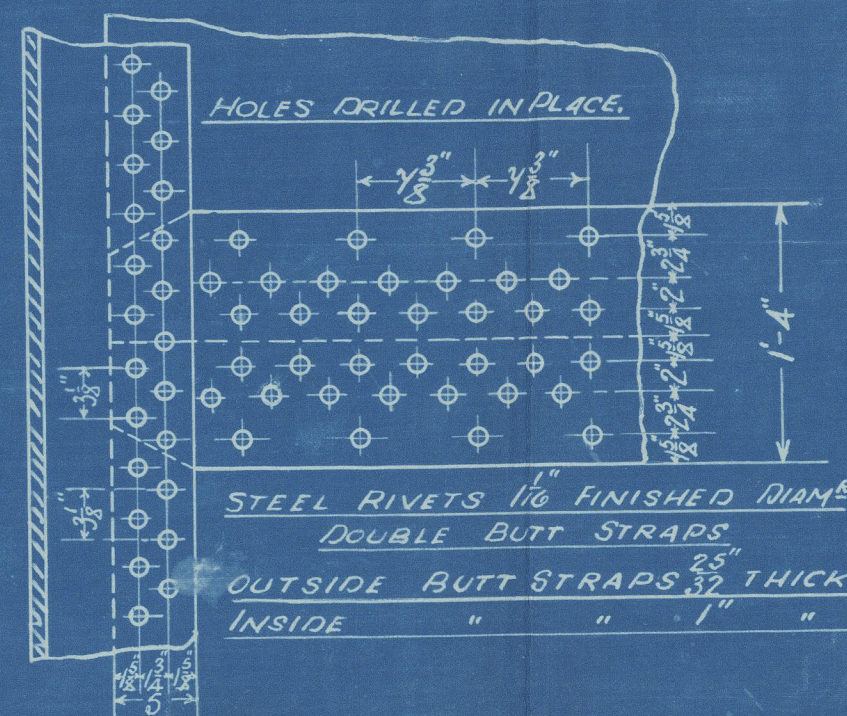

9-4-12.



W1038-0194

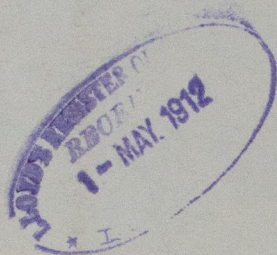

© 2020

Lloyd's Register  
Foundation

" HARPTREE COMBE

*Wm Russell & Co. Ltd.* <sup>EX</sup>

*N<sup>os</sup> 519 & 520*

*Main Boilers*

*519 / S.S. "Norah Colsmie" \**

*Abx rept. 11010*

*520 / S.S. "Braeneil"*

*Abx rept. 11011*

W1038-0194

© 2020

Lloyd's Register  
Foundation