

Lloyd's Register of Shipping.

SURVEYS FOR FREEBOARD.

(CONDITIONS OF ASSIGNMENT.)

 13 JUN 1944
 Index No. 34221
 (For London Office only).

Ship's Name "EMPIRE MOMBASA" Port of Survey Sunderland
 Official Number 181121 Surveyor's Signature [Signature]
 Nationality and Port of Registry British, Sunderland Date of Survey While building

Disposition and dimensions of superstructures, trunks, deckhouses and machinery casings to be inserted in the diagrams and tabular statement: --

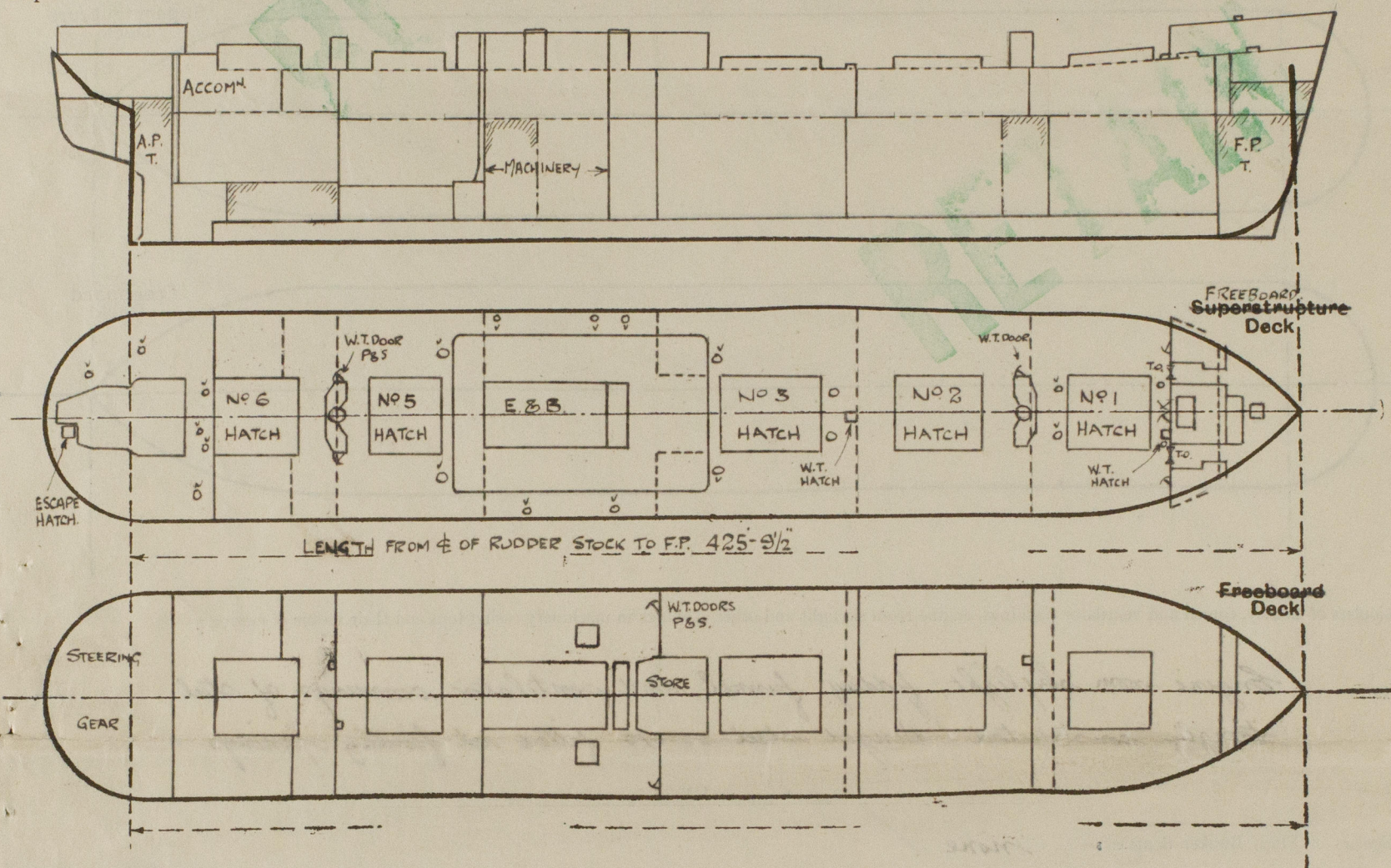

Particulars of Superstructures, Trunks, Casings, Deckhouses.

	Coaming	Plating	Stiffeners	Spacing	End Attachments of Stiffeners	Size of Openings	Height of Sills	Height of Casings
Poop Bulkhead ...	✓	40"	3 x 3 x 40 8 DEEP BKT	30"	✓	✓	✓	3'-0"
Raised Quarter Deck Bulkhead ...	✓							
Bridge, After Bulkhead ...	✓							
Bridge, Forward Bulkhead ...	✓							
Forecastle Bulkhead ...	32"	32"	4 x 3 x 5/16 OA	30"	JOINTER RIVET @ 8" BTM	2 @ 5'-0" x 2'-3" 2 @ 5'-0" x 3'-1" 1 @ 5'-0" x 3'-11"	1/8" 1/2" 1/2"	7'-0"
Trunk, Aft ...	✓							
Trunk, Forward ...	✓							
Exposed Machinery Casings on Freeboard or Raised Quarter Decks ...	✓							
Exposed Machinery Casings on Superstructure Decks ...	✓							
Machinery Casings within Superstructures not fitted with Class I Closing Appliances ...	✓							
Deckhouses on Flush Deck Ships ...	✓							

Particulars of Closing Appliances (state if capable of being manipulated from both sides).

Poop Bulkhead ...	No opening.
Raised Quarter Deck Bulkhead ...	✓
Bridge, After Bulkhead ...	✓
Bridge, Forward Bulkhead ...	✓
Forecastle Bulkhead ...	✓
Exposed Machinery Casings on Freeboard or Raised Quarter Decks ...	✓
Exposed Machinery Casings on Superstructure Decks ...	✓
Machinery Casings within Superstructures not fitted with Class I Closing Appliances ...	✓
Deckhouses on Flush Deck Ships ...	✓

Hinged steel doors operated from both sides. 3/8" steel plate secured by 3/4" hooked bolts at 13" apart ✓

Engine room skylight, fiddley, funnel and ventilator coverings of steel strongly constructed. Hinged steel covers fitted at fiddley openings. ✓

none ✓

Entrance to crew's accom. in after deckhouse, hinged teak doors, 5'-0" x 2'-0" - 1 7/8" thick 2 1/2" sill. ✓
 W.L. steel doors in mast houses 3'-6" x 1'-6" - 3/8" sill. ✓
 All doors operated from both sides. ✓

Upper decks:-

1	cowl vent	10" dia	coaming	34" x 32"	to steering gear.	✓
1	"	10"	"	34" x 32"	to accomm.	✓
2	"	14"	"	34" x 36"	do	✓
2	"	14"	"	34" x 36"	to hold.	✓
2	"	18"	"	46" x 40"	do (stayed)	✓
2	"	12"	"	34" x 34"	do	✓
2	"	12"	"	34" x 34"	Cabin store	✓
1	"	12"	"	34" x 34"	Refrig. Machy.	✓
4	"	18"	"	34" x 40"	holds.	✓
4	"	18"	"	36" x 40"	do	✓

Forecastle deck:-

3	cowl vents	8" dia.	coaming	36" x 32"	to store	✓
2	"	12"	"	36" x 34"	do	✓

G.H.V. on upper deck 4.66" dia. 34" to lift
 " " Forecastle 6 " 36" " " ✓

All ventilators fitted with wood plugs and canvas covers. ✓

Upper Deck:-
 14-5" dia air pipes 30" to lip ✓
 2-3" " " 30 " " ✓
 3-4" " " 30 " " ✓
 1-2 " " 30 " " ✓

Forecastle deck:-
 2-5" dia air pipes 18" to lip ✓
 1-4 " " 18" " " ✓

Air pipes fitted with wood plugs or gauge and canvas covers. ✓

W1038 - 0049 2/2

Empire Mombasa.

[illegible]

10" dia. sidelights to accommodation aft (two decks) fitted with substantial hinged deadlights ✓

35'-0" ✓

Forecastle deck:- 3'4" high, 2 rods, stanchions spaced 4'-6" apart. ✓

Upper deck aft - 3'6" high, 3 rods, stanchions spaced 4'6" apart.

Bulwark 3 1/2" high fitted from break of upper deck aft to forecastle. ✓

One 2" S.W. lifeline supplied with fittings for same post & started ✓

Particulars of Freeing Arrangements.						
	Length of Bulwark	Height of Bulwark	Size of Freeing Ports	Number each side	Area each side	Rule area each side
After Well bulwark ...	356' 3"	3' 6" rising to	12' 0" x 9"	3	26.61	77.58 $\frac{1}{2}$ 71.4 $\frac{1}{2}$
Midship do		5' 0" at	6' 0" x 9"	1	6.62	
Forward Well bulwark ...		forecastle port.	12' 0" x 9"	5	44.35	
<p>State position of each freeing port ... (After Well :— (F. and A. position and height above deck edge) Forward Well :—</p> <p>State whether the freeing ports are fitted with shutters, bars, or rails, and give particulars of such :— none.</p> <p>Additional area where sheer is less than standard.</p>						
<p style="text-align: center;">Position of freeing ports</p> <p>9-6"x5" scuppers cut in stronger angle to drain upper deck.</p>						

PARTICULARS OF PROTECTION TO OPENINGS, ETC.

HATCHWAYS ON FREEBOARD AND SUPERSTRUCTURE DECKS.											
← FREEBOARD DECK →											
Description of Hatchway	Nº 1	Nº 2 & 3	Nº 5	Nº 6	CASING TOP 2 OFF	UPPER DK IN FO'LE	UPPER DK IN FO'LE	ESCAPE W.T. HATCHES ON UPPER DECK	W.T. ESCAPE HATCH ON FO'LE
Dimensions of Hatchway	31'6" x 23'	36' x 23'	36' x 23'	36' x 23'	19'7" x 9'	3'9" x 3'0"	6'6" x 4'3"	3' OFF 2'3" x 2'3" APPROX.	2'0" x 1'9"
COAMINGS	Height above Deck	...	30	30	42	54	12	9	9	9	9
	Thickness	Sides	.44 ✓	.44 ✓	.44 ✓	.44 ✓	12 x 3/2 x 43L	9 x 3/2 x 40L	9 x 3/2 x 40L	9 x 3/2 x 40L	9 x 3/2 x 45
	Stiffeners	Ends	.44	.44	.44	.44	do	do	do	do	do
	Brackets, Stays	...	3 x 3/2 x 46L	12 x 3/2 x 46L	9 x 3/2 x 46L	9 x 3/2 x 46L	✓	✓	✓	✓	✓
HATCH BEAMS	Number	...	6	7	7	7	1				
	Spacing	...	equal	equal	equal	equal	equal				
	Scantling and Sketch	...	5 x 3 x 46	do	do	do	4 x 3 x 44	✓	✓	✓	✓
	Bearing Surface	...	18 x 36	3	3	3	16 x 36	✓	✓	✓	✓
FORE AND AFTERS	Number	...	NONE	✓	✓	✓	✓	✓	✓	✓	✓
	Spacing	...									
	Unsupported Lengths	...									
	Scantling and Sketch	...									
HATCH COVERS	Material	...	W.W.	W.W.	W.W.	W.W.	W.W.	W.W.	W.W.	HINGED STEEL COVERS SECURED BY TOSSELS	do.
	Thickness	...	2 1/2	2 1/2	2 1/2	2 1/2	2 1/2	2 1/2	2 1/2		
	How fitted	...	F.B.A.	F.B.A.	F.B.A.	F.B.A.	F.B.A.	THWART.	F.B.A.		
	Bearing Surface	...	3	3	3	3	3	3	3		
Spacing of Cleats	24	24	24	24	24	24	24		
Number of Tarpaulins	3	3	3	3	3	1	1		

*Are wood fore and afters steel shod at all bearing surfaces? NONE
 Are battens and wedges efficient and in good condition? YES
 Are tarpaulins in good condition and in accordance with rule requirements? YES
 Are lashings provided in accordance with rule requirements? LOCKING BARS.

Particulars of any special features:—

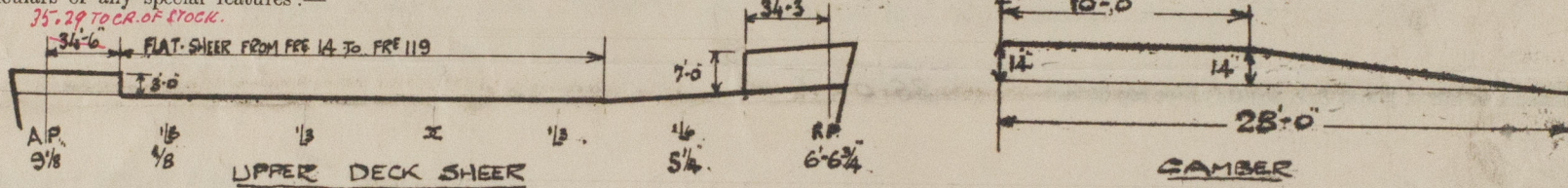

This vessel has been built to scantlings as per plans approved 29/2/44 in order to obtain a draught in excess of that permitted by the Rules for a C.S.S. vessel having a tonnage opening.
 Pre-fabricated materials have been incorporated in the vessel.

Endorsement at first survey and at surveys for renewal of Certificate:—

The fittings and appliances are in accordance with the particulars shown on this form (or as now modified) and are in good condition.

Equivalent Camber.

$$\text{Area} = (20 + 18) \times \frac{14}{12} \div 2$$

$$\text{Mean Height} = \frac{(20 + 18) \times 14}{56 \times 12} = .792$$

$$\therefore \text{Eq. Camber} = \frac{3}{2} \times .792 = 1.188 = 14.26"$$