

Superstructure bulkheads, trunks, deckhouses, casings, cargo and coaling hatchways, extent and coaling ports, and any other openings, etc., which would

28 JUN 1935

Particulars of Scupperns and Sanitary Discharge Pipes =
 Scupperns draining poop deck 2' dia pipe, no valve, to shell 3' 0" below poop deck level.
 To & after wells drained by scupperns in gunwale bar 4 1/2 x 3".
 Sanitary discharge pipes below freeboard deck fitted with storm valves at ship's side.

Particulars of Side Scuttles:
 All side scuttles below freeboard deck fitted with hinged deadlights.
 in poop, bridge & fore tween decks fitted with hinged deadlights.
 All scuttles of substantial construction.

Particulars of Guard Rails:—

Steel bulwork in wells	3' 6" high, Stays 6' B.A. 6 feet apart
Guard Rails on Ice deck	3' 2" high with 3 rails + stanchions spaced 4' 6" to 5' apart
Coop	3' 4"
Brick	

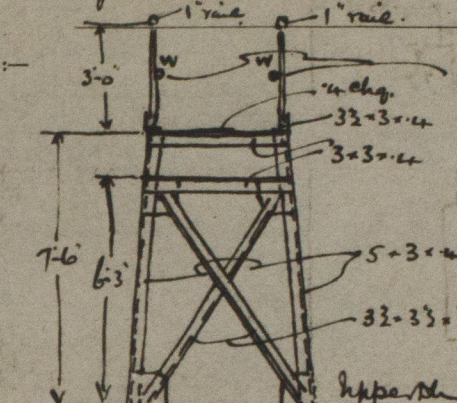

Sketch showing Foreaft gateway between
File + Bed. + Bed + Poop.
Supports spaced 9' 6" apart.
Dimensions " 6' 0" " "

Particulars of Freeing Arrangements.						
	Length of Bulwark	Height of Bulwark	Size of Freeing Ports	Number each side	Area each side	Rule area each side
After Well	$93.75'$ $97-3$	3-6	$36.4 \times 21 = 6$	148	$82 \text{ } \phi$	14 area 82ϕ
Forward Well	$115.67'$ $116-6$	3-6	$36.3 \times 21 = 6$	1410	$100 \text{ } \phi$	101ϕ

State position of each freeing port } After Well :— } Height above deck edge 12".
(F. and A. position and height above deck edge) } Forward Well :—

State whether the freeing ports are fitted with shutters, bars, or rails, and give particulars of such :— 2 bars horizontal each in each.

Additional area where sheer is less than standard.

Particulars of Superstructures, Trunks, Casings, Deckhouses.								
	Coaming	Plating	Stiffeners	Spacing	End Attachments of Stiffeners	Size of Openings	Height of Sills	Height of Casings
Poop Bulkhead ✓	.40 ✓	.40 ✓	7x3x36 BA 25' length	30" ✓	bkts ✓	no openings		7-6
Raised Quarter Deck Bulkhead ✓			12" flange web 91x32 web 35' long	36" ✓	bkts ✓	2'-4" x 3" ✓	18" ✓	7-6
Bridge, After Bulkhead30 -	.30 -	8" BA and 15' web	30" ✓	bkts top & sides	2'-4" x 2'-6" ✓	18" ✓	7-6
Bridge, Forward Bulkhead45 ✓	.42 -	3x3x35	30" ✓	none ✓	4'-9" x 2'-1" ✓	18" ✓	7-6
Forecastle Bulkhead35 -	.35 -						
Trunk, Aft ✓								
Trunk, Forward ✓								
Exposed Machinery Casings on Free-board or Raised Quarter Decks ...								
Exposed Machinery Casings on Super-structure Decks (Poop)32 ✓	.32 ✓	4x3x36	27"-30" ✓	bkts, top ✓	4'-9" x 2'-1" ✓	15" ✓	7-6
Machinery Casings within Superstructures not fitted with Class I Closing Appliances. Poop low candle32 ✓	.32 ✓	do. ✓	do. ✓	none ✓	1, 5'-3" x 2'-1" ✓	9" ✓	7-6
Deckhouses on Flush Deck Ships ... ✓								

Particulars of Closing Appliances (state if capable of being manipulated from both sides).	
Poop Bulkhead	no openings
Raised Quarter Deck Bulkhead ...	
Bridge, After Bulkhead	3" th. Stomboards in riveted channels.
Bridge, Forward Bulkhead	Strong steel hinged W.T. doors with clips 20' apart.
Forecastle Bulkhead	Steel hinged doors, spring locks. Yes.
Exposed Machinery Casings on Freeboard or Raised Quarter Decks ...	
Exposed Machinery Casings on Superstructure Decks ...	Steel hinged doors, spring locks, Yes.
Machinery Casings within Superstructures not fitted with Class I Closing Appliances	1 Steel door, hinged, spring lock, Yes.
Deckhouses on Flush Deck Ships ...	

Forecastle Bulkhead	Steel hinges doors, spring locks.. yes. ✓
Exposed Machinery Casings on Free-board or Raised Quarter Decks	

28 JUN 1935

Particulars of Scuppers and Sanitary Discharge Pipes

SAN ROBERTO

Superstructure bulkheads, trunks, deckhouses, casings, cargo and coaling hatchways, extent and thickness of sheathing on the freeboard deck, gangway, cargo and coaling ports, and any other openings, etc., which would affect the seaworthiness of the ship are to be shown on the following sketches:—

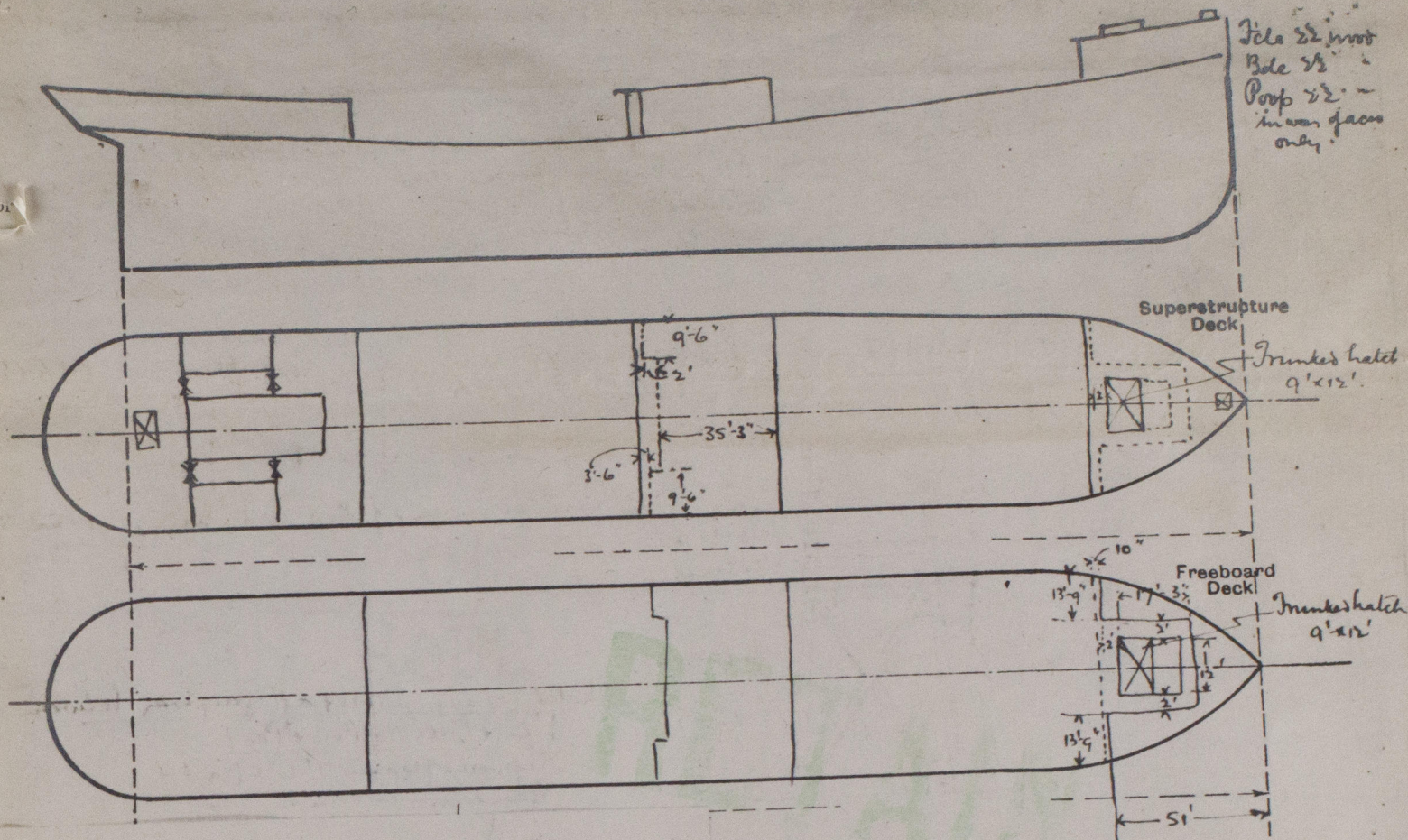

Hatch to trunk on File Bde.

9'x12'
Coaming 30'x40'
hony still 7 1/2 BA'
no stays
1 hatch beam 11'x3'
no f. rafters
WR comers 22' la. fitted f. ta.
3" bearing surface
Cleats 24" apart
2 turnbuckles, fittings in foot comers.
(9) trunk plating in file twice dls. 28 d.
Stiffs 3"x12", 1/2 rounds, spaces 2'-3"
no openings in file twice dls.

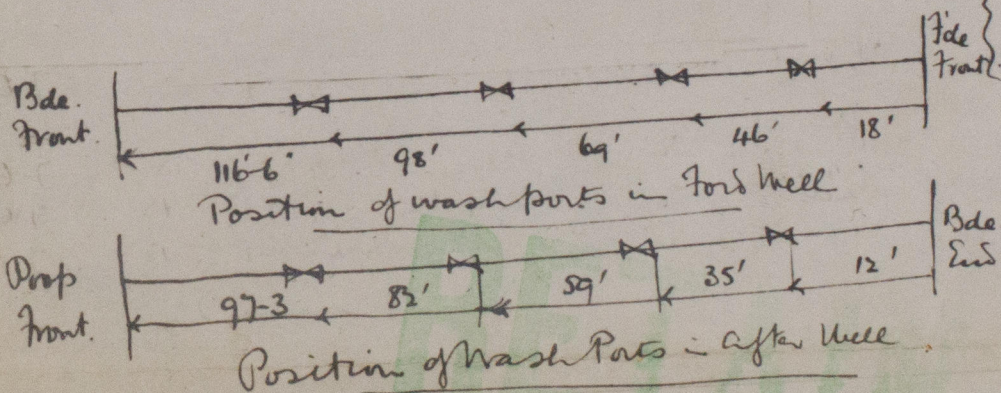

Freeing port area is being increased as shown on the accompanying sketch