

No. 578

Tropical	Fresh Water	Freeboard
Fresh Water			"
Tropical			"
Winter			"
Winter North Atlantic			"

3' - 7 1/2"

21 OCT 1935

PARTICULARS OF PROTECTION TO OPENINGS, ETC.

HATCHWAYS ON FREEBOARD AND SUPERSTRUCTURE DECKS									
U.O. Br. 2 Br. 0 Br. 0 L.O.									
Description of Hatchway			No. 1.	No. 2.	No. 3.	No. 4.	No. 5.		
Dimensions of Hatchway			26'0"x19'0"	26'0"x19'0"	19'6"x19'0"	28'2"x19'0"	28'2"x19'0"		
COAMINGS	{	Height above Deck ...	2'-7"	2'-7"	2'-7"	2'-7"	2'-7"		
		Thickness { Sides ...	4'-4"	4'-4"	4'-4"	4'-4"	4'-4"		
		{ Ends ...	4'-4"	4'-4"	4'-4"	4'-4"	4'-4"		
		Stiffeners ...	7x3x40 B.A.	7x3x40 B.A.	7x3x40 B.A.	7x3x40 B.A.	7x3x40 B.A.		
HATCH BEAMS	{	Brackets, Stays ...	2 1/2 Dia.	2 1/2 Dia.	2 1/2 Dia.	2 1/2 Dia.	2 1/2 Dia.		
		Number	5"	5"	3"	5"	5"		
		Spacing	4'-4"	4'-4"	4'-10"	4'-8"	4'-8"		
		Scantling and Sketch ...	7" 15-10x35 PLATE 1" 4x3x44	7" 13x33 dupl 6x3x44	as wd. 2	as wd. 2	as wd. 1.		
Bearing Surface		3"	3"		3"	3"			
FORE AND AFTERS	{	Number							
		Spacing							
		Unsupported Lengths ...							
		Scantling* and Sketch ...							
Bearing Surface									
HATCH COVERS	{	Material	W. Pine	W. Pine	W. Pine	W. Pine	W. Pine		
		Thickness	3"	3"	3"	3"	3"		
		How fitted	F.A.	F.A.	F.A.	F.A.	F.A.		
		Bearing Surface	3"	3"	3"	3"	3"		
Spacing of Cleats		23"	23"	23"	23"	23"			
Number of Tarpaulins		2	2	2	2	2			

*Are wood fore and afters steel shod at all bearing surfaces? *yes*

Are battens and wedges efficient and in good condition? *yes*

Are tarpaulins in good condition and in accordance with rule requirements? *yes*

Are lashings provided in accordance with rule requirements? *yes*

Particulars of fiddley, funnel and ventilator coverings:— The stockhold platings are covered by steel hinged covers. The fiddley and Engine Room Ventilators and funnel are in good and efficient condition. The engine Room skylight is of steel strongly constructed and is in good condition.

Particulars of Flush Bunker Scuttles:—

have.

Particulars of Companionways :—

one - Strongly constructed of steel on forecable head leading to crew's forecable with ~~wood~~ ^{steel} hinged door 3'-10" x 23", 14" sill.

Particulars of Ventilators in exposed positions on freeboard and superstructure decks :—

2-VENTS ON BRIDGE DEK. 30" HIGH, x 35" 6" DIA. LED TO POCKET BUNKERS.

[illegible]

Particulars of Air Pipes in exposed positions on freeboard, raised quarter, or superstructure decks :—

1- 3 1/2" C.I. AIR PIPE ON FREEBOARD DECK 6" HIGH LED TO FORE PEAK TANK. *inside peak space*
 2- 3" " " PIPES " *NO 36* " " " NO 1 D.B. TANK.
 10- 3" " " BRIDGE " 10" " " NO 2, 3, 4 & 5 NO D.B. TANKS
 1- 4" " " Pipe " Poop " 18" " " AFTER PEAK TANK.

ALL AIR PIPES CLOSED WITH CANVAS COVERS. ✓

Particulars of Gangway Cargo and Coaling Ports:—

bone.

Particulars of Scuppers and Sanitary Discharge Pipes —

all Scuppers and Sanitary pipes are fitted with J. M. Storm Valves. ✓

Particulars of Side Scuttles :

Side Scuttles: The Side Scuttles in fore-castle, Bridge, and Poop spaces are fitted with C.I. dead lights.

all side Suttles are of substantial construction. ✓

Particulars of Guard Rails :—

ward Rails :-
 Forecastle deck rails and stanchions 3'0" high, 5'0" apart. 3 rods.
 Bridge deck rails and stanchions 3'0" high, 5'5" apart. 3 rods.
 Poop deck rails and stanchions 3'4" high 5'0" apart. - 3 rods.

Particulars of Gangways, Lifelines, etc.:—

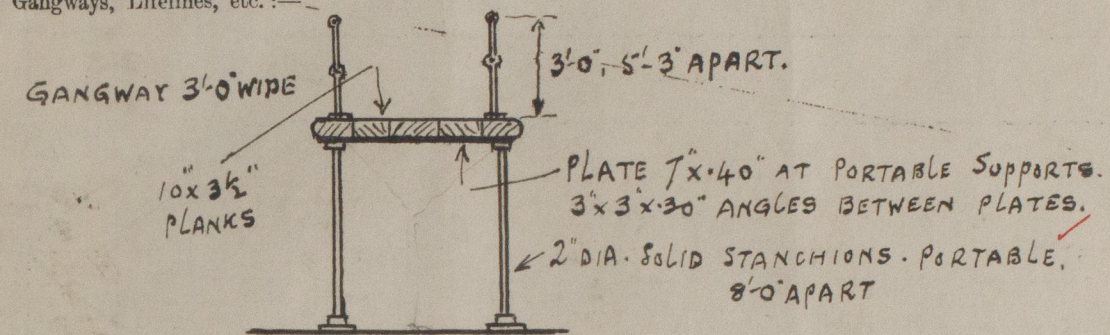

THIS GANGWAY FROM BRIDGE
DECK TO FO'CLE DECK OVER
FORE WELL PORTS SIDE ONLY.

SIMILAR GANGWAY FROM BRIDGE
DECK TO POOP DECK OVER AFT
WELL, PORT & STARBOARD SIDES.
GANGWAY IS PORTABLE.

Particulars of Freeing Arrangements.

	Length of Bulwark	Height of Bulwark	Size of Freeing Ports	Number each side	Area each side	Rule area each side
After Well	40'-2"	3'-8"	3'-8" x 1'-6"	3	16.47	10.52
Forward Well	28'-2"	3'-8"	2'-10" x 1'-6"	2	8.64	9.00

BOGE END

BOGE FRONT

12" ABOVE DECK

OPEN PORTS WITH BAR DIVISION.

State position of each freeing port { After Well :—
(F. and A. position and height above deck edge) { Forward Well :—

State whether the freeing ports are fitted with shutters, bars, or rails, and give particulars of such :—

Additional area where sheer is less than standard.

Particulars of Superstructures, Trunks, Casings, Deckhouses.

	Coaming	Plating	Stiffeners	Spacing	End Attachments of Stiffeners	Size of Openings	Height of Sills	Height of Casings
Poop Bulkhead	40"	36"	6x3x360A	30"	LUGS TOP & BOTTOM	4'10"x3'6"	20"	7'0"
Raised Quarter Deck Bulkhead ...	-	-	-	-	-	3-STEEL DOORS 5'x2'	18"	-
Bridge, After Bulkhead	NONE	30"	3x3x300A	30"	NONE	2@5'-0"x3'-6"	24"	7'-0"
Bridge, Forward Bulkhead	48"	40"	8x3 1/2 x 40"	30"	BRACKETS	4'-0"x3'-0"	21"	7'-0"
Forecastle Bulkhead	NONE	25"	3x3x30"	30"	NONE	4'-6"x22" 4'-6"x24"	19"	7'-0"
Trunk, Aft	-	-	-	-	-	-	-	-
Trunk, Forward	-	-	-	-	-	-	-	-
Exposed Machinery Casings on Free- board or Raised Quarter Decks ...	-	-	-	-	-	-	-	-
Exposed Machinery Casings on Super- structure Decks	35"	30"	3'x3x30"	39"	BRACKETS TOP	3-STEEL DOORS 4'x2' WOOD DOORS 4'x2'x2'	24" 19"	7'-0"
Machinery Casings within Superstruc- tures not fitted with Class I Closing Appliances	35"	32	3 1/2 x 3 x 40	50"	BRACKETS TOP LOW	2 DOOR CASES 4'-1"x2'-11" 4'-1"x2'-11"	20" 20"	7'-0"
Deckhouses on Flush Deck Ships ...	-	-	-	-	-	-	-	-

Particulars of Closing Appliances (state if capable of being manipulated from both sides).

Poop Bulkhead	3" Wood Boards full height in riveted channels. - 1" Ripe C/I (inside)
Raised Quarter Deck Bulkhead	25-1-46
Bridge, After Bulkhead	...	3" Wood Boards full height in riveted channels. { 2- steel doors hinged, manipulated both sides.	
Bridge, Forward Bulkhead	...	Steel hinged W.T. door, manipulated outside only. from both sides.	
Forecastle Bulkhead	...	Strong Wood hinged doors, manipulated both sides.	
Exposed Machinery Casings on Freeboard of Raised Quarter Decks	
Exposed Machinery Casings on Superstructure Decks	
Machinery Casings within Superstructures not fitted with Class I Closing Appliances	Steel & Wood hinged doors, manipulated both sides. Hinged steel doors, operated both sides
Doors on Flush Deck Ships	

Superstructure bulkheads, trunks, deckhouses, casings, cargo and coaling hatchways, extent and thickness of sheathing on the freeboard deck, gangway, cargo and coaling ports, and any other openings, etc., which would affect the seaworthiness of the ship are to be shewn on the following sketches:—

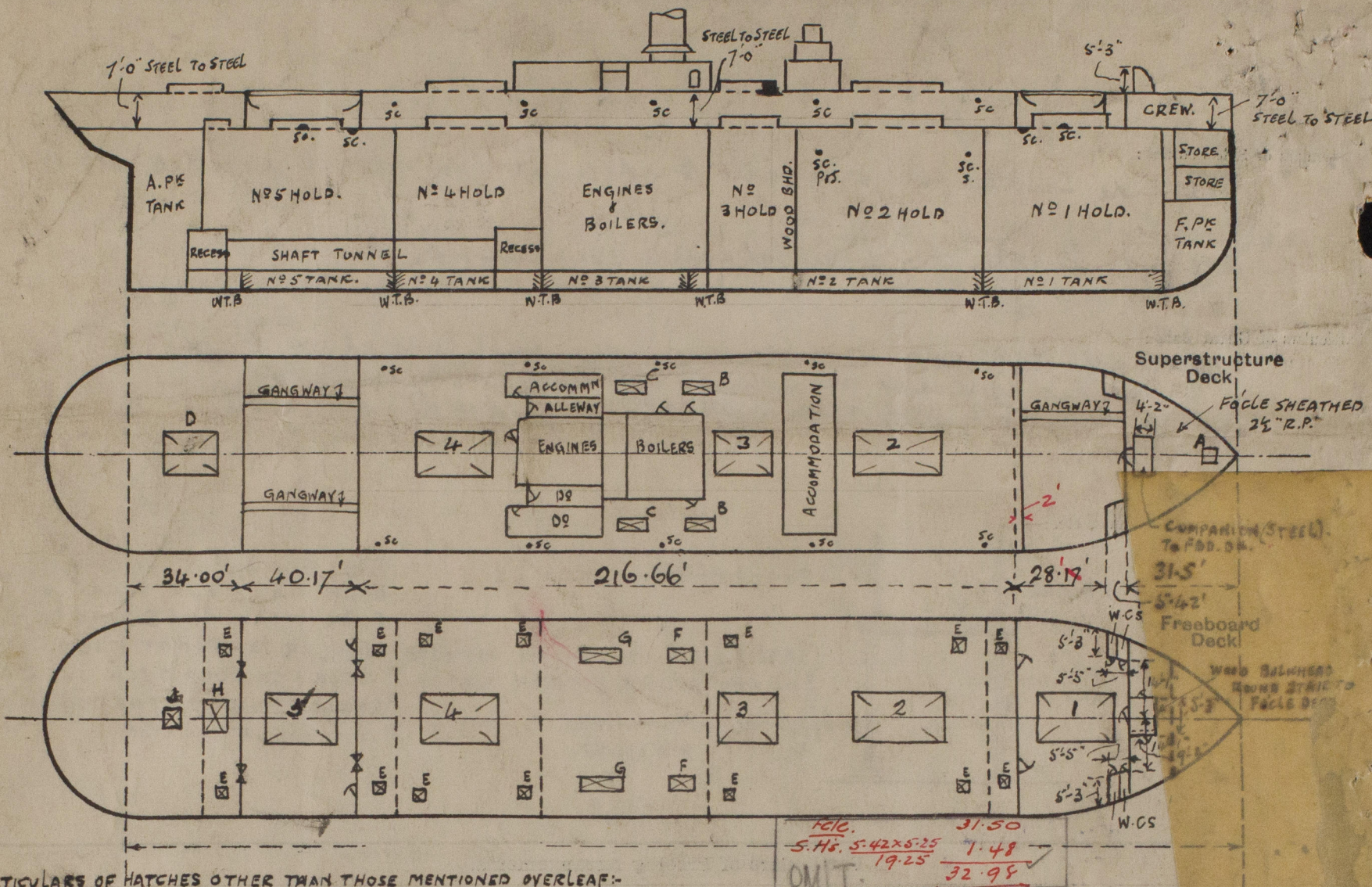

DETAILS OF TRIMMING HATCHES E.

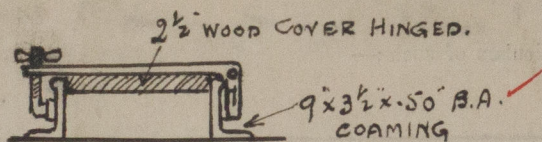
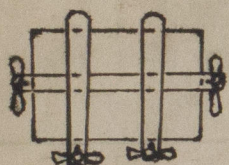

NOTE:- SCUPPERS FROM BRIDGE DECK ARE OPEN AT SHIP'S SIDE

NOTE Doors direct to ENGINES & BOILERS FROM BRIDGE DECK ARE OF STEEL.

NOTE: UPPER DECK HATCHES IN BRIDGE SPACE ARE SAME DIMENSIONS AS BRIDGE DECK HATCHES. COAMINGS 12' x 3 1/2" x 42" - 40" B.A. WEBS: NO 2, 5-SPACED 4'-4" - 16" x 35". D.A. 4' x 3' x 44". NO 3, 3- " 4'-0 1/2" - 17" x 35". " 4' x 3' x 44". NO 4, 4- " 4'-8 1/2" - 16" x 35". " 4' x 3' x 44". ALL FITTED WITH CLEATS, BATTENS & TARPAULINS IN GOOD CONDITION. 2 1/2 WOOD COVERS.

Builder's name and yard number

Kress & John Blumer Co. Ltd. No 258.

Names of sister ships

Owners

Stag Line Ltd. OMIT

Fee £ 11 : 18 : 0

Received by me



© 2020 Lloyd's Register Foundation