

# WIRECK SECTION

## Lloyd's Register of Shipping

### SURVEYS FOR FREEBOARD.

(CONDITIONS OF ASSIGNMENT.) REPORT N° 2955

Ship's Name "EMPIRE PRIZE" (EX "CELELIA CAMPANELLA") Port of Survey PORT SAID.  
 Official Number 149881 Surveyor's Signature H. Y. Mathison.  
 Nationality and Port of Registry BRITISH, LONDON. Date of Survey JULY - AUGUST 1943

Disposition and dimensions of superstructures, trunks, deckhouses and machinery casings to be inserted in the diagrams and tabular statement:—

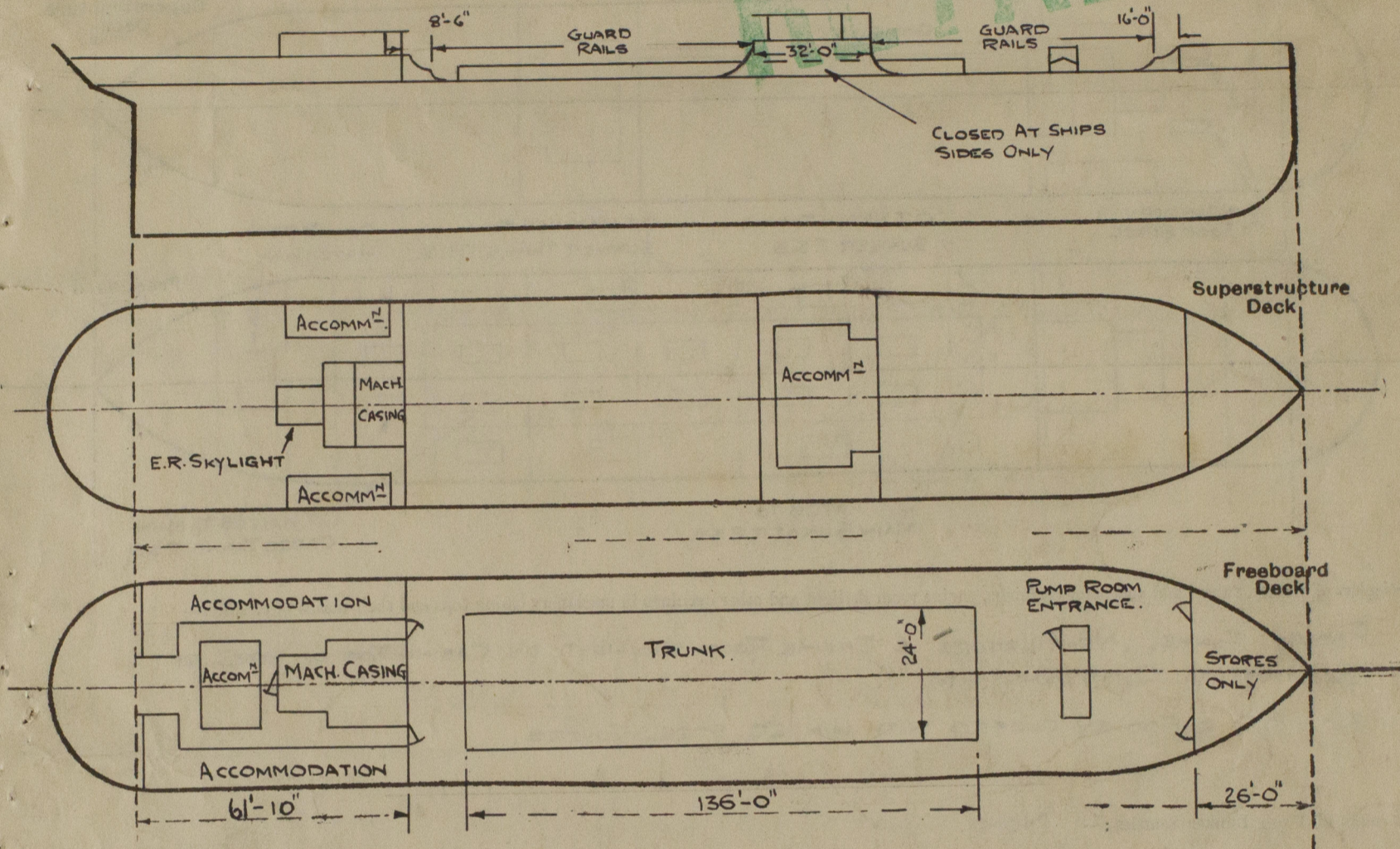

Particulars of Superstructures, Trunks, Casings, Deckhouses.

	Coaming	Plating	Stiffeners	Spacing	End Attachments of Stiffeners	Size of Openings	Height of Sills	Height of Casings
Poop Bulkhead ...	.45"	.40"	8"x3 1/2"x.45"	30"	BKTS. TOP + BOT.	4'-10" x 2'-0"	18"	7'-6"
Raised Quarter Deck Bulkhead ...	✓							
Bridge, After Bulkhead ...	✓							
Bridge, Forward Bulkhead ...	✓							
Forecastle Bulkhead ...	.45"	.40"	3 1/2"x3 1/2"x.40"	30"	NIL	5'-2" x 2'-6"	15"	7'-6"
Trunk, <del>the</del> ...	.40"	.40"	.40" BKTS.	30"	LUGS ON DECK	✓	✓	24"
<del>Trunk, Forward</del> PUMP ROOM ENTRANCE ...	.50"	.40"	3 1/2"x3 1/2"x.40" HORIZONTAL DOUBLE ANGLES AROUND CASING 24" ABOVE MAIN DECK			4'-3" x 2'-0"	24"	6'-3"
Exposed Machinery Casings on Freeboard or Raised Quarter Decks ...	SEE POOP BULKHEAD.							
Exposed Machinery Casings on Superstructure Decks ...	.45"	.40"	4"x3"x.40"	30"	BKTS. TOP	NONE	✓	6'-9"
Machinery Casings within Superstructures not fitted with Class I Closing Appliances ...	✓							
Deckhouses on Flush Deck Ships ...	✓							

Particulars of Closing Appliances (state if capable of being manipulated from both sides).

Poop Bulkhead ...	W.T. HINGED STEEL DOORS, CAPABLE OF MANIPULATION BOTH SIDES. ✓
PUMP ROOM ENTRANCE ...	W.T. HINGED STEEL DOOR, CAPABLE OF MANIPULATION BOTH SIDES. ✓
Bridge, After Bulkhead ...	✓
Bridge, Forward Bulkhead ...	✓
Forecastle Bulkhead ...	W.T. HINGED STEEL DOORS, CAPABLE OF MANIPULATION OUTSIDE ONLY. ✓
Exposed Machinery Casings on Freeboard or Raised Quarter Decks ...	SEE POOP BULKHEAD. ✓
Exposed Machinery Casings on Superstructure Decks ...	✓
Machinery Casings within Superstructures not fitted with Class I Closing Appliances ...	✓
Deckhouses on Flush Deck Ships ...	✓

PARTICULARS OF PROTECTION TO OPENINGS, ETC.

The following diagrams should be used to indicate the positions of cargo and coaling hatchways, gangway, cargo and coaling ports, ventilators, companionways, etc., which would affect the seaworthiness of the ship:—

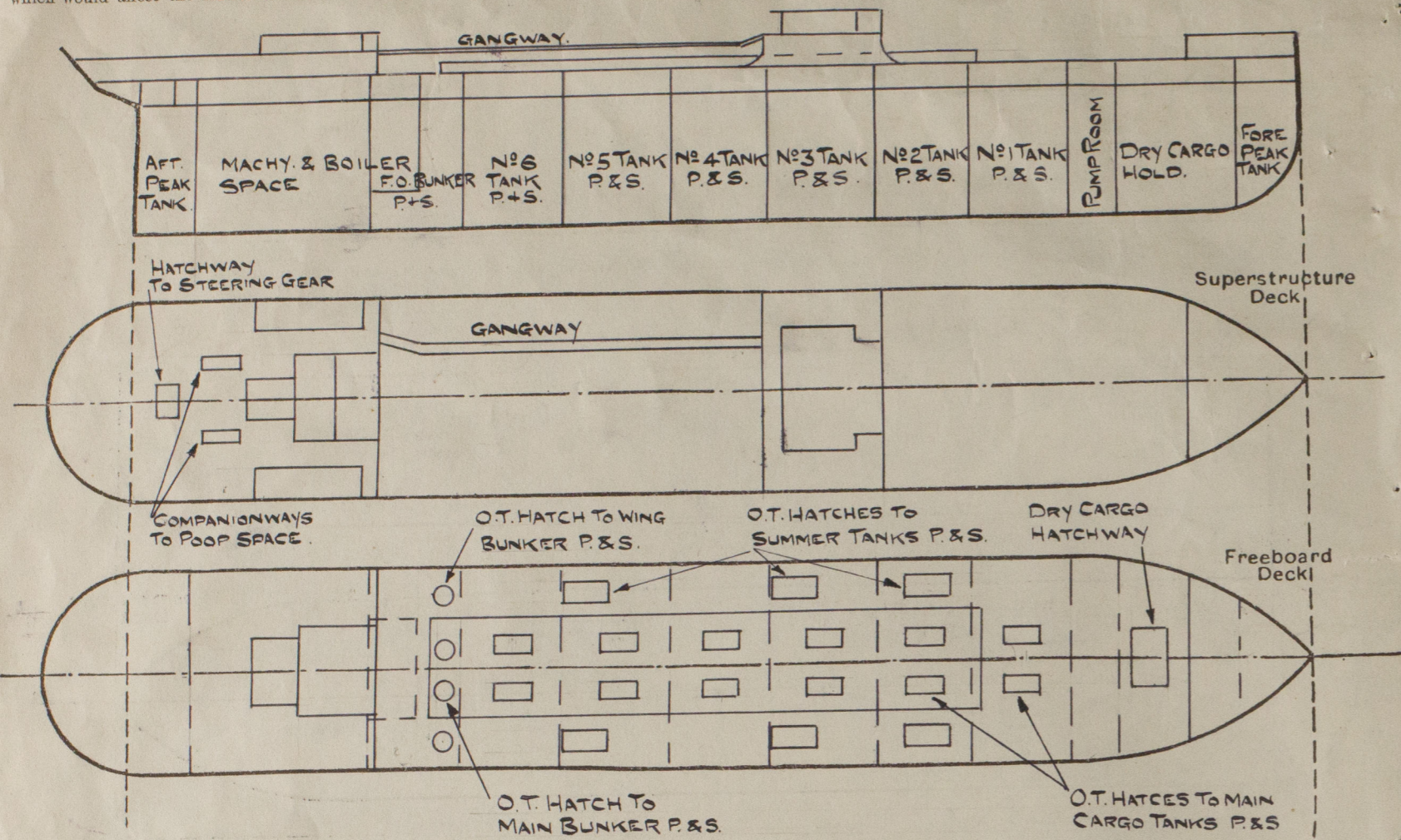

Particulars of fiddley, funnel and ventilator coamings, engine room skylight and other openings in machinery casing tops and their means of closing :—

FIDDLEY, FUNNEL, VENTILATORS & ENGINE ROOM SKYLIGHT ON CASING TOP OF STEEL OF SUBSTANTIAL CONSTRUCTION. ✓ ✓

SKYLIGHT & FIDOLEY CLOSED WITH HINGED STEEL COVERS.

Particulars of Flush Bunker Scuttles:— NONE.

Particulars of Companionways:— Two COMPANIONWAYS ON POOP DECK LEADING TO POOP SPACE  
6'-6" x 3'-0" x 3'-3" HIGH OF 1" THICK HARD WOOD. STRONG WOOD DOORS MANIPULATED FROM  
BOTH SIDES AND STRONG WOOD SLIDING TOP. DOORWAY SILL 18" IN HEIGHT. ✓

Particulars of Ventilators in exposed positions on freeboard and superstructure decks :—

ON FREE<sup>BD</sup> DECK:- 2- 18" DIA., COAMING 36" x .35" TO PUMP ROOM. ✓  
1- 24" DIA., COAMING 36" x .35" TO FORE HOLD. ✓  
1- 18" DIA., COAMING 72" x .45" TO BOILER SPACE, SPECIALLY SUPPORTED & SECURED.

ON POOP DECK:-

1- 51" DIA.,	COAMING	60" X .40"	TO MACHY. SPACE	"	"	"	✓
1- 24" DIA.,	COAMING	60" X .40"	" " "	"	"	"	
1- 18" DIA.,	COAMING	60" X .40"	" " "	"	"	"	
1- 10" DIA.,	COAMING	18" X .30"	TO MACHY. SPACE	✓			
6- 7" DIA.,	COAMING	12" X .45"	TO POOP SPACE				
2- 6" DIA.,	COAMING	18" X .30"	" " "				

ON FORECASTLE DECK: -

- 1- 24" DIA., COAMING 33" x .35" To DRY CARGO HOLD.
- 2- 11" DIA., COAMING 36" x .40" To FORECASTLE SPACE. ✓
- 1- 6" DIA., COAMING 36" x .30" To FORECASTLE SPACE.

ALL VENTILATORS FITTED WITH WOOD PLUGS AND CANVAS COVERS

Particulars of Air Pipes in exposed positions on freeboard, ~~raised quarter~~, or superstructure decks:—

ON FREE <sup>RD</sup> DECK:- 8-6" DIA., 36" IN HEIGHT TO SUMMER TANKS.  
2-6" DIA., 87" IN HEIGHT TO WING BUNKERS, SPECIALLY SUPPORTED & SECURED.

ON TRUNK TOP:- 2 - 6" DIA., 24" IN HEIGHT TO MAIN BUNKERS.

ON POOP DECK:- 1 - 3" DIA., 18" IN HEIGHT TO AFT PEAK TANK  
1 - 3" DIA., 18" IN HEIGHT TO DOMESTIC F.W. TANK.

ON FORECASTLE DECK - 1 - 4" DIA., 12" IN HEIGHT TO FORE PEAK TANK WITH HINGED C.I. COVER & SCREW FASTENING.

ALL AIR PIPES (EXCEPT FORE PEAK) FITTED WITH GAUZE & HINGED COVERS OR WOOD PLUGS & CANVAS COVERS.

Particulars of Gangway Cargo and Coaling Ports:— NONE

Particulars of Scuppers and Sanitary Discharge Pipes :—

ALL SCUPPERS FROM FREE<sup>BD</sup> DECK CUT IN SHEER STRAKE AT TOP ✓  
ALL SCUPPERS FROM POOP SPACE DISCHARGING 12" BELOW FREE<sup>BD</sup> DECK FITTED WITH G.M. NON RETURN VALVES  
AT SHIP'S SIDE. ✓

ALL SANITARY DISCHARGES FROM ACCOMMODATION SPACES AMIDSHIPS & POOP FITTED WITH G.M. NONRETURN VALVES AT SHIPS SIDE. ✓

Particulars of Side Scuttles :—

POOP :- 10" DIA. OF SUBSTANTIAL CONSTRUCTION, FITTED WITH STRONG HINGED DEADLIGHTS.  
FORECASTLE :- 10" DIA " " " " " " " " "

Vertical distance of Sill of lowest Side Scuttle above top of keel..... 33'-7"

Particulars of Guard Rails :—

Particulars of Guard Rails :-  
**FREE<sup>RD</sup> DECK** :- 3'-6" IN HEIGHT, STANCHIONS 4'-0" APART, STEEL RAIL ON TOP & TWO STEEL WIRE ROPES BELOW.

POOP DECK:- 3-0" " " , " " " , " " "  
FORECASTLE DK. 3-6" " " , " " " , 3 STEEL CHAINS

Particulars of Gangways, Lifelines, etc. :—

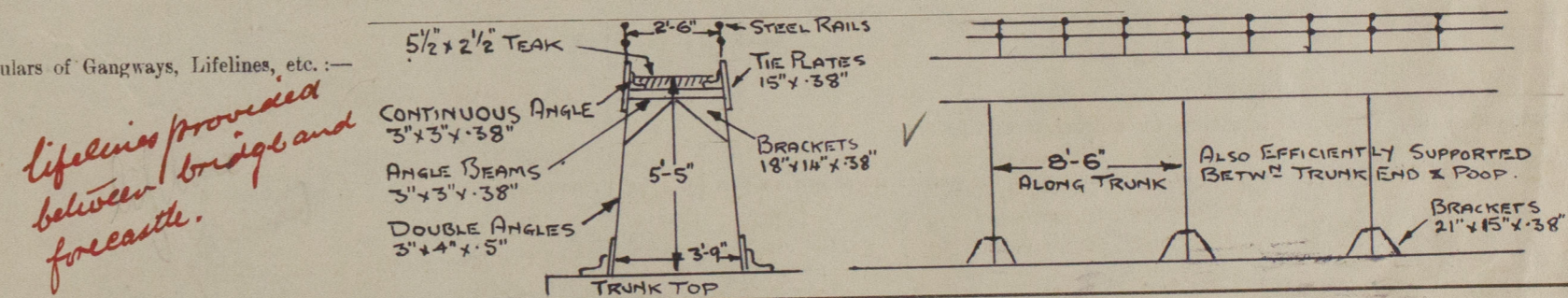

lifelines provided  
between bridge and  
forecastle.

**Particulars of Freeing Arrangements.**

	Length of Bulwark	Height of Bulwark	Size of Freeing Ports	Number each side	Area each side	Rule area each side
After Well ... ..	}	No FREEING PORTS ✓				
Forward Well ... ..						

State position of each freeing port ... .. { After Well :— ✓

(F. and A. position and height above deck edge) { Forward Well :— ✓

State whether the freeing ports are fitted with shutters, bars, or rails, and give particulars of such :— ✓

Additional area where sheer is less than standard. ✓

© 2020  
 Lloyd's Register  
 Foundation

# PARTICULARS OF PROTECTION TO OPENINGS, ETC.

HATCHWAYS ON FREEBOARD AND SUPERSTRUCTURE DECKS.									
Description of Hatchway To:-	DRY CARGO HATCH ON UPPER DK.	MAIN CARGO TANKS ON UPPER DK.	WING BUNKERS ON UPPER DK.	MAIN CARGO TANKS ON TRUNK TOP.	MAIN BUNKERS ON TRUNK TOP.	STEERING SPACE ON POOP DK.			
Dimensions of Hatchway	7'-6" x 14'-0"	3'-2" x 6'-2"	TWO 2 1/2" DIA	3'-2" x 6'-2"	TWO 2 1/2" DIA	3'-10" x 3'-10"			
COAMINGS	Height above Deck	24"	24"	6" x 3" x 3/8"	6" ABOVE TRUNK TOP	21"			
	Thickness	.45"	.45"	ANGLE	.40"	.40"			
	Stiffeners	3 1/2" x 3 1/2" x 4 1/2"	3 1/2" x 3 1/2" x 4 1/2"	ANGLE	✓	3" O BAR AROUND TOP			
	Brackets, Stays	AROUND TOP	AROUND TOP	✓	✓	✓			
HATCH BEAMS	Number	ONE	NONE	✓	✓	✓			
	Spacing	3 1/2" x 10" x 45"							
FORE AND AFTERS	Number	NONE	NONE	✓	✓	✓			
	Spacing								
	Unsupported Lengths								
	Scantling and Sketch								
Bearing Surface									
HATCH COVERS	Material	STEEL	STEEL	STEEL	STEEL	STEEL	WOOD		
	Thickness	.45"	.40" STEEL	.40"	.40"	.40"	3"		
	How fitted	2-STIFFENERS	HINGED	HINGED	HINGED	HINGED	ATHW.		
	Bearing Surface	5" x 3" x 45" L.S.	OIL TIGHT	OIL TIGHT	OIL TIGHT	OIL TIGHT	3"		
Spacing of Cleats	BOLTS	19" SIDES	FIVE	19" SIDES	FIVE	24"			
Number of Tarpaulins	3 3/4" PITCH	21" ENDS	HINGED	21" ENDS	HINGED	THREE			
		SCREWS	SCREWS	SCREWS	SCREWS				

\*Are wood fore and afters steel shod at all bearing surfaces? ☒ YES  
 Are battens and wedges efficient and in good condition? ☒ YES  
 Are tarpaulins in good condition and in accordance with rule requirements? ☒ YES  
 Are lashings provided in accordance with rule requirements? ☒ YES

Particulars of any special features:- SUMMER TANK HATCHWAYS. DIMENSIONS:- 8'-6" x 4'-0" x 24" HEIGHT OF COAMING, SIDES & ENDS .45" THICK. ✓ THE TOP OF THE HATCHWAYS ARE CLOSED WITH .45" THICK STEEL PLATE, ADEQUATELY STIFFENED & RIVETED OIL TIGHT TO 3 1/2" x 3 1/2" x .40" ANGLE FASTENED AROUND THE TOP OF THE COAMING INSIDE. ✓ ONE MANHOLE 16" x 12" AND ONE OPENING FOR WINDSHUTE 30" DIA. ARE CUT THRO' THE TOP PLATE AND CLOSED OIL TIGHT WITH .5" THICK STEEL COVERS, WELL STIFFENED AND SECURED WITH STEEL STUDS & NUTS SCREWED THRO' THE TOP PLATE WITH NUTS ON THE UNDER SIDE. ✓

## PUMP ROOM ENTRANCE

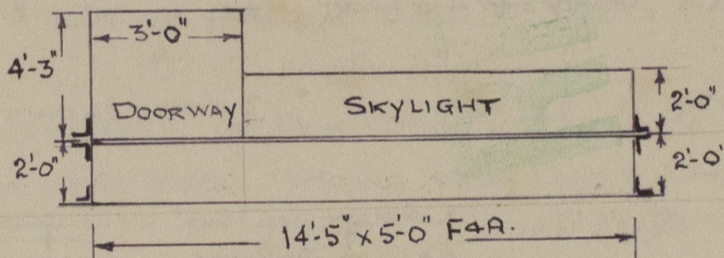

SKYLIGHT CLOSED WITH STRONG HINGED WEATHER TIGHT STEEL COVERS.

Endorsement at first survey and at surveys for renewal of Certificate:-

The fittings and appliances are in accordance with the particulars shown on this form (or as now modified) and are in good condition.