

Lloyd's Register of Shipping.

SURVEYS FOR FREEBOARD.

(CONDITIONS OF ASSIGNMENT.) REPORT N° 2955

Ship's Name "EMPIRE PRIZE" (EX "LELIA CAMPANELLA") Port of Survey PORT SAID.
 Official Number 149881 Surveyor's Signature *H. J. Mathison*
 Nationality and Port of Registry BRITISH, LONDON. Date of Survey JULY - AUGUST 1943

Disposition and dimensions of superstructures, trunks, deckhouses and machinery casings to be inserted in the diagrams and tabular statement:—

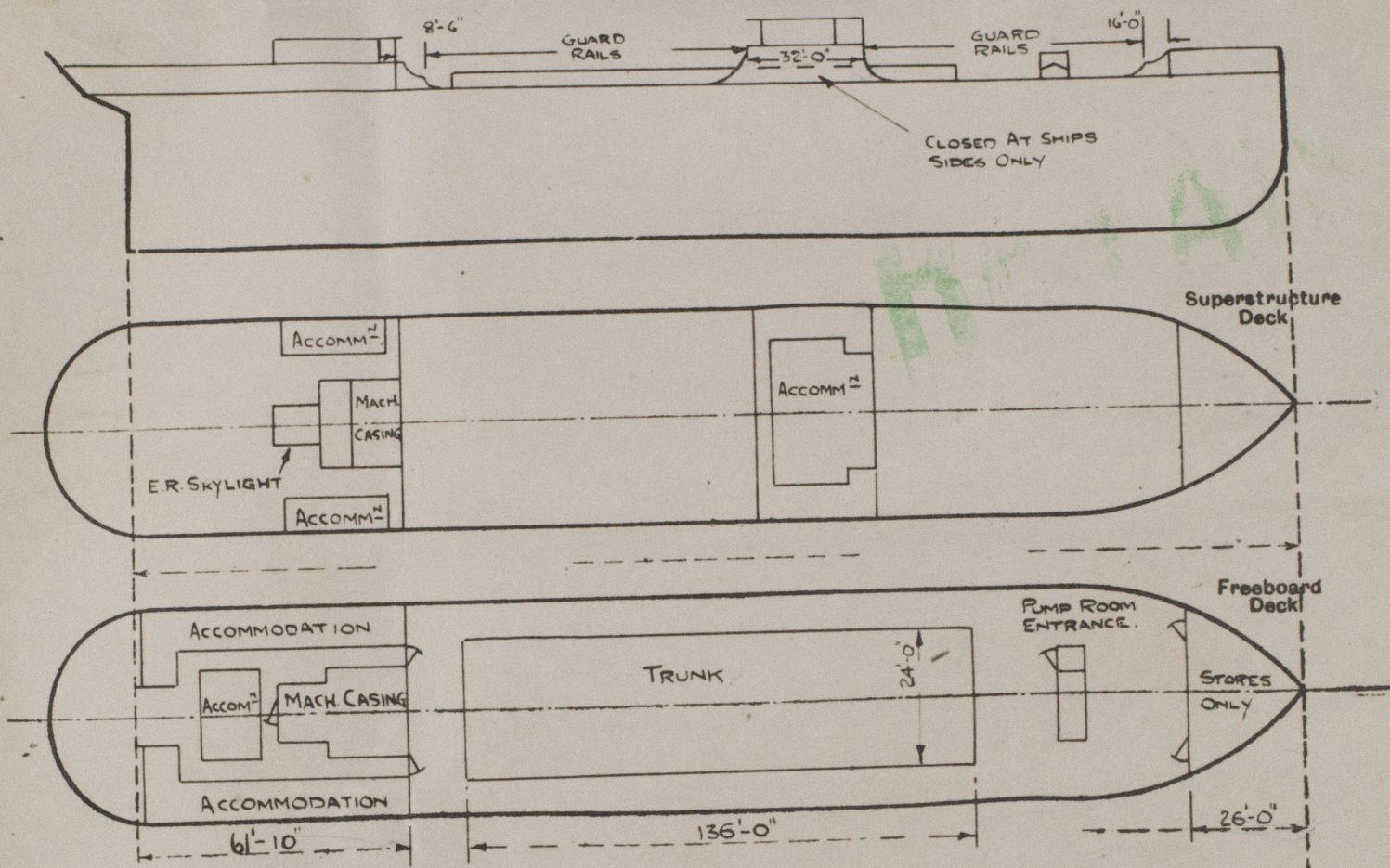

Particulars of Superstructures, Trunks, Casings, Deckhouses.

	Coaming	Plating	Stiffeners	Spacing	End Attachments of Stiffeners	Size of Openings	Height of Sills	Height of Casings
Poop Bulkhead45"	.40"	8"x3 1/2"x.45"	30"	BKTS. TOP + BOT.	4'-10" x 2'-0"	18"	7'-6" ✓
Raised Quarter Deck Bulkhead ...	✓							
Bridge, After Bulkhead ...	✓							
Bridge, Forward Bulkhead ...	✓							
Forecastle Bulkhead45"	.40"	3 1/2"x3 1/2"x.40"	30"	NIL	5'-2" x 2'-6"	15"	7'-6" ✓
Trunk, the40"	.40"	.40" BKTS.	30"	LUGS ON DECK	✓	✓	24" ✓
Trunk, Forward PUMP ROOM ENTRANCE50"	.40"	3 1/2"x3 1/2"x.40" HORIZONTAL DOUBLE ANGLES AROUND CASING 24" ABOVE MAIN DECK	24"		4'-3" x 2'-0"	24"	6'-3" ✓
Exposed Machinery Casings on Freeboard or Raised Quarter Decks ...	SEE POOP BULKHEAD							
Exposed Machinery Casings on Superstructure Decks45"	.40"	4"x3"x.40"	30"	BKTS. TOP	NONE	✓	6'-9" ✓
Machinery Casings within Superstructures not fitted with Class I Closing Appliances ...	✓							
Deckhouses on Flush Deck Ships ...	✓							

Particulars of Closing Appliances (state if capable of being manipulated from both sides).

Poop Bulkhead ...	W.T. HINGED STEEL DOORS, CAPABLE OF MANIPULATION BOTH SIDES. ✓
PUMP ROOM ENTRANCE	W.T. HINGED STEEL DOOR, CAPABLE OF MANIPULATION BOTH SIDES. ✓
Bridge, After Bulkhead ...	✓
Bridge, Forward Bulkhead ...	✓
Forecastle Bulkhead ...	W.T. HINGED STEEL DOORS, CAPABLE OF MANIPULATION OUTSIDE ONLY. ✓
Exposed Machinery Casings on Freeboard or Raised Quarter Decks ...	SEE POOP BULKHEAD. ✓
Exposed Machinery Casings on Superstructure Decks ...	✓
Machinery Casings within Superstructures not fitted with Class I Closing Appliances ...	✓
Deckhouses on Flush Deck Ships ...	✓

"EMPIRE PRIZE."

Particulars of Gangway Cargo and Coaling Ports:— NONE. ✓

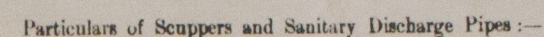

Particulars of Side Scuttles :—

Particulars of fiddley, funnel and ventilator coamings, engine room skylight and other openings in machinery casing tops and their means of closing :—

Particulars of Flush Bunker Scuttles:— NONE.

Particulars of Ventilators in exposed positions on freeboard and superstructure decks :—

ALL VENTILATORS FITTED WITH WOOD PLUGS AND CANVAS COVERS

Particulars of Air Pipes in exposed positions on freeboard, raised quarter, or superstructure decks :—

ON TRUNK TOP:- 2 - 6" DIA., 24" IN HEIGHT TO MAIN BUNKERS.

ON FORECASTLE DECK: 1- 4" DIA., 12" IN HEIGHT TO FORE PEAK TANK, WITH HINGED C.I. COVER & SCREW FASTENING.

ALL AIR PIPES (EXCEPT FORE PEAK) FITTED WITH GAUZE & HINGED COVERS OR WOOD PLUGS & CANVAS COVERS.

Particulars of Guard Rails :—

Particulars of Gangways, Lifelines, etc. :—

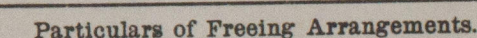

State position of each freeing port	(After Well :— ✓
(F. and A. position and height above deck edge)		(Forward Well :— ✓

State whether the freeing ports are fitted with shutters, bars, or rails, and give particulars of such:— ✓

Additional area where sheer is less than standard. ✓

PARTICULARS OF PROTECTION TO OPENINGS, ETC.

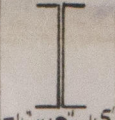
HATCHWAYS ON FREEBOARD AND SUPERSTRUCTURE DECKS.									
Description of Hatchway To:-		DRY CARGO HATCH ON UPPER DK.	MAIN CARGO TANKS ON UPPER DK.	WING BUNKERS ON UPPER DK.	MAIN CARGO TANKS ON TRUNK TOP	MAIN BUNKERS ON TRUNK TOP	STEERING SPACE ON POOP DK.		
Dimensions of Hatchway		7'-6" x 14'-0"	3'-2" x 6'-2"	TWO 2 1/2" DIA	3'-2" x 6'-2"	TWO 2 1/2" DIA	3'-10" x 3'-10"		
COAMINGS	Height above Deck	24"	24"		6" ABOVE TRUNK TOP	6" ABOVE TRUNK TOP	21"		
	Thickness	.45"	.45"	6" x 3" x 3/8" ANGLE	.40"	6" x 3" x 3/8" ANGLE	.40"		
	Sides Ends	3 1/2" x 3 1/2" x 4 1/2"	3 1/2" x 3 1/2" x 4 1/2"		✓	✓	3" O BAR AROUND TOP		
	Stiffeners	AROUND TOP	AROUND TOP		✓	✓	✓		
HATCH BEAMS	Number	ONE	NONE	✓	✓	✓	✓		
	Spacing	3'-0"							
	Scantling and Sketch								
FORE AND AFTERS	Number	NONE	NONE	✓	✓	✓	✓		
	Spacing								
	Unsupported Lengths								
	Scantling and Sketch								
HATCH COVERS	Material	STEEL	STEEL	STEEL	STEEL	STEEL	WOOD		
	Thickness	.45"	.40" STIFF	.40"	.40"	.40"	3"		
	How fitted	2-STIFFENED	WINGED	HINGED	STIFFENED HINGED	HINGED	ATHW.		
	Bearing Surface	5" x 3 1/2" x 4 1/2"	OIL TIGHT	OIL TIGHT	OIL TIGHT	OIL TIGHT	3"		
Spacing of Cleats		BOLTS	1 1/2" SIDES 2 1/2" ENDS	FIVE HINGED	1 1/2" SIDES 2 1/2" ENDS	FIVE HINGED	2 1/2"		
Number of Tarpaulins		3 3/4 PITCH	HINGED SCREWS	SCREWS	HINGED SCREWS	SCREWS	THREE		

*Are wood fore and afters steel shod at all bearing surfaces? ✓
 Are battens and wedges efficient and in good condition? YES
 Are tarpaulins in good condition and in accordance with rule requirements? YES
 Are lashings provided in accordance with rule requirements? ✓

Particulars of any special features:- SUMMER TANK HATCHWAYS DIMENSIONS - 8'-6" x 4'-0" x 24" HEIGHT OF COAMING, SIDES & ENDS .45" THICK. ✓ THE TOP OF THE HATCHWAYS ARE CLOSED WITH .45" THICK STEEL PLATE, ADEQUATELY STIFFENED & RIVETED OIL TIGHT TO 3 1/2" x 3 1/2" x .40" ANGLE FASTENED AROUND THE TOP OF THE COAMING INSIDE. ✓ ONE MANHOLE 16" x 12" AND ONE OPENING FOR WINDSHUTE 30" DIA. ARE CUT THRO' THE TOP PLATE AND CLOSED OIL TIGHT WITH .5" THICK STEEL COVERS, WELL STIFFENED AND SECURED WITH STEEL STUDS & NUTS SCREWED THRO' THE TOP PLATE WITH NUTS ON THE UNDER SIDE. ✓

PUMP ROOM ENTRANCE

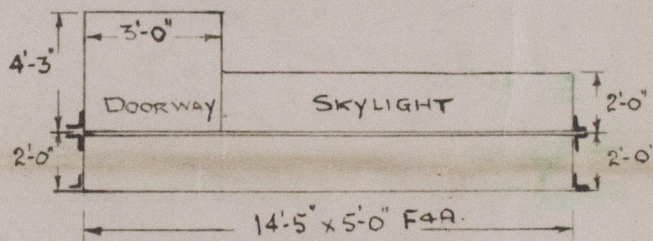

SKYLIGHT CLOSED WITH STRONG HINGED WEATHER TIGHT STEEL COVERS.

Endorsement at first survey and at surveys for renewal of Certificate:-

The fittings and appliances are in accordance with the particulars shown on this form (or as now modified) and are in good condition.