

6<sup>2</sup>  
New proposed  
plan

Scale  $\frac{1}{2}" = 1 \text{ foot}$

5' 0"

4' 6"

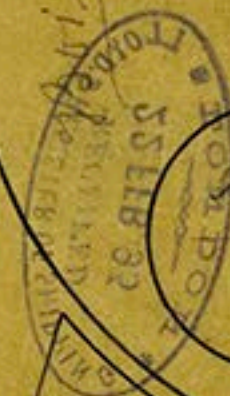

True place

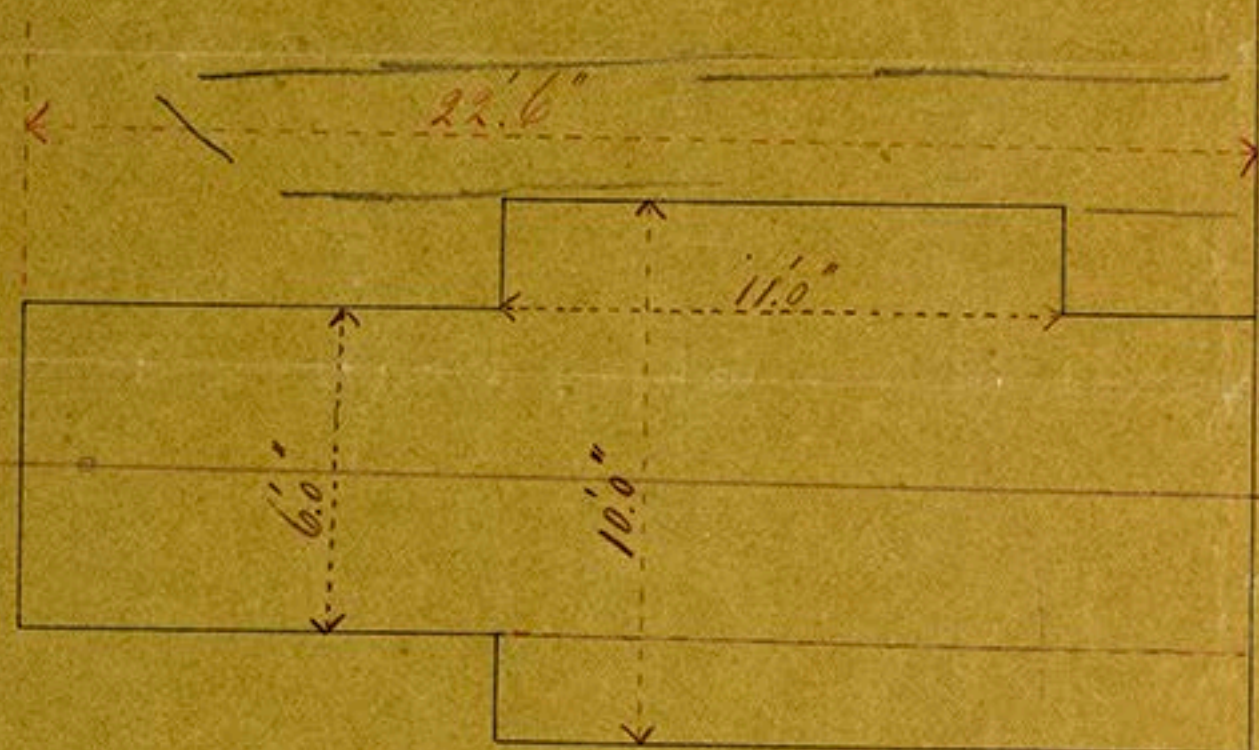

Scale  $\frac{1}{4}" = 1 \text{ foot}$

Approved modification by the  
Committee of Lloyd's Register



© 2018

Lloyd's Register  
Foundation



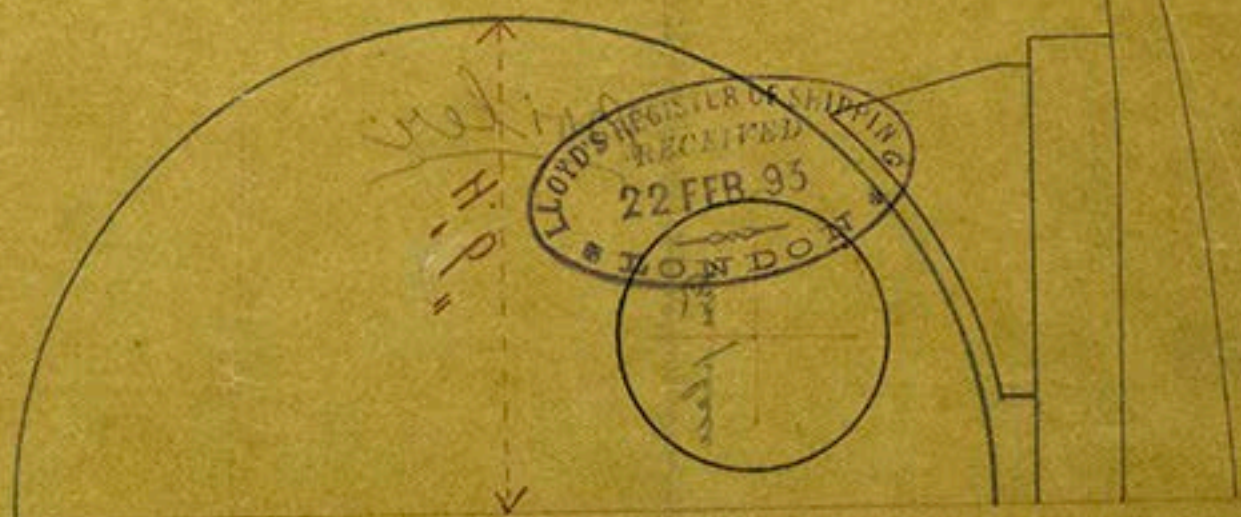
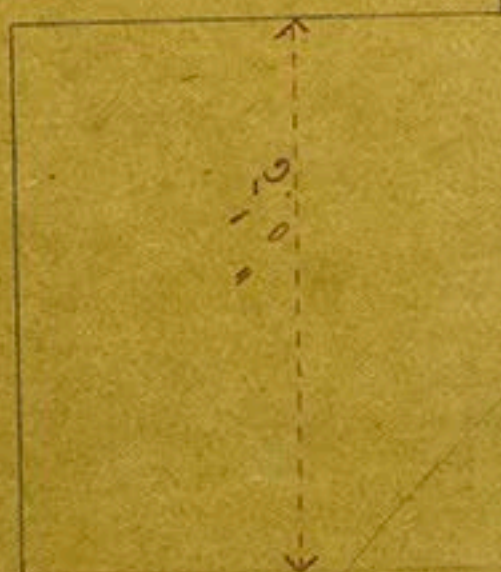

*Case 1/4 = 1/4*

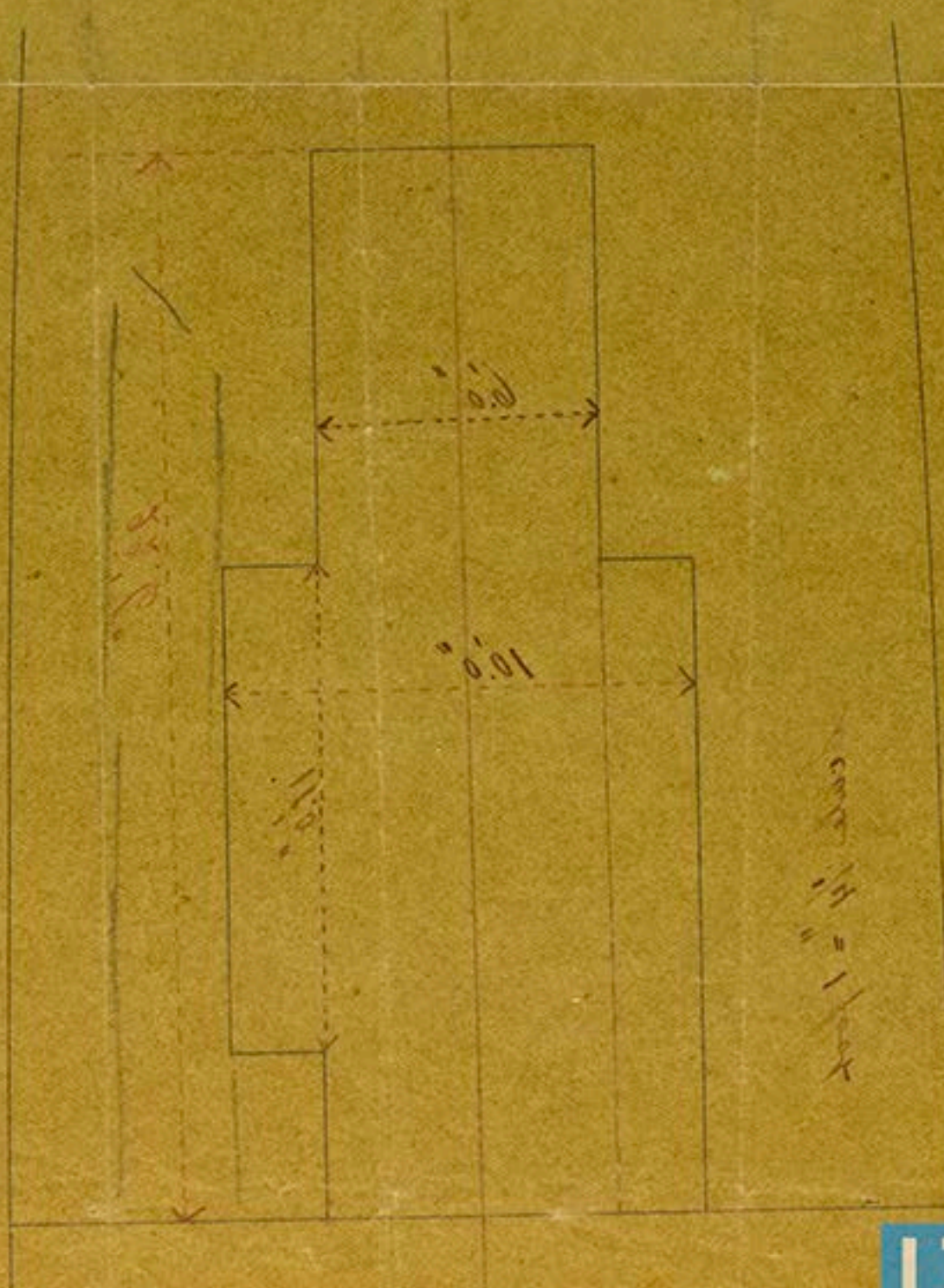

*Case 1/4 = 1/4*

*Handwritten notes and signatures on the right side of the page.*

