

15. 9. 92

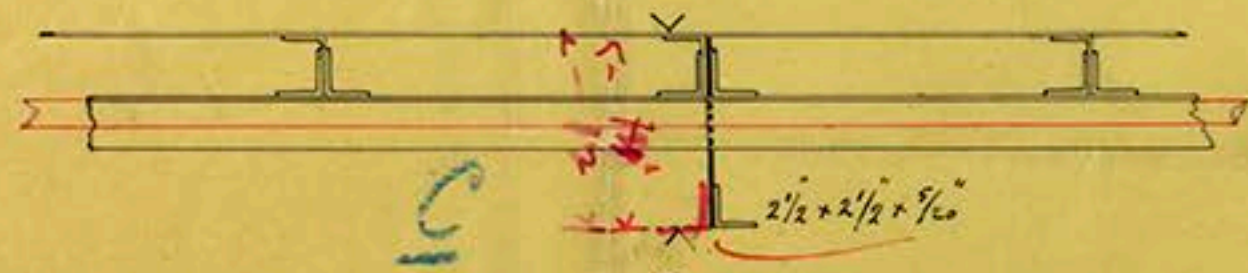

Viewerslaten 25/9  
Mulder.

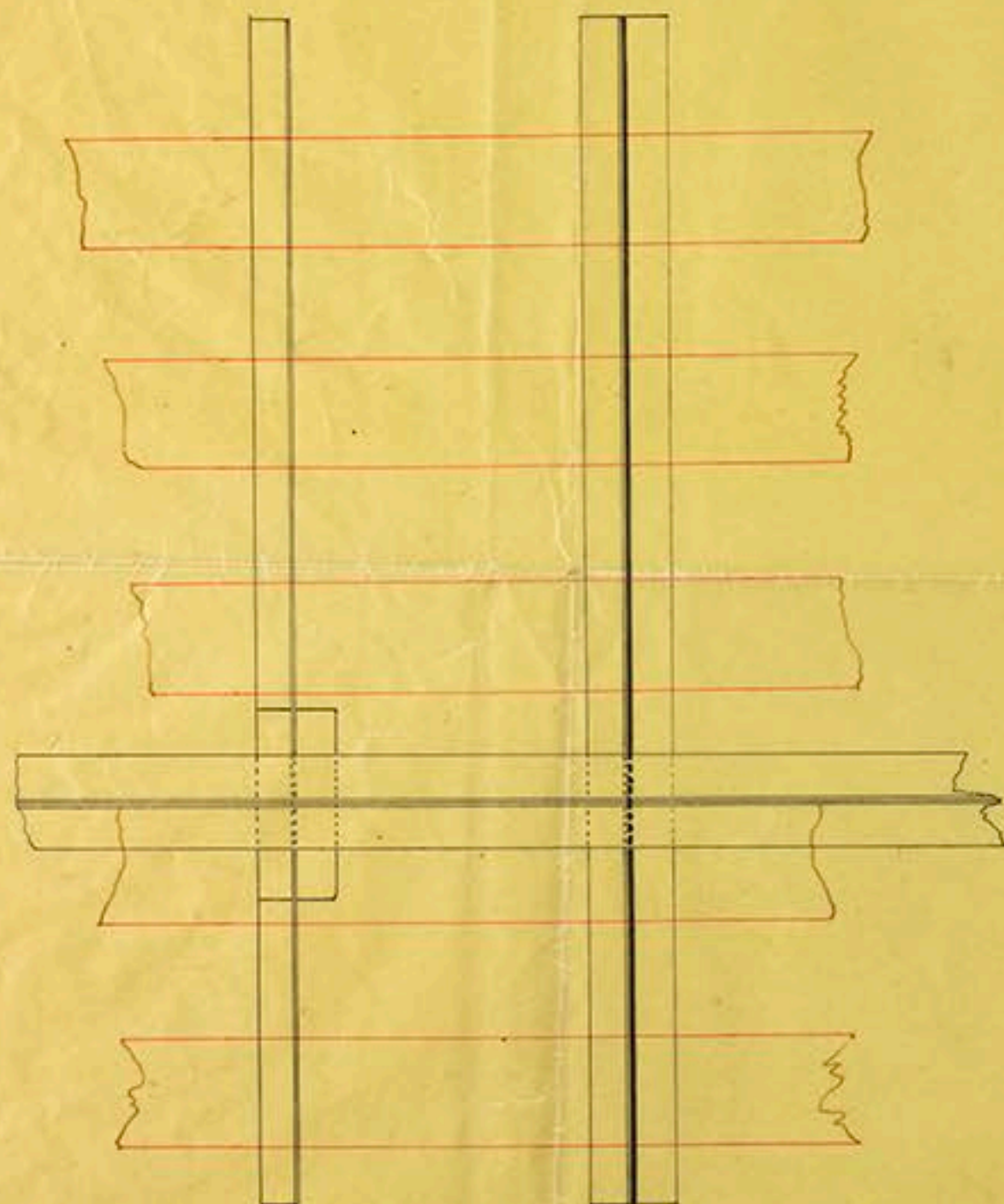
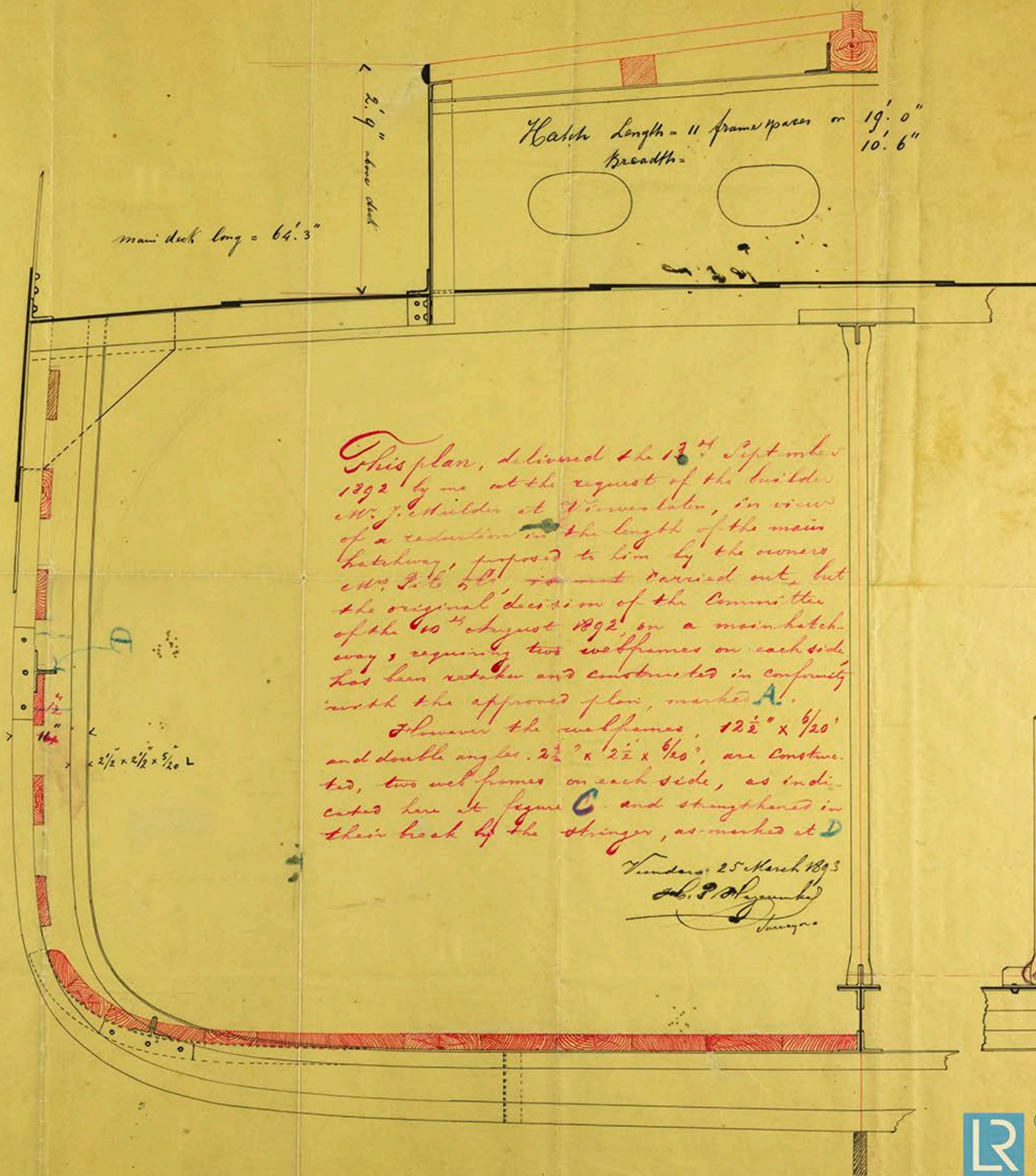

This plan, delivered the 13<sup>th</sup> September 1892 by me at the request of the builder Mr. J. Mulder at Viewerslaten, in view of a reduction in the length of the main hatchway, proposed to him by the owners Mr. J. L. H. & Co. was not carried out, but the original decision of the Committee of the 10<sup>th</sup> August 1892, on a main hatchway, requiring two webframes on each side, has been retaken and constructed in conformity with the approved plan, marked A.

However the webframes, 12 1/2" x 6/20' and double angles, 2 1/2" x 2 1/2" x 5/16", are constructed, two webframes on each side, as indicated here at figure C and strengthened in their back by the stringer, as marked at D.

Tenders 25 March 1893  
J. P. Mulder  
Tenders