



FRI 20 SEP 89  
MON 14 OCT 89  
FRI 21 FEB 90

MIDSHIP

SECTION

OF

A

STEEL TWIN SCREW STEAMER

FOR RIVER PURPOSES.

DIMENSIONS.

LENGTH 190.0  
BREADTH 28.6  
DEPTH MOULDED 8.6

SCALE  $\frac{1}{2}$  INCH = 1 FOOT.

No 122

1 Bronze Anchor 15 lb. each  
1 " " 7 "  
1 " " 2 1/2 "  
150 fms 1" shot chain cable  
60 " 1 1/2 "  
70 fms 7" bottom  
70 " 5" rope

30 August 89  
W.B.

30 August 89  
W.B.

For River purposes only



Handwritten notes in red ink on the left side of the drawing, including '10/20' and '1/20'.

double  
Rivets lapped  
1/20 PLATING  
Rivets lapped

For plate edge  
See opposite side

Trans No 1001



© 2019

Lloyd's Register  
Foundation

MR 391276



Midship Section  
Vbro 91

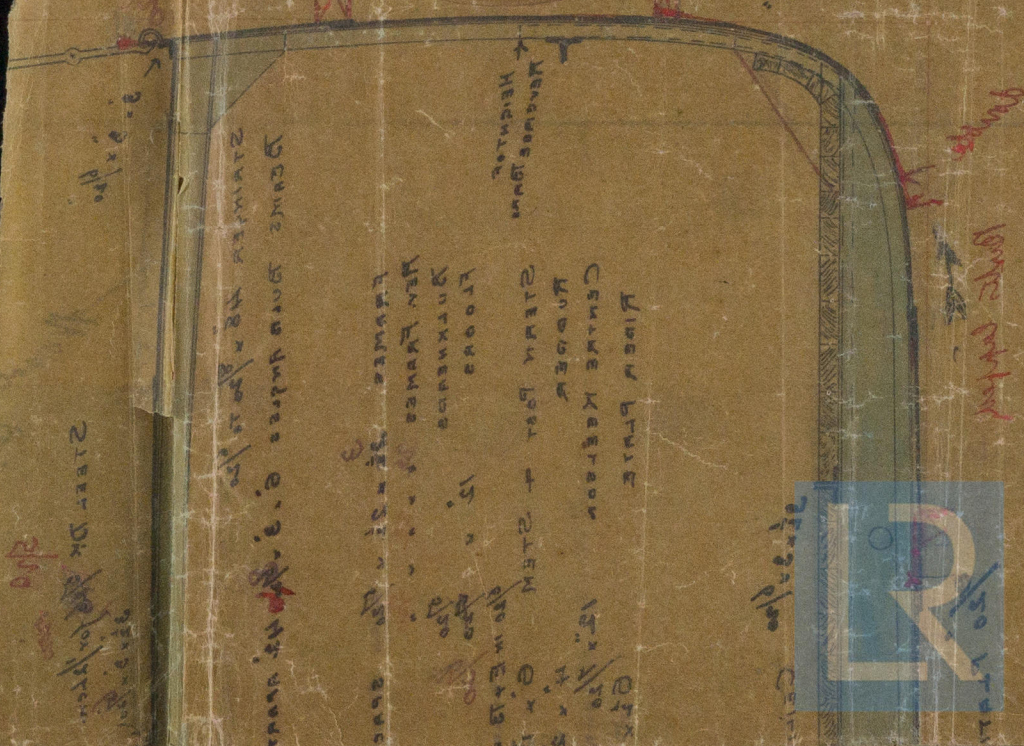
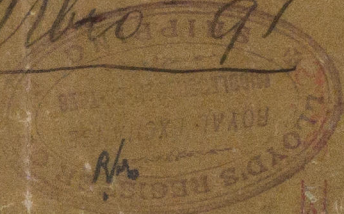

MDB 739/276