

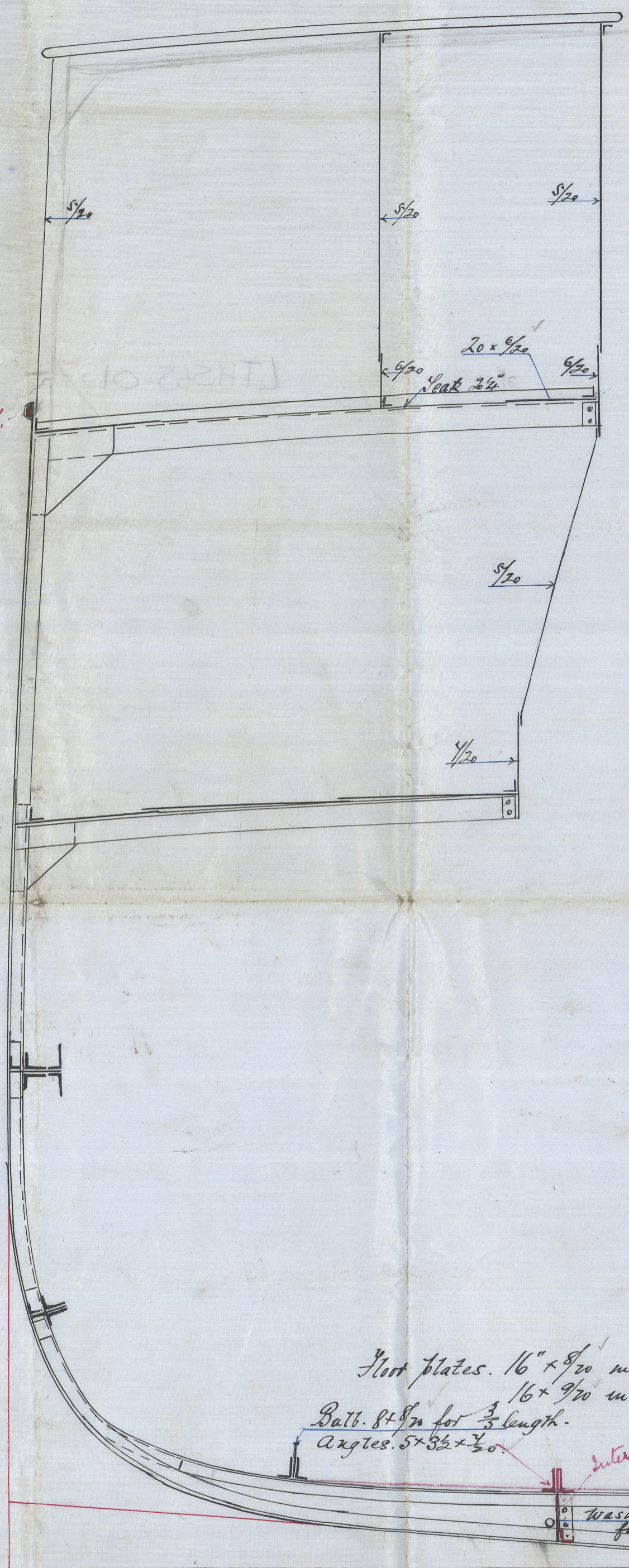

229' 4" 31' 10 1/2" 13' 10"

6.5.95
13.5.95
11.6.95

Midship Section S S No 93 "Clio" M. Regt. No 7963
Length 229' 4" Breadth 31' 10 1/2" Depth 13' 10" Mtd
Scale 1/2" = one foot
Class. 100⁹ Steel



- Equipment.
- 2 Bow Anchor. 2 1/2 Cwt each. Stockless.
 - 1 Stream " 19 " ex Stock.
 - 1 Kedge " 3 1/4 " " "
 - 210 fms. 1 1/2 Stud Chain Cable.
 - 60 fms. 3/4 Stream Chain or 3 1/2 Steel wire.
 - 90 fms. 3 1/2 Steel Wire.
 - 90 fms. 1/2 Hawser.
 - 90 fms. 5 1/2 " "

Flot plates. 16" x 8" in Engine Space.
16" x 9" in Boiler Space.
Butts. 8" x 1/2" for 1/2 length.
Angles. 5" x 3 1/2" x 1/2".

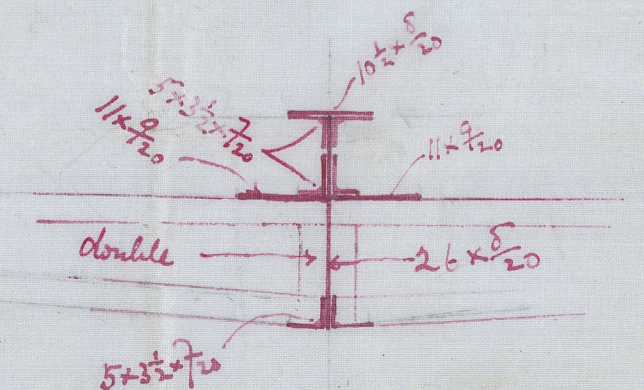
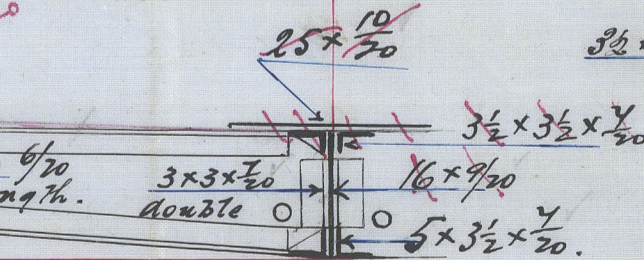

Awning Deck.

Main Deck.

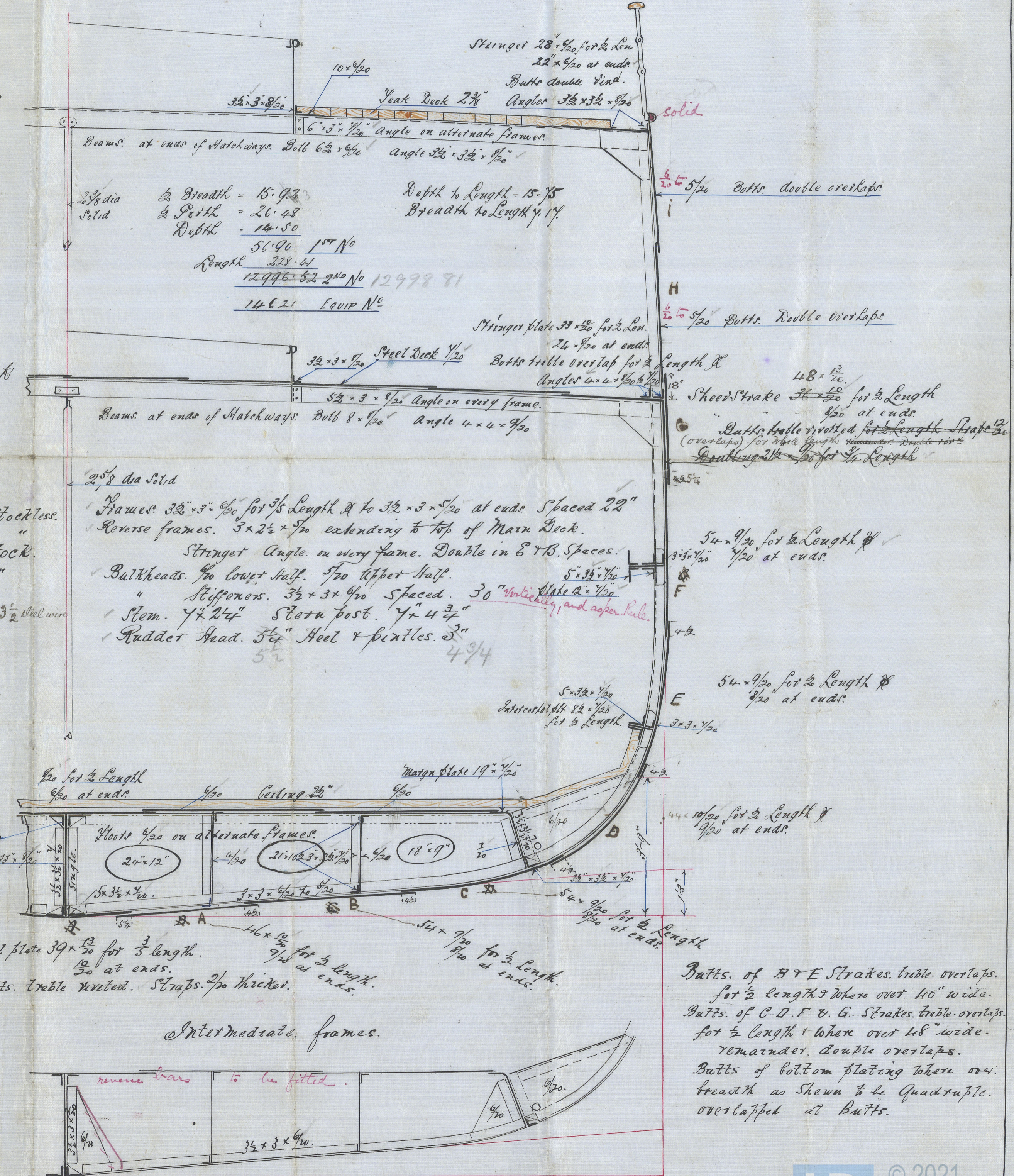

Keel plate 39" x 1 1/2" for 1/2 length.
1/2" at ends.
Butts. treble riveted. Straps. 1/2" thick.

Intermediate frames.

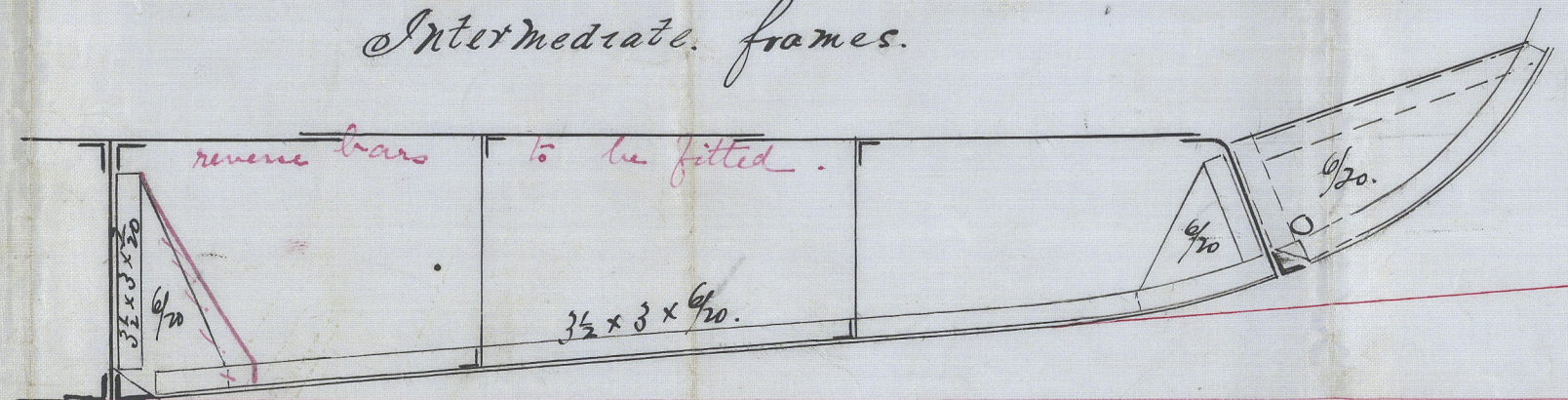

Butts. of B & E Strakes, treble overlaps.
for 1/2 length & where over 110" wide.
Butts. of C, D, F & G. Strakes, treble overlaps.
for 1/2 length & where over 118" wide.
remainder, double overlaps.
Butts. of bottom plating where over.
breadth as shown to be quadruple.
overlapped at Butts.

S. S. "Clio"

Lth. Rept. No 7963.

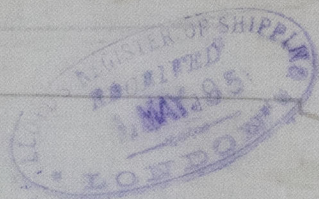

© 2021

Lloyd's Register
Foundation