

Sic. Ltr. 24. 10.92

Section through top of Fire Door.

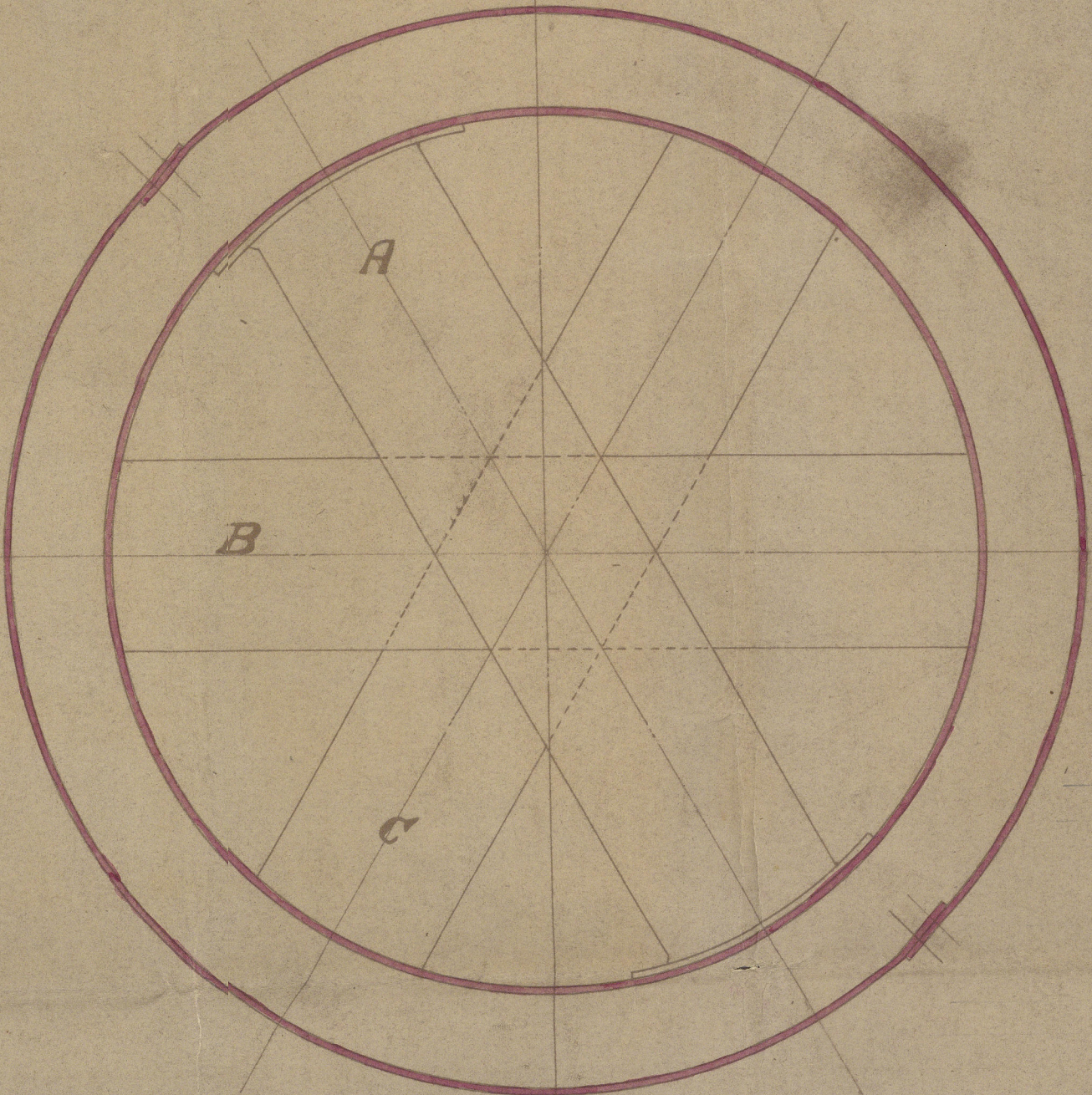

PROPOSED BOILER
FOR
MTAR BOAT H.96.
FOR
WORKING TAR PUMP.

WORKING PRESSURE 70 LBS. PER SQUARE INCH.

SCALE 1 1/2" = 1'-0"

blowing 8 plate
1/4 inch 8 gauge

Plan of Top of Boiler.

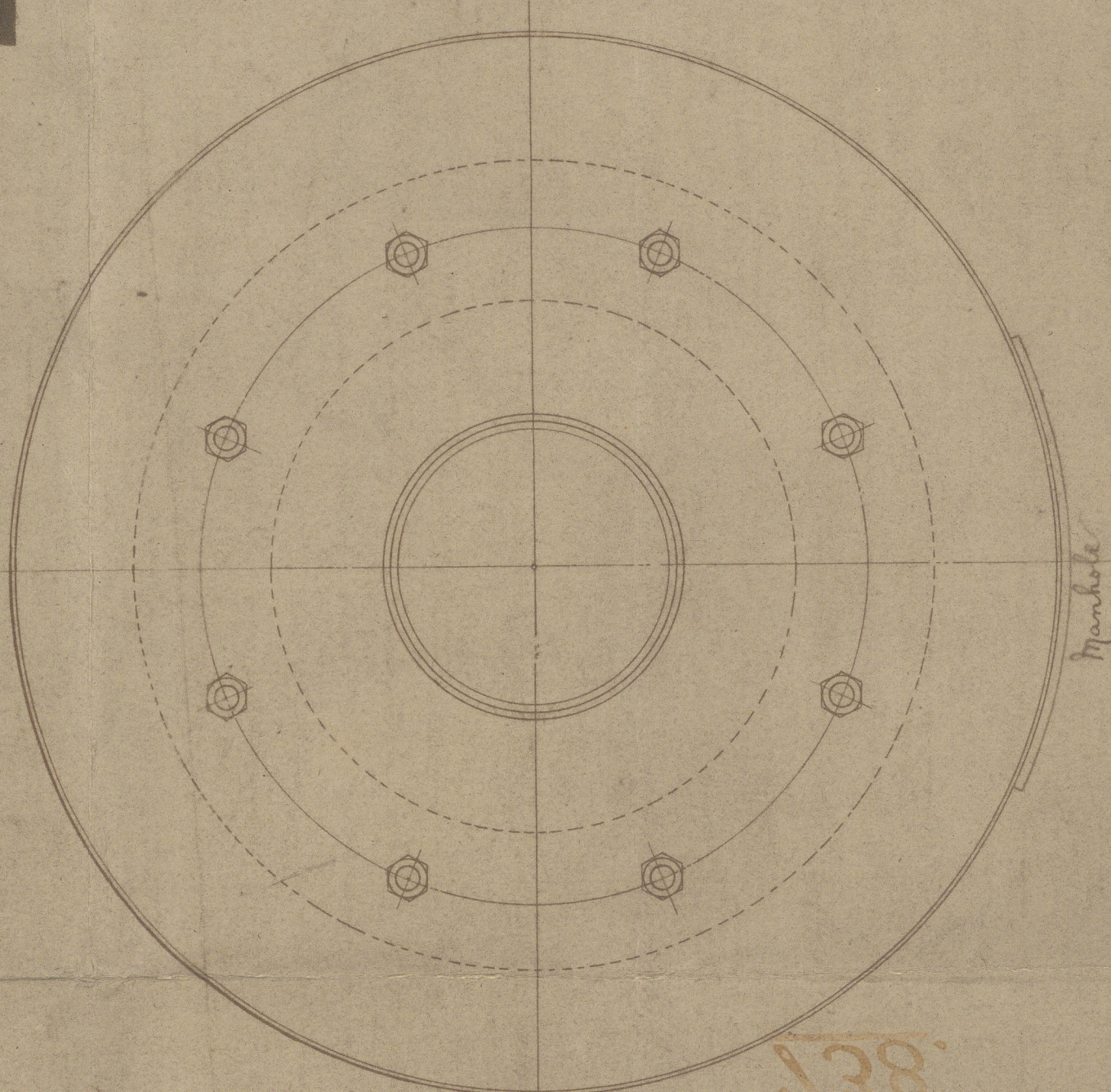

Section at Manhole Box.

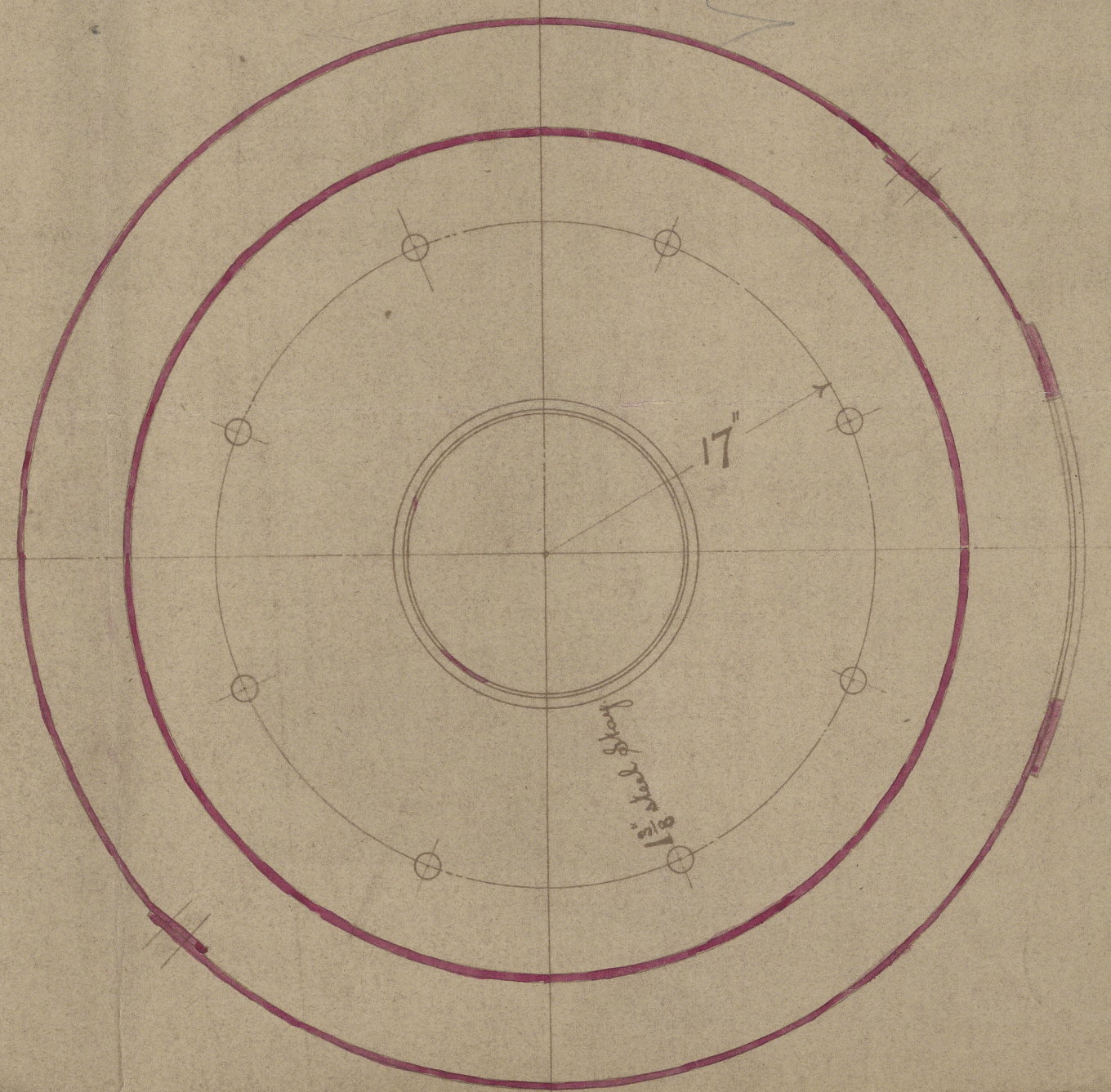

Section at top of Fire Bars.

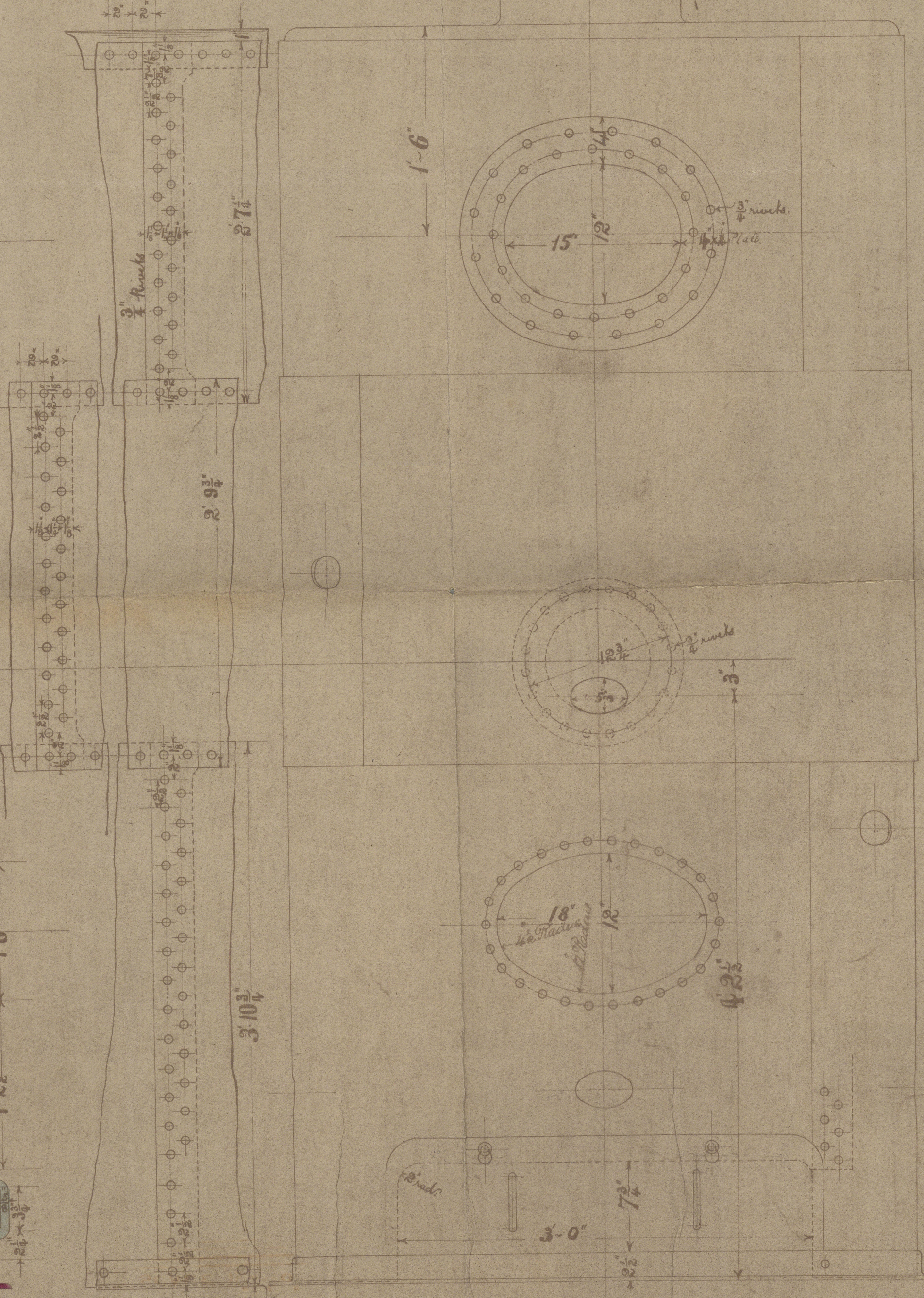
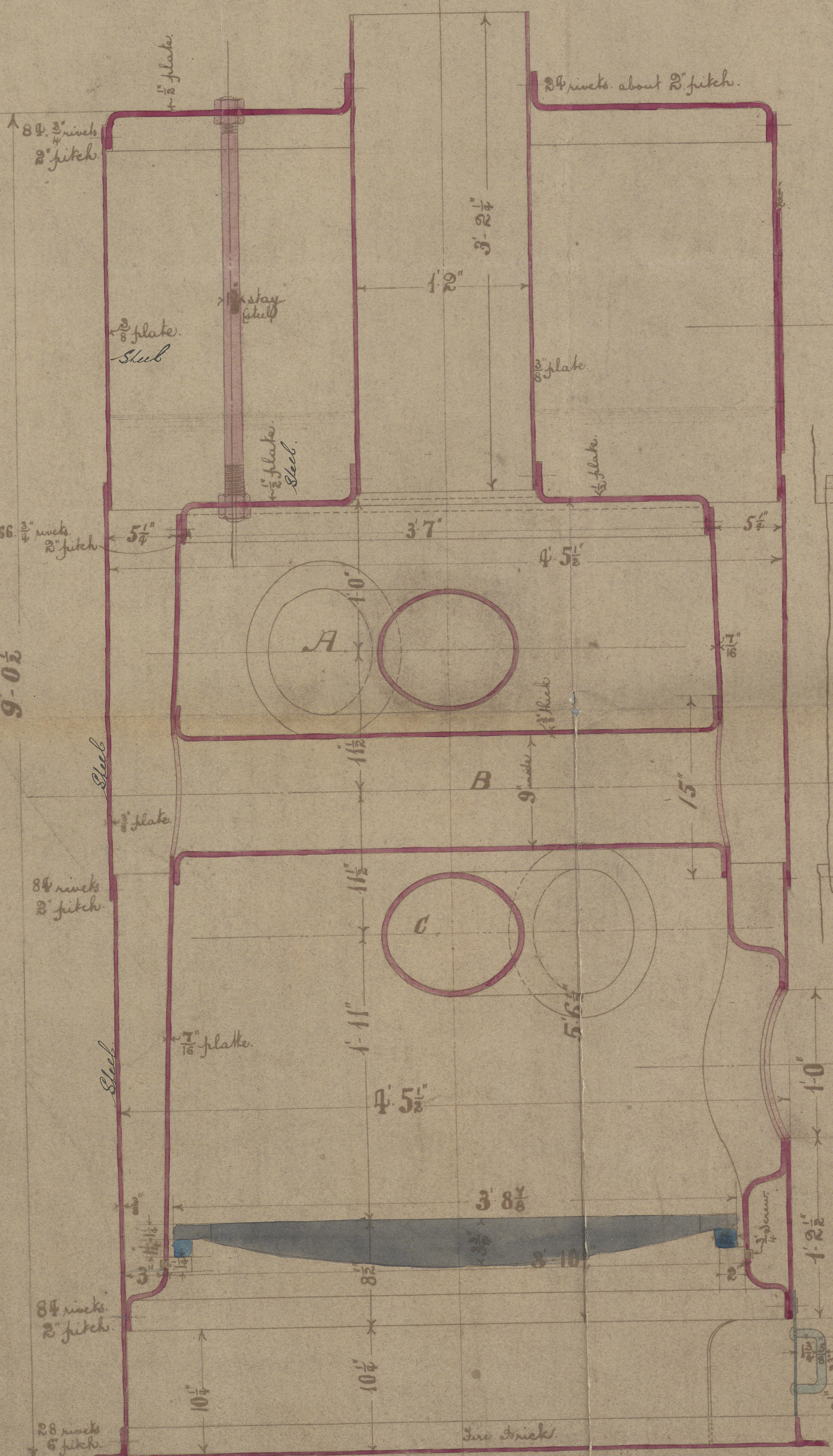
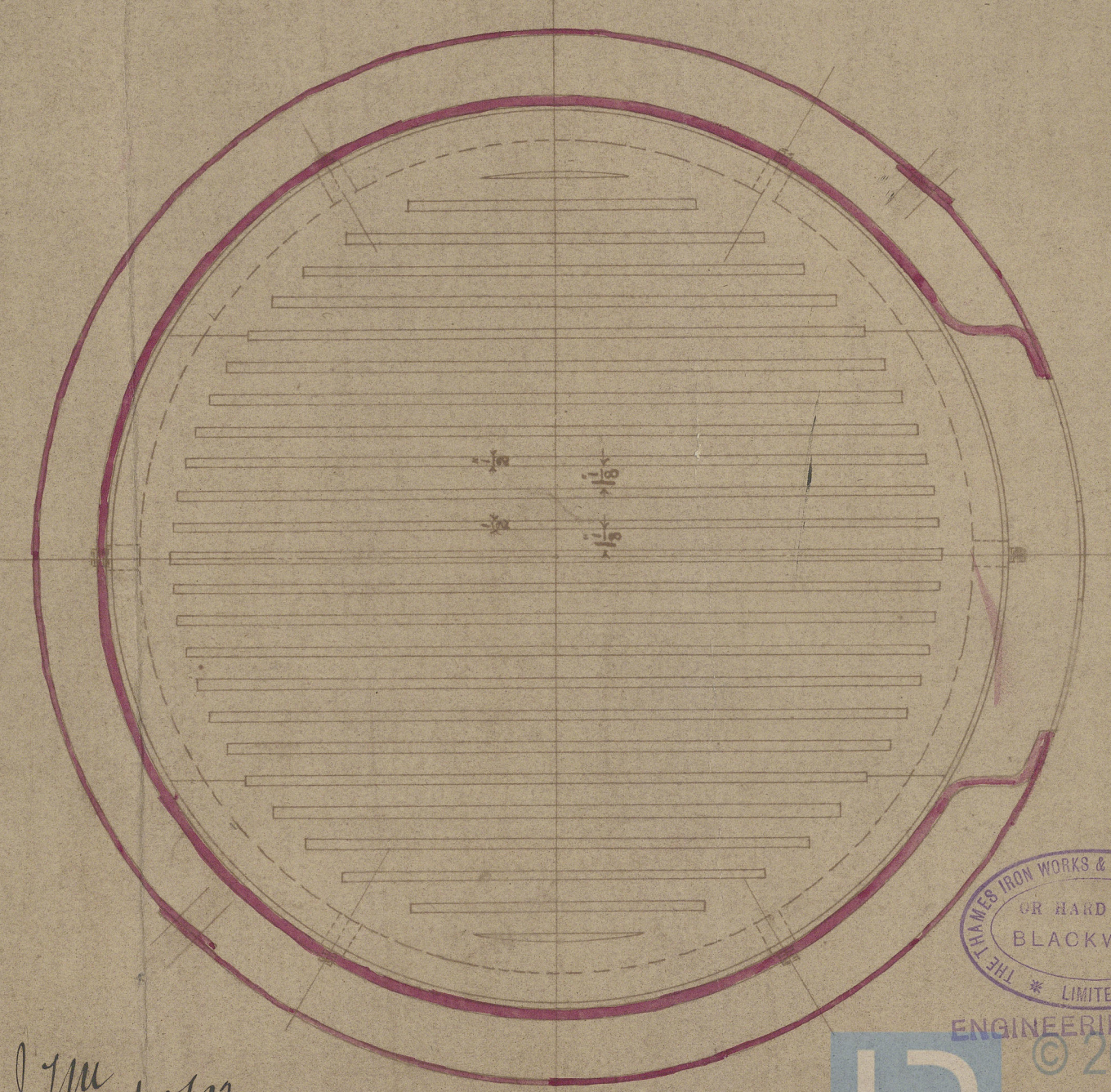

J. M. 24/10/92

101727-011

LON727-011

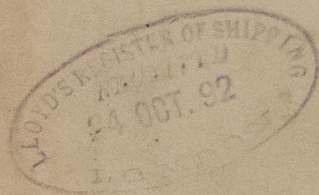

© 2021

Lloyd's Register
Foundation