

REPORT of SURVEY for REPAIRS, &c.

No. in Reg. Book. **No. 13862** Survey held at **St. Shields** Date, first Survey **27 July** Last Survey **2 Aug** 1876.

on the **Iron V. S. "Lady Lycett"** Master **G. Layton**

TONNAGE under Tonnage Deck **1815**
 Ditto of Spar Deck, or Awning Deck
 Ditto of Poop
 Ditto of Raised Qr. Dk.
 Ditto of Houses on Deck
 Ditto of Forecastle
 Gross Tonnage **1833**
 Crew Space, as per Rule
 Net Tonnage, cut on Beam Room
 as St' mer, cut on Bm. **1507**
 Poop ☒ ft. Ditto, Forecastle ☒ ft. Ditto, Raised Quarter Deck ☒ ft. Years assigned. **90** Character in Register Book. **1.75**

By, No. **13862** Port **Iron** Classed **90**

REPAIRS, OR EXAMINATION AS PER RULE **alteration in Coal Bunkers &c.**

The coal Bunkers on each side of the Engine room taken away, part of the iron deck plating for 16 feet in length in the way of the Engine hatchway on each side cut out, which has been compensated for by doubling the strake of plating immediately inside the main deck stringer plate with 8/16 plates for 28 feet in length, two angle bars each 4x4x8/16 riveted back to back and to the deck plating for 32 feet in length are also fitted so as to properly compensate for cutting the iron deck, thus.

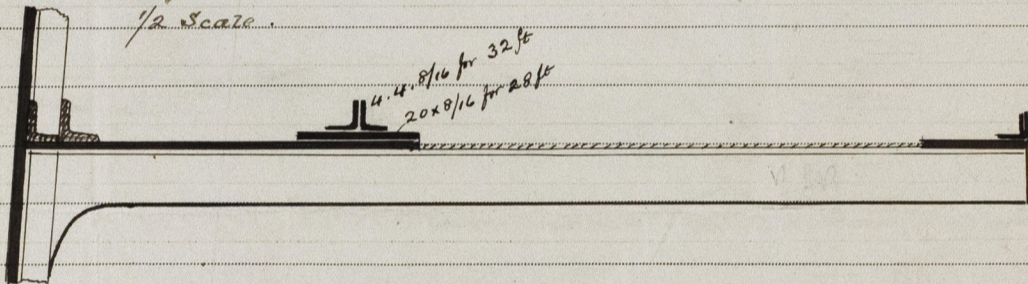

Present Condition of the	Good	Treenails	Rivets	Windlass and Capstan	Good
Decks		Breasthooks and Stemson		Pumps	
Waterways		Transoms, Pointers, and Crutches		Boats	
Comings		Timbers of the Frame at the openings		Masts, Yards, &c.	
Upper Deck Beams & Fastenings		Ditto Ditto at other places		Condition, how ascertained by examination	
Lower Deck Beams & Fastenings		Keelsons		Sails	
Planksheers		Clamps and Shelves		Anchors No. of	
Sheerstrakes		Ceiling		Cables	
Copsides		Rudder		Hawsers and Warps	
Tales		Copper	When put on	Standing & Running Rigging	
Deck (Bottom) and Counter	Not seen	Caulking of			
Engine Room Skylights	Good	Bottom, Deck, & Waterways	Not seen		

General Observations, Opinion as to Class, &c. **This vessel was lying loaded in the Tyne**

doct when I was called upon to survey her, from what could be seen she appears in good & efficient condition, I informed the owners representative that she was due for Special Survey 2nd 1, but as she was loaded and ready for her voyage, they promised to get this done on her return.

The Amount of Entry Fee ... £ 2 : 2 : - received by me, **2 Aug 1876**
 Special ... £ 2 : 2 : -
 Certificate (if required) ... £ - : - : -
 (Travelling Expenses, if any, £ -)

Committee's Minute **1st September 1876**

Character assigned **90** **1.75 as in previous**

J. Moverly
 Surveyor to Lloyd's Register of British and Foreign Shipping.