

27.6.95

s/s Emu
Hull Report No

DIMENSIONS.

— LENGTH AS PER RULE — 100.10 1/2 —
— HALF M BREADTH — 10.2 1/2 —
— DEPTH KEEL TO M.D.B. — 12.4 —

MIDSHIP SECTION

— STEAM TRAWLER N° 138 —

102'0" x 20'6" x 11'0" Bold

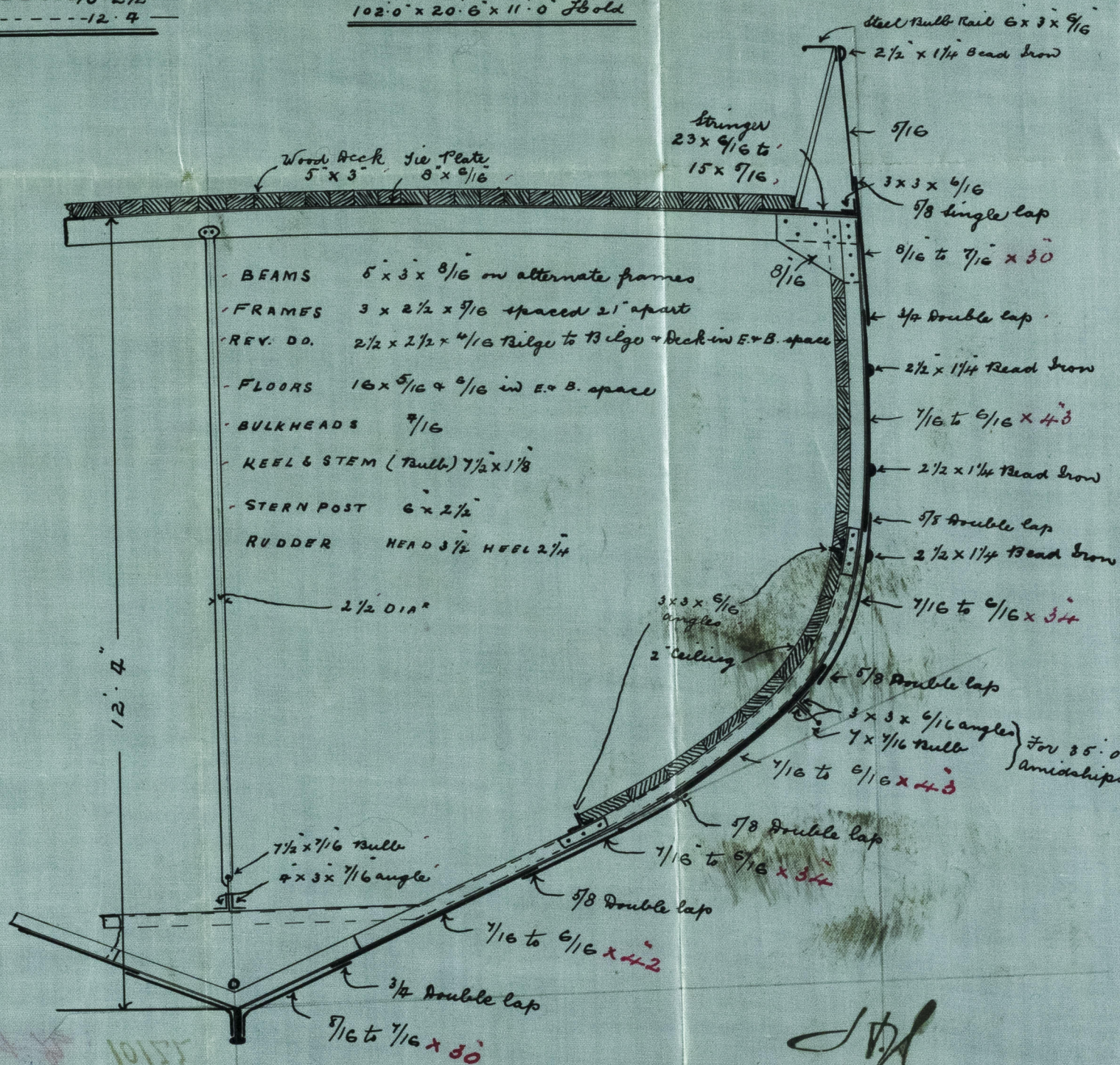

— COCHRANE & COOPER —

— SHIPBUILDERS —

— BEVERLEY —

1/2 Girth 17.83
1/2 Breadth 10.2
Depth 12.33
40.36 1 1/2 W.
100.87
28252
32288
403600
4071.13 2 2 1/2 W.

$$\frac{L}{D} = 8.18$$

$$\frac{L}{B} = 4.9$$

Moulded depth 11'10"

Butt straps of Sheer strake stringer & one strake at Bilge, to be 1/16 thicker than plates they connect
all Butts double Rivetted

J.H.L.
27/6/95

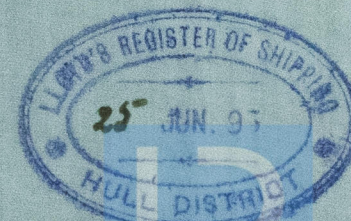

© 2019

Lloyd's Register
Foundation



S/S *Emu*

Hull Report No: 10122

HUL411-0335

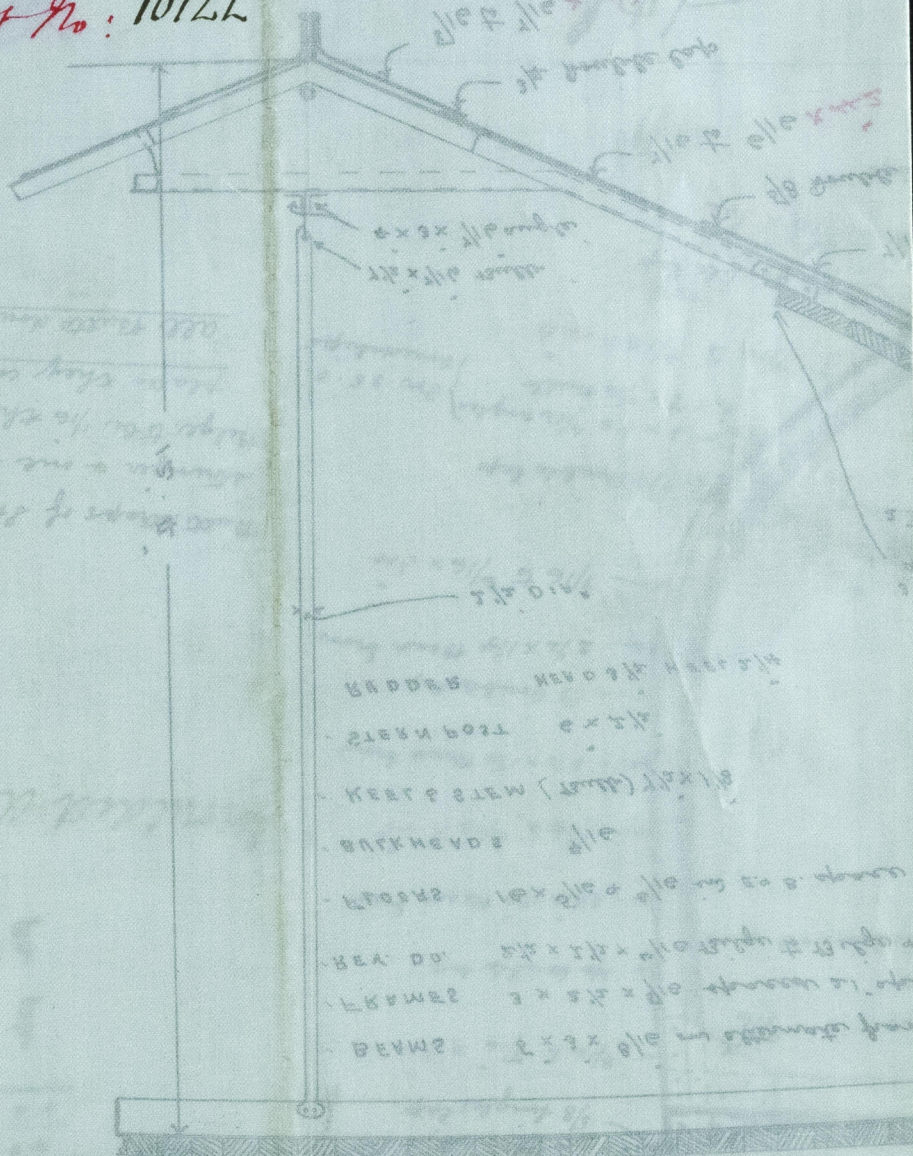

BEAMERS

SHIP BUILDERS

COOPERATIVE

DEPTH KEEL TO WDP

WDP TO GUNWALE

TENSION OF BEE BAGE

DIMENSIONS

105.0 x 50.0 x 11.0

STEEL TANKER

WIDSHIP



© 2019

Lloyd's Register
Foundation