

12:5:00

# PUMPING ARRANGEMENT

SCALE 3/4" = 1' 0"

TONNAGE OVER 3,000

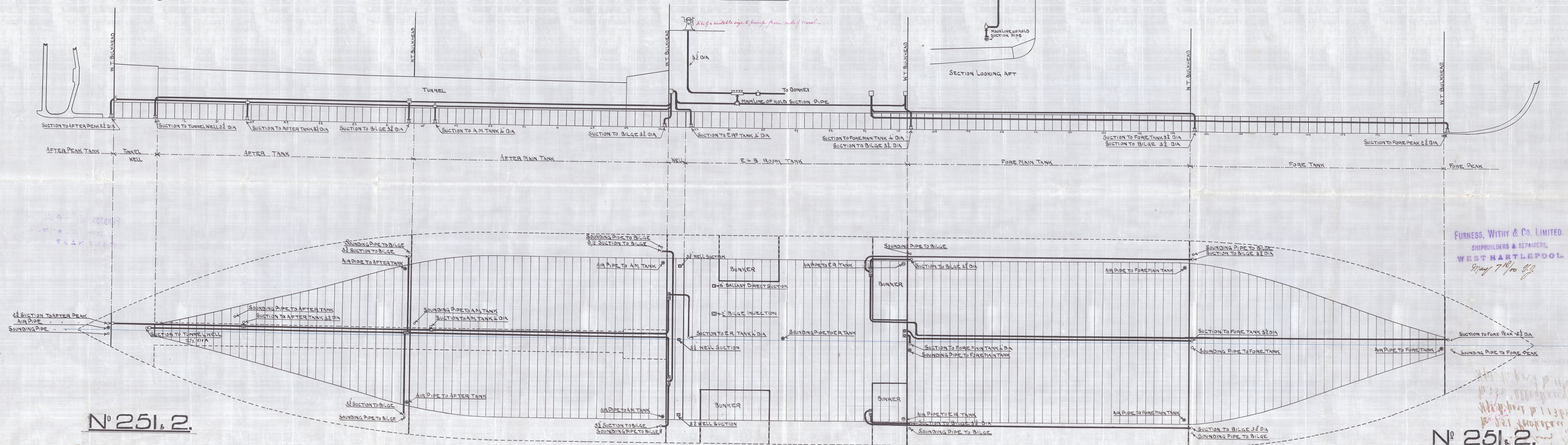

FURNESS, WITBY & CO. LIMITED.  
SHIPBUILDERS & REPAIRERS,  
WEST HARTLEPOOL.  
May 7/10 J.P.



Furness City H.C.

No. 251 & 252

Pumping Plan

No. 251 "Powhatan"

Hpl. Report No. 11368

No. 252 "Alleghany"

Hpl. Report No. 11467

HP 340-0229

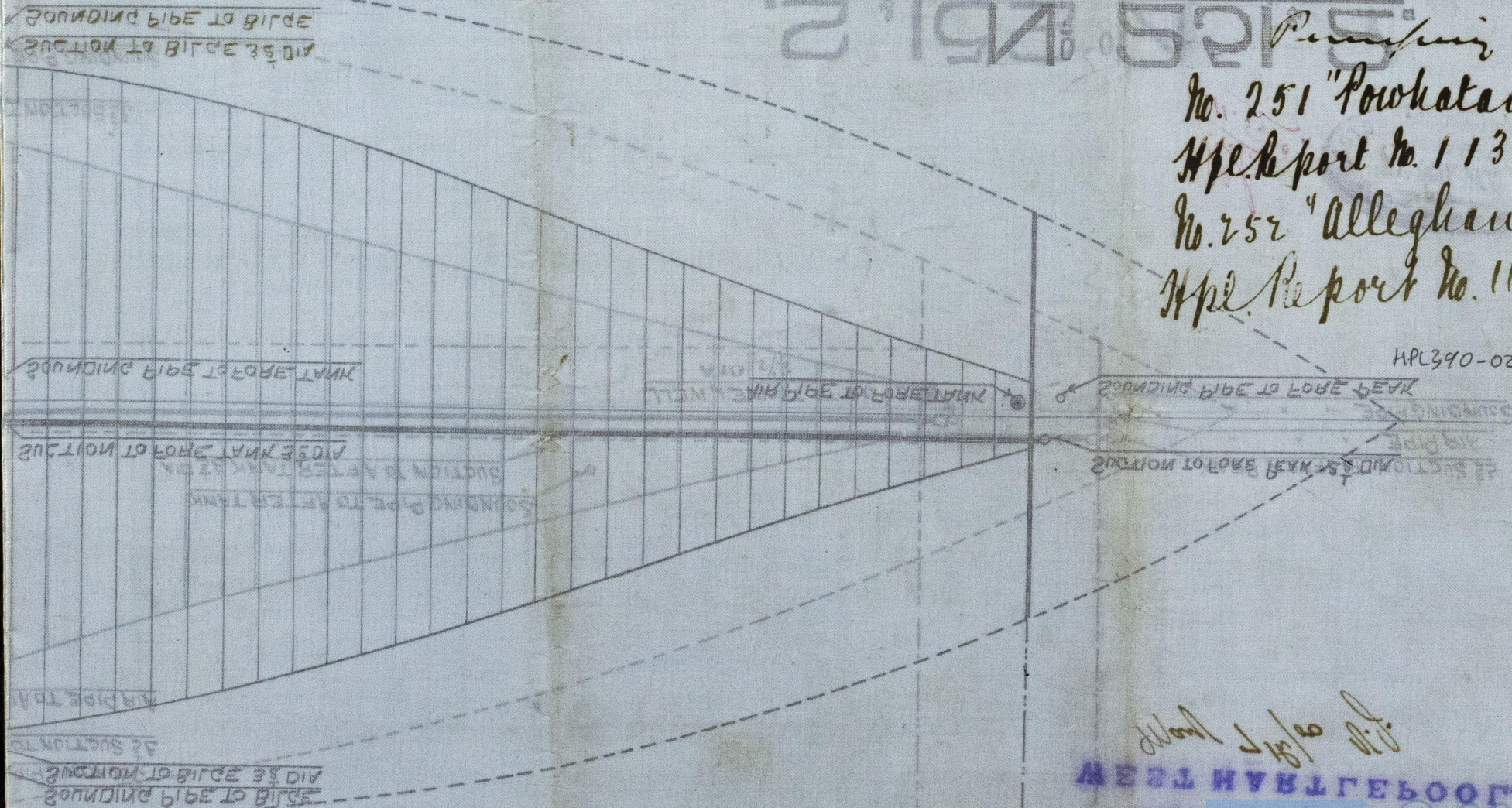

WEST HAVLGEBOO

SHIPBUILDERS & REPAIRERS

FURNESS' MILNER & CO. LIMITED

Lloyd's Register Foundation