

30.12.99

TOTAL HEIGHT 36' 0"

Cast Steel  
SCREW FRAME

SCALE  $\frac{1}{2}" = 1 \text{ FOOT}$

TO PASS LLOYDS SURVEY

CAST STEEL

No. 821 "Pocahontas"  
No. 820 "Allegany"  
No. 819 "Allegany"

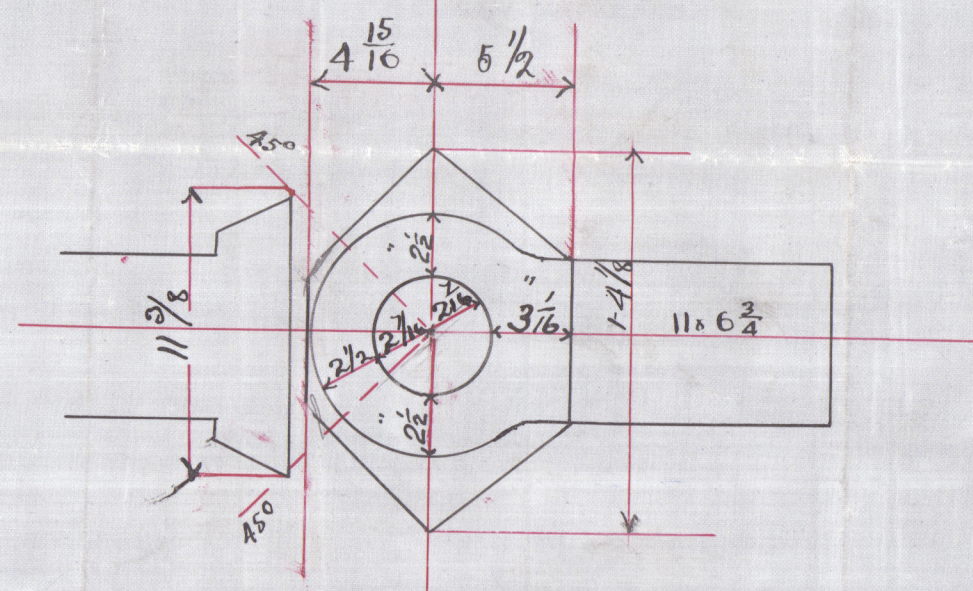
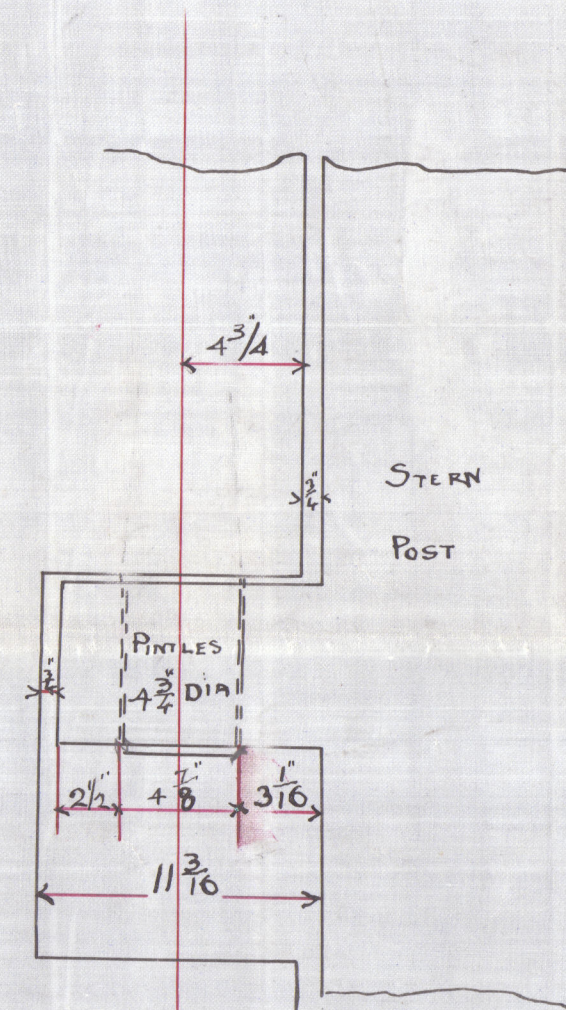
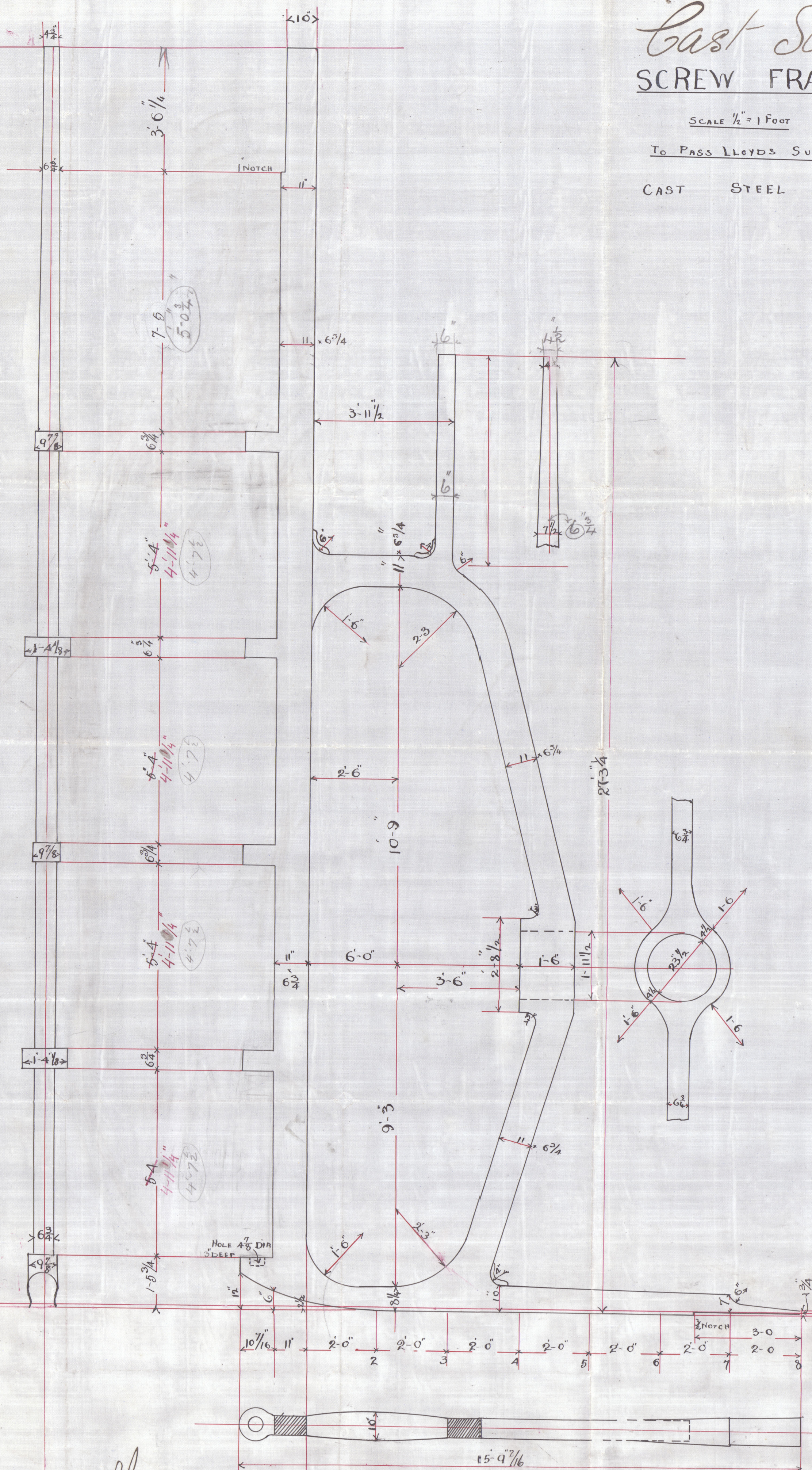

SKETCH OF GUDGEON & STOPPER  
SCALE  $1\frac{1}{2}" = 1$  FOOT

FURNESS, WITHEY & CO. LIMITED.

WEST HARTLEPOOL.

Dec 19<sup>th</sup>/99 B.J.

BASE LINE

N<sup>os</sup> 251.S.S. & 252

© 2020

Lloyd's Register  
Foundation

MPL390-0271



Garners Willey & Co

No. 251 & 252

Cast steel screw frame

No. 251 "Powhatan"

Hpl Report No. 11368

No. 252 "Alleghany"

Hpl Report No. 11467

HPL390-0224

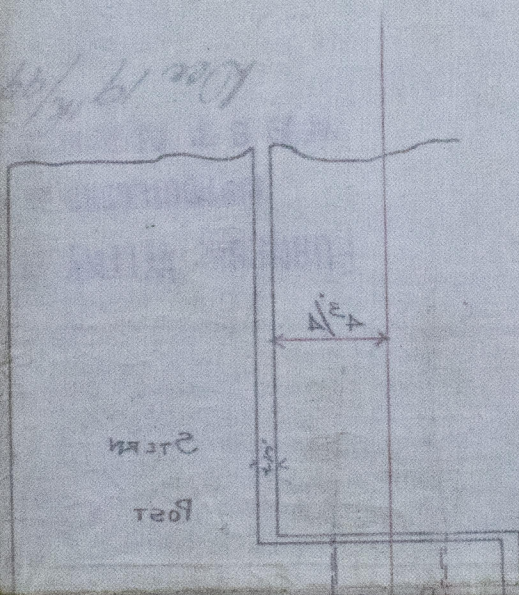

Post  
SCREW FRAME

SCALE 1" = 1 FOOT  
TO PASS FLOOD SURVEY  
CAST STEEL



© 2020

Lloyd's Register  
Foundation