

Ch
5: 7.99.

PUMPING ARRANGEMENT.

SCALE 1/8" = ONE FOOT.

TONS UNDER DECK ABOUT 5080.

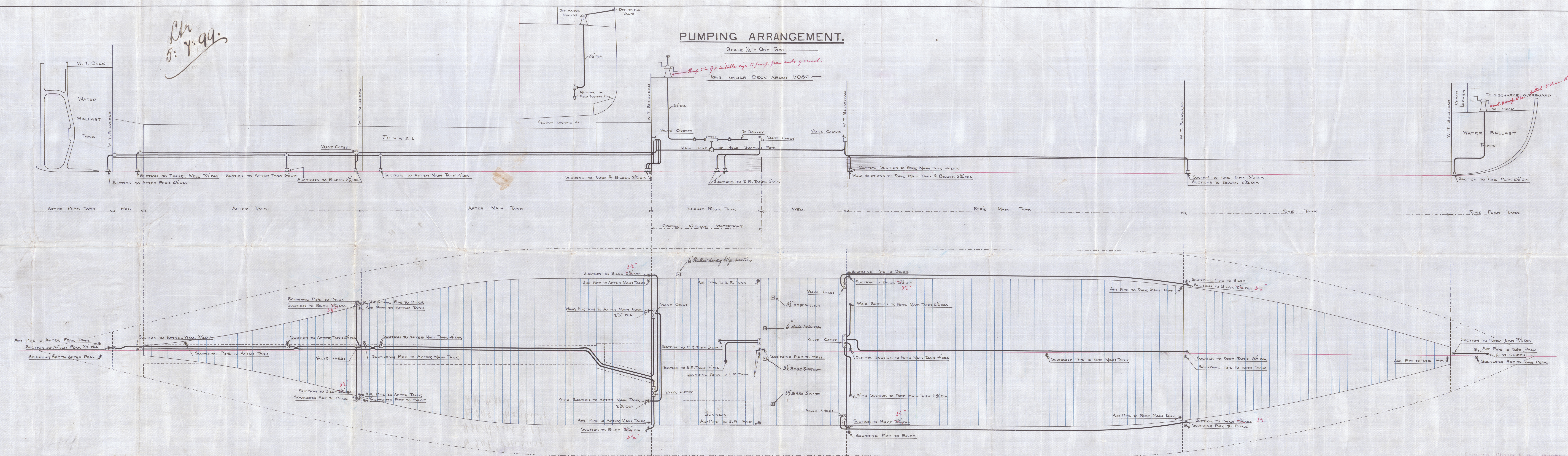

Nº 246 & 248.

FURNESS, WITBY & CO., LIMITED.

SHIPBUILDERS & REPAIRERS
WEST HARTLEPOOL.

Rel.
u. 7.99

June 28/99

© 2020

Lloyd's Register
Foundation

Jarvis Wilby & Co Ltd

Sh 246-248

Pumping Plant

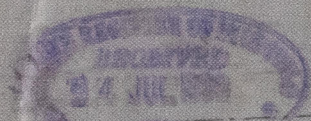

No. 246 "Freiburg"

Hpl. Report No. 11140

No. 248 "Marburg"

Hpl. Report No.

HPL388-0143

