

PUMPING ARRANGEMENT

SCALE $\frac{1}{8}$ = ONE FOOT.

WESTGARTH ENGLISH & CO.
ENGINEERS AND
BOILER MAKERS,
MIDDLESBROUGH.

Inquirer No. 45. May 19th 96. W.G.

Under Deck tonnage 3190 approx.

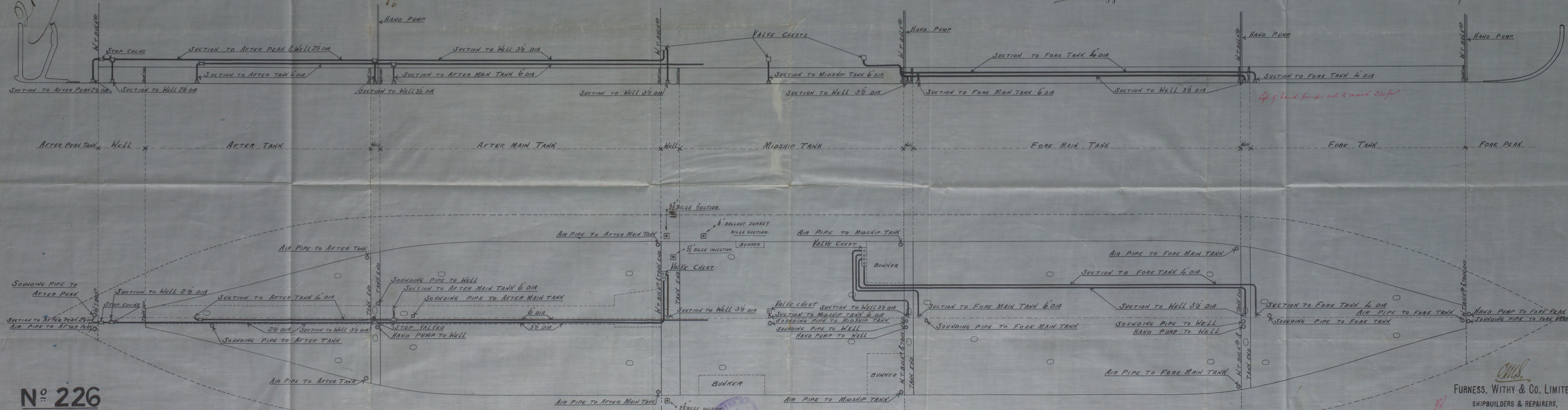

N^o 226

FURNESS, WITBY & CO. LIMITED.
SHIPBUILDERS & REPAIRERS,
WEST HARTLEPOOL.
MAY 15th 1896
TRACING N^o 13604

Turner & Whitney Co
No. 226.

Pumping arrangement.

U.S. Commonwealth
W. H. R. Report No. 10063.

HPL378-0104

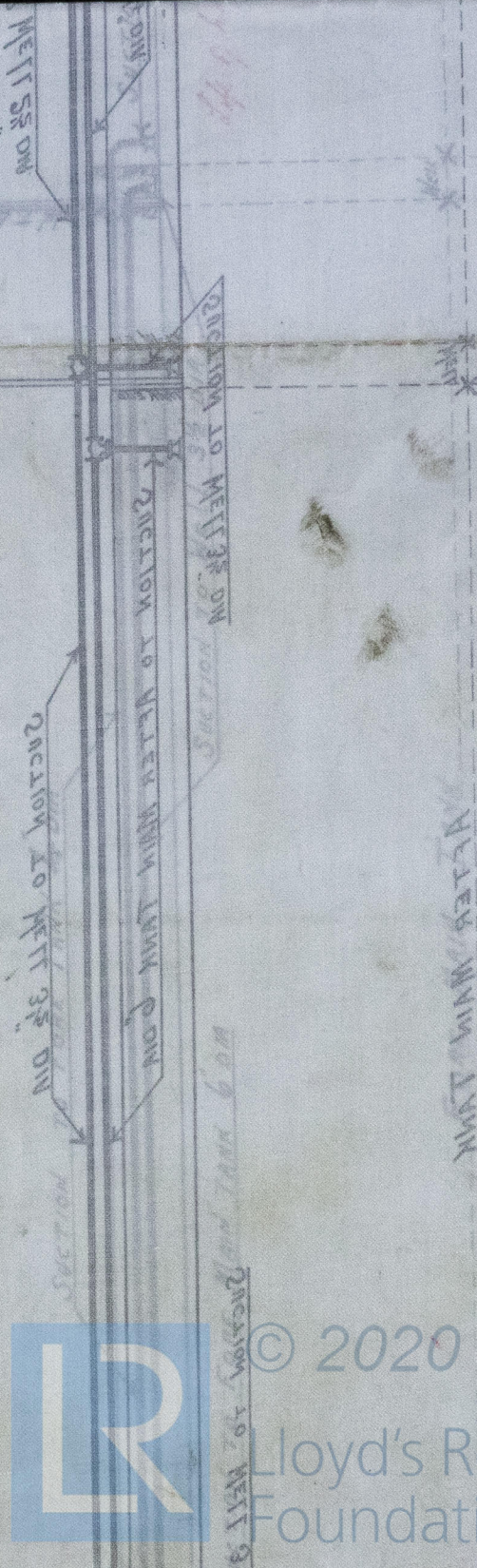

© 2020

Lloyd's Register
Foundation