

MIDSHIP SECTION

SCALE $\frac{1}{2}'' = 1 \text{ FOOT}$

FORECASTLE DECK

BEAM ANGLES $5\frac{1}{2} \times 3 \times \frac{7}{20}$ ON EVERY FRAME

IRON DECK $\frac{5}{16}''$

STRINGER PLATE $40 \times \frac{10}{20}$ BUTTS TREBLE RIVETED
STRINGER ANGLE $4 \times 4 \times \frac{9}{20}$

IRON DECK $\frac{5}{16}''$ INCREASED AT SIDES OF OPENINGS

BEAM/ANGLE $5\frac{1}{2} \times 3 \times \frac{7}{20}$ ON EVERY FRAME

QUARTER DECK

MAIN & QUARTER DECKS

BEAM BULB ANGLE ON EVERY FRAME $7\frac{1}{2} \times 3 \times \frac{9}{20}$

BEAM BULB ON WEBS & HATCH ENDS $9\frac{1}{2} \times \frac{9}{20}$ WITH

TWO ANGLES $3\frac{1}{2} \times 3\frac{1}{2} \times \frac{7}{20}$

STRINGER PLATE $44\frac{1}{2} \times \frac{10}{20}$ TO $37 \times \frac{8}{20}$ INCREASED $\frac{2}{20}$ FOR $\frac{3}{5}$ LENGTH

STRINGER ANGLES $4\frac{1}{2} \times 4\frac{1}{2} \times \frac{10}{20}$. $4 \times 4 \times \frac{9}{20}$ UNDER BRIDGE

IRON DECK $\frac{7}{16}''$

FRAMES BULB ANGLES $6 \times 3\frac{1}{2} \times \frac{11}{20}$ FOR $\frac{3}{5}$ LENGTH $\frac{10}{20}$ AT ENDS

FRAMES ON FLOORS $3\frac{1}{2} \times 3\frac{1}{2} \times \frac{8}{20}$ ON BRACKETS $7 \times 3\frac{1}{2} \times \frac{8}{20}$

BULKHEADS UPPER PLATING $\frac{9}{20}$, LOWER PLATING $\frac{7}{20}$ STIFFENERS $6\frac{1}{2} \times 3 \times \frac{11}{20}$ BULB ANGLE
SPACED 4'-0" APART VERTICALLY & HORIZONTALLY

FORGINGS STEM $10 \times 2\frac{3}{4}$ SCREW FRAME 10×6 RUDDER 8" AT HEAD 4" AT HEEL

BUTTSTRAPS OF ALL SHELL TREBLE RIVETED FOR $\frac{3}{4}$ LENGTH $\frac{4}{20}$ THICKER
THAN PLATES FOR $\frac{1}{2}$ LENGTH, REMAINDER $\frac{2}{20}$ THICKER

BOSS PLATES $\frac{13}{20}$

PILLARS AS PER RULE

LOWER DECK IN AFTER HOLD

BEAMS IN HOLDS PLATE $15 \times \frac{10}{20}$ 4 ANGLES $5 \times 4 \times \frac{9}{20}$

STRINGER PLATE $46 \times \frac{11}{20}$ TO $32 \times \frac{9}{20}$

STRINGER ANGLES $4 \times 4 \times \frac{9}{20}$

INNER BULB ANGLE $6 \times 3\frac{1}{2} \times \frac{11}{20}$

INTERCOSTAL PLATES $18 \times \frac{8}{20}$
" ANGLES $3\frac{1}{2} \times 3\frac{1}{2} \times \frac{8}{20}$ & $6 \times 3\frac{1}{2} \times \frac{12}{20}$

SEMI DIAMOND PLATES
 $32 \times 19\frac{1}{2} \times \frac{9}{20}$

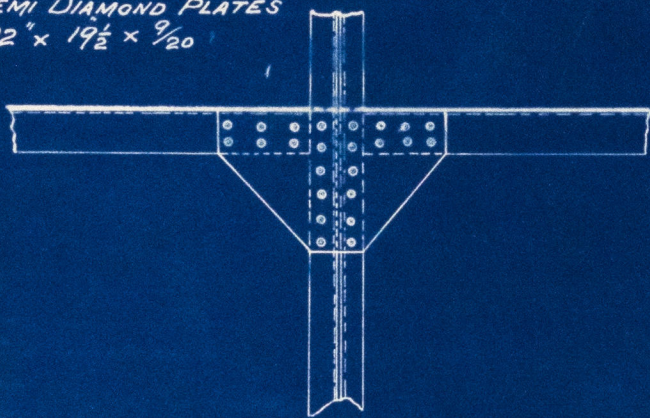

LLOYDS NUMERALS

HALF BEAM MOULDED.....	20'-2"
DEPTH OF HOLD & FLOORS.....	24'-8"
HALF GIRTH.....	40'-0"
FRAME NUMBER.....	84'-10"
LENGTH PER RULE.....	312'-4"
PLATING NUMBER.....	26495
EQUIPMENT NUMBER.....	29807
BEAMS IN LENGTH.....	7.74
DEPTHS IN LENGTH.....	12.67

CLASS 100 A. PARTIAL AWNING DECK

ALL SCANTLINGS OF STEEL EXCEPT

WHERE OTHERWISE SPECIFIED

SECTION IN ENGINE SPACE

Additional fittings under Surfaces

CEILING $2\frac{1}{2}''$

MARGIN PLATE $26 \times \frac{8}{20}$

TANK TOP IN E & B SPACE $\frac{8}{16}$ IRON $\frac{8}{20}$ STEEL IN HOLDS

CENTRE PLATE $63 \times \frac{9}{20}$

KNEES $\frac{8}{20}$

DOUBLED UNDER ENGINES & BOILERS

CENTRE KEELSON
 $40 \times \frac{10}{20}$

F $12-9$
 $\frac{20}$

E $11-9$
 $\frac{20}$

D $12-9$
 $\frac{20}$

C $11-9$
 $\frac{20}$

B $12-11$
 $\frac{20}$

A $36 \times 24-14$
 $\frac{20}$

DOUBLE BUTT STRAPS

FLOORS FLANGED TOP & BOTTOM $\frac{9}{20}$ THICK

BRACKETS FLANGED AT TOP $\frac{8}{20}$ THICK

Nº 195.

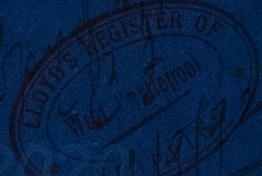
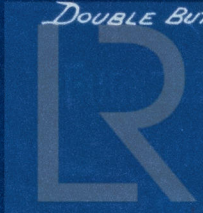

Furness, Withy & Co.

No. 195.

Midship Section

S.S. "Graffol",

W. H. L. Report No. 8895



Cover

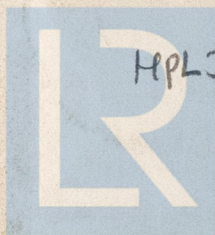

HP L368-0021

© 2020

Lloyd's Register
Foundation