

# MIDSHIP SECTION

SCALE  $\frac{1}{2}$ " = 1 FOOT

S.S. "Birdoswald"

FORECASTLE DECK

BEAM ANGLES  $5\frac{1}{2} \times 3 \times \frac{7}{20}$  ON EVERY FRAME

IRON DECK  $\frac{5}{16}$

STRINGER PLATE  $40 \times \frac{10}{20}$  BUTTS TREBLE RIVETED  
STRINGER ANGLE  $4 \times 4 \times \frac{7}{20}$

IRON DECK  $\frac{5}{16}$  INCREASED AT SIDES OF OPENINGS

BEAM ANGLE  $5\frac{1}{2} \times 3 \times \frac{7}{20}$  ON EVERY FRAME

QUARTER DECK

MAIN & QUARTER DECKS

BEAM BULB ANGLE ON EVERY FRAME  $7\frac{1}{2} \times 3 \times \frac{7}{20}$

BEAM BULB ON WEBS & HATCH ENDS  $9\frac{1}{2} \times \frac{7}{20}$  WITH

TWO ANGLES  $3\frac{1}{2} \times 3\frac{1}{2} \times \frac{7}{20}$  OR BULB TEES OF EQUAL SECTION

STRINGER PLATE  $44\frac{1}{2} \times \frac{10}{20}$  TO  $37 \times \frac{8}{20}$  INCREASED  $\frac{2}{20}$  FOR  $\frac{3}{4}$  LENGTH

STRINGER ANGLES  $4\frac{1}{2} \times 4\frac{1}{2} \times \frac{10}{20}$   $4 \times 4 \times \frac{7}{20}$  UNDER BRIDGE

Steel  $\frac{7}{16}$  and IRON DECK  $\frac{7}{16}$

P  $\frac{11}{20}$   
BUTTS TREBLE RIVETED

O  $\frac{8}{20}$   
INCREASED  $\frac{1}{20}$  FOR  $\frac{1}{2}$  LENGTH  
 $\frac{10}{20}$  IN WAY OF BREAK

N  $\frac{13-10}{20}$   
INCREASED  $\frac{2}{20}$  FOR  $\frac{3}{4}$  LENGTH

M  $\frac{11-9}{20}$   
INCREASED  $\frac{1}{20}$  FOR  $\frac{1}{2}$  LENGTH

L  $\frac{12-9}{20}$

K  $\frac{11-9}{20}$

I  $\frac{12-9}{20}$

H  $\frac{11-9}{20}$

G  $\frac{12-9}{20}$

F  $\frac{12-9}{20}$

E  $\frac{11-9}{20}$

D  $\frac{12-9}{20}$

C  $\frac{11-9}{20}$

B  $\frac{12-11}{20}$

A  $36 \times \frac{24-14}{20}$

DOUBLE BUTT STRAPS

SECTION IN ENGINE SPACE

CEILING  $2\frac{1}{2}$ "

MARGIN PLATE  $\frac{8}{20}$

TANK TOP IN E & B SPACE  $\frac{8}{16}$  IRON  $\frac{8}{20}$  STEEL IN HOLDS

CENTRE PLATE  $63 \times \frac{9}{20}$

KNEES  $\frac{8}{20}$

$3\frac{1}{2} \times 3\frac{1}{2} \times \frac{8}{20}$

$2 \times 6$

$8\frac{1}{20}$

CENTRE KEELSON  
 $40 \times \frac{10}{20}$

$6\frac{1}{2} \times 4 \times \frac{9}{20}$

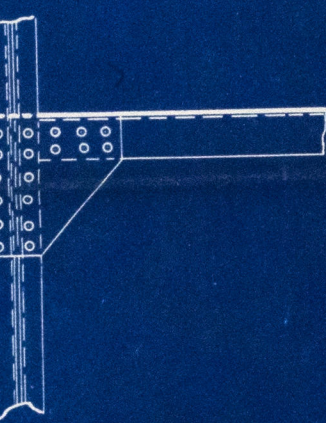

INTERCOSTAL PLATES  $18 \times \frac{8}{20}$   
" ANGLES  $3\frac{1}{2} \times 3\frac{1}{2} \times \frac{8}{20}$  &  $6 \times 3\frac{1}{2} \times \frac{12}{20}$

SEMI-DIAMOND PLATES  
 $32 \times 19\frac{1}{2} \times \frac{9-8}{16}$

LOWER DECK IN AFTER HOLD  
BEAMS IN HOLDS PLATE  $15 \times \frac{10}{20}$  4 ANGLES  $5 \times 4 \times \frac{9}{20}$   
STRINGER PLATE  $41 \times \frac{9}{20}$  TO  $32 \times \frac{8}{20}$   
STRINGER ANGLES  $4 \times 4 \times \frac{9}{20}$   
FACE PLATES  $8\frac{1}{2} \times \frac{10-9}{20}$   
FACE PLATE ANGLES  $4 \times 3\frac{1}{2} \times \frac{7}{20}$

## LLOYDS NUMERALS

HALF BEAM MOULDED	20.2
DEPTH OF HOLD & FLOORS	24.8
HALFGIRTH	40.0
FRAME NUMBER	84.10
LENGTH PER RULE	312.4
PLATING NUMBER	26495
EQUIPMENT NUMBER	29807
BEAMS IN LENGTH	7.74
DEPTHS IN LENGTH	12.67
CLASS 100 A. PARTIAL AWNING DECK	

ALL SCANTLINGS OF STEEL EXCEPT  
WHERE OTHERWISE SPECIFIED

After grain division  $\frac{5}{16}$  thick  
Double angle stiffeners  $5 \times 3 \times \frac{9}{16}$

Nº 191

FLOORS FLANGED TOP & BOTTOM  $\frac{9}{20}$  THICK

BRACKETS FLANGED AT TOP  $\frac{8}{20}$  THICK

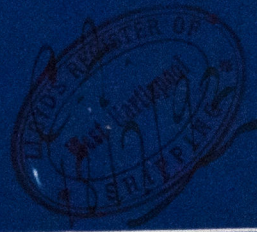

FURNISHED WITH  
SHIPBUILDERS & SHIPOWNERS  
WEATHER & SHIPBUILDERS  
TRADING N° 10741  
APRIL 5TH 1893



Furness, Withy & Co.  
No. 191

Marship Section

S.S. "Birdswald"

*Copy*

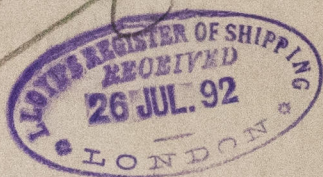

HL367-0135

© 2020

Lloyd's Register  
Foundation