

16-10-07

Shelter Deck

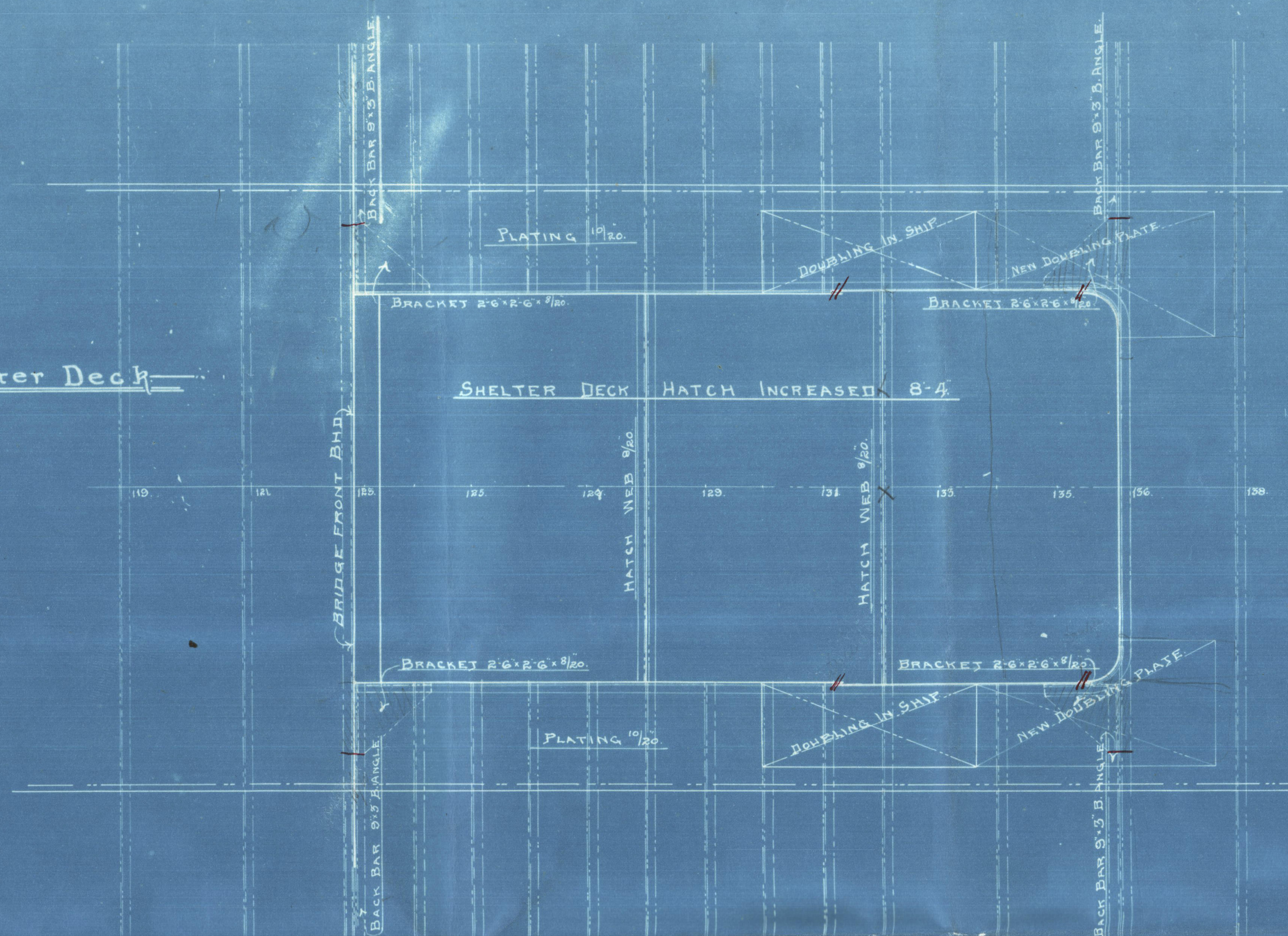

Handwritten scribbles at the top of the right page.

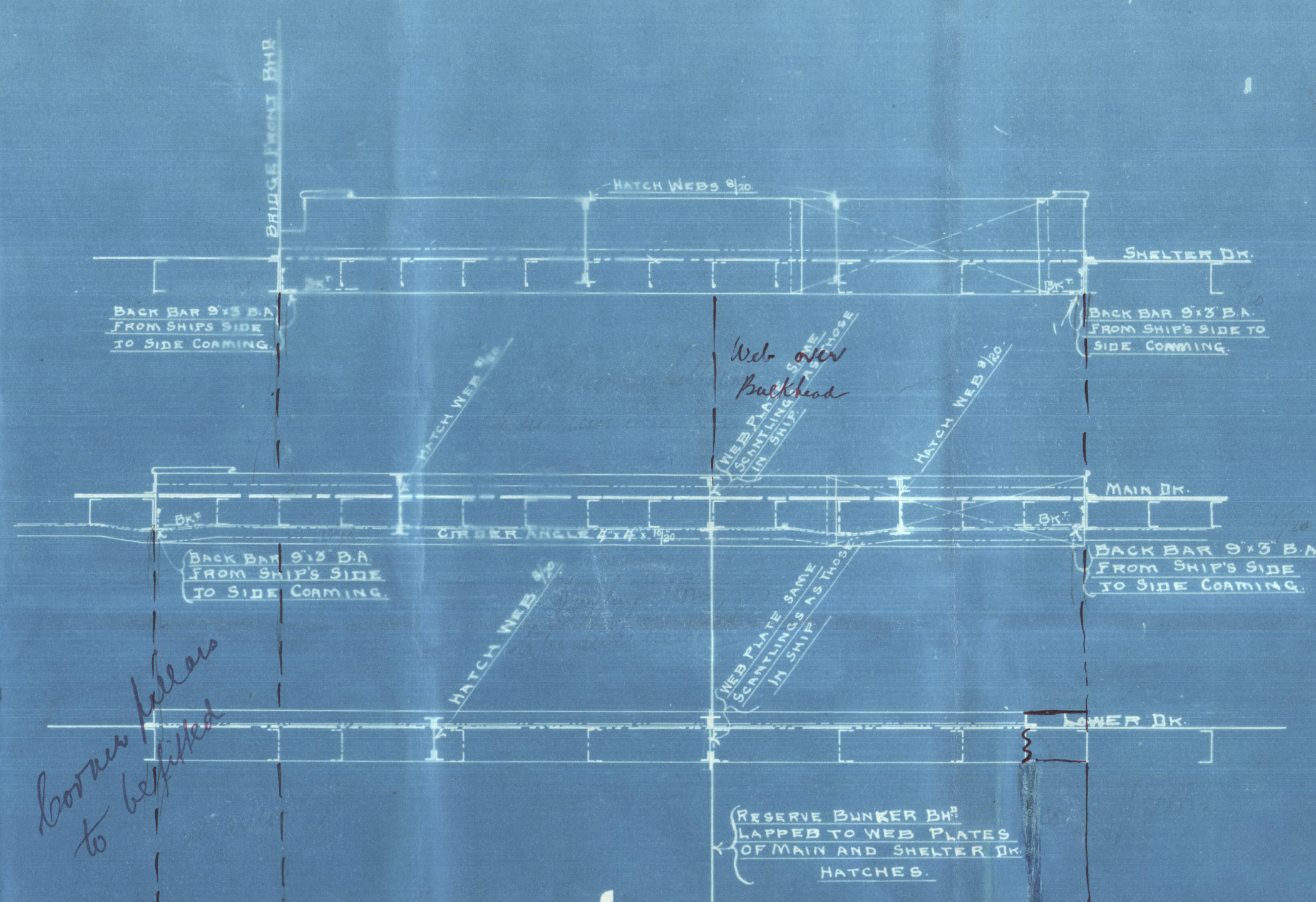

*Lower plates to be fitted*

Main Deck

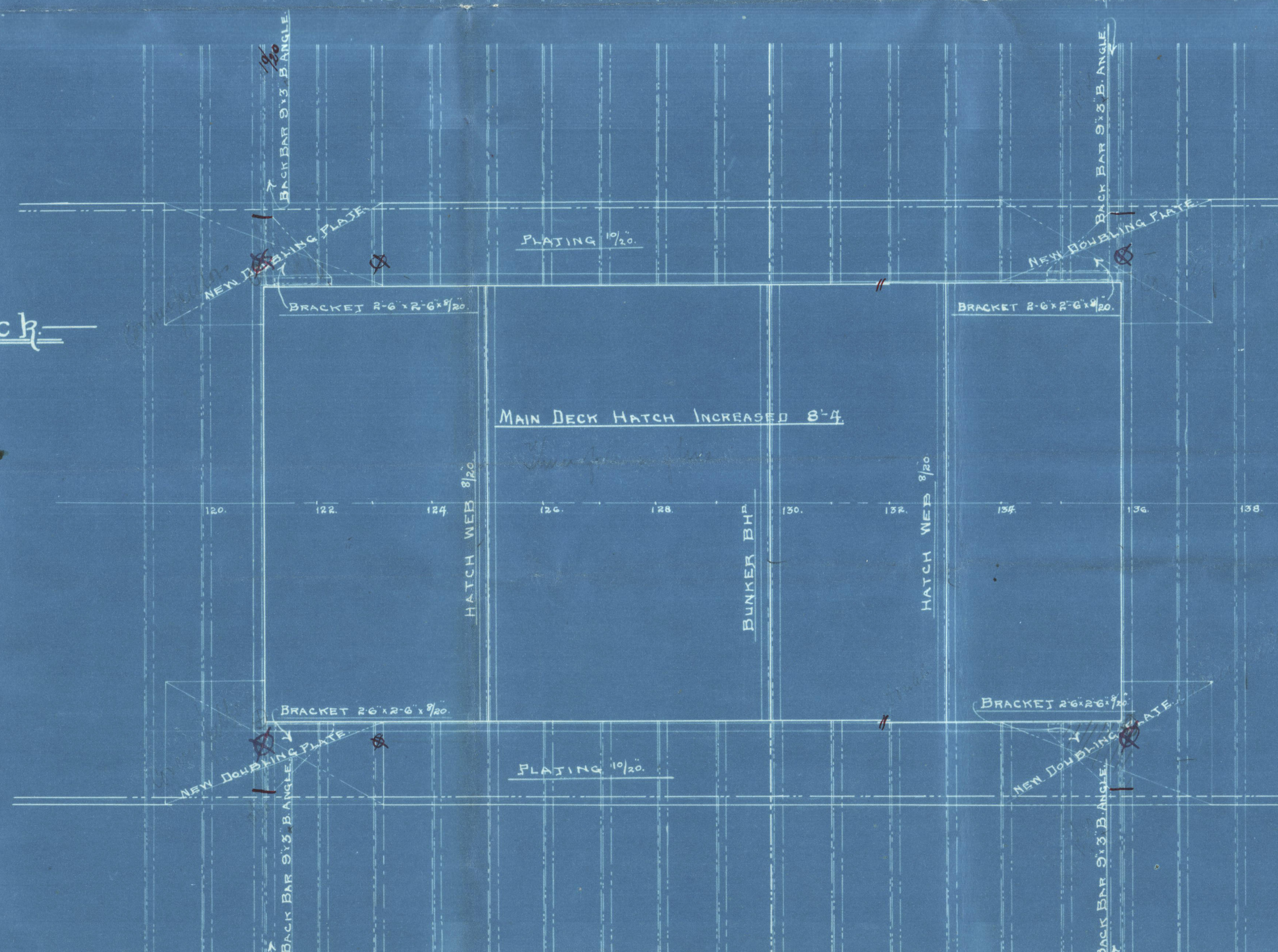

*Three fore and aft to be fitted*

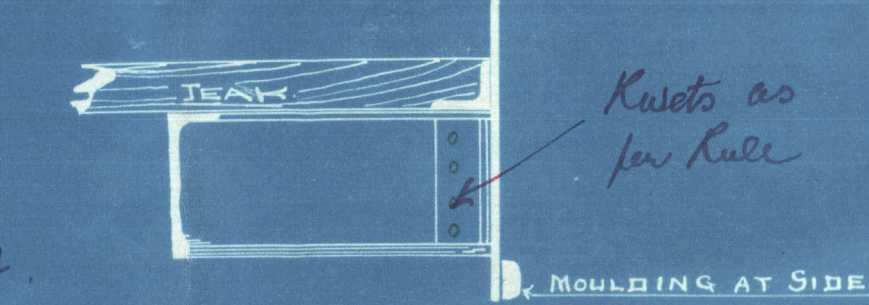

*Sides of hatchways supported by pillars as per Rule.*

SKETCH OF SHELTER DECK HATCH COAMING AS FITTED IN SHIP

SCALE OF SKETCHES 1" = ONE FOOT.

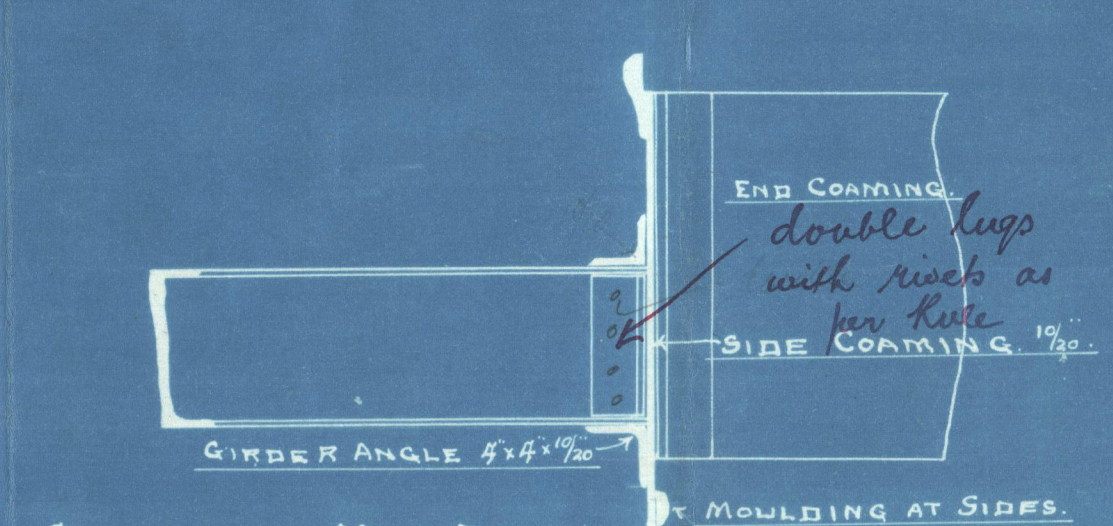

SKETCH OF MAIN DECK HATCH COAMINGS AS IN SHIP

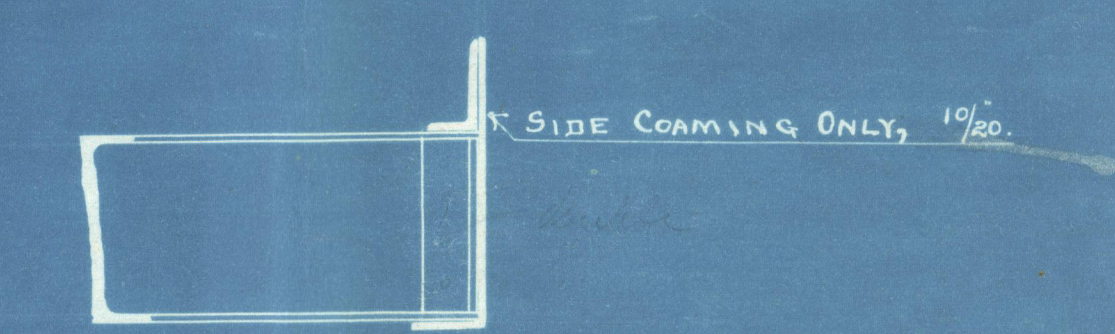

SKETCH OF LOWER DECK HATCH COAMING AS FITTED IN SHIP

Lower Deck

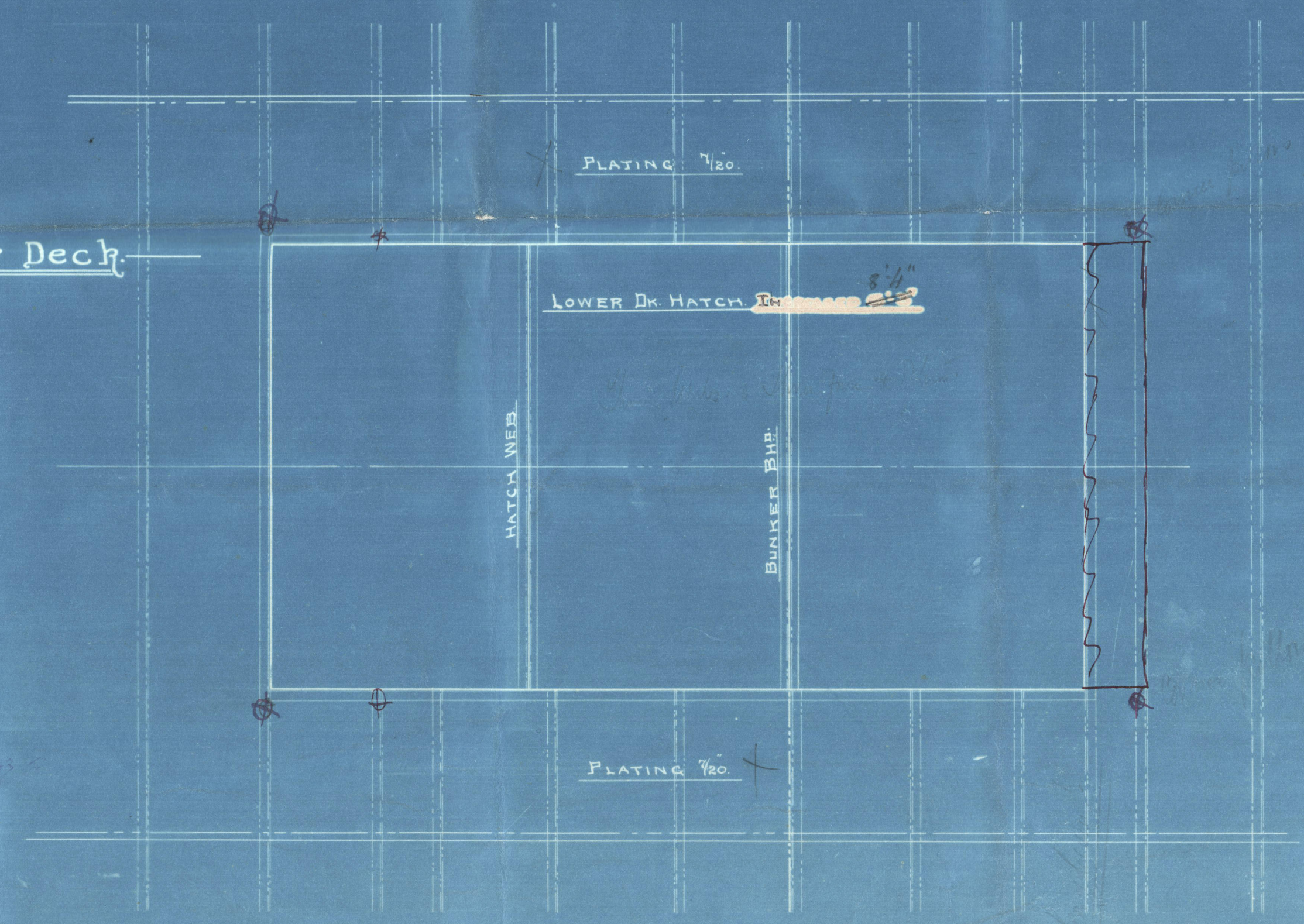

T.S.S. ITONUS

Plan Shewing Extension of Hatches As Now Proposed  
to be fitted in Shelter, Main and Lower Deck Hatches, into  
1/3 Fold.

Scale 1/4" = One Foot.

*C.B.  
16.10.07.*



Excursion of No 3 Natchways  
Greenock Bruntt Dyke No.  
Y.S.S. "Horus" ex "Anglio"

Greenock 4th No 15291

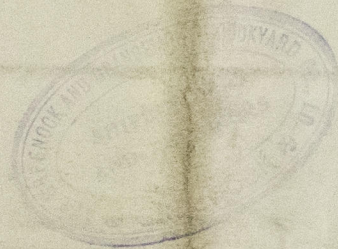
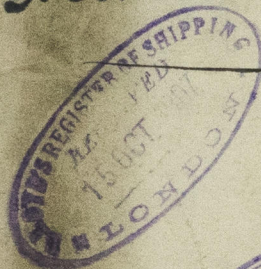

GRX355-0122

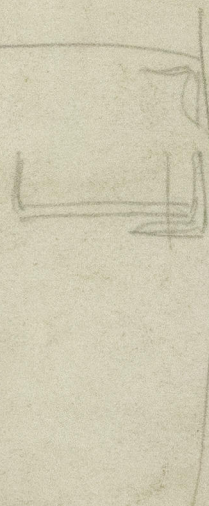

© 2020

Lloyd's Register  
Foundation