

Received at

Office,

1899

## Lloyd's Register of British and Foreign Shipping.

(Report on Vessel No. \_\_\_\_\_)

Port

Hull

No. 4646 SHIP FORGINGS ~~OR CASTINGS~~.

I have to report that the undermentioned Iron or Steel Forgings ~~or Castings~~,  
 manufactured by *The Blaydon Forge Co*  
 of *Blaydon* for the Vessel No. *8*, being built  
 by *Messrs Hagerup D & S* of *Hull*  
 have been inspected by me as set forth below, and found to be, so far as can be seen,  
*sound*

*Fitted in No 7. s/s "King William" B.S.O.*

Mark on Forgings.

Lloyd's

No. 8696B

JB

*John C Craig*  
*Newcastle*

	STERN FRAME.	RUDDER FRAME.	STEM.
Material* ...	<i>Scrap</i>	<i>Scrap</i>	
How made ...	<i>Forged</i>	<i>Forged</i>	
Dimensions ...	<i>6 - 2 1/2</i>	<i>3 1/4 - 2 1/4</i>	
Progress on Inspection	<i>Forged &amp; Smothered</i>	<i>Forged &amp; Smothered</i>	
Date when Inspected	<i>November 25th</i> <i>December 20/28</i>	<i>November 30/28</i> <i>to January 13/29</i>	

SKETCHES OF FRAMES SHOWING POSITION AND DESCRIPTION OF WELDS OF FORGINGS, OR PARTICULARS OF TESTS APPLIED TO CASTINGS.

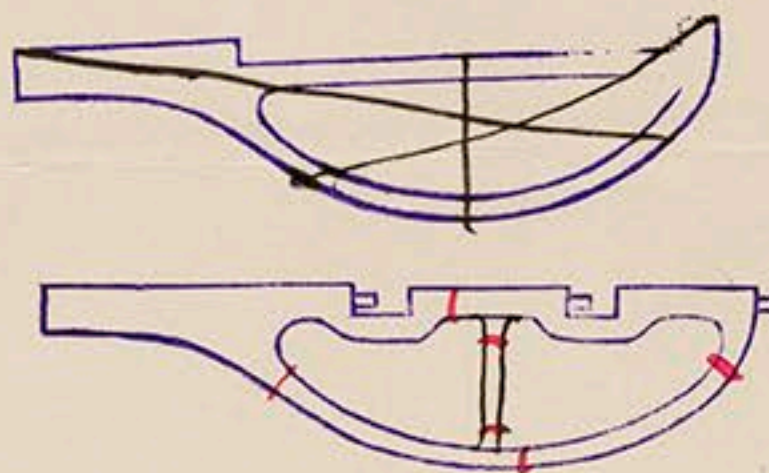
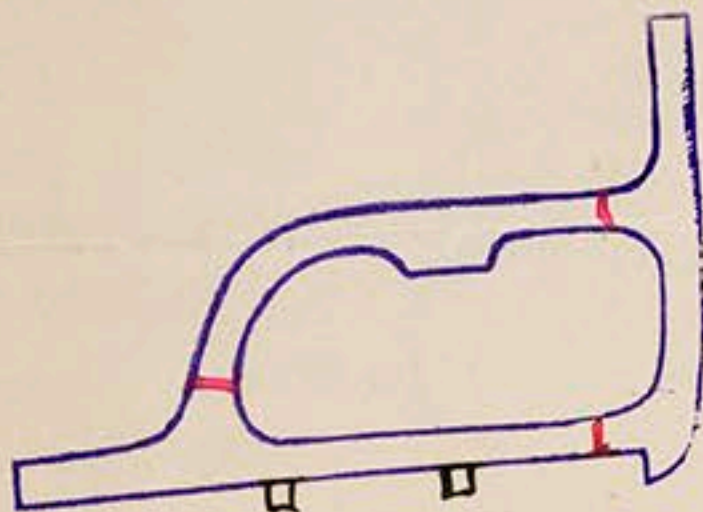

*welds*

Fee (if any chargeable) £

To be paid at

\* If of Iron, state whether scrap or puddled Iron.