

LLOYD'S REGISTER OF SHIPPING
 22.11.98
 15.12.98 (Nos 261, 234)
 16.1.00

Outline Elevation of Screw Steamers Nos 259 & 260, also 261, 262, 263 and 264
 To Class 100 A.I. Lloyd's (Steel)
 Scale 1/4 inch = one foot
 appd: 15/12/98

A. & J. NOLLS
 14 NOV 98
 SHIPBUILDERS
 GLASGOW

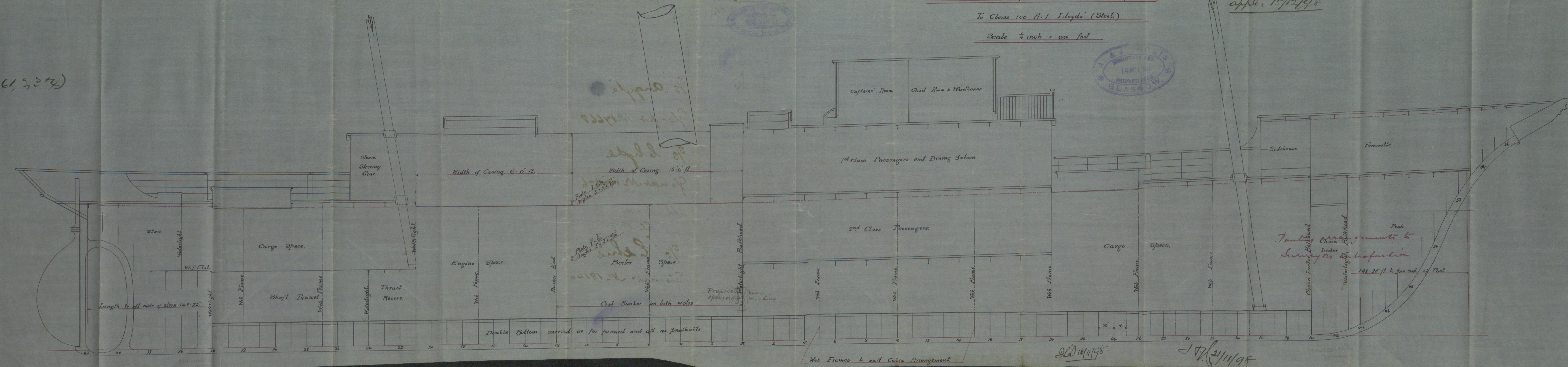

259¹⁶⁰

GLS 285-0094



2612³⁴

5/5 Argyle 

Gls n^o 14668

5/5 Clyde

Gls n^o 1445-6

S.S. Dundee

Gls. 18075

5/5 "Echie"

Gls n^o 18140



© 2019

Lloyd's Register
Foundation

Arrangement.