

ELEVATION AT DIVISIONAL BULKHEAD.

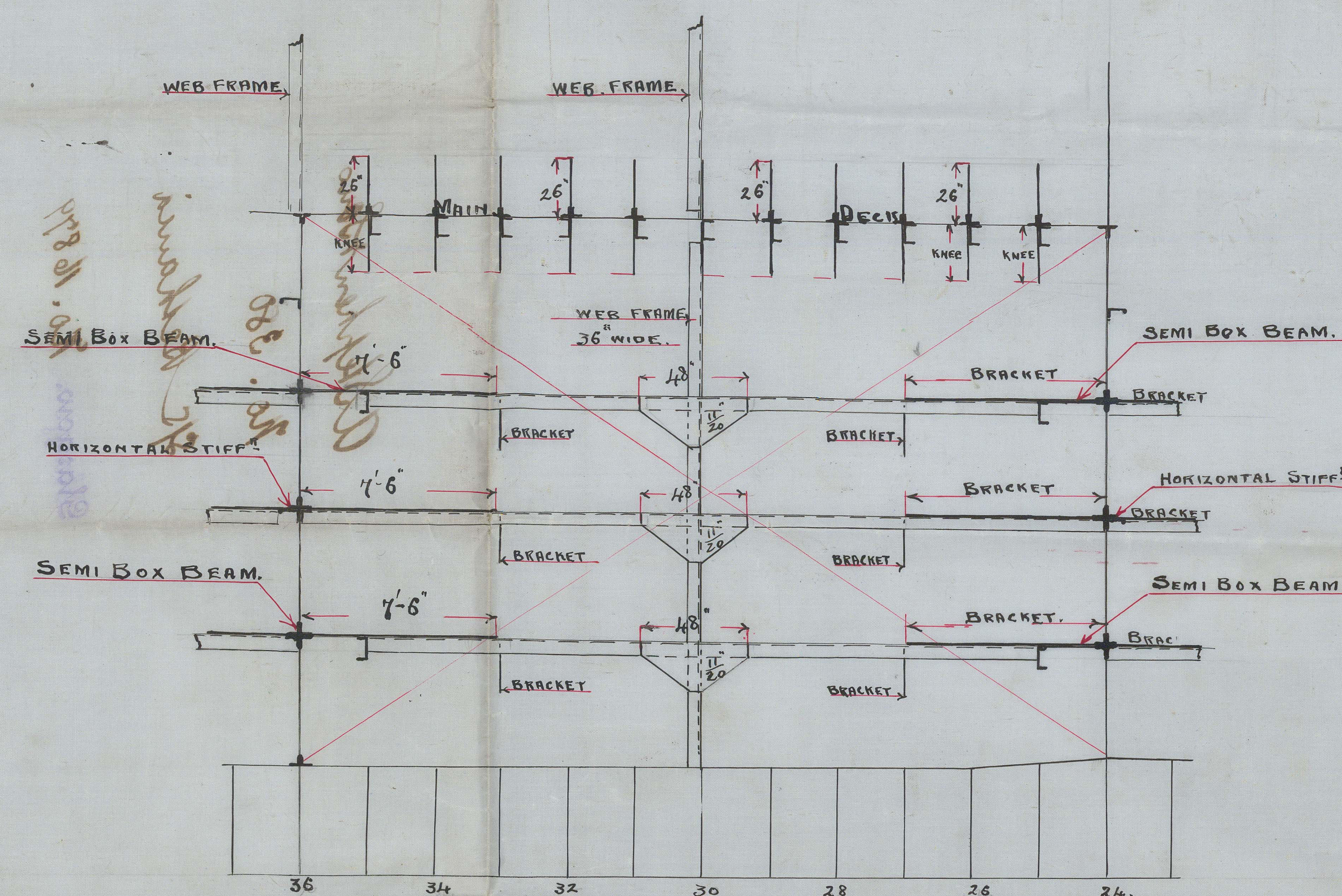

ELEVATION AT SHIPS SIDE.

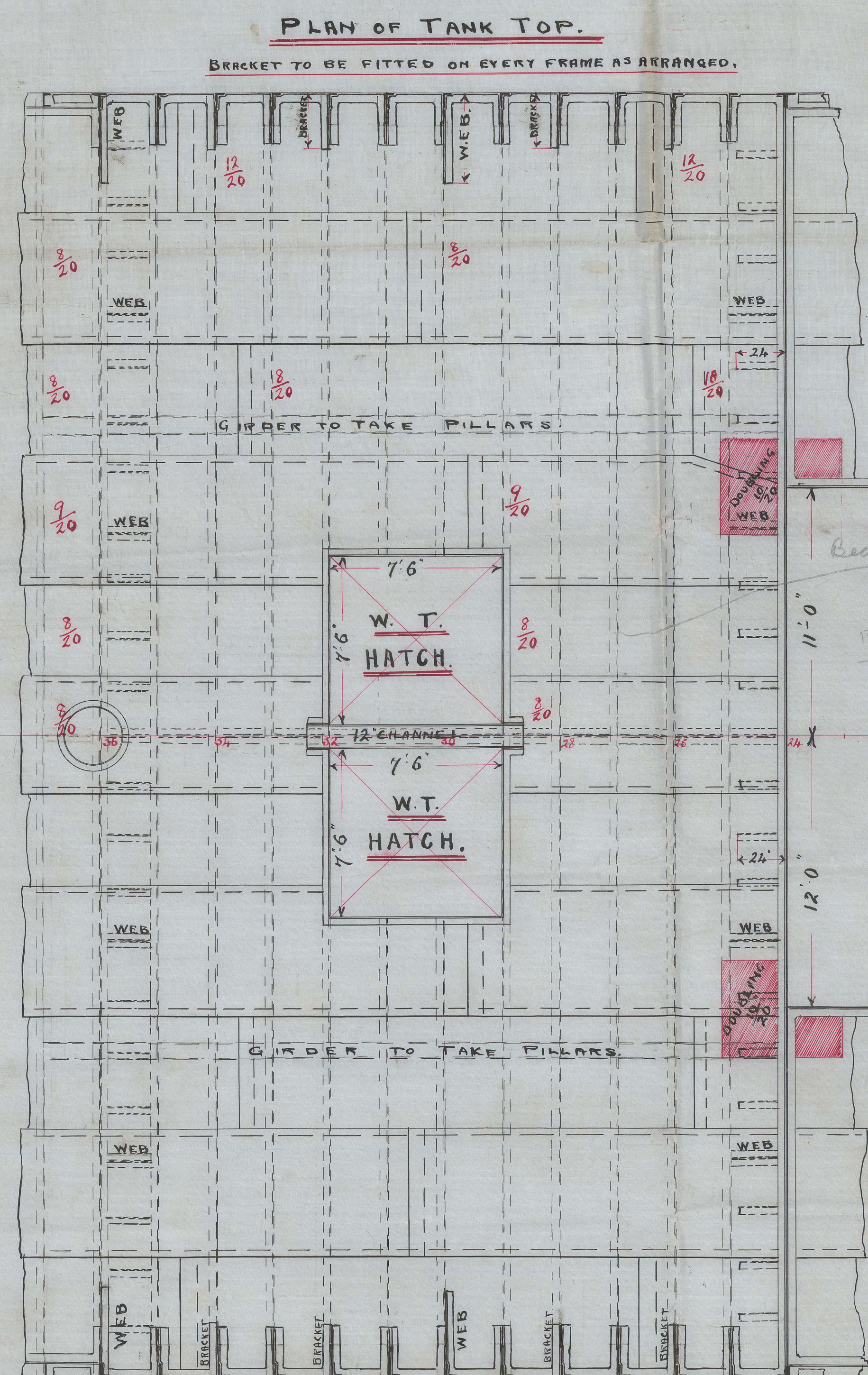

PLAN OF TANK TOP.

BRACKET TO BE FITTED ON EVERY FRAME AS ARRANGED

ELEVATION OF BULKHEAD N°36

LOOKING AFT.

$$\frac{4.75^2 \times 2.25 \times 35}{35 \times 11.8} = 4.3 \text{ test}$$

SECTION OF GIRDER FITTED TO STIFFENERS  
MARKED ON PLAN WITH BRACKETS FITTED  
AT TOP & BOTTOM & AT SEMI-BOX BEAMS

AT TOP & BOTTOM & AT SEMI-BOX BEAM:

AT TOP & BOTTOM & AT SEMI-BOX BEAM:

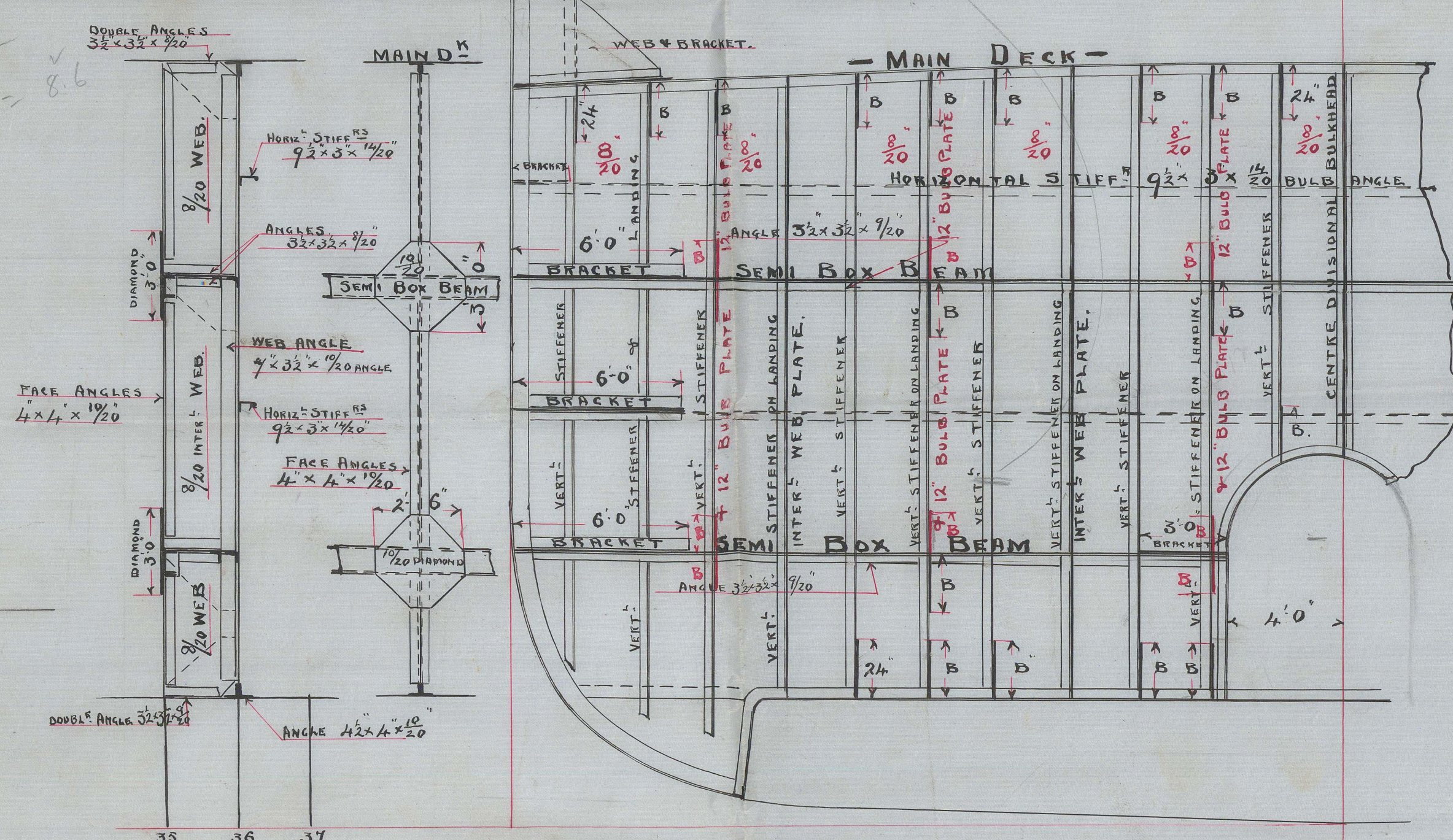

ELEVATION OF BULKHEAD N<sup>o</sup> 24.

LOOKING FORWARD

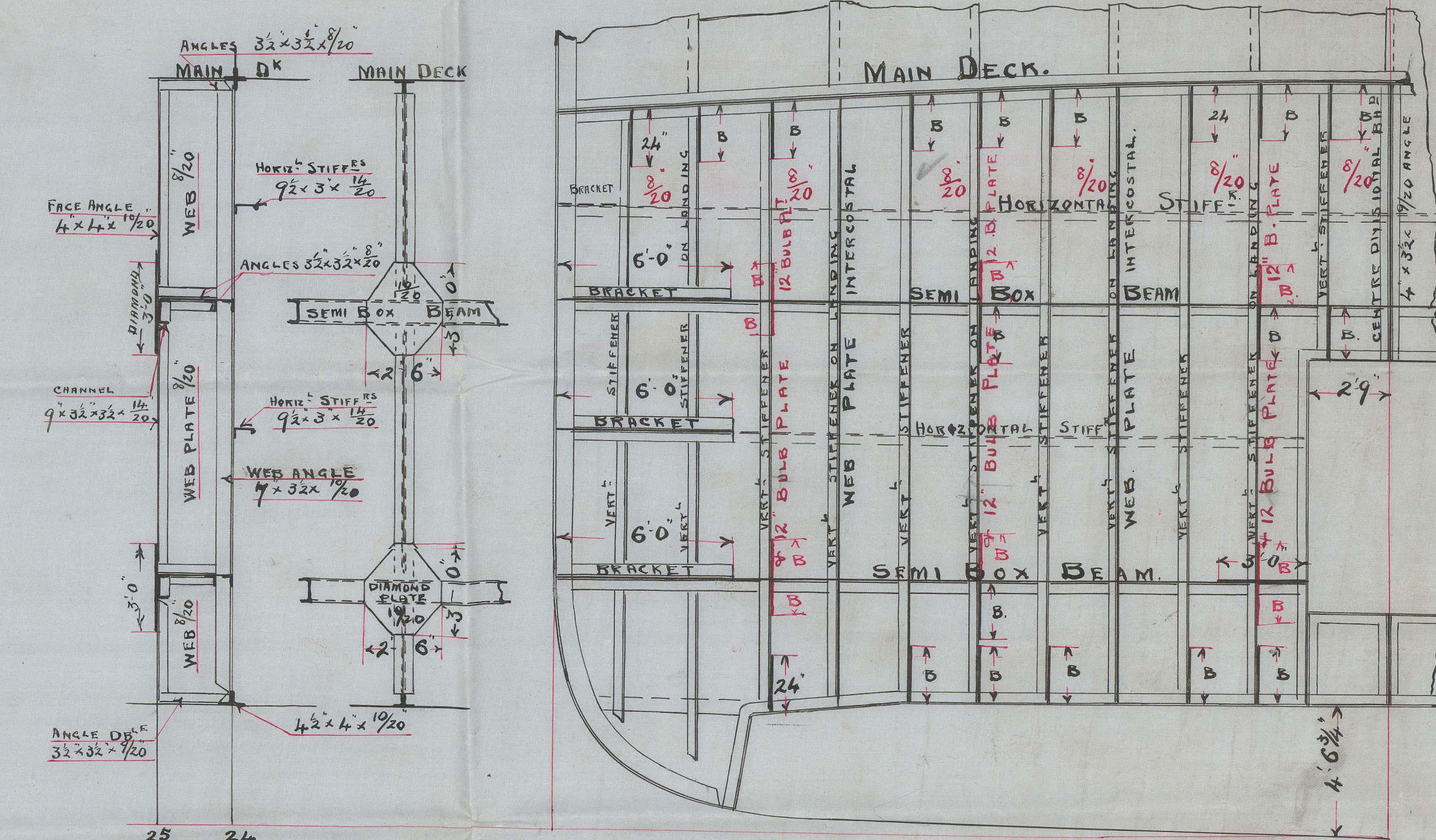

# DEEP TANK

# PLAN

N<sup>o</sup> 380

similar to 85 Bengalia no 377

SCALE  $\frac{1}{4}$  INCH TO 1 FOOT

Alex Stephen & Sons  
SHIPBUILDERS & ENGINEERS  
(GLASGOW)

SHIPBUILDERS & ENGINEERS.

EX. LSGOTV

DRAWING № 9482

24/2/4

卷之



1-9  
A Stephen & Sons

No. 380

45 Bethania

Glasgow No. 16879

МАТЕВ ДОХ ІМАЗ

МАТЕВ ДОХ ІМАЗ

SEMI BOX BEAM.

HORIZONTAL STIFF

МАТЕВ ДОХ ІМАЗ

© 2021

Lloyd's Register  
FGLS275A-0072