

19696

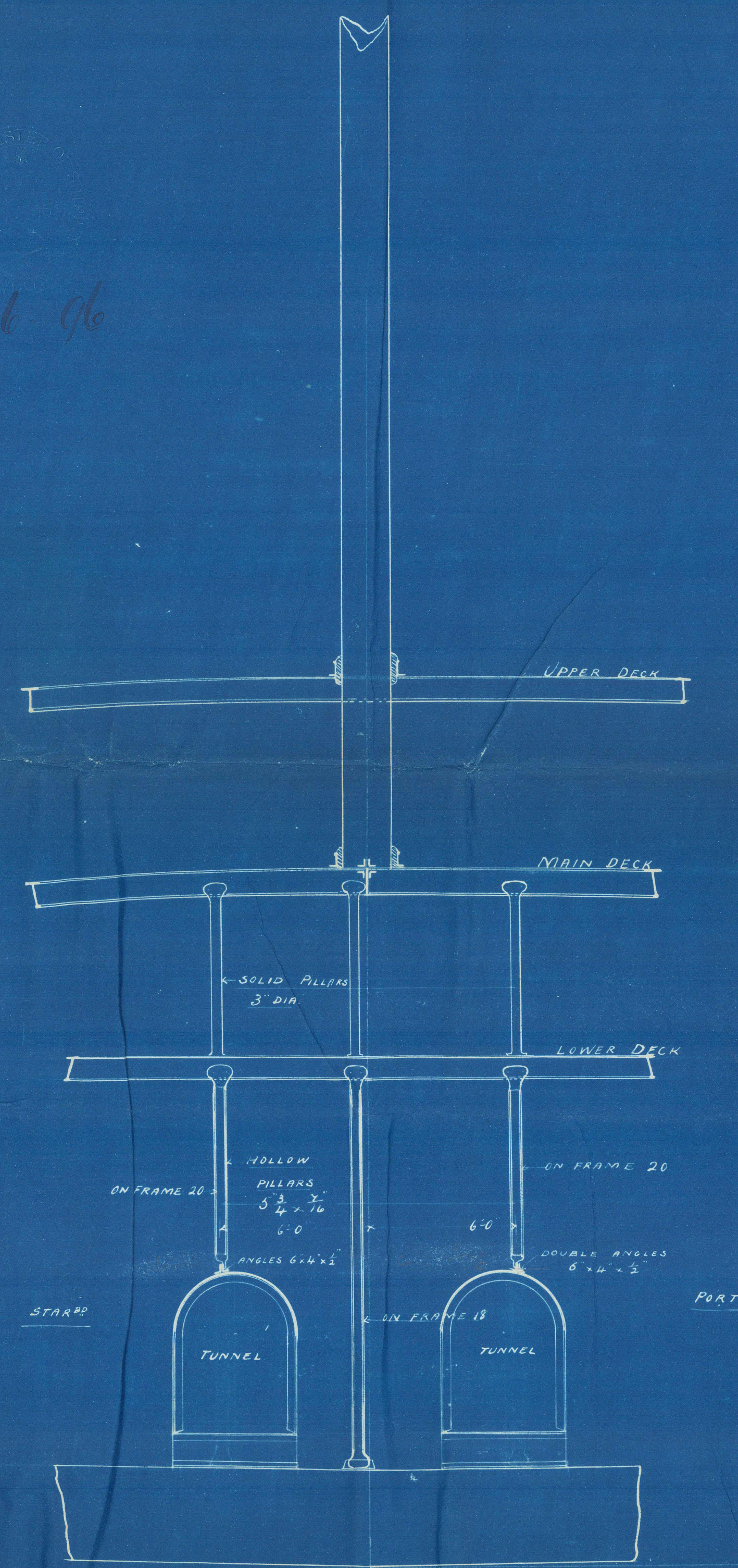

— JIGGER MAST —

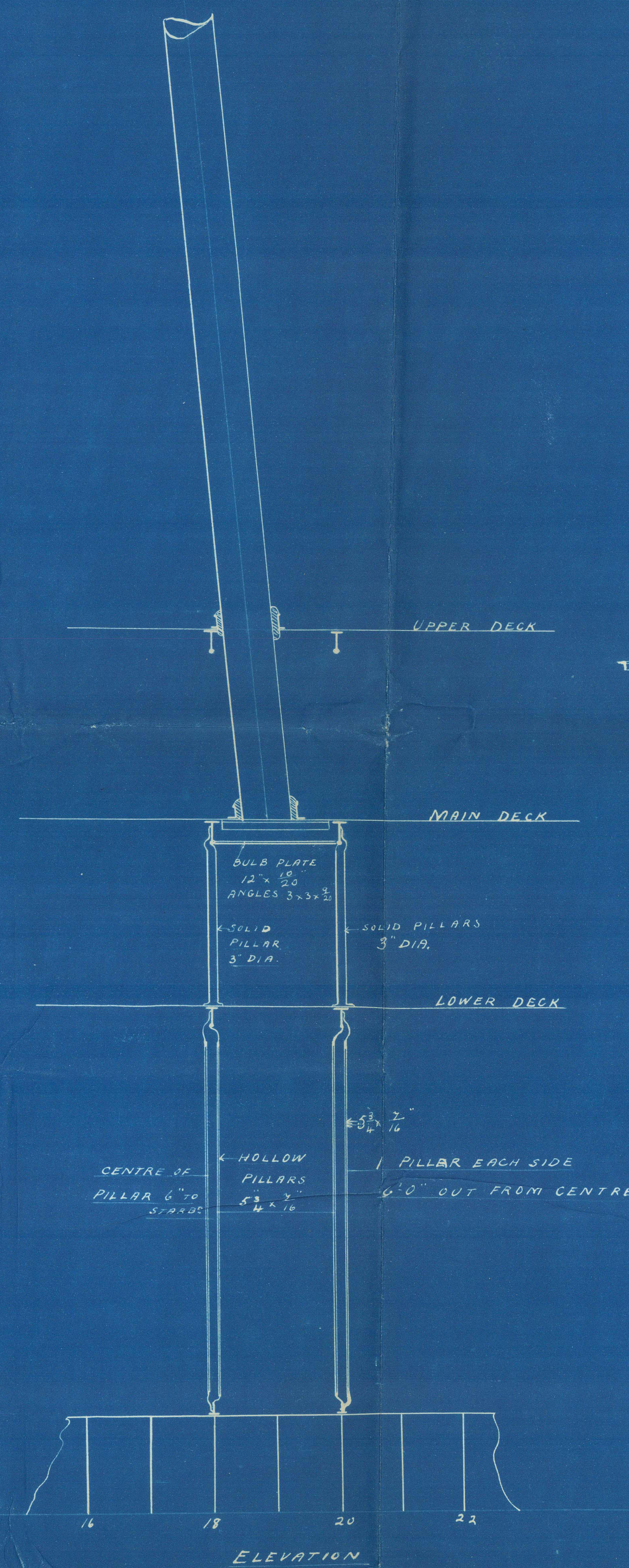

— MIZEN MAST —

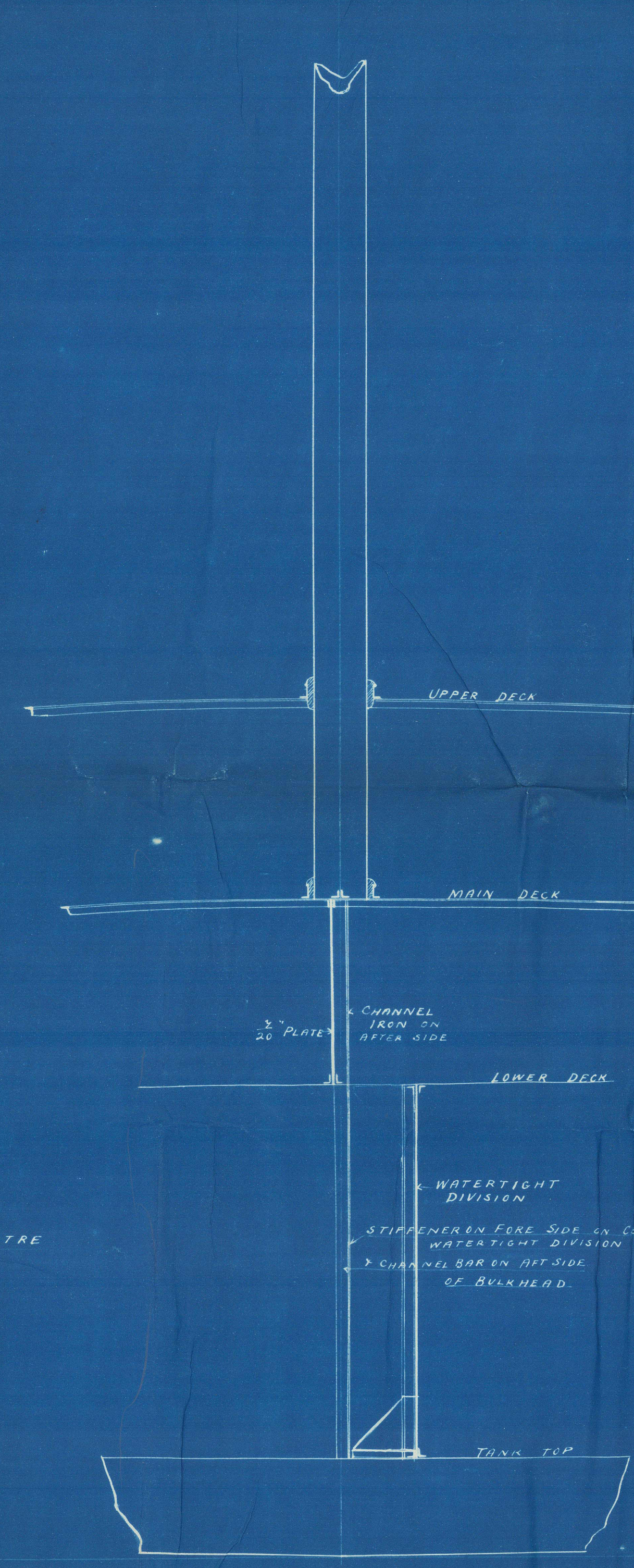

— MAIN MAST —

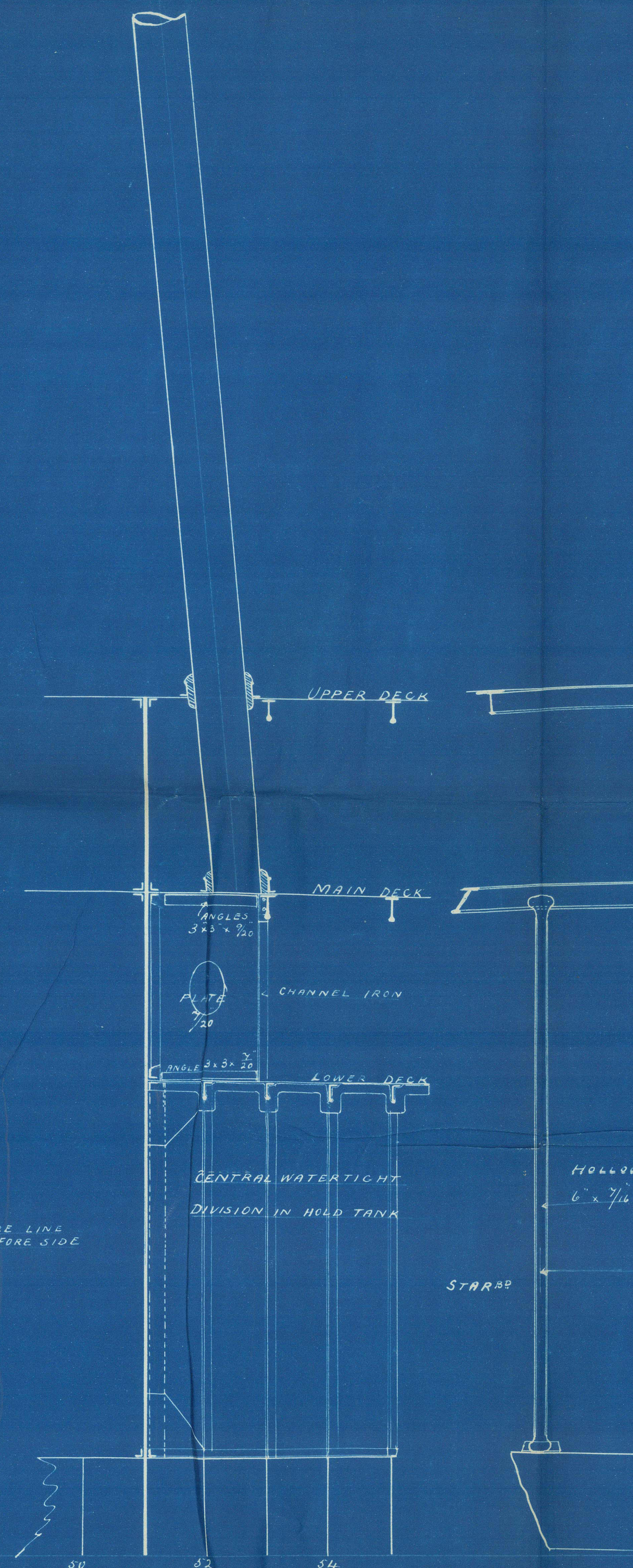

— FORE MAST —

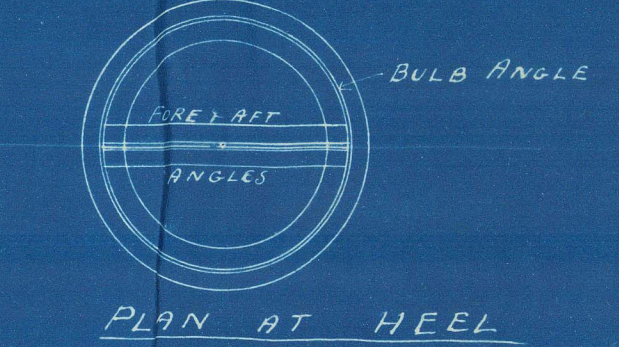
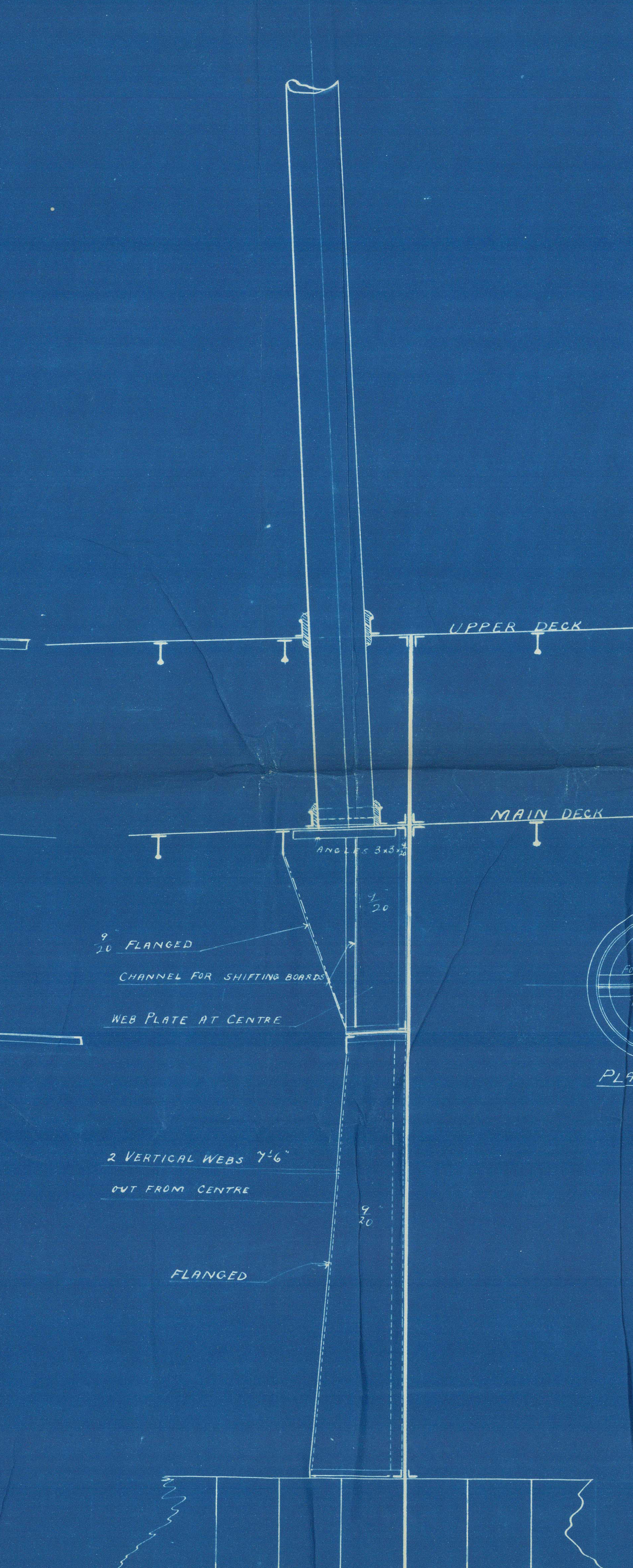
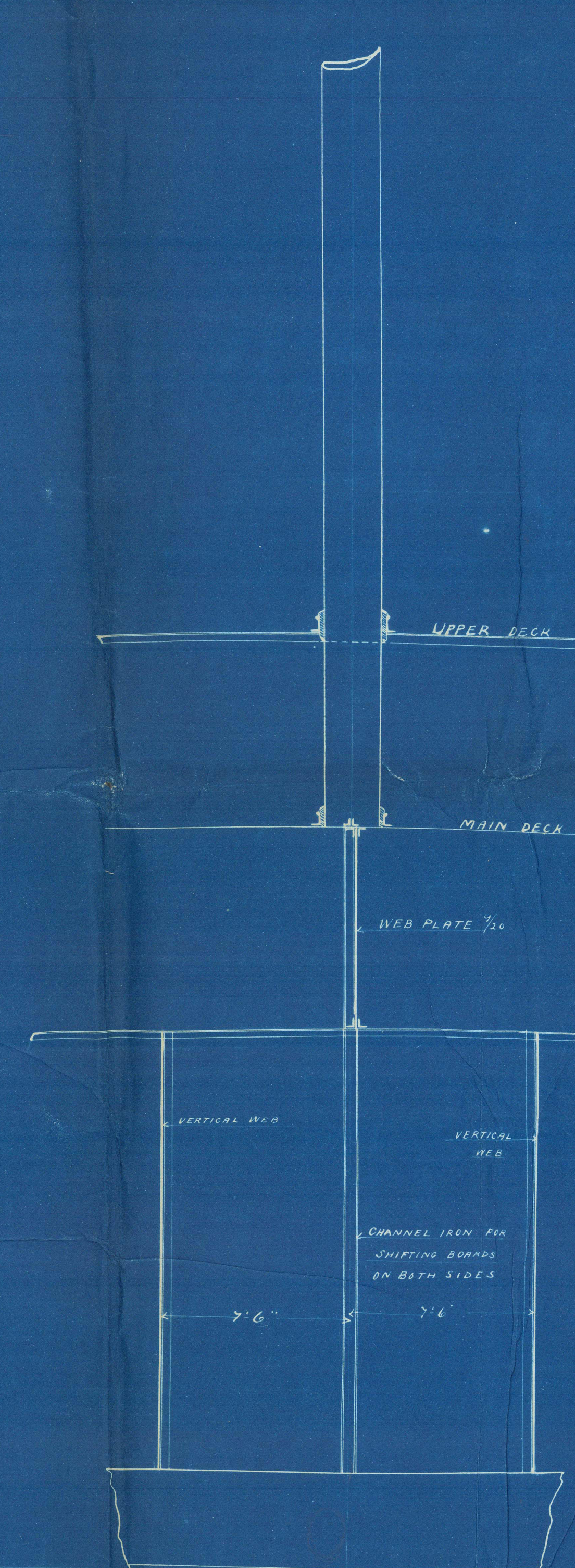
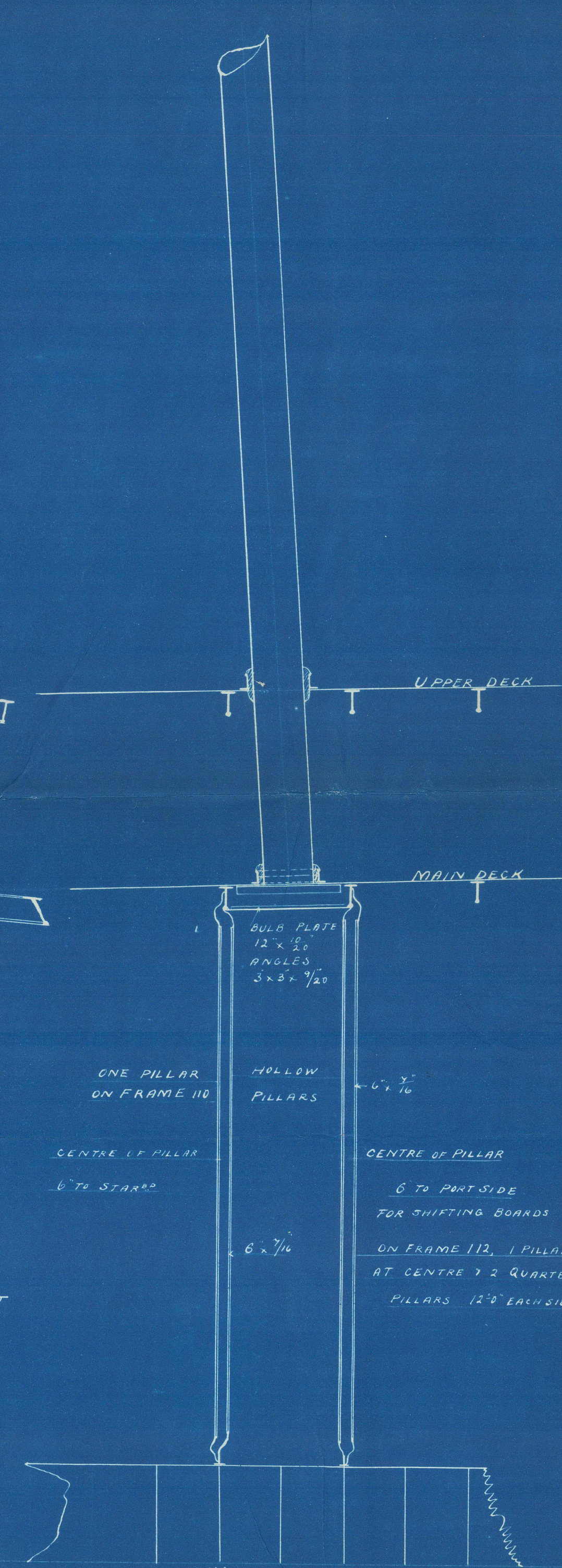
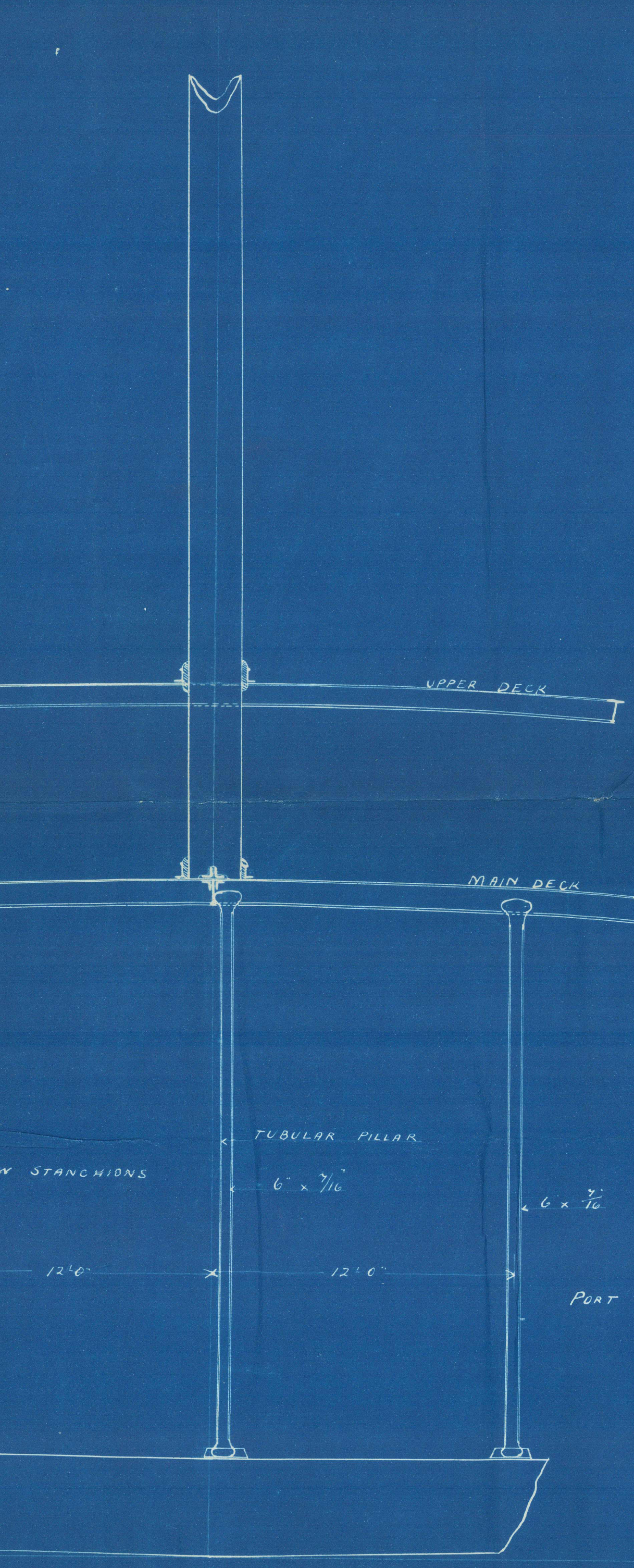

— T.S.S. Nos 394 & 5 —  
STIFFENING UNDER MASTS  
Scale 1/4" = 1 FOOT

19696



S. S. "Kanagawa Maru" Glasgow Report N<sup>o</sup> 14840.  
S. S. "Hakata Maru" — do — 15019.

Not Vuppert

394 395-

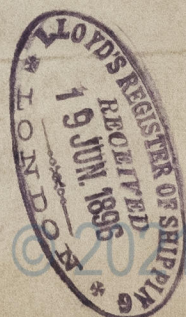
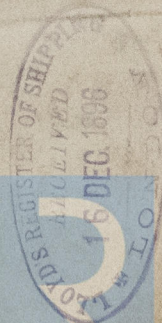

Lloyd's Register  
GLS258-0104  
Foundation