

25-3-96
 600 6.5 11
 100 3.9 11

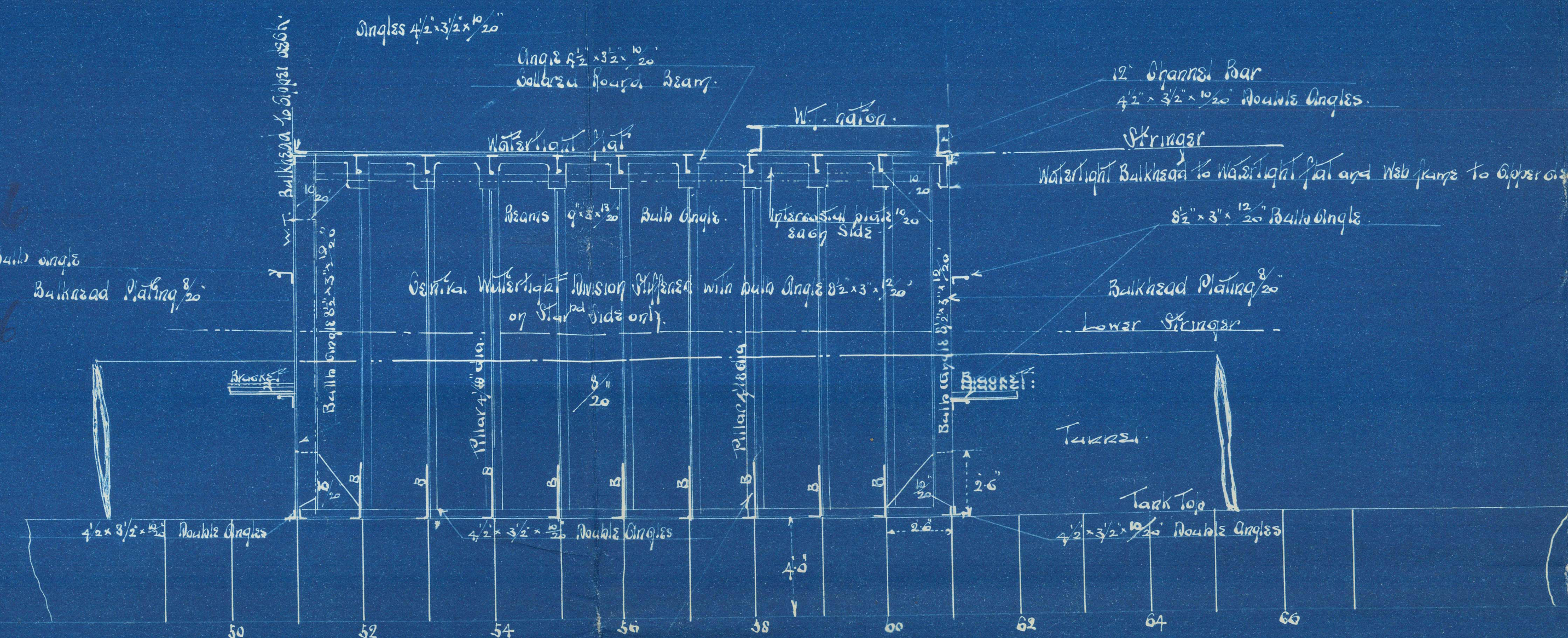

Plan of Ballast Tank in No 5 Hold

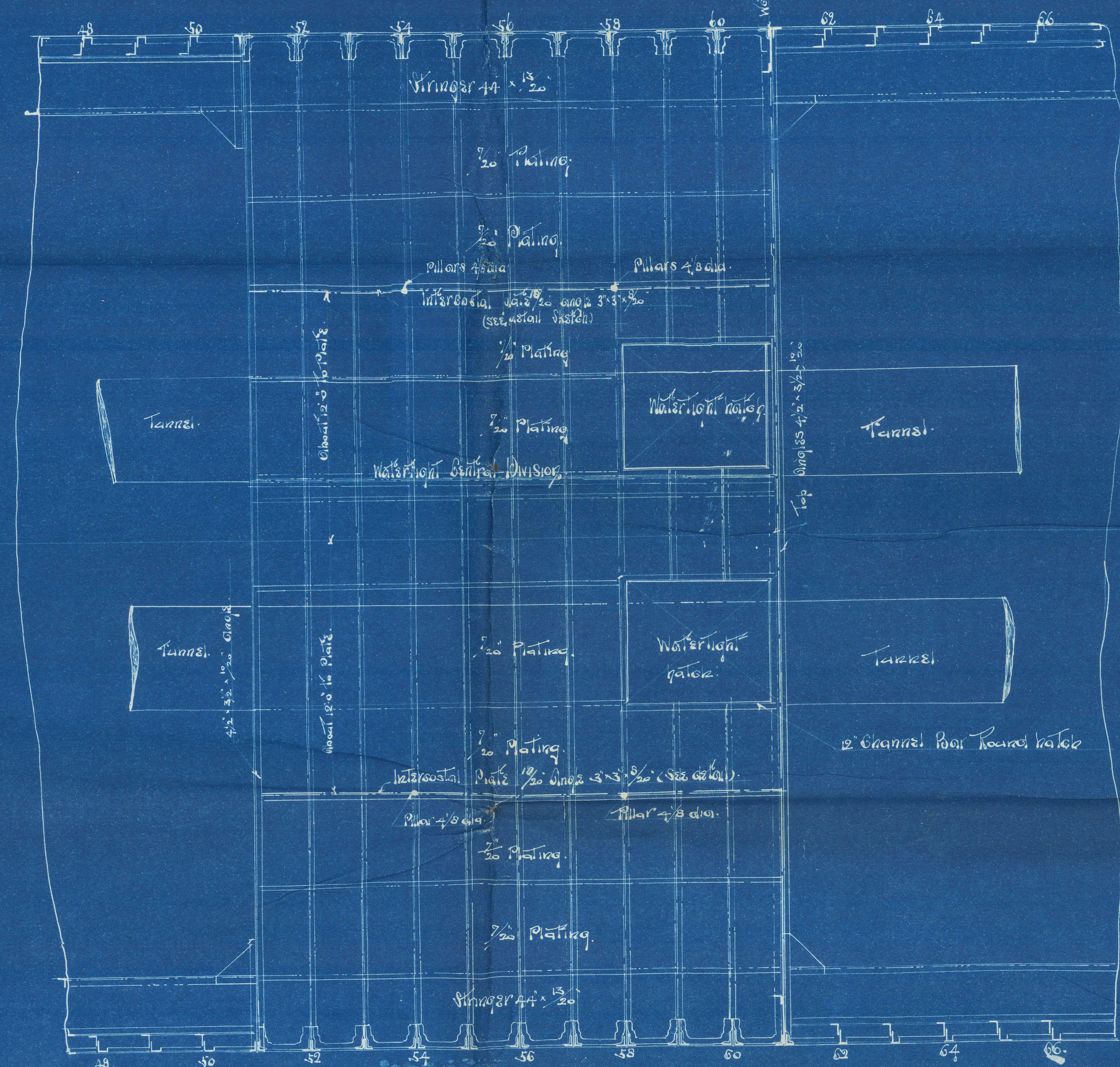

Plan of Waterlight Division

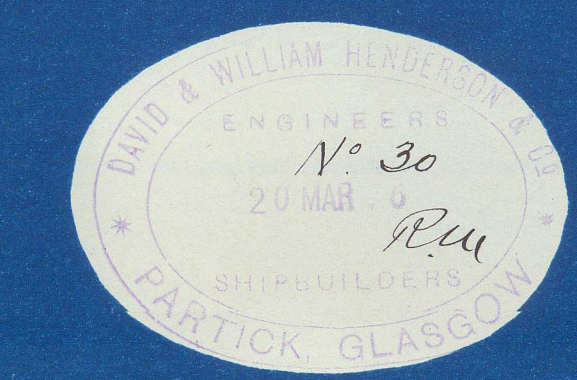

PLAN OF BALLAST TANK IN NO 5 HOLD

S S Nos 594-5

Scale 1/4" = One foot

Dec 31st 1914
 1 345

Plan of Waterlight Division

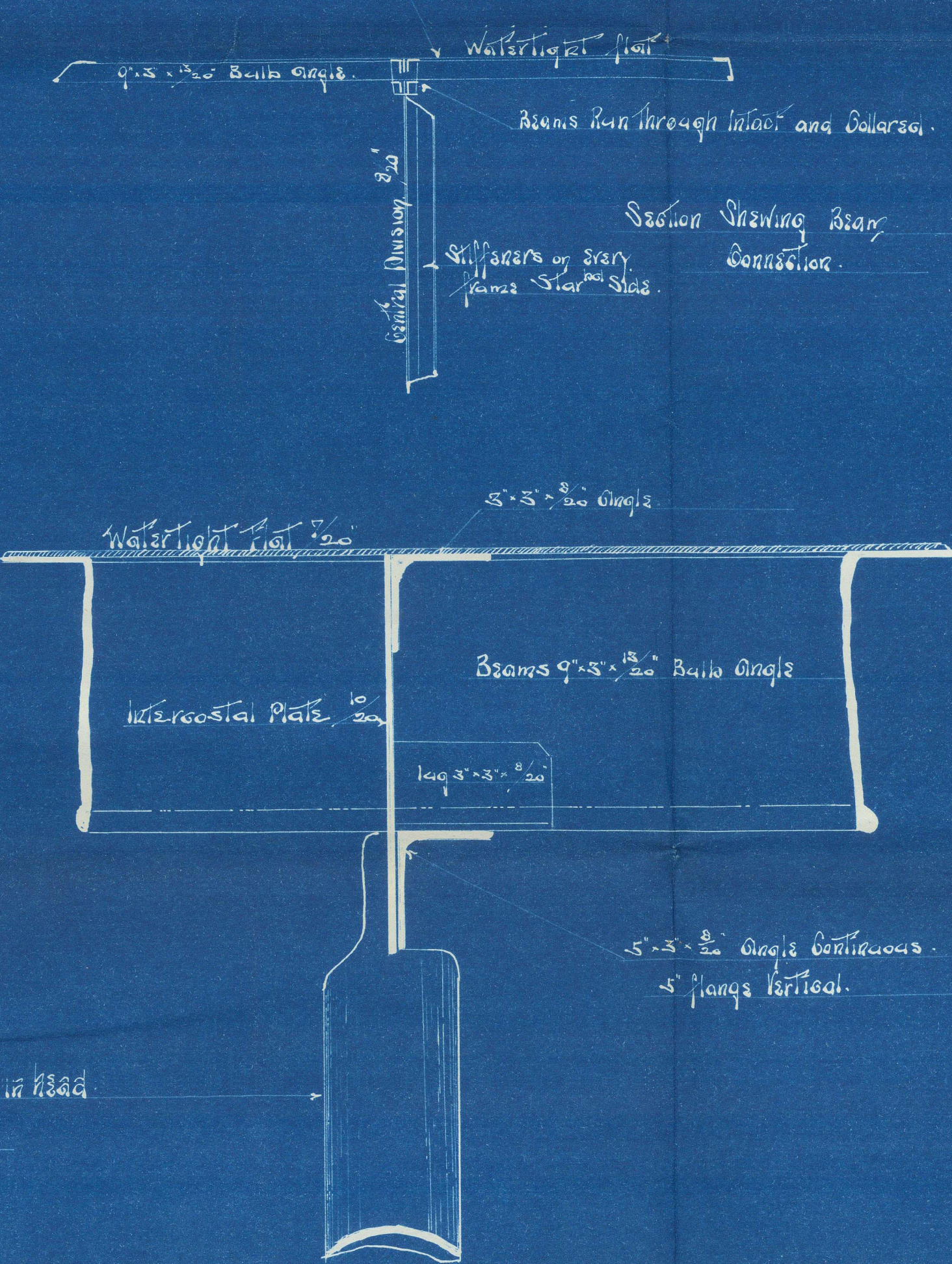
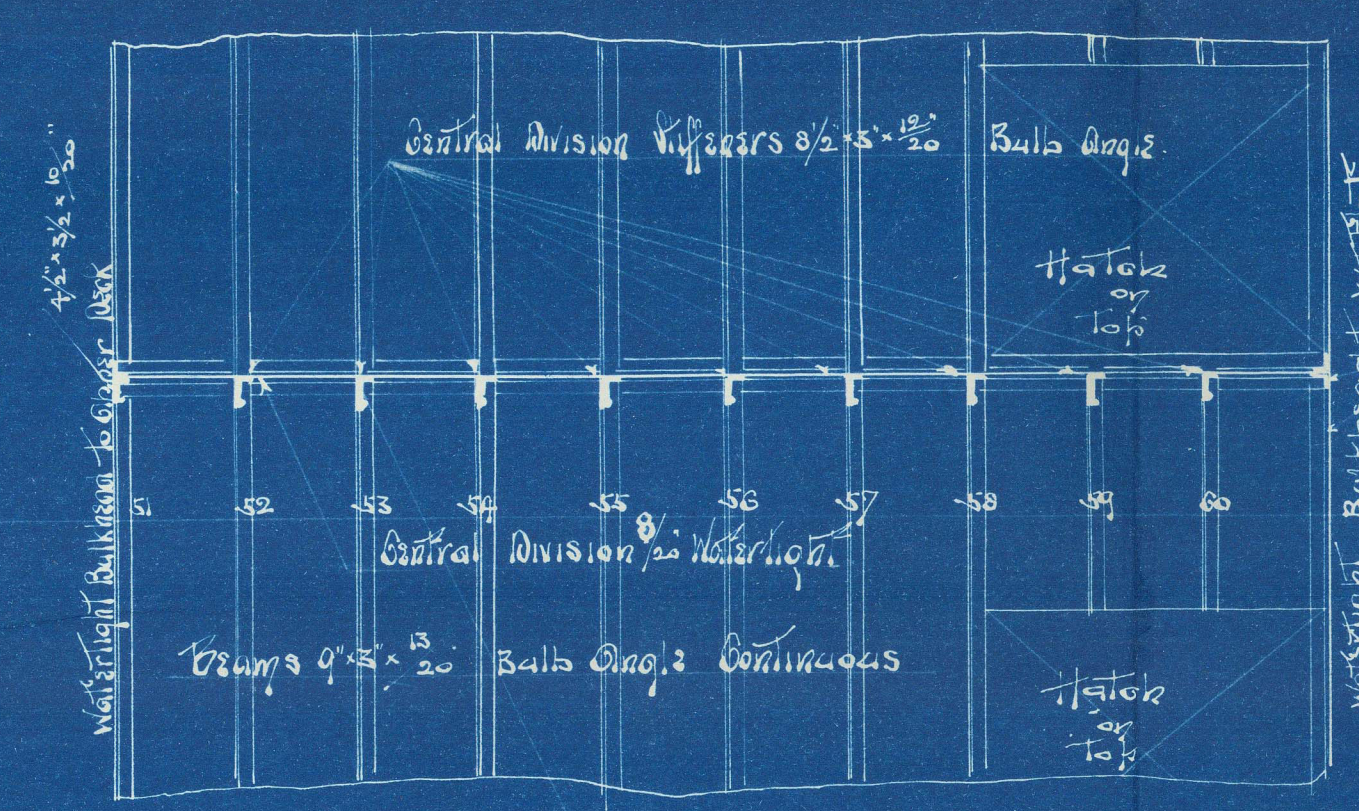

Section of Waterlight Division

Scale 1/2" = One foot

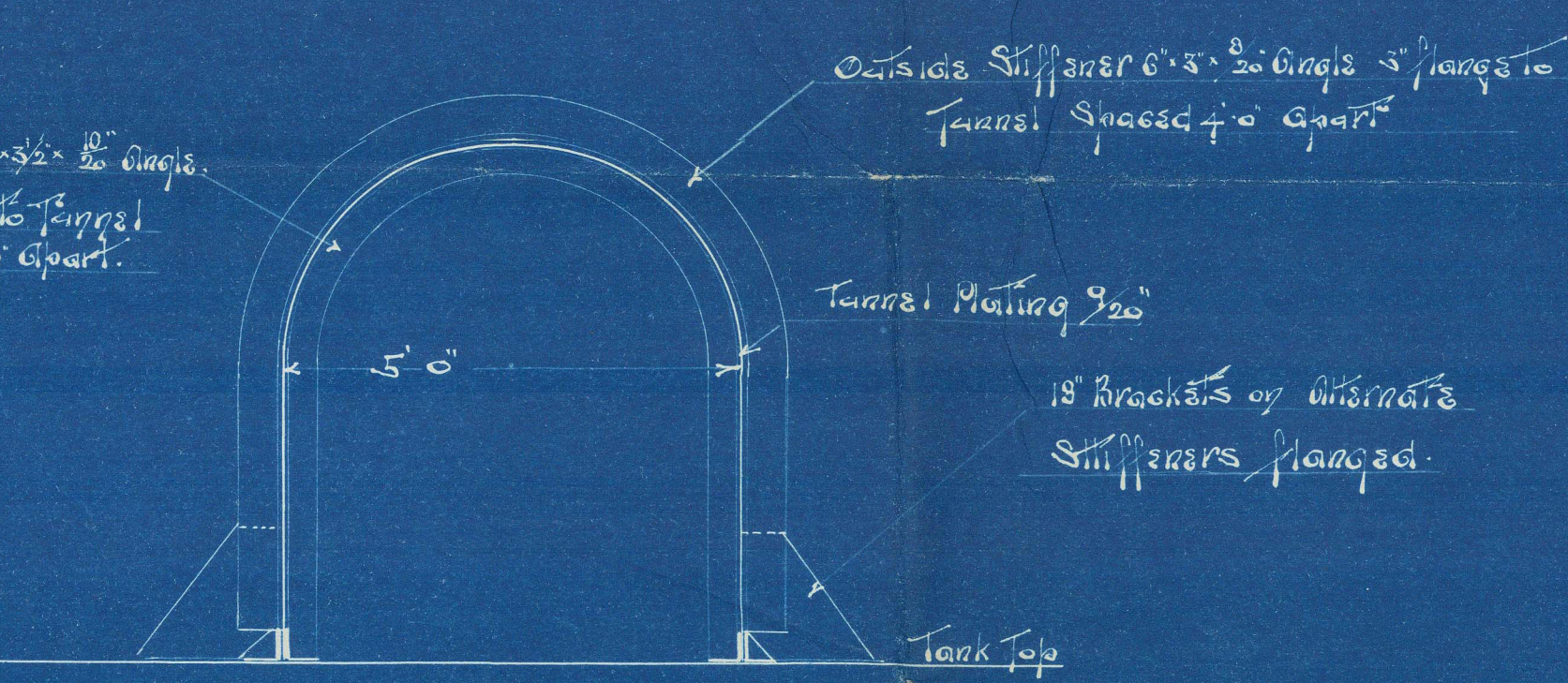

Section of Waterlight Division

Scale 1/2" = One foot

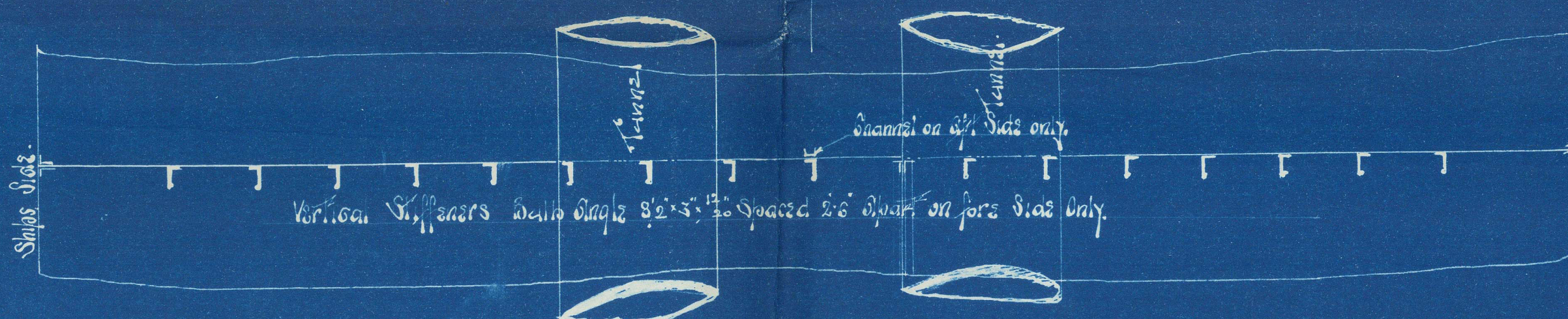
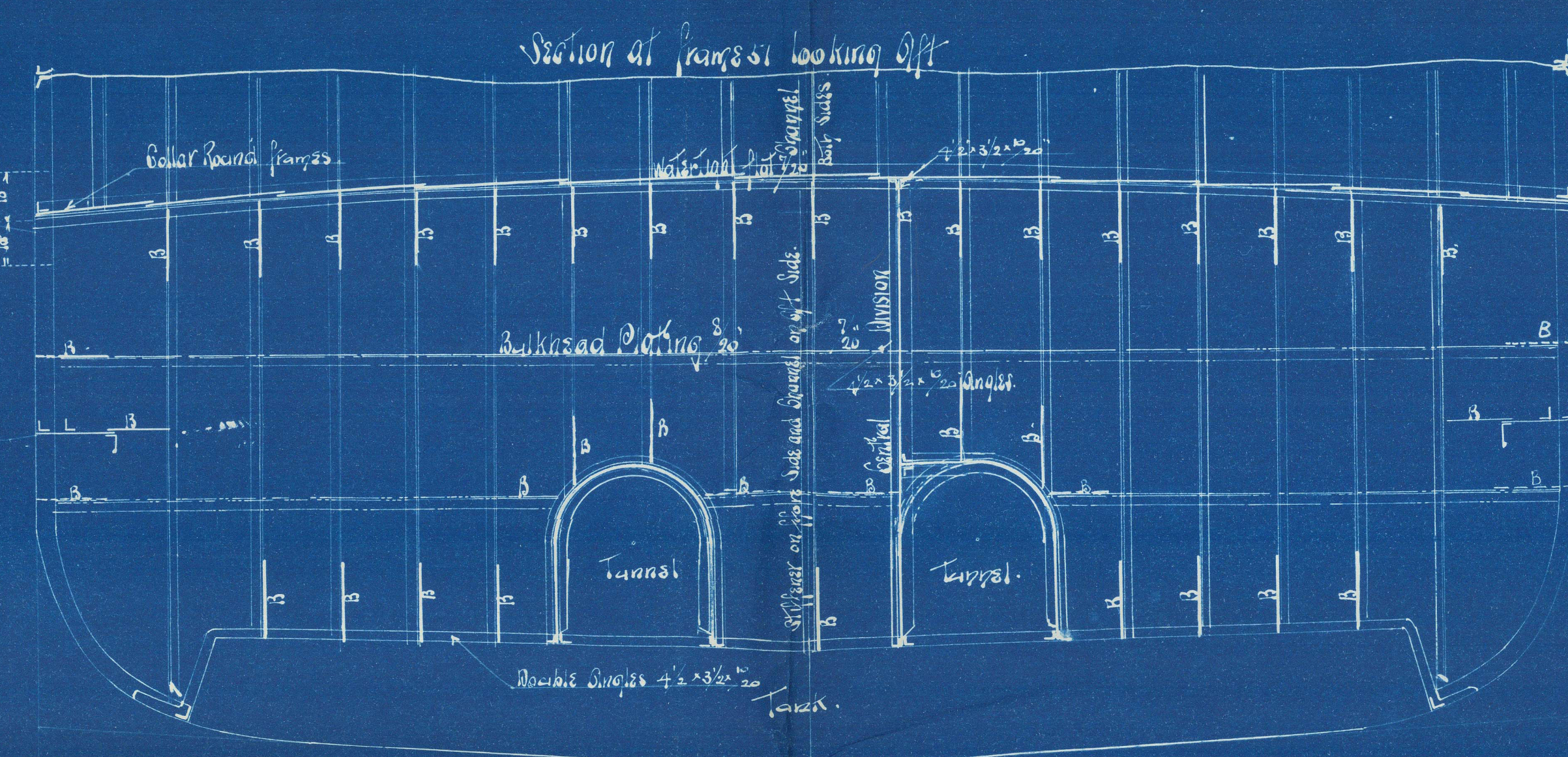

Section of Tank looking aft

Notes: Ballast Tank with Vertical Stiffeners of Ball Angle 8"x8" spaced 30" apart and connected to Tank Top by Vertical Stiffeners 8"x8" spaced 30" apart. Ballast Tank with Vertical Stiffeners of Ball Angle 8"x8" spaced 30" apart and connected to Tank Top by Vertical Stiffeners 8"x8" spaced 30" apart. Ballast Tank with Vertical Stiffeners of Ball Angle 8"x8" spaced 30" apart and connected to Tank Top by Vertical Stiffeners 8"x8" spaced 30" apart.

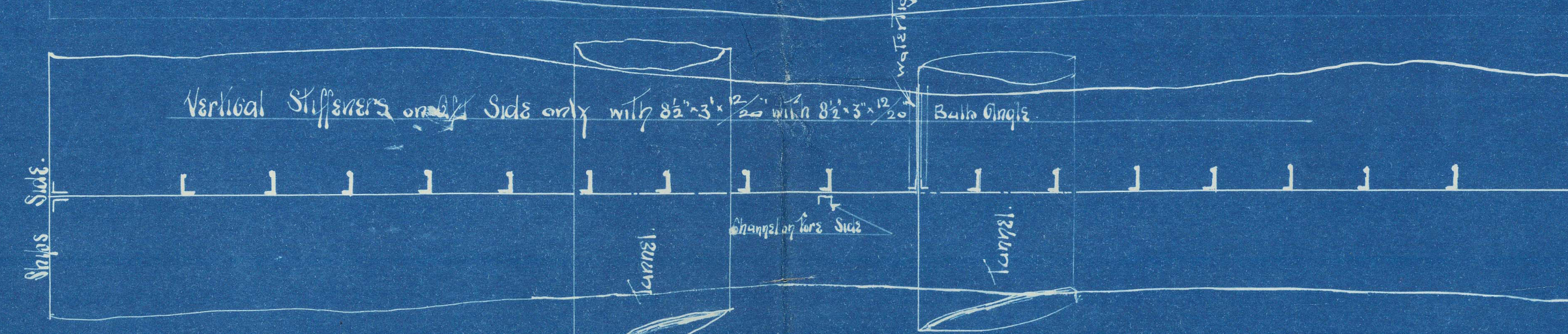
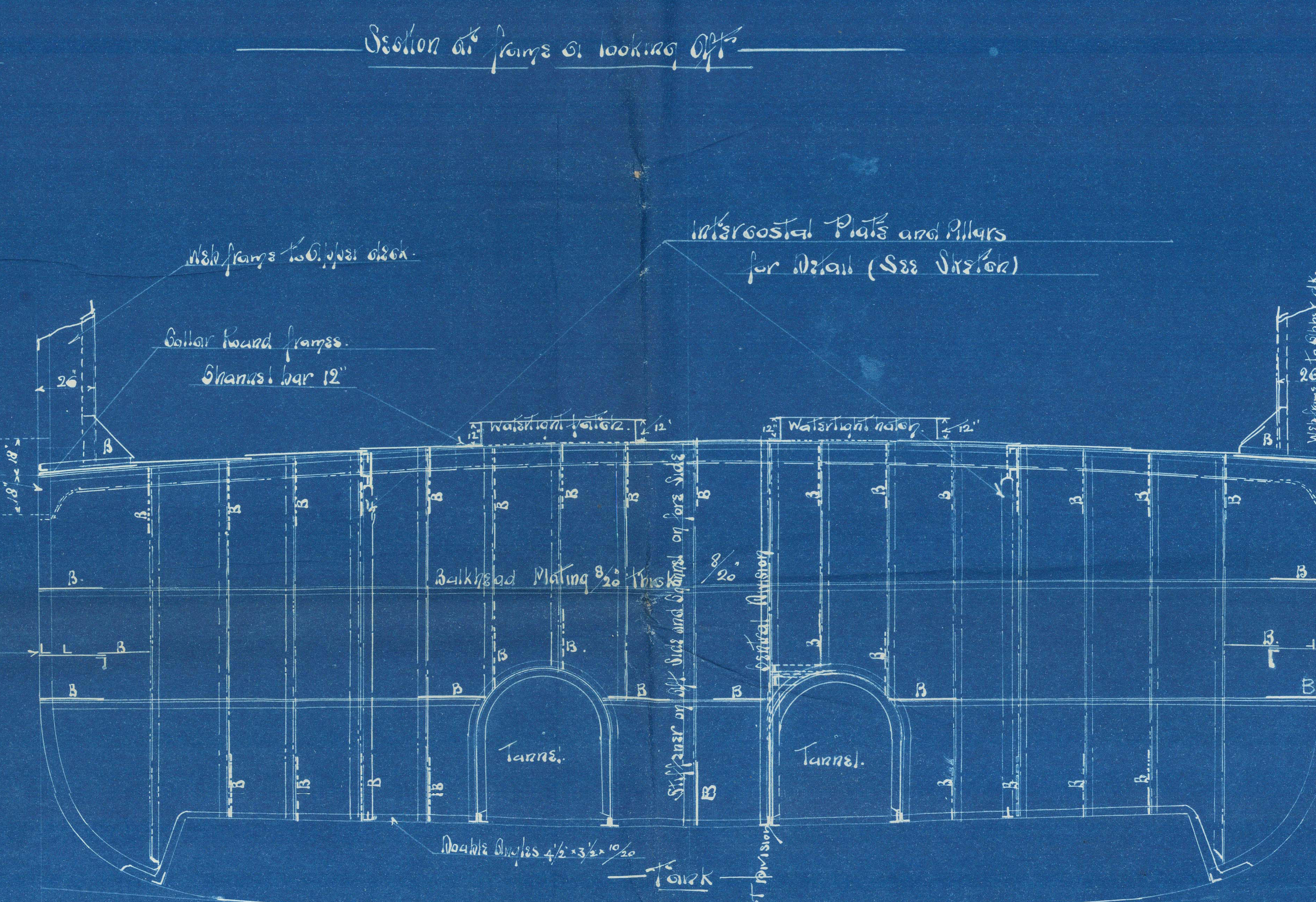

Section of Tank looking aft

S.S. "Kanagawa Maru"	Glasgow Report N ^o 4840.
S.S. "Hakata Maru"	do — 15019. —
S.S. "Wakasa Maru"	do — 15163. —
S.S. "Inaba Maru"	do — 15422. —
S.S. "Bingo Maru"	do — 15666. —

GLS258-0095

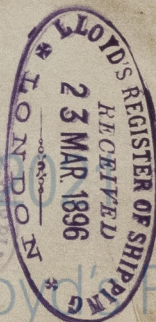

Lloyd's Register
Foundation