

Hand-drawn plan of the ship "SS. Albatross" showing the deck layout, compartments, and structural details. The plan includes the following labeled areas:

- Deck Level:**
 - Starboard Side (left): Lazarette, Aft. Peak, Sounding pipe, Deck Pump, Engine Bilge Section.
 - Port Side (right): Boatman's Store, Sounding pipe, Fore Peak, Deck Pump, Engine Bilge Section.
 - Central Deck: Dining Saloon, Lobby, Pentry, Engine Space, Coal Bunker, Boiler Space, Boatky Boiler, Chain Locker.
- Below Deck Level:**
 - Starboard Side: State Rooms, Passage, State Rooms, State Rooms, Company's, Engineers Room, Steam Steering Gear, Stateroom, Galley, Passage, Stateroom, Smoking Room, Captain's Room.
 - Port Side: Company's, Storage.
- Structural Features:**
 - Three funnels are shown along the top edge.
 - Engine Skylight is located above the Engineers Room.
 - Small rectangular structures are shown along the deck edge, likely lifeboats or davits.
- Dimensions:** A scale bar at the bottom indicates measurements from 0 to 138 feet.
- Annotations:**
 - Handwritten note on the left: "SS. Albatross" and "SS. Albatross" (written vertically).
 - Stamp on the right: "DAVID & WILLIAM HENDERSON & CO. ENGINEERS 181 22 MAY 93 2/11/96 SHIPBUILDERS PARTICK GLASGOW".

Handwritten notes and scribbles at the top left of the page.

S. S. "Olive" Glasgow Report No. 121+29.

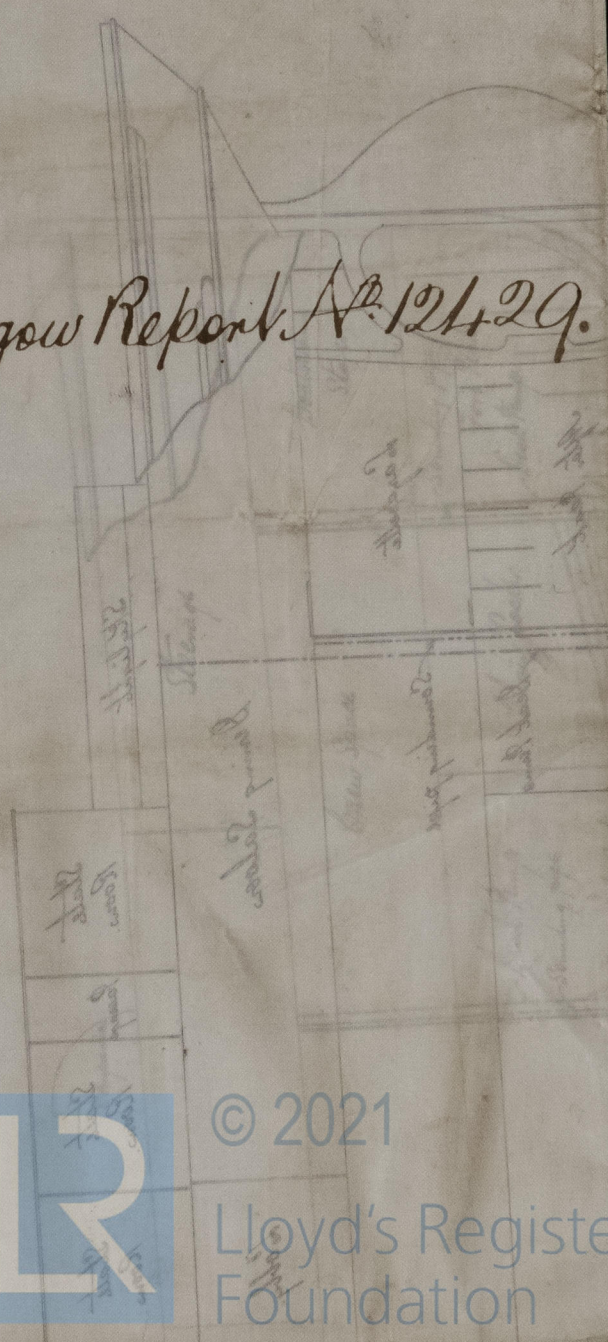

© 2021

Lloyd's Register
Foundation