

## Lloyd's Register of British and Foreign Shipping.

(Report on Vessel No. 9830 Port Glasgow)S.S. "Bute No. 2."No. 2424SHIP FORGINGS ~~OR CASTINGS~~.I have to report that the undermentioned Iron ~~or Steel~~ Forgings ~~or Castings~~, manufactured byThe Portland Forge Co of Kilmarnockfor the Vessel No. 78, being built by Messrs Scott & Coof Bowling have been inspected by me as set forth below, and foundto be, so far as can be seen, sound & efficient

The words FORGINGS or CASTINGS, IRON or STEEL, should be struck out as may be required.

Mark on Forgings.

Lloyd's

No. 2424W HWilliam HamiltonGlasgow  
7/12/89

	STERN FRAME.	RUDDER FRAME.	STEM.
Material* - - - -	<u>Scrap iron</u>		
How made - - - -	<u>Forged</u>		
Dimensions - - - -	<u>7 x 1 1/4</u>		
Progress on Inspection -	<u>Forging &amp; smithing</u>		
Dates when Inspected	<u>29/11/89. 6/12/89</u>		

SKETCHES OF FRAMES SHEWING POSITION AND DESCRIPTION OF WELDS OF FORGINGS, OR PARTICULARS OF TESTS APPLIED TO CASTINGS.

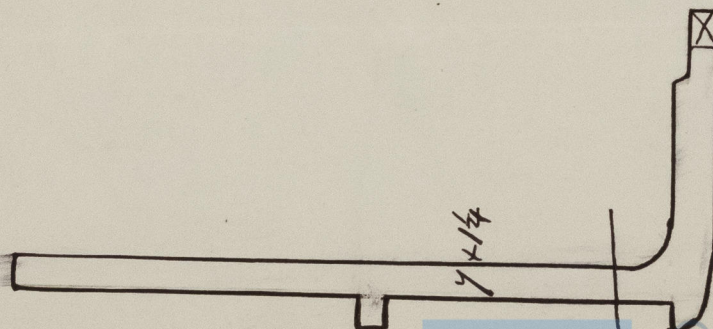
Glue Weld