

Mr to Glas. 4/10/84

S. S. "Primrose"
Glasgow Report No. 6867

Boiler No 175
Engines No 102

Pressure 80 lbs. per sq. inch

all steel plates
holes bored.
Longitudinal seams treble riveted $\frac{15}{16}$ rivets
 $3\frac{3}{4}$ pitch
Circumferential seams double riveted
 $\frac{11}{8}$ rivets $3\frac{3}{4}$ pitch
Steam dome single riveted $\frac{7}{8}$ rivets $2\frac{1}{4}$ pitch

Scale 1" = one foot

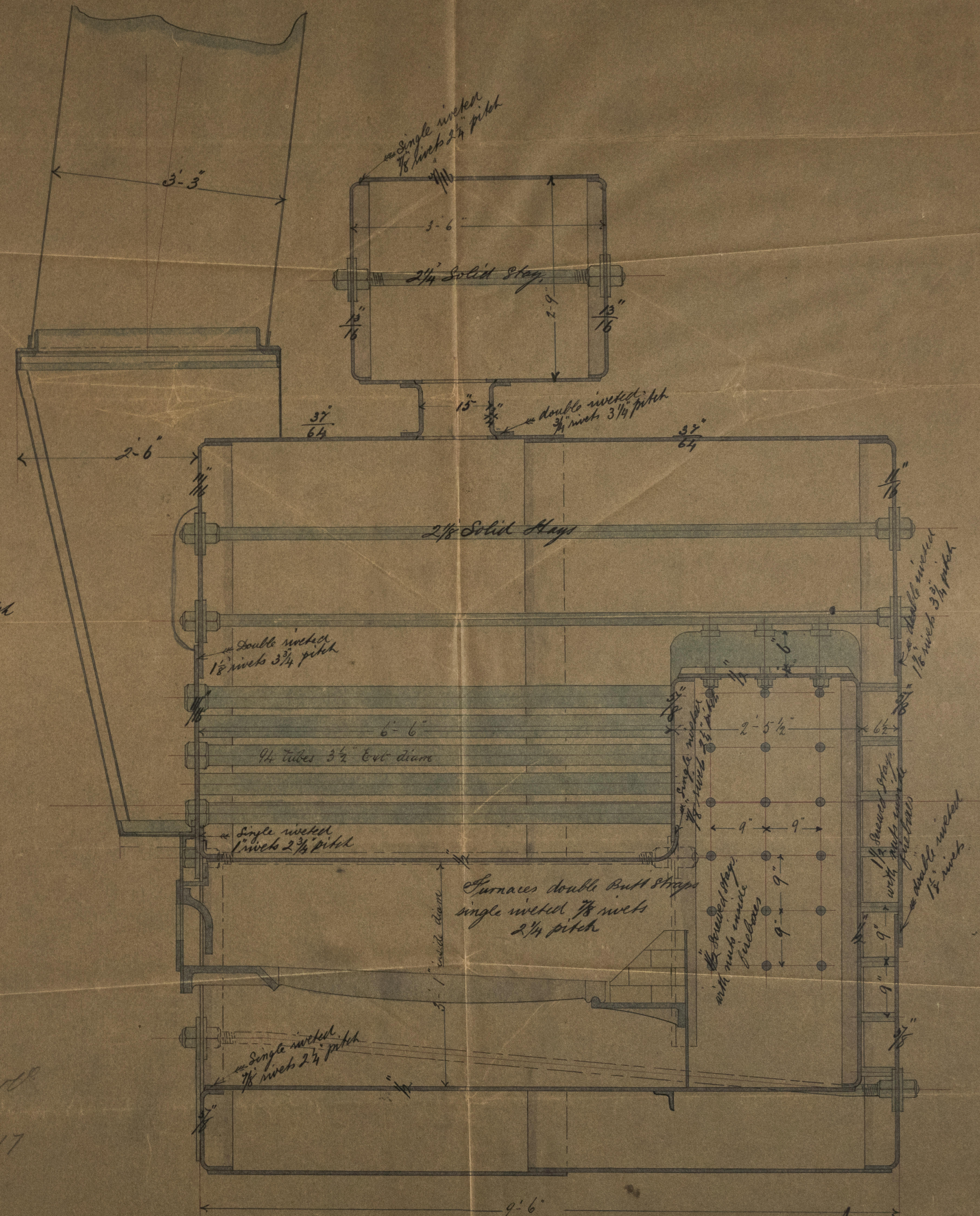
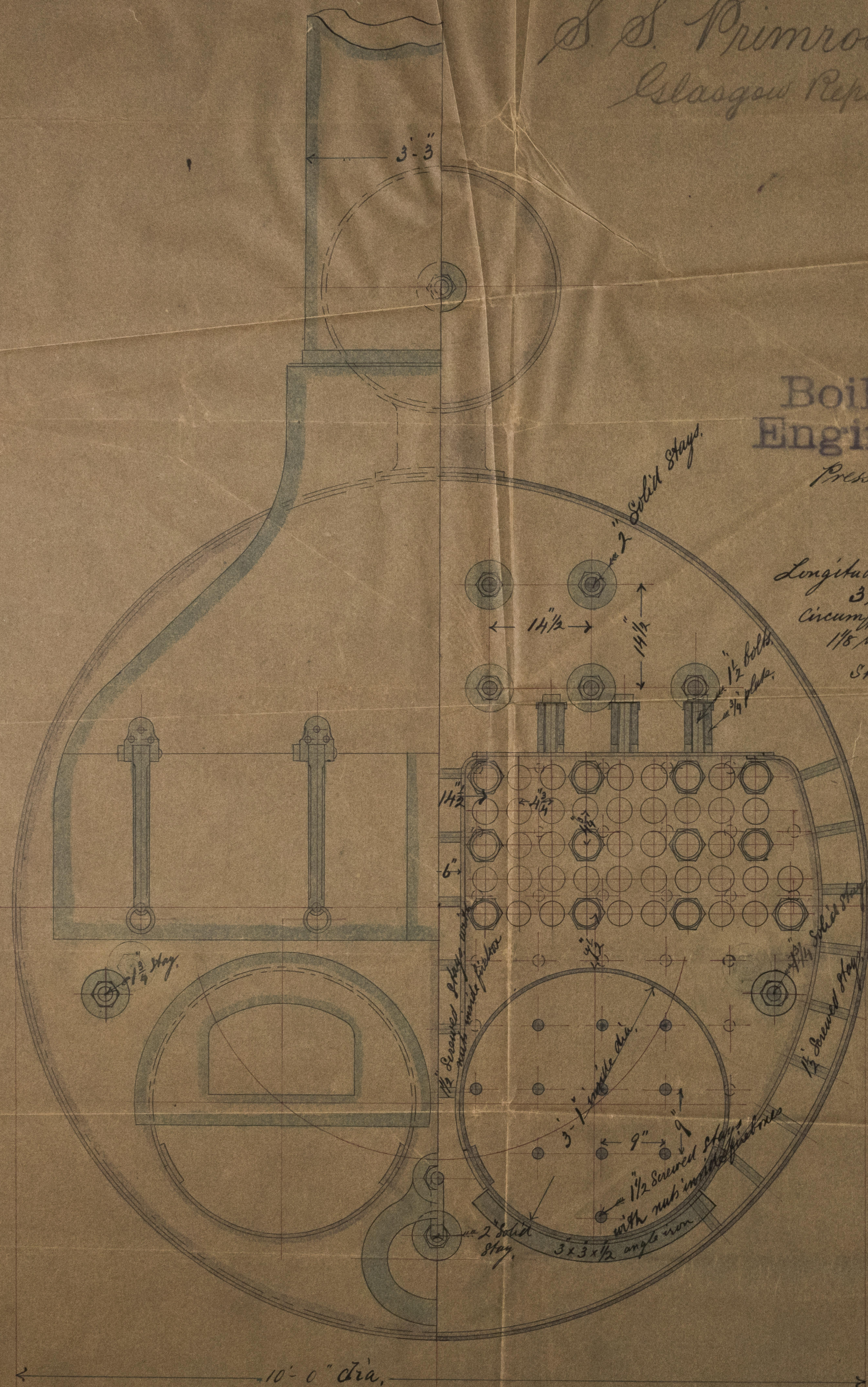

H. McAndrew & Co.
Glasgow
S.S. No 117

D.P.
11/10/84



© 2021 Glasgow Register Foundation
Registered
Foundation

11/10/11
 11/10/11
 11/10/11

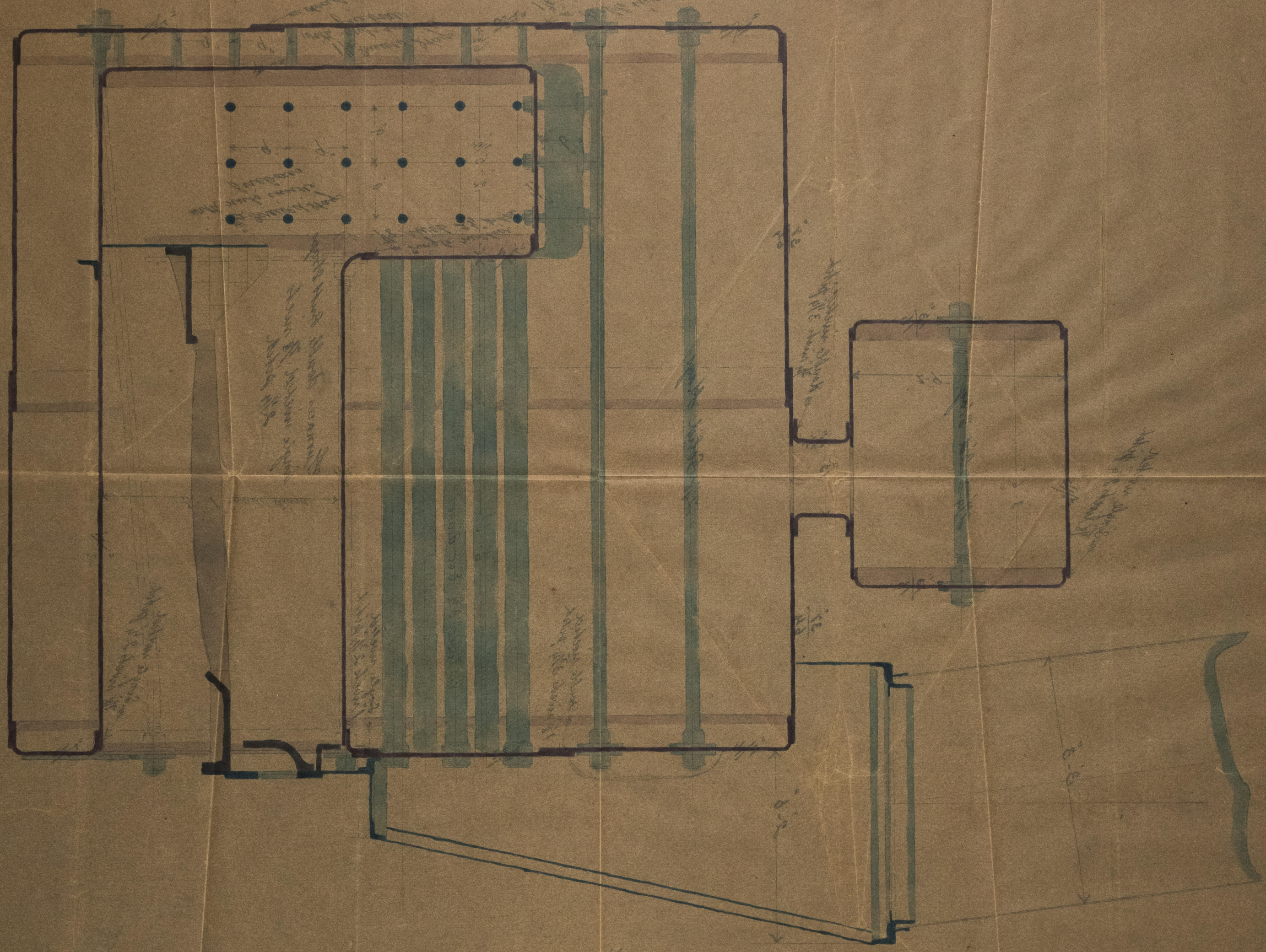

11/10/11
 11/10/11
 11/10/11

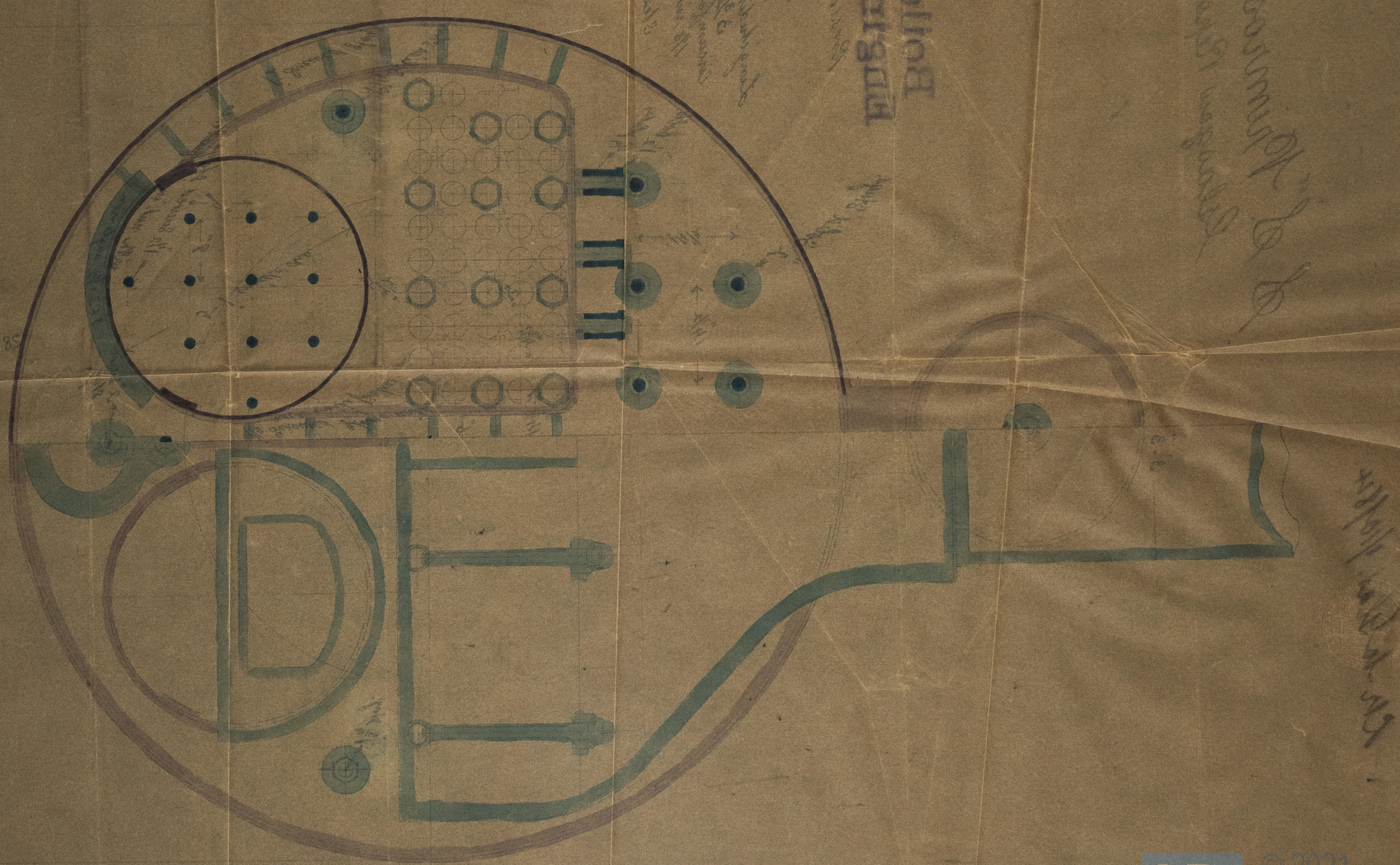

Boiler No 172
 Engine No 103

11/10/11
 11/10/11
 11/10/11