

27. 1884  
412184  
187184

16 FEB. 84.

Ship by  
Ch. Connell & Coy No 139.

# Steel Boiler No 164 & 5 for Engines No 97

Routing  
Longitudinal seams, triple riveted,  
15" steel rivets, 4" pitch, drilled holes  
Circumferential seams double riveted  
15" Steel Rivets 3 1/4" Pitch  
Pressure 80 lbs per sq in  
Scale 1" = one foot



S. S. "Charles Morand"  
Glasgow Report  
No 6612

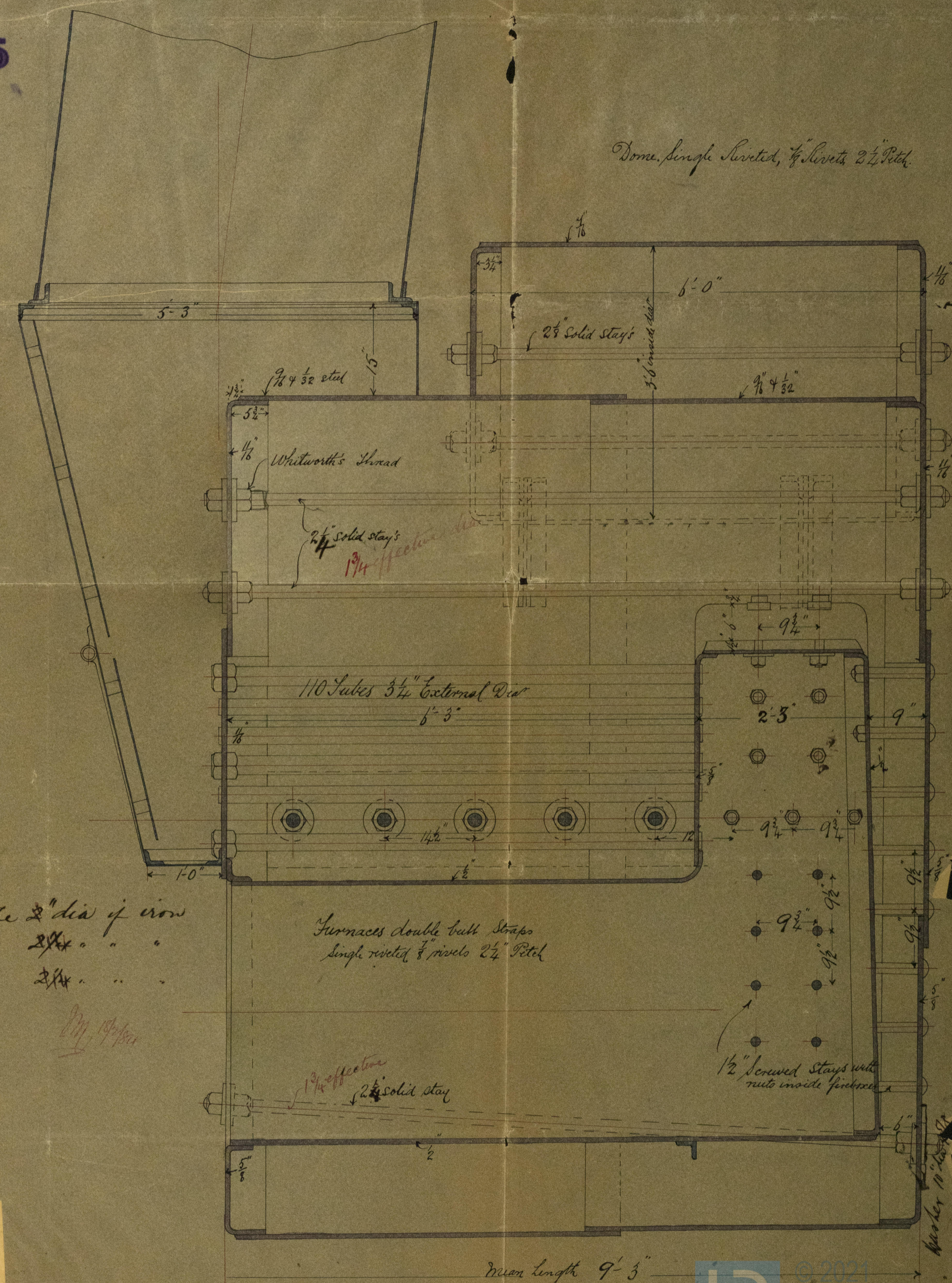
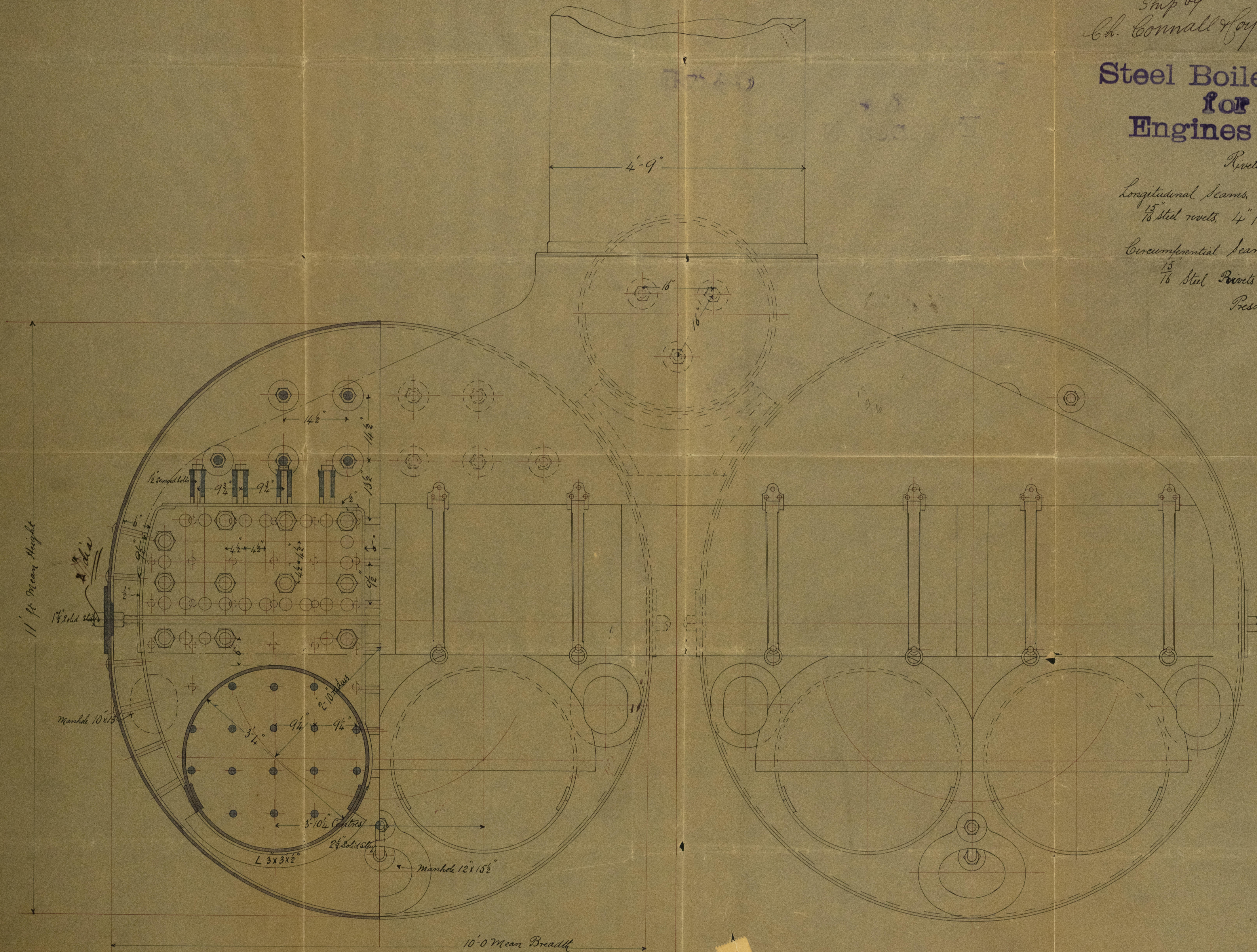

Cross stay to be 2" dia if iron  
Steam space do 2 1/4" " "  
Lower stay 2 1/4" " "

1884

Comm  
139

Spencer's pencil sketch, showing the plan of the site.

1/2"

Spencer's sketch

1/2" scale

1:0"

1/2" & 1/4"

1/2"

425199-0151

425199-0151



© 2021

Lloyd's Register  
Foundation

