

LLOYD'S REGISTER OF SHIPPING
16 FEB. 84
LONDON

Dr. S. G. L.
19:2:84

S. S. N^o 129.

SCALE $\frac{1}{4}$ INCH TO A FOOT.

by Atkinson & Mansell.

S. S. "Gran Chaco Argentino"
Glasgow Report
N^o 6594.

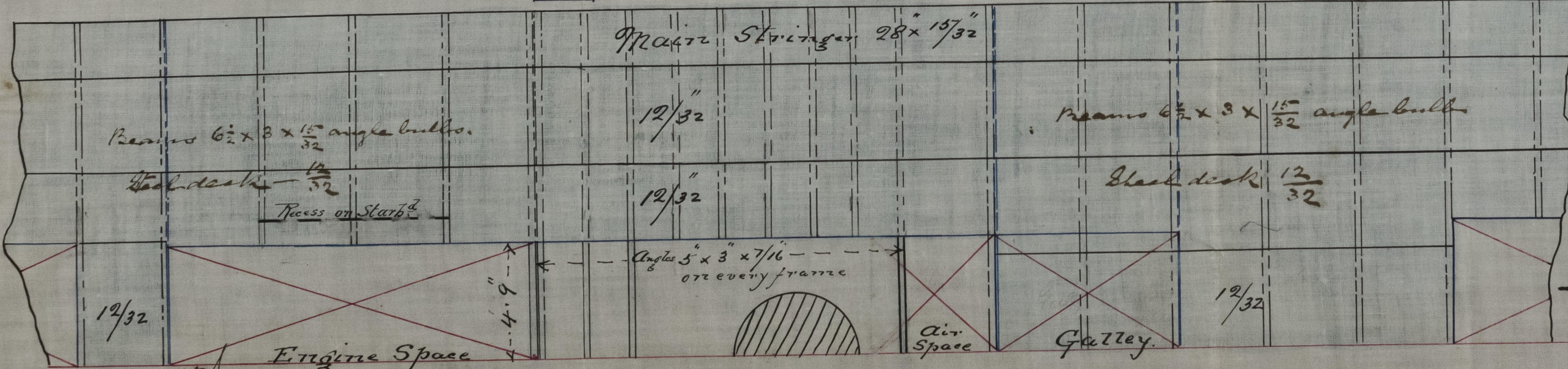
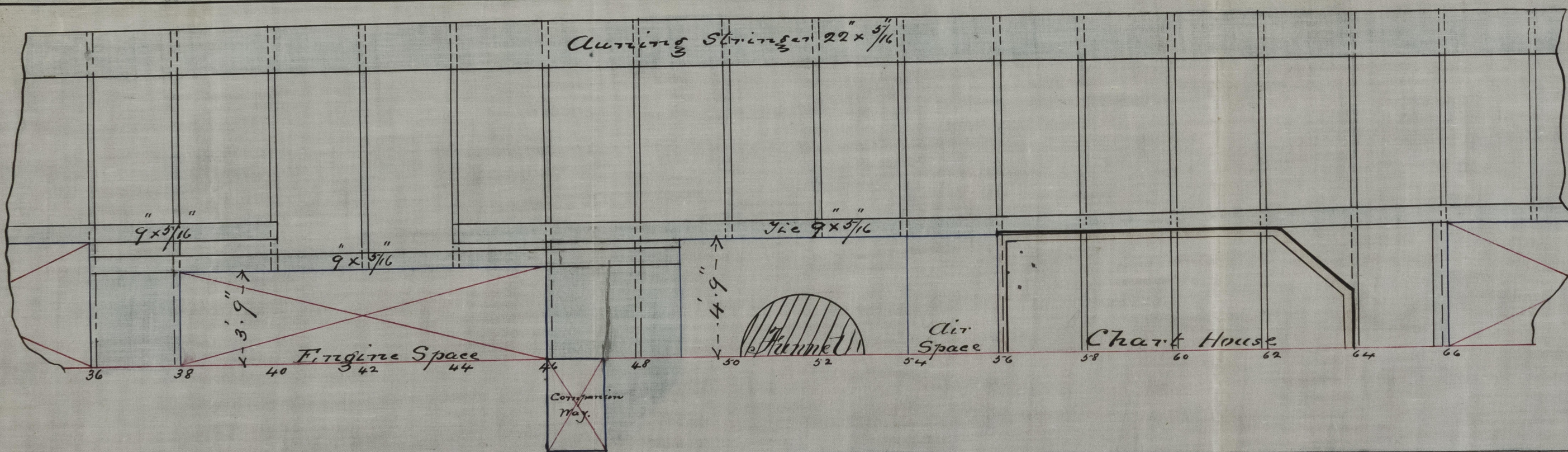
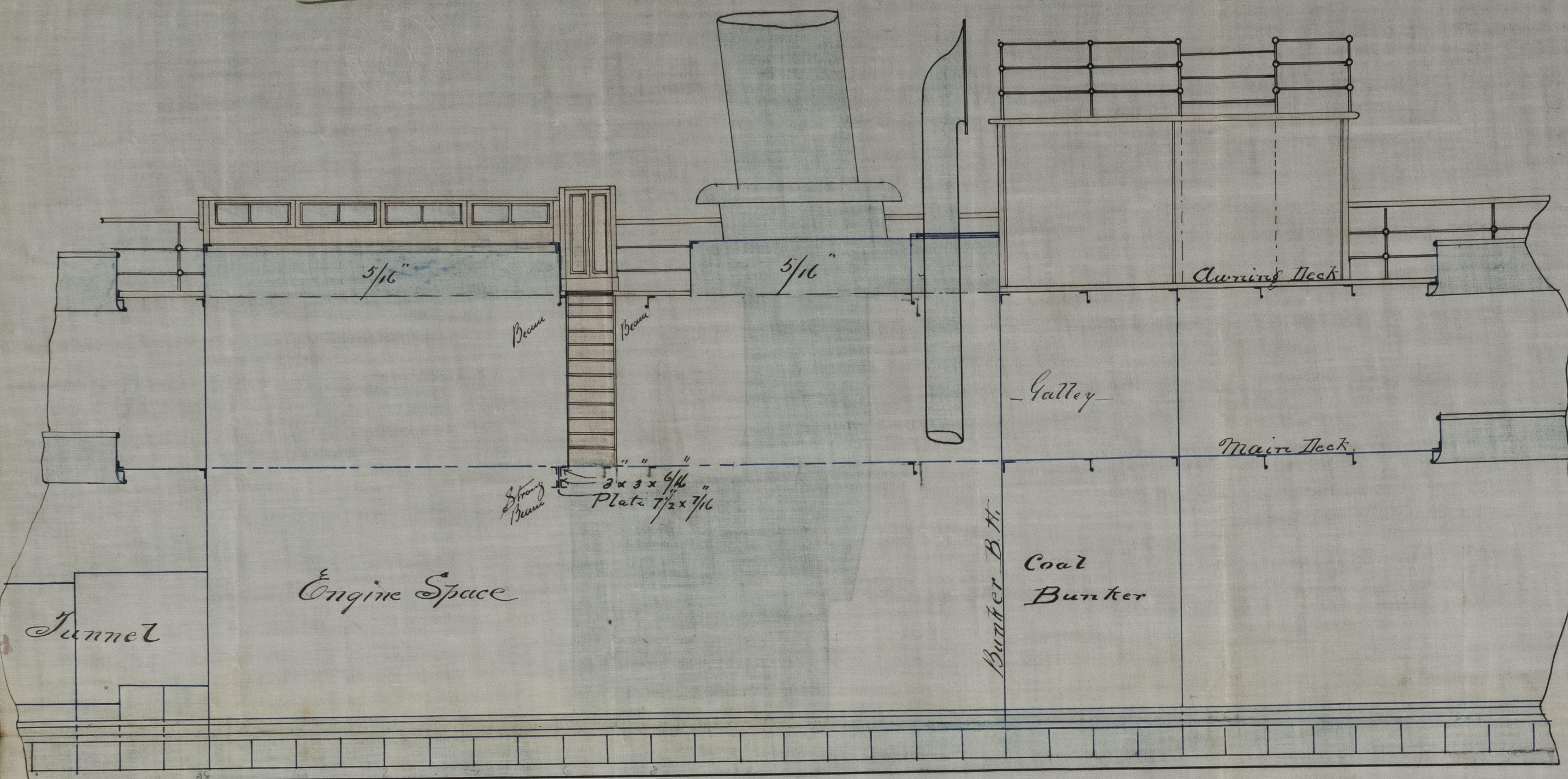

MIDSHIP SECTION.

SCALE $\frac{1}{2}$ INCH TO A FOOT.

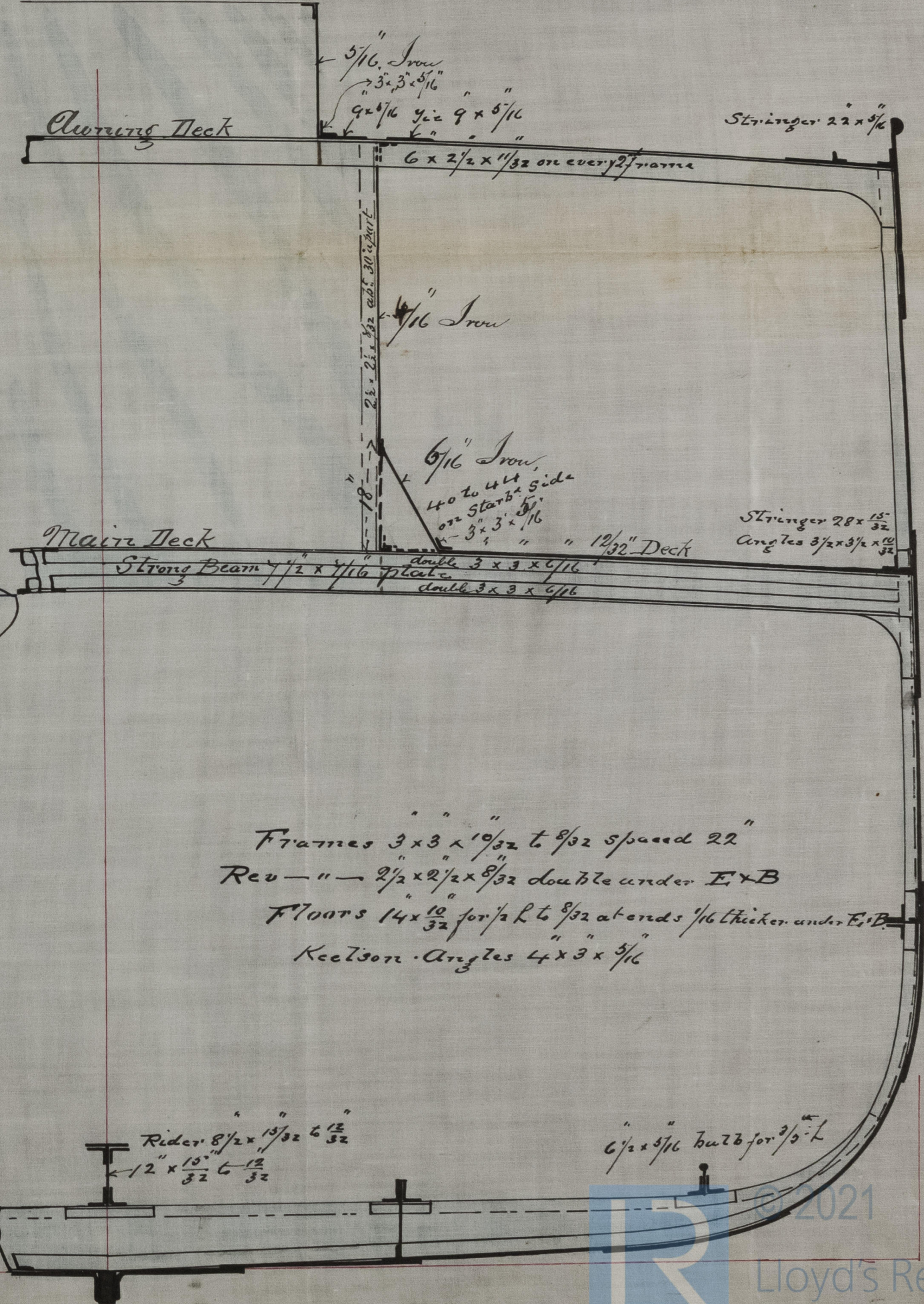

Frames $3 \times 3 \times \frac{10}{32}$ to $\frac{9}{32}$ spaced 22"
Revs — $2 \frac{1}{2} \times 2 \frac{1}{2} \times \frac{8}{32}$ double under E & B
Floors $14 \times \frac{12}{32}$ for $\frac{1}{2}$ L to $\frac{8}{32}$ at ends $\frac{1}{16}$ thicker under E & B
Keelson Angles $4 \times 3 \times \frac{5}{16}$