

Lloyd's Register of Shipping
 27 JUN. 83
 LONDON
 27/6/83
 12/7/83
 Lloyd's Register of Shipping
 LONDON

Elevation of Permanent Anning
 "S.S. No. 258"
 Scale $\frac{1}{8}$ " = 1 Foot,

S.S. Adelaide
 Glasgow Report
 No. 6309

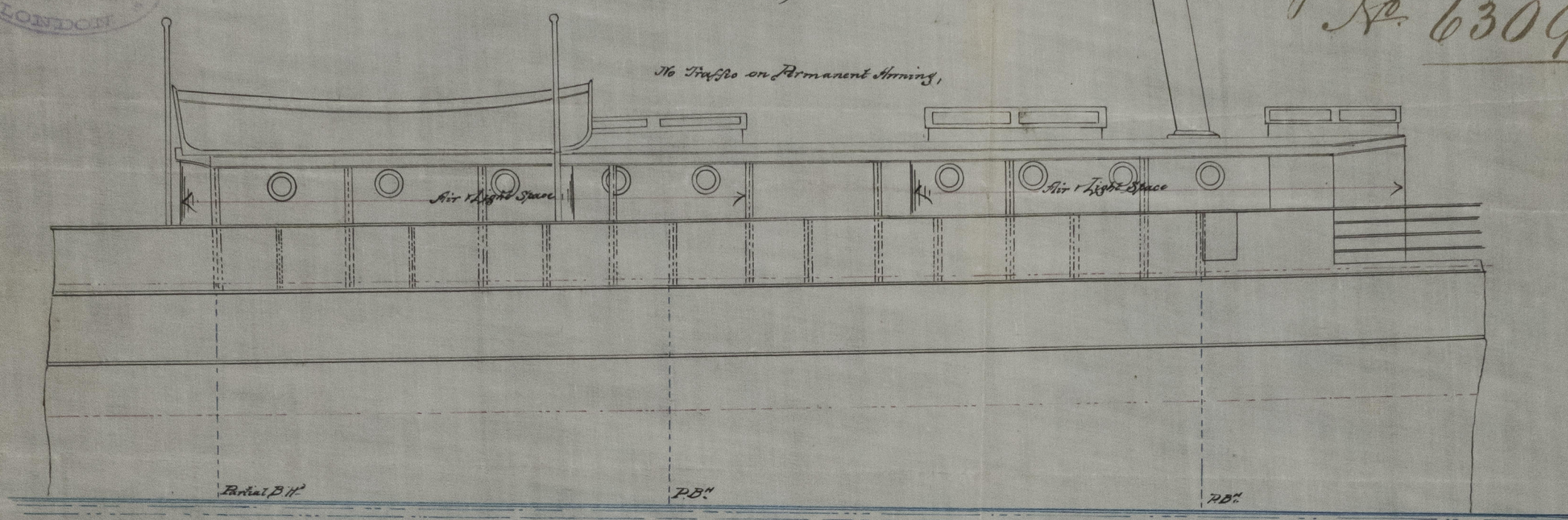

Section Showing Permanent Anning
 At Alternate Beams
 S.S. No. 258
 Scale $\frac{1}{8}$ " = one Foot,

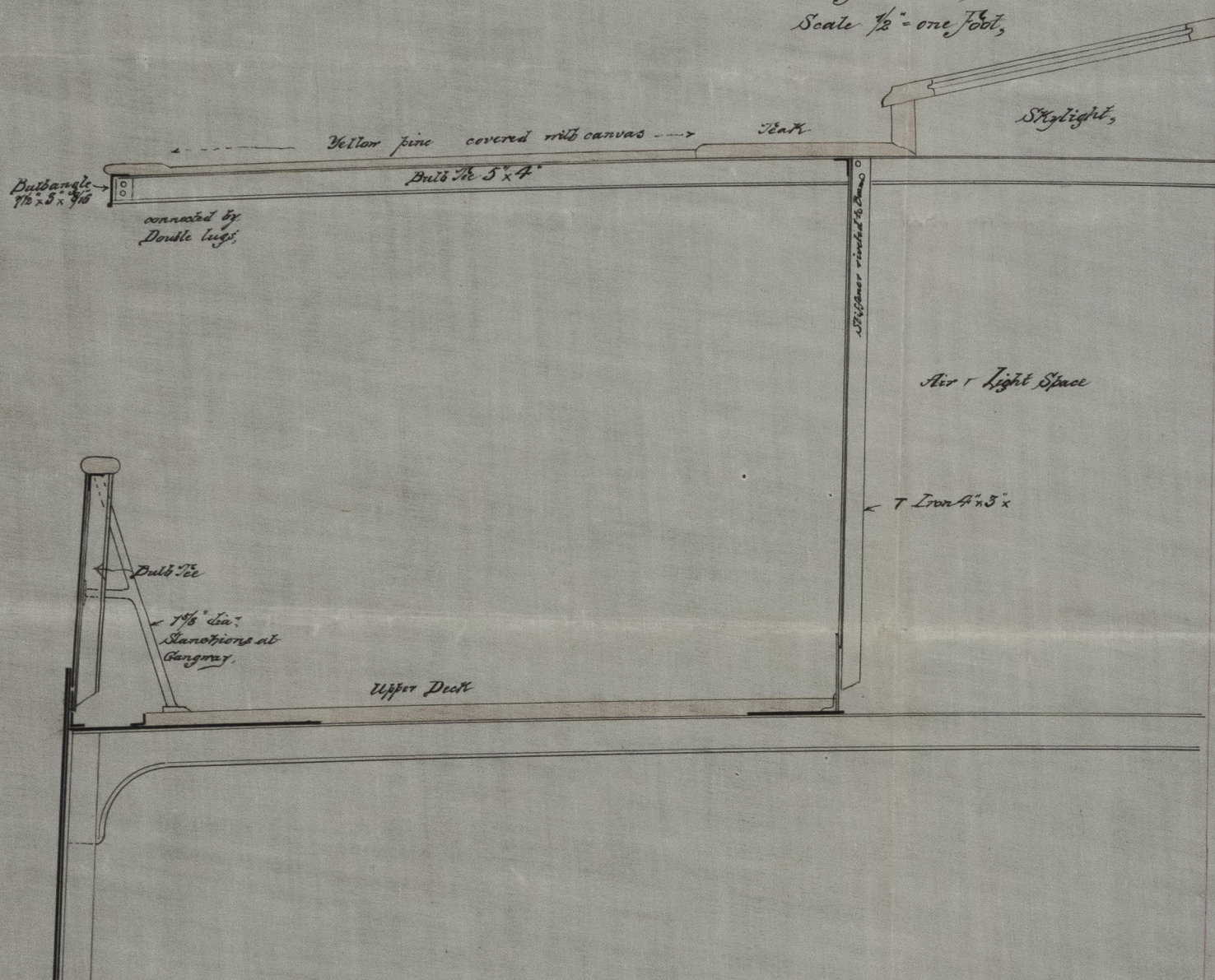

DAVID & WILLIAM HENDERSON & CO.
 110
 JUN
 G.L.
 PARTICK, GLASGOW

Section at Alternate Beams,

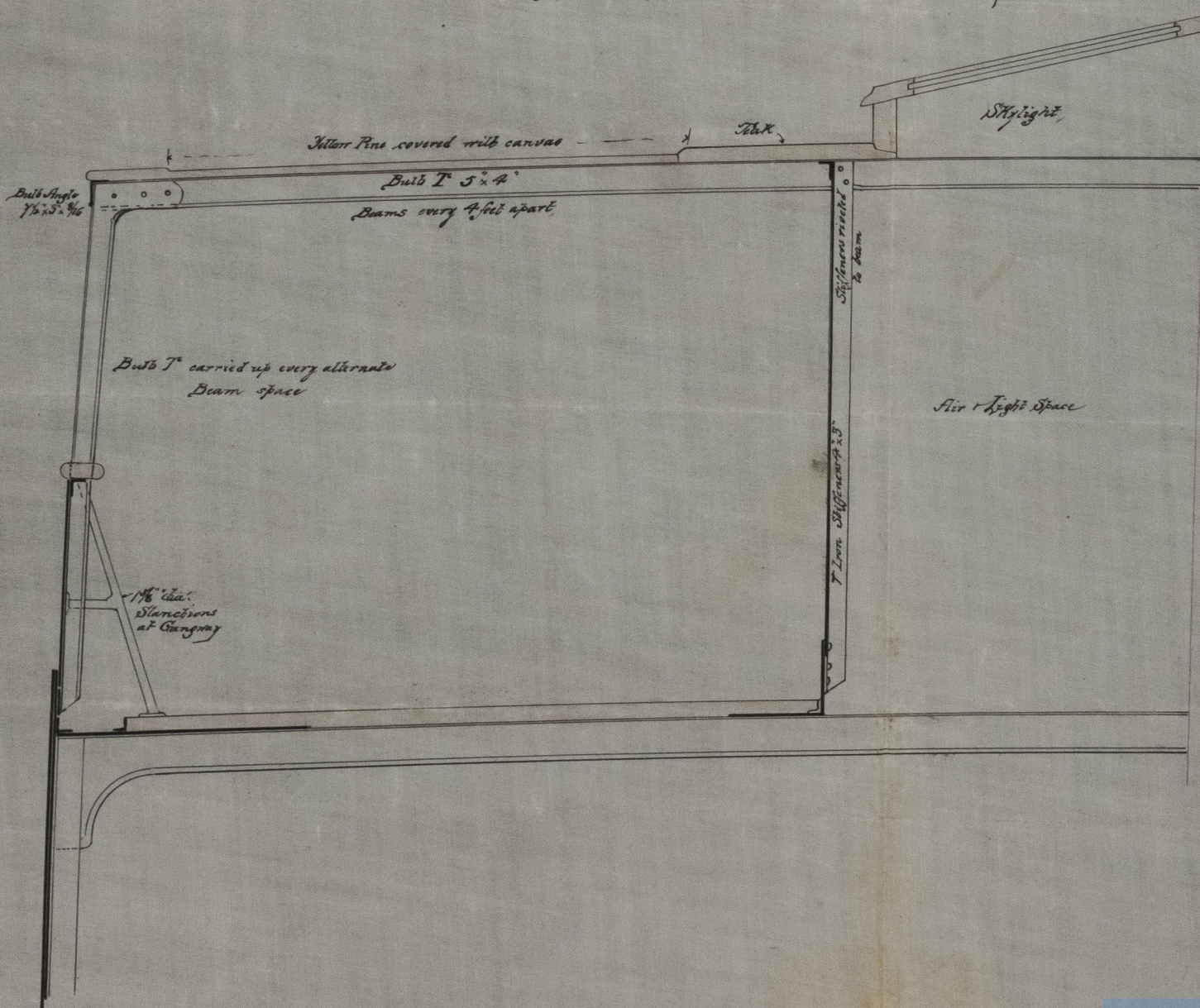

© 2021

Lloyd's Register Foundation

GLS196-0115