

Lloyd's Register of Shipping.

SURVEYS FOR FREEBOARD.

(CONDITIONS OF ASSIGNMENT.)

 Index No. [REDACTED]
 (For London Office only.)

No 40736

Ship's Name

Q.P. 7

Port of Survey

Rotterdam

Official Number

Surveyor's Signature

[Signature]

Nationality and Port of Registry

Venezuela - Maracibo

Date of Survey

While building

Disposition and dimensions of superstructures, trunks, deckhouses and machinery casings to be inserted in the diagrams and tabular statement:

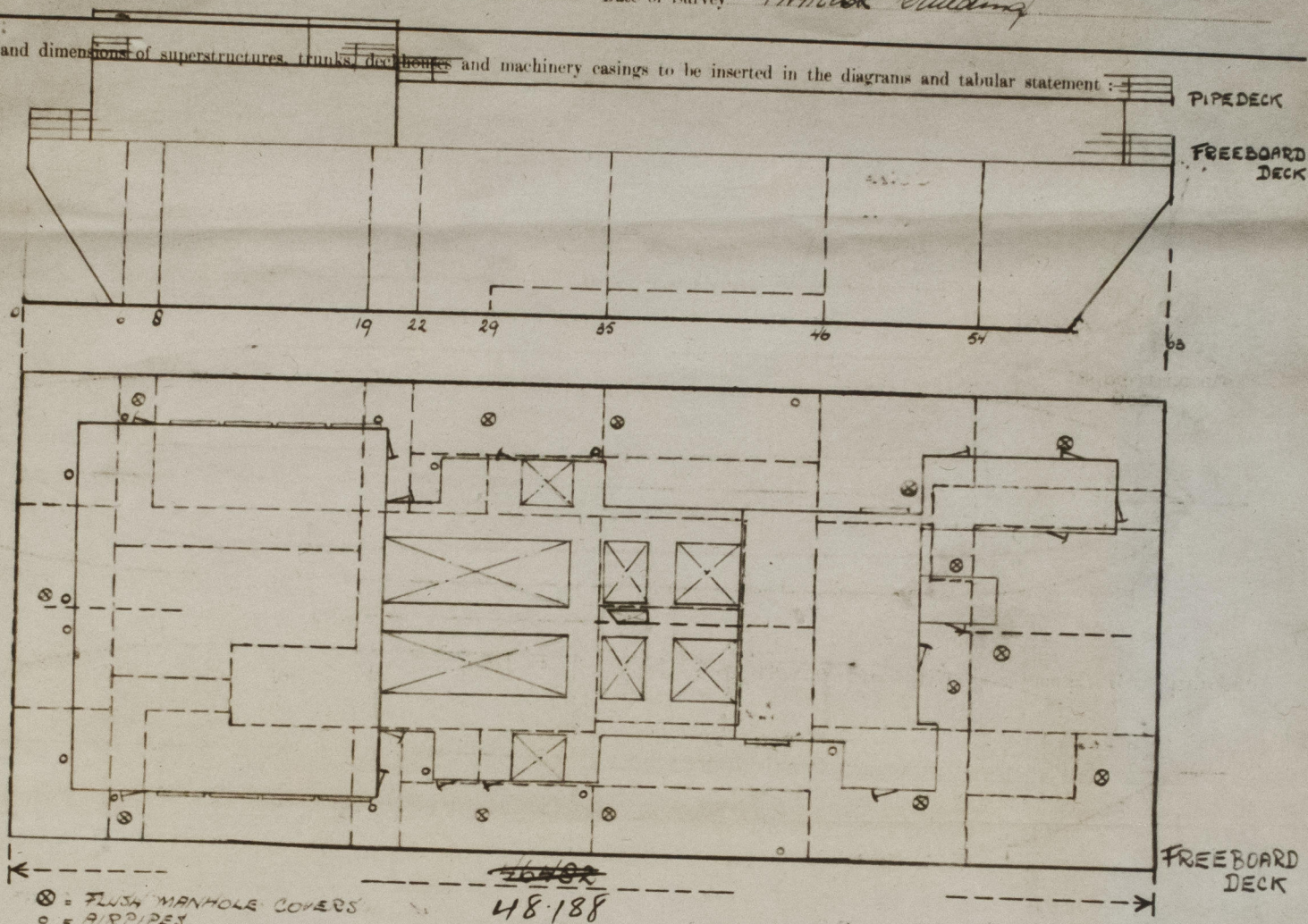

Particulars of Superstructures, Trunks, Casings, Deckhouses.

	Coaming mm	Plating mm	Stiffeners mm	Spacing mm	End Attachments of Stiffeners	Size of Openings mm	Height of Sills mm	Height of Casings mm
Poop Bulkhead ...	—	—	—	—	—	—	—	—
Raised Quarter Deck Bulkhead ...	—	—	—	—	—	—	—	—
Bridge, After Bulkhead ...	—	—	—	—	—	—	—	—
Bridge, Forward Bulkhead...	—	—	—	—	—	—	—	—
Forecastle Bulkhead...	—	—	—	—	—	—	—	—
Trunk, Aft ...	—	—	—	—	—	—	—	—
Trunk, Forward ...	—	—	—	—	—	—	—	—
Exposed Machinery Casings on Freeboard or Raised Quarter Decks...	7	7	100x75x75	610-975	bracket on top E.N. on bottom	530x610 with Roll rolling curtains	610	3048
Exposed Machinery Casings on Superstructure Decks ...	—	—	—	—	—	—	—	—
Machinery Casings within Superstructures not fitted with Class I Closing Appliances ...	—	—	—	—	—	—	—	—
Deckhouses on Flush Deck Ships ...	7	7	100x75x75	640-900	E.N. on top and bottom	530x610	610	3048

Particulars of Closing Appliances (state if capable of being manipulated from both sides).

Poop Bulkhead ...	—
Raised Quarter Deck Bulkhead ...	—
Bridge, After Bulkhead ...	—
Bridge, Forward Bulkhead ...	—
Forecastle Bulkhead...	—
Exposed Machinery Casings on Freeboard or Raised Quarter Decks...	—
Exposed Machinery Casings on Superstructure Decks ...	—
Machinery Casings within Superstructures not fitted with Class I Closing Appliances ...	—
Deckhouses on Flush Deck Ships ...	—

Steel h.T. hinged doors, capable of being operated from both sides /
 On top Roll watertight covers of strong construction /
 Steel h.T. hinged doors, capable of being operated from both sides /

014717-014783-0129 1/2

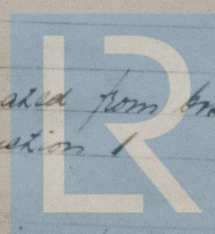

© 2021

Lloyd's Register
Foundation

PARTICULARS OF PROTECTION TO OPENINGS, ETC.

The following diagrams should be used to indicate the positions of cargo and coaling hatchways, gangway, cargo and coaling ports, ventilators, companionways, etc., which would affect the seaworthiness of the ship:—

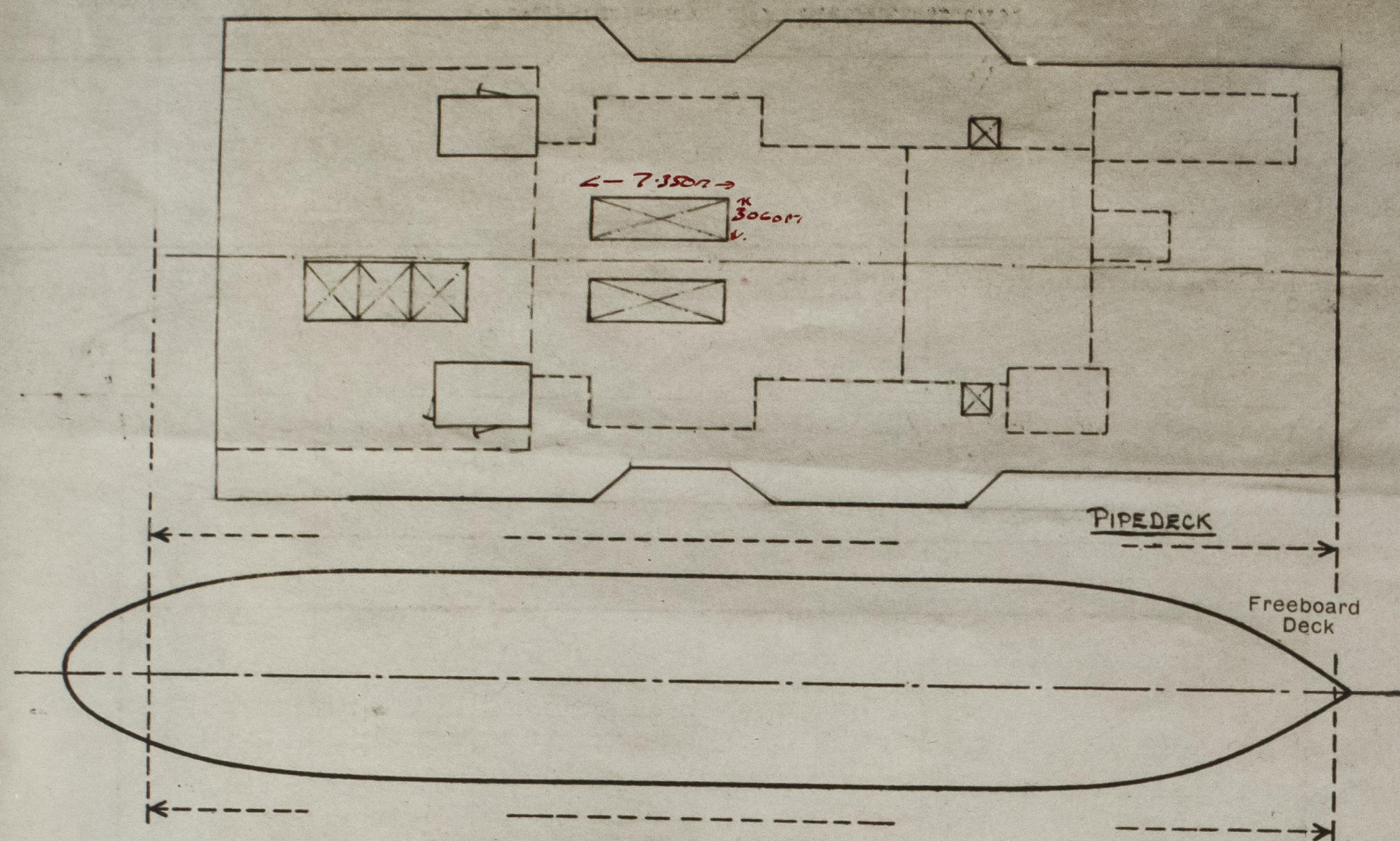

Particulars of tidley, funnel and ventilator coamings, engine room skylight and other openings in machinery casing tops and their means of closing:—

None

Particulars of Flush Bunker Scuttles:— 13 flush bunker scuttles of keel construction closed by means of strong back and secured with permanently fitted chain - Rubber packing.

Particulars of Companionways:—

None

Particulars of Ventilators in exposed positions on freeboard and superstructure decks:—

1 forepeak ventilator of 3' - height 915 mm with wooden plug and canvas cover

Particulars of Air Pipes in exposed positions on freeboard, raised quarter, or superstructure decks:—

13 air pipes on water tanks - height 915 mm - provided with wooden plug.
2 " " fuel tanks - " 1030 mm - " " gas cap and canvas cover
3 " " crude oil tanks - " 2650 mm - " " gas cap and pressure vacuum relief valve
All other air pipes extended above pipedeck.

Particulars of Gangway Cargo and Coaling Ports:—

None

Particulars of Scuppers and Sanitary Discharge Pipes:—

No discharges from spaces below freeboard deck.
W.C.s and Washbasins situated in deck houses on freeboard deck discharging by means of 2 - 4" mm return valves, 2 - 2 1/2" mm return valves and 1 - 2" mm return valve, all placed in cofferdams.

Particulars of Side Scuttles:—

No side scuttles below freeboard deck.

Vertical distance of Sill of lowest Side Scuttle above top of keel

Particulars of Guard Rails:—

Height 1080 mm (3 rods), efficiently supported.

Particulars of Gangways, Lifelines, etc.:—

Particulars of Freeing Arrangements.

	Length of Bulwark	Height of Bulwark	Size of Freeing Ports	Number each side	Area each side	Rule area each side
After Well ...						
Forward Well ...						

State position of each freeing port ... { After Well:—
(F. and A. position and height above deck edge) { Forward Well:—

State whether the freeing ports are fitted with shutters, bars, or rails, and give particulars of such:—

Additional area where sheer is less than standard.

PARTICULARS OF PROTECTION TO OPENINGS, ETC.

HATCHWAYS ON FREEBOARD AND SUPERSTRUCTURE DECKS.									
Description of Hatchway									
Dimensions of Hatchway									
COAMINGS	{	Height above Deck ...							
		Thickness	Sides ...						
			Ends ...						
		Stiffeners ...							
		Brackets, Stays ...							
HATCH BEAMS	{	Number							
		Spacing							
		Scantling and Sketch ...							
		Bearing Surface							
FORE AND AFTERS	{	Number							
		Spacing							
		Unsupported Lengths ...							
		Scantling* and Sketch ...							
		Bearing Surface							
HATCH COVERS	{	Material							
		Thickness							
		How fitted							
		Bearing Surface							
Spacing of Cleats									
Number of Tarpaulins... ..									

*Are wood fore and afters steel shod at all bearing surfaces ?

Are battens and wedges efficient and in good condition ?

Are tarpaulins in good condition and in accordance with rule requirements ?

Are lashings provided in accordance with rule requirements ?

Particulars of any special features :—

2- Portable plate - pipe deck
secured by $5\frac{7}{8}$ " top bolts at 120" spacing.

SURVEYOR'S SIGNATURE:

W. W. W. W. W.