

FOR CLASSIFICATION PURPOSES ONLY

C.11.

LLOYD'S REGISTER OF SHIPPING

Index No. _____
(For London Office only.)

SURVEYS FOR FREEBOARD

(CONDITIONS OF ASSIGNMENT)

Ships' Names 507, 508, 509, 510, 511, 512, 513. Port of Survey YOKOHAMA
Official Number NONE Surveyor's Signature Bhineh Leman + William Alcorn.
Nationality and Port of Registry INDONESIA - DJAKARTA. Date of Survey WHILE BUILDING 1963.

Disposition and dimensions of superstructures, trunks, deckhouses, machinery casings and wood sheathing to be inserted in the diagrams and tabular statement :-

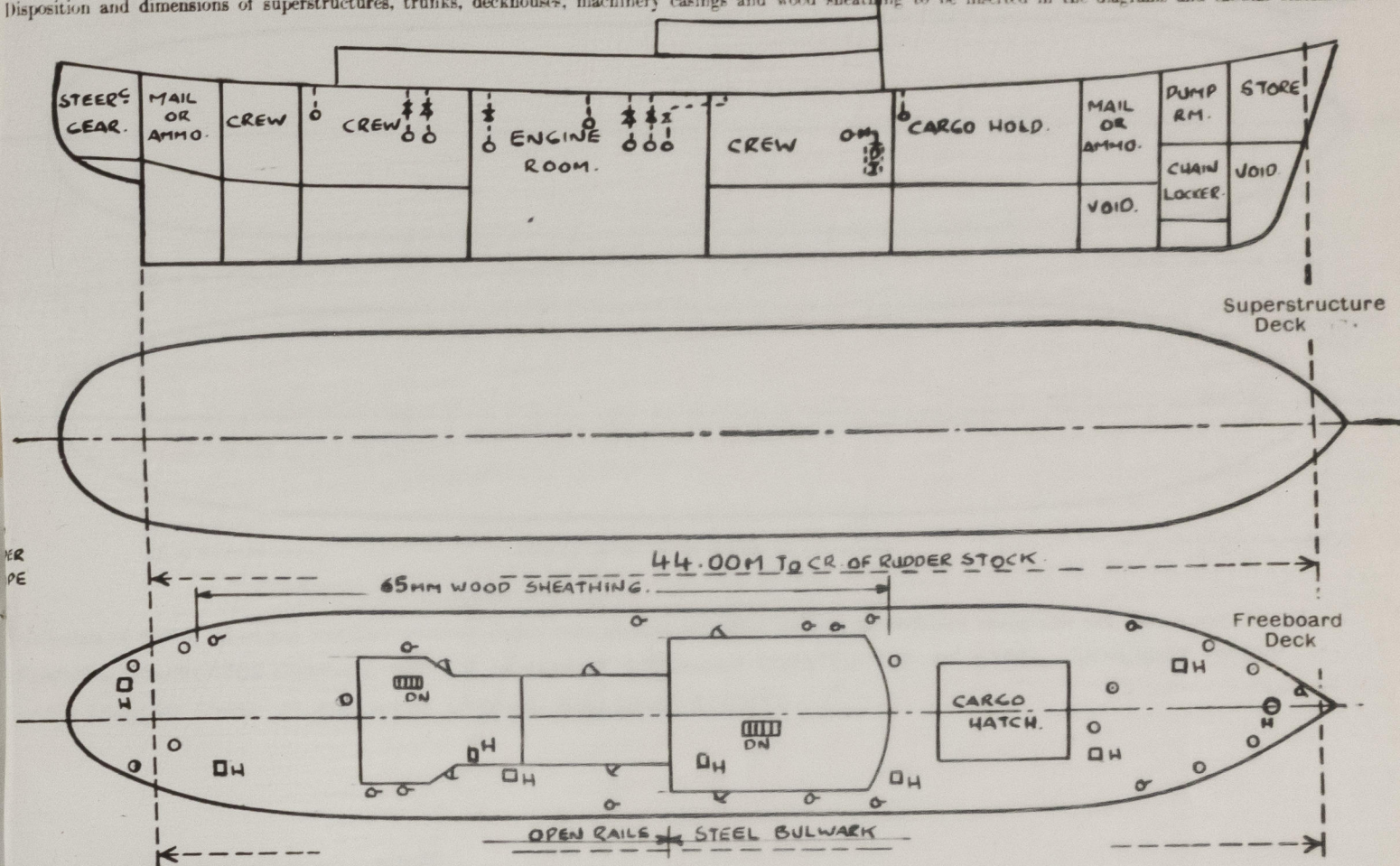

Particulars of Superstructures, Trunks, Casings, Deckhouses.

	Coaming MM	Plating MM	Stiffeners MM	Spacing MM	End Attachments of Stiffeners	Size of Openings MM.	Height of Sills MM	Height, Beam to Beam MM
Poop Bulkhead ...								
Raised Quarter Deck Bulkhead ...								
Bridge, After Bulkhead ...								
Bridge, Forward Bulkhead ...								
Forecastle Bulkhead ...								
Trunk, Aft ...								
Trunk, Forward ...								
Exposed Machinery Casings on Freeboard or Raised Quarter Decks ...	6	6	65x65x61A	600	BKT? T&B	1450x600	610	2300
Exposed Machinery Casings on Superstructure Decks ...								
Machinery Casings within Superstructures not fitted with Class I Closing Appliances ...								
Deckhouses and Pump Room Entrances	4.5	6	75x9 F.B.	600	BKT? AT TOP	1600x600	385	2300

Particulars of Closing Appliances (state if capable of being manipulated from both sides).

Poop Bulkhead ...	
Raised Quarter Deck Bulkhead ...	
Bridge, After Bulkhead ...	
Bridge, Forward Bulkhead ...	
Forecastle Bulkhead ...	
Exposed Machinery Casings on Freeboard or Raised Quarter Decks ...	HINGED STEEL W.T. DOORS - O.B.S.
Exposed Machinery Casings on Superstructure Decks ...	
Machinery Casings within Superstructures not fitted with Class I Closing Appliances ...	
Deckhouses and Pump Room Entrances	HINGED STEEL W.T. DOORS - O.B.S.



© 2021

Lloyd's Register
Foundation

014501-014512-0219 1/4

PARTICULARS OF PROTECTION TO OPENINGS, ETC.

The following diagrams should be used to indicate the positions of cargo and coaling hatchways, gangway, cargo and coaling ports, side scuttles, scuppers, ventilators, companionways, etc., which would affect the seaworthiness of the ship:—

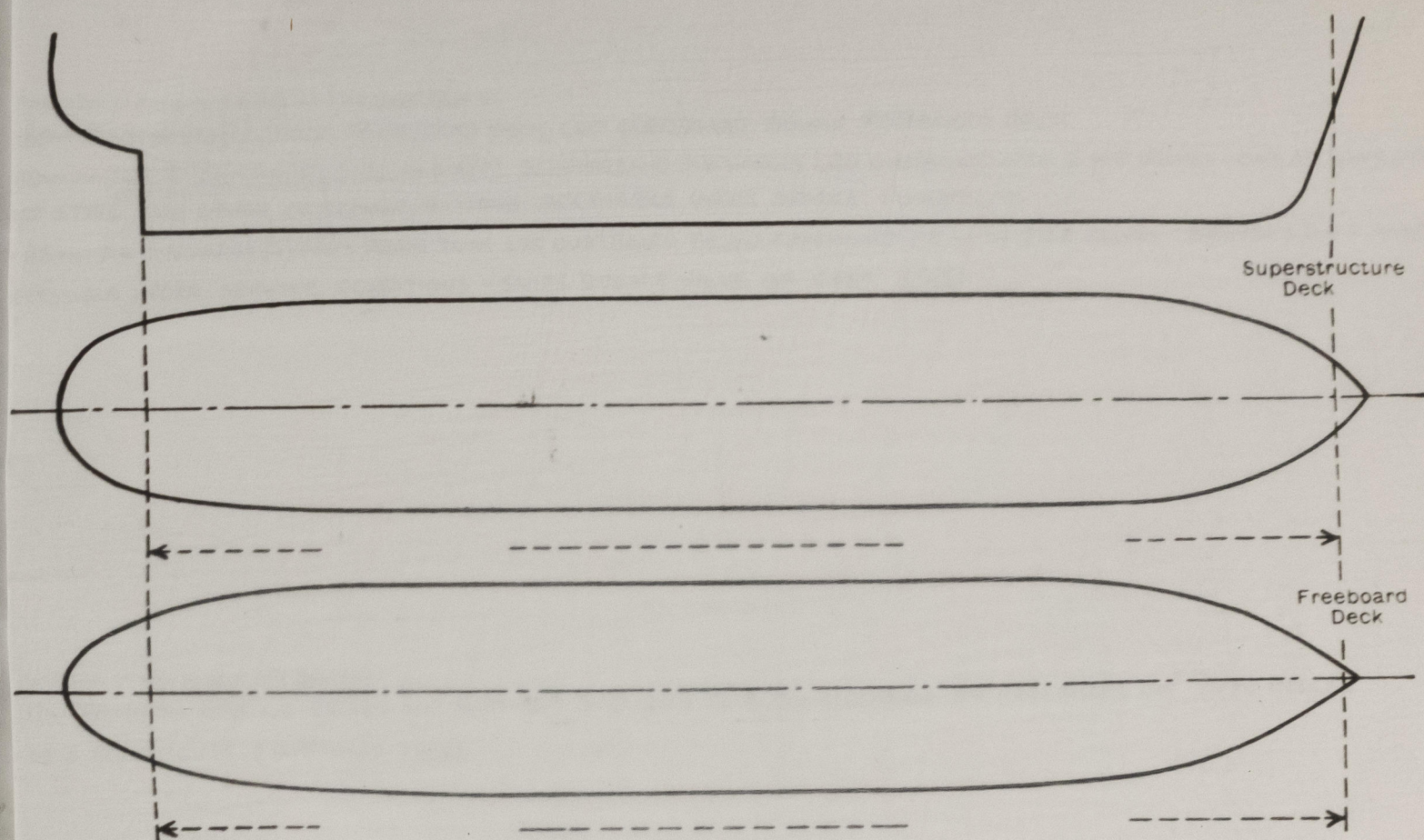

Particulars of fidley, funnel and ventilator coamings, engine room skylight and other openings in machinery casing tops and their means of closing:—
FUNNEL, VENTILATOR COAMING AND E.R. SKYLIGHT STRONGLY CONSTRUCTED OF STEEL. SKYLIGHT FITTED WITH HINGED STEEL FLAPS WITH STRONG BULLSEYE LIGHTS.

Particulars of Flush Bunker Scuttles:— **NONE**

Particulars of Companionways:—

(including those incorporated in deckhouses and masts)

COMPANIONWAYS ENCLOSED IN STRONG STEEL DECKHOUSE ON F.B. DECK - HINGED STEEL W.T. DOORS, O.B.S. 1600MM x 600MM - SILLS 385MM, HAVING INNER SILLS AT DECK OPENINGS 230MM HIGH.

Particulars of Ventilators in exposed positions on freeboard and superstructure decks:—

FREEBOARD DECK: 1-400MM DIA x 9.5MM x 920MM HIGH.

6-100MM DIA x 8.6MM C.N. VENTS - 915MM HIGH.

3-350MM DIA x 10MM M.V. - 915MM HIGH.

2-300MM DIA x 9MM M.V. - 915MM HIGH.

1-400MM DIA x 9.5MM - 915MM HIGH.

C.N. AND M.V. PROVIDED WITH STEEL W.T. COVERS.

AND COWL VENTS WITH WOOD PLUGS AND CANVAS COVERS.

BRIDGE DECK:

2-650MM DIA x 10MM M.V. - 200MM HIGH.

1-400MM DIA x 8MM M.V. - 200MM HIGH.

2-350MM DIA x 6MM M.V. - 200MM HIGH.

1-200MM DIA x 4.5MM M.V. - 200MM HIGH.

2-400MM DIA x 8MM. - 850MM HIGH.

Particulars of Air Pipes in exposed positions on freeboard, raised quarter, or superstructure decks:—

FREEBOARD DECK.

8-70MM DIA x 915MM HIGH.

6-80MM DIA x 915MM HIGH.

O.F. AND F.W. TANK AIRPIPES PROVIDED WITH WIRE GAUZE,

BALL CHECK VALVES AND HINGED C.I. COVER SECURED BY CLIP.

VOID TANK AND BALLAST TANK AIR PIPES PROVIDED WITH HINGED

C.I. COVER SECURED BY CLIP.



© 2021

Lloyd's Register
Foundation

Particulars of Gangway Cargo and Coaling Ports :—

NONE.

Particulars of Scuppers and Sanitary Discharge Pipes :—

- 80MM DIA SCUPPERS (P&S) FROM FREEBOARD DECK, LED OVERBOARD BELOW FREEBOARD DECK.
- 100MM DIA (P&S), 2-70MM DIA (S) & 2-50MM DIA (P) SCUPPERS AND DISCHARGES LED OVERBOARD WITH 2 N.R. VALVES - ONE AT SHIPS SIDE OF CAST STEEL, THE OTHER, OF BRONZE, ALWAYS ACCESSIBLE UNDER SERVICE CONDITIONS.
- 25MM DIA DISCHARGE (S) FROM DRAIN TANK LED OVERBOARD BELOW FREEBOARD DK WITH 2 N.R. VALVES - BRONZE S.D.N.R. ALWAYS ACCESSIBLE UNDER SERVICE CONDITIONS - SHIPS SIDE N.R. VALVE OF CAST STEEL

Particulars of Side Scuttles and Deadlights :—

17- 250MM DIA OPENING BRONZE AND ALUMINIUM SIDELIGHTS TO ACCOMMODATION ON FREEBOARD DK, WITH HINGED M.S. DEADLIGHTS. (APPROVED TYPE)

Vertical distance of Sill of lowest Side Scuttle above top of keel NONE BELOW FREEBOARD DECK.
Distance from amidships to centre of lowest Side Scuttle

Particulars of Guard Rails and Bulwarks :— FORD WELL - BULWARK 1000MM HIGH x 6MM WITH 100MM x 9.5MM B.P. RAIL BAR AND 6MM FL. PLATE STAYS 1625MM APART.
ON FREEBOARD DECK
AFTER WELL - 3 GUARDRAILS WITH STANCHIONS 1000MM HIGH AND 2500MM APART.

Particulars of Gangways, Lifelines, etc. :— HANDRAIL ON HOUSE SIDE P&S.

Particulars of Freeing Arrangements.

	Length of Bulwark	Height of Bulwark	Size of Freeing Ports	Number each side	Area each side	Rule area each side
After Well	OPEN RAILS.					
Forward Well	25M.	1000MM.	1300MM x 230MM.	2.		

State position of each freeing port (After Well :—
(P. and A. position and height above deck edge) (Forward Well :— 1000MM FOR² OF HOUSE FRONT, 1500MM ABAFT HOUSE FRONT.

State whether the freeing ports are fitted with shutters, bars, or rails, and give particulars of such :— NONE.

Additional area where sheer is less than standard.



© 2021

Lloyd's Register
Foundation

7/6/20

PARTICULARS OF PROTECTION TO OPENINGS, ETC.

HATCHWAYS ON FREEBOARD AND SUPERSTRUCTURE DECKS.

(DIMENSIONS IN MM)

Description of Hatchway	ACCESS						
			TO FORD HOLD.	TO BOSS'S STORE.	TO PUMP SPACE.	TO MAIL ROOMS.	TO HOLD.	STEER. CR.	ESCAPE (2)
Dimensions of Hatchway	3000 x 2400	600 DIA.	500 x 590	500 x 590	500 x 590	500 x 500	500 x 500
COAMINGS	Height above Deck	...	745	610	610	610	610	610	230
	Thickness	Sides	10	6	6	6	6	6	4.5
	Stiffeners	Ends	10	-	-	-	-	-	-
	Brackets, Stays	Sides	10MM FL. PL.	-	-	-	-	-	-
HATCH BEAMS	Number	...	NONE	NONE	NONE	NONE	NONE	NONE	NONE
	Spacing	...							
	Scantling and Sketch	...							
	Bearing Surface	...							
FORE AND AFTERS	Number	...	/	/	/	/	/	/	/
	Spacing	...	/	/	/	/	/	/	/
	Unsupported Lengths	...	/	/	/	/	/	/	/
	Scantling* and Sketch	...	/	/	/	/	/	/	/
HATCH COVERS	Material	...	STEEL	STEEL	STEEL	STEEL	STEEL	STEEL	STEEL
	Thickness	...	8	8	6	6	6	6	4.5
	How fitted	...	THWART	HINGED AND	HINGED AND	HINGED AND	HINGED AND	HINGED AND	HINGED AND
	Bearing Surface	...	80	SECURED	SECURED	SECURED	SECURED	SECURED	SECURED
Spacing of Cleats	540	W.T.	W.T.	W.T.	W.T.	W.T.	BY
Number of Tarpaulins	2	BY 4 CLIPS.	BY 4 CLIPS.	BY 4 CLIPS.	BY 4 CLIPS.	BY 4 CLIPS.	2 CLIPS.

Are wood fore and afters steel shod at all bearing surfaces? **NONE**.

Are battens and wedges efficient and in good condition? **YES**.

Are tarpaulins in good condition and in accordance with rule requirements? **YES**.

Are lashings provided in accordance with rule requirements? **YES - LOCKING BARS**.

Are wood covers fitted with galvanised end bands? **NONE**.

Particulars of any special features:— (Timber Deck-cargo Fittings, Skylights, Sewage Systems, Ash Ejectors, Rubbish Shoots, etc.)

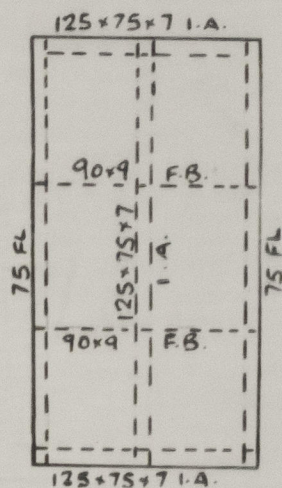

PONTOON HATCH COVERS TO FORD HOLD (3-OFF)