

SS ELLINIS
 SEMI-CIRCULAR PROTECTION PLATE X
 BULWARK ON UPPER DECK (AS FITTED)
 SCALE: 1/4" = 1 FOOT

APPROVED BY LLOYDS
 16 OCT. 1963.

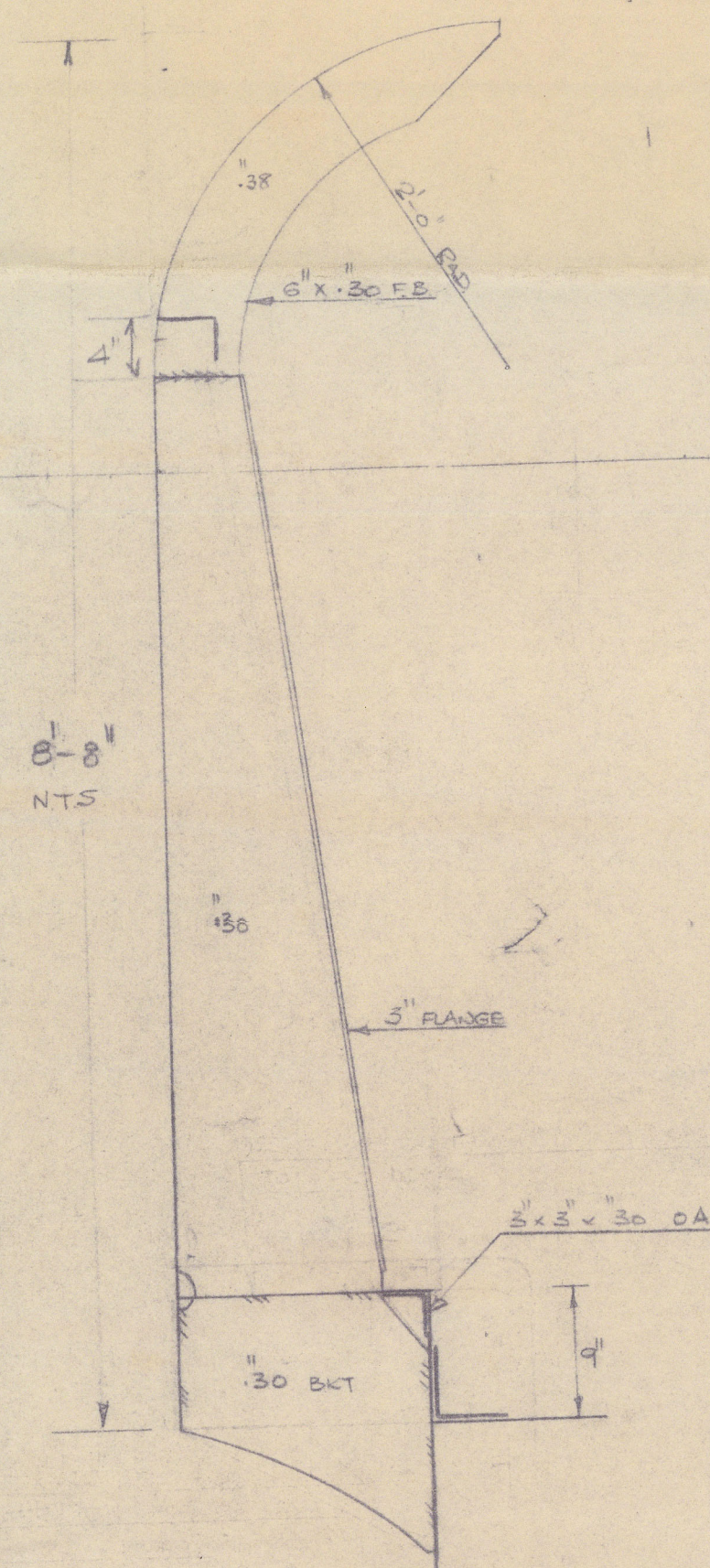

TYPICAL SECTION THRO
 X-X
 SCALE: 1/4" = 1 FOOT

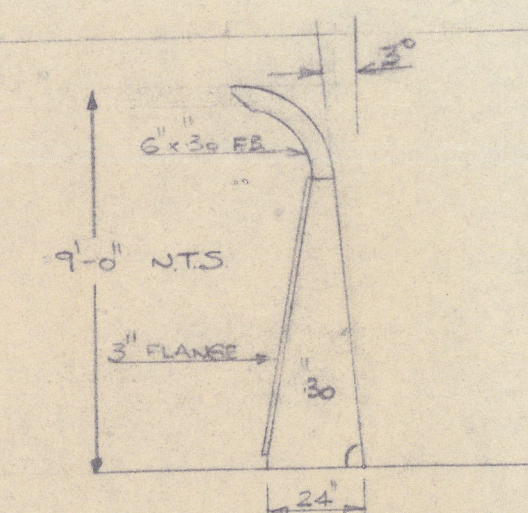
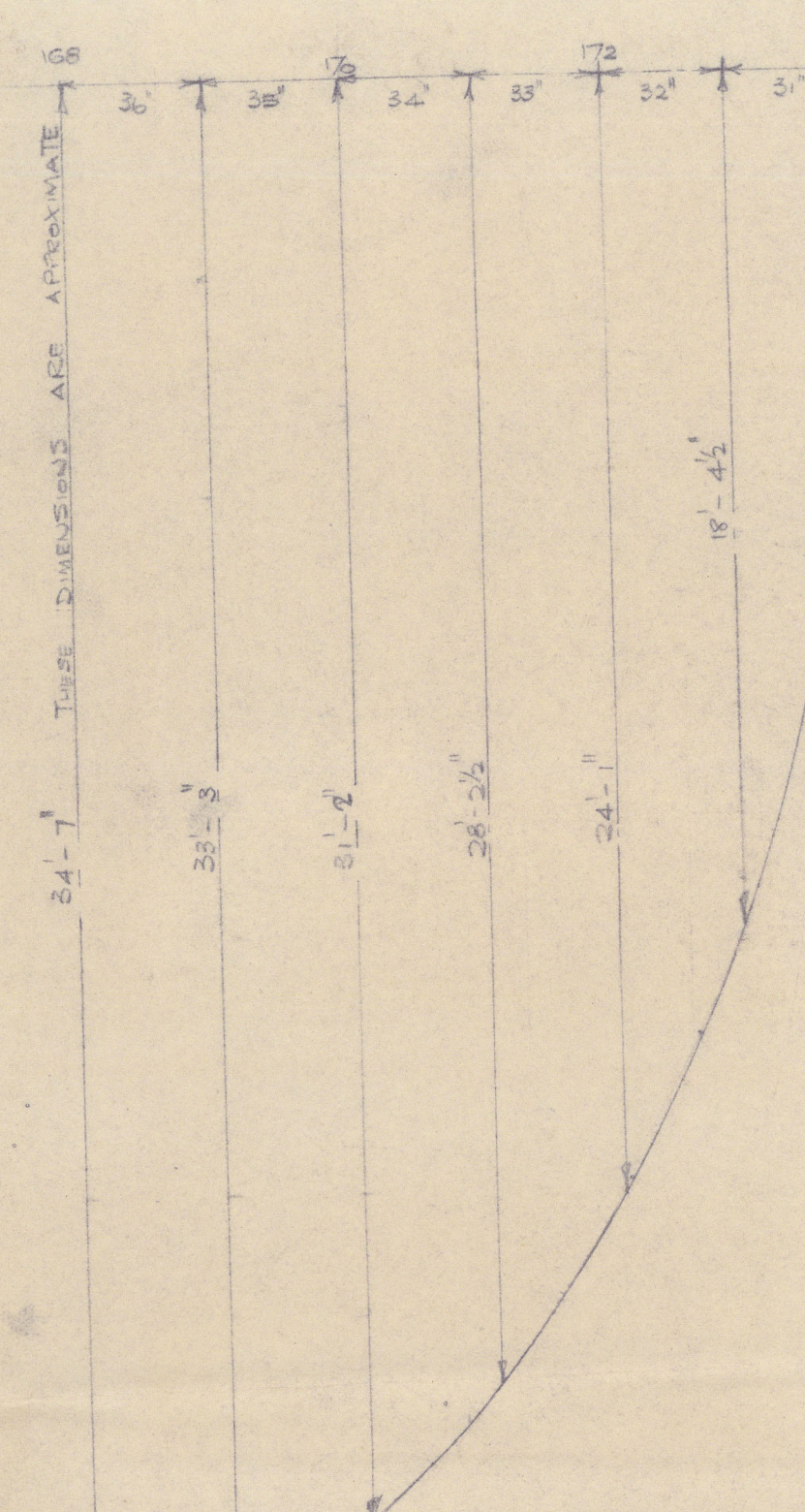

TYPICAL BRACKET
 SIMILAR TO THOSE
 FITTED TO EXISTING
 BULWARK

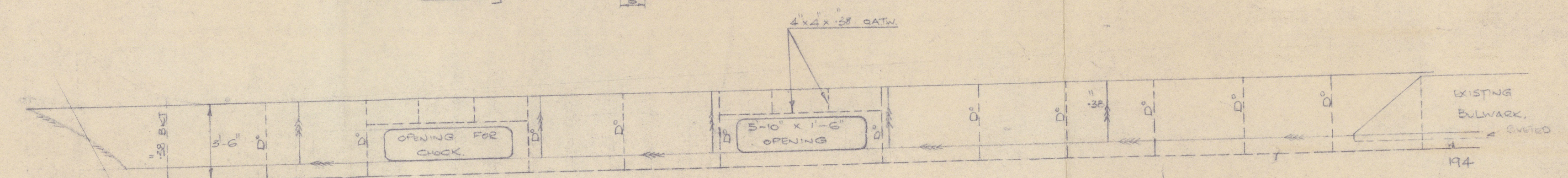
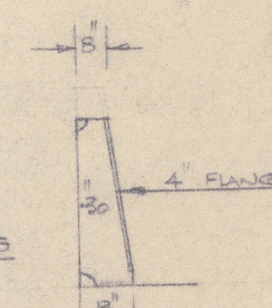

CONTINUATION OF BULWARK

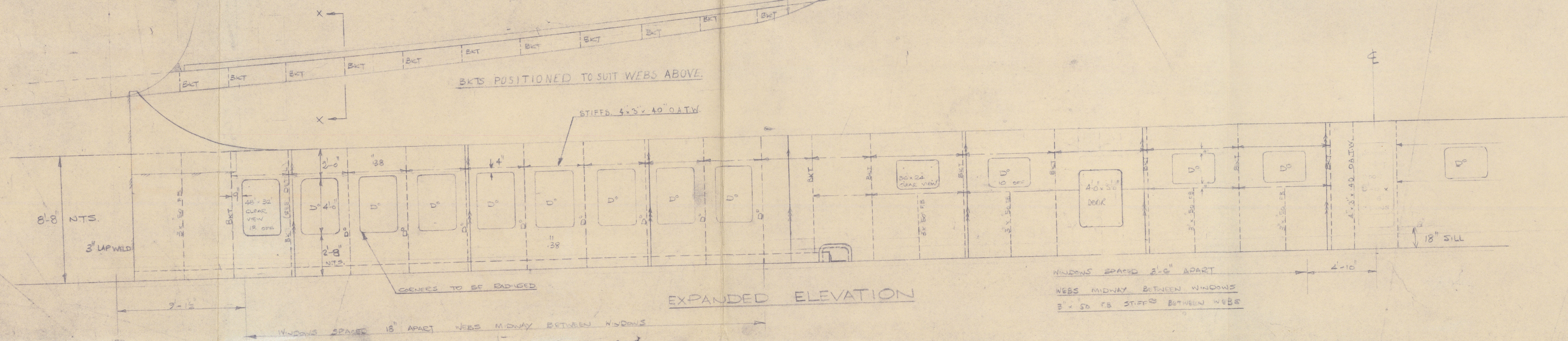

EXPANDED ELEVATION

WINDOWS SPACED 2'-0" APART
 WEBS MIDWAY BETWEEN WINDOWS
 3/4" x 30" FB STIFFER BETWEEN WEBS