

44773

Rpt. C.11.

Lloyd's Register of Shipping.

SURVEYS FOR FREEBOARD.

(CONDITIONS OF ASSIGNMENT.)

Index No. (For London Office only.)

Ship's Name **"ZAGORA"**

Port of Survey **La Seyne-sur-Mer**

Official Number

Surveyor's Signature

Nationality and Port of Registry **Moroccan, CASABLANCA**

Date of Survey **whilst building**

Disposition and dimensions of superstructures, trunks, deckhouses and machinery casings to be inserted in the diagrams and tabular statement:

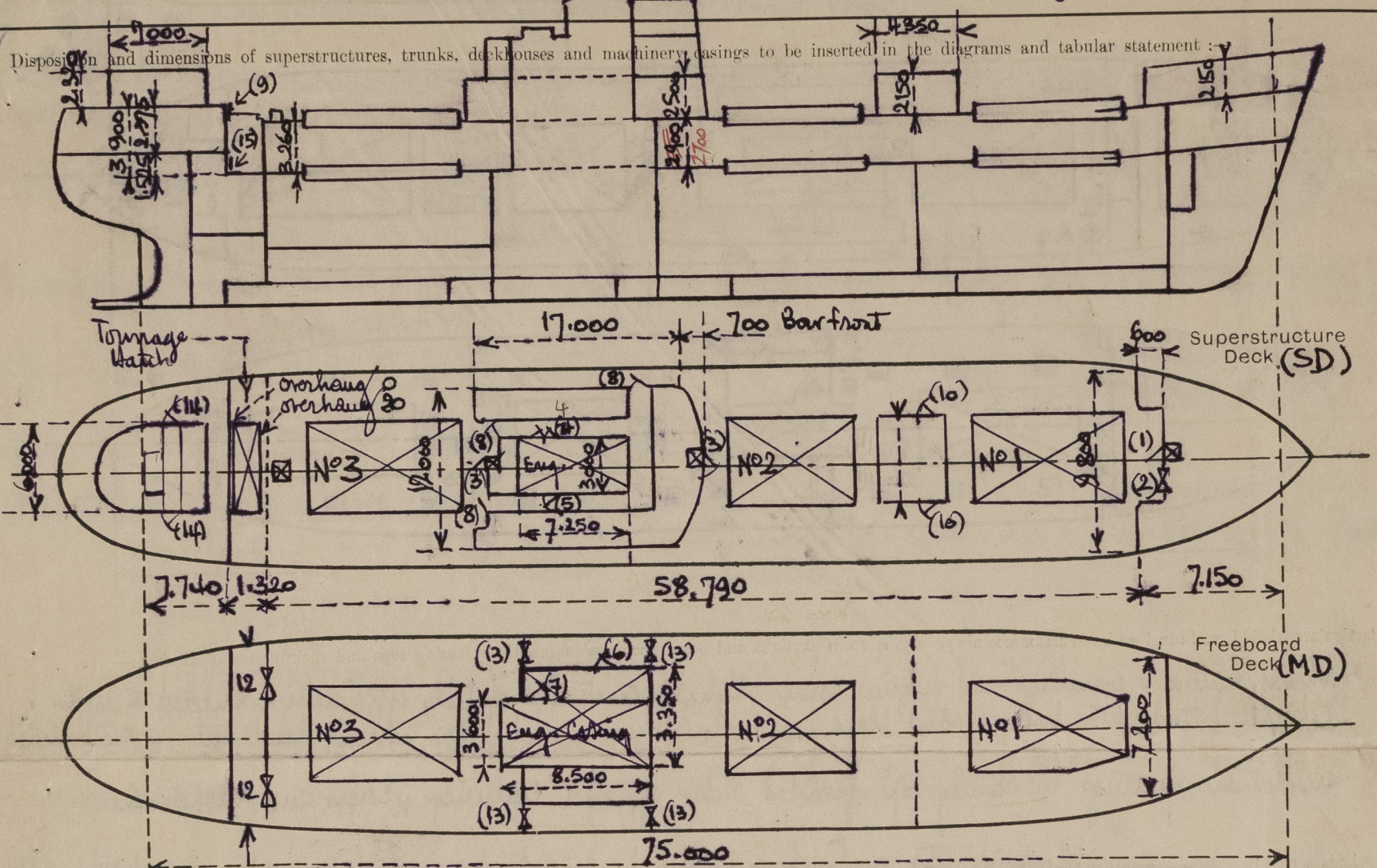

Breadth of Deck at CR of Tonnage Hatch = 11.900

Particulars of Superstructures, Trunks, Casings, Deckhouses.

Identification numbers

	Plating Ext. to Deck	Plating	Stiffeners	Spacing	End Attachments of Stiffeners	Size of Openings	Height of Sills	Height of Casings
Poop Bulkhead (Tonnage well) top.	6.0	6.0	1 80x8	425	E.W. to Decks at Top and Bot.	2 part lights clear 300x1415 (9)	250	2.375
Combined with Raised Quarter Deck Bulkhead (Tonnage well) both.	7.5	7.5	1 160x8	650	360x550x10 brackets at Top E.W. to Deck	2 manholes w.t. 500x400 (15)	600	1.525
Bridge After Bulkhead (Tonnage well) top.	6.0	6.0	1 80x8	400 at CL 400 p.d.s.	E.W. to Deck at Bot	1.700x920 (12)	250	3.260
Midship Deck House	7.0	7.0	L 120x80x10 L 75x55x7	640 at CL 400 p.d.s.	E.W. to Deck at Bot	1.340x520 (3)	610	2.500
Bridge Forward Bulkhead	7.0	7.0			E.W. to Deck	1.750x630 (8)	250	2.500
Midship Deck House after Forecastle Bulkhead and sides	7.0	7.0			E.W. to Deck	1.700x700 (8)	250	2.500
Forecastle Bulkhead on S.D.	8.0	6.5	1 80x8	700	300x300x8 brackets at top	1.340x630 (1)	610	2.150
Door Deck House	250x8	6.5	1 80x8	600	300x200x7 brackets at Bot.	1.500x750 (14)	400	2.320
Trunk Forward						doors p.d.s.		
Exposed Machinery Casings on Freeboard or Raised Quarter Decks	✓	✓	✓	✓	✓			✓
Exposed Machinery Casings on Superstructure Decks	✓	✓	✓	✓	✓			✓
Machinery Casings within Superstructures not fitted with Class I Closing Appliances	SD MD 250x9	6.0 6.5	75x55x7 80x60x7	600		SD 1.700x1000 (4) 1.700x620 (5) MD 1.700x900 (6) 1.100x930 (7)	240 240 250 250	2.460 2.706
Deckhouses on Flush Deck Ships	250x8	6.0	100x100x10	600	400x300x8 brackets	1.340x630 (10) 1.000x1000 alt (11)	610 1000	2.150

Particulars of Closing Appliances (state if capable of being manipulated from both sides).

	Identification numbers	Description
Poop Bulkhead	(9)	Steel portable bolted watertight manhole cover p.d.s.
Combined with Raised Quarter Deck Bulkhead	(15)	Hinged port light (p.d.s.) with steel plate covers secured from outside by toggles
Bridge After Bulkhead	(12)(13)	Shifting boards (p.d.s.) in welded channel, 60 mm thick wood.
Midship Deck House	(3)	Hinged steel doors, manipulated from both sides.
Bridge Forward Bulkhead and sides and aft Bulkheads	(8)	Hinged hard wood doors, 50 mm thick, manipulated from both sides.
Forecastle Bulkhead on S.D.	(1)	Hinged steel door, manipulated from both sides.
Exposed Machinery Casings on Freeboard or Raised Quarter Decks	(2)	Shifting boards, 60 mm thick wood, in welded channels.
Exposed Machinery Casings on Superstructure Decks	(14)	Hinged hardwood doors, 50 mm thick, manipulated from both sides.
Machinery Casings within Superstructures not fitted with Class I Closing Appliances	(4)(5)(6)(7)	Hinged wood doors, lined with steel, manipulated from both sides.
Deckhouses on Flush Deck Ships	(10)(11)	Hinged steel doors, manipulated from both sides.

013735-013739-0131 1/2

PARTICULARS OF PROTECTION TO OPENINGS, ETC.

The following diagrams should be used to indicate the positions of cargo and coaling hatchways, gangway, cargo and coaling ports, ventilators, companionways, etc., which would affect the seaworthiness of the ship :-

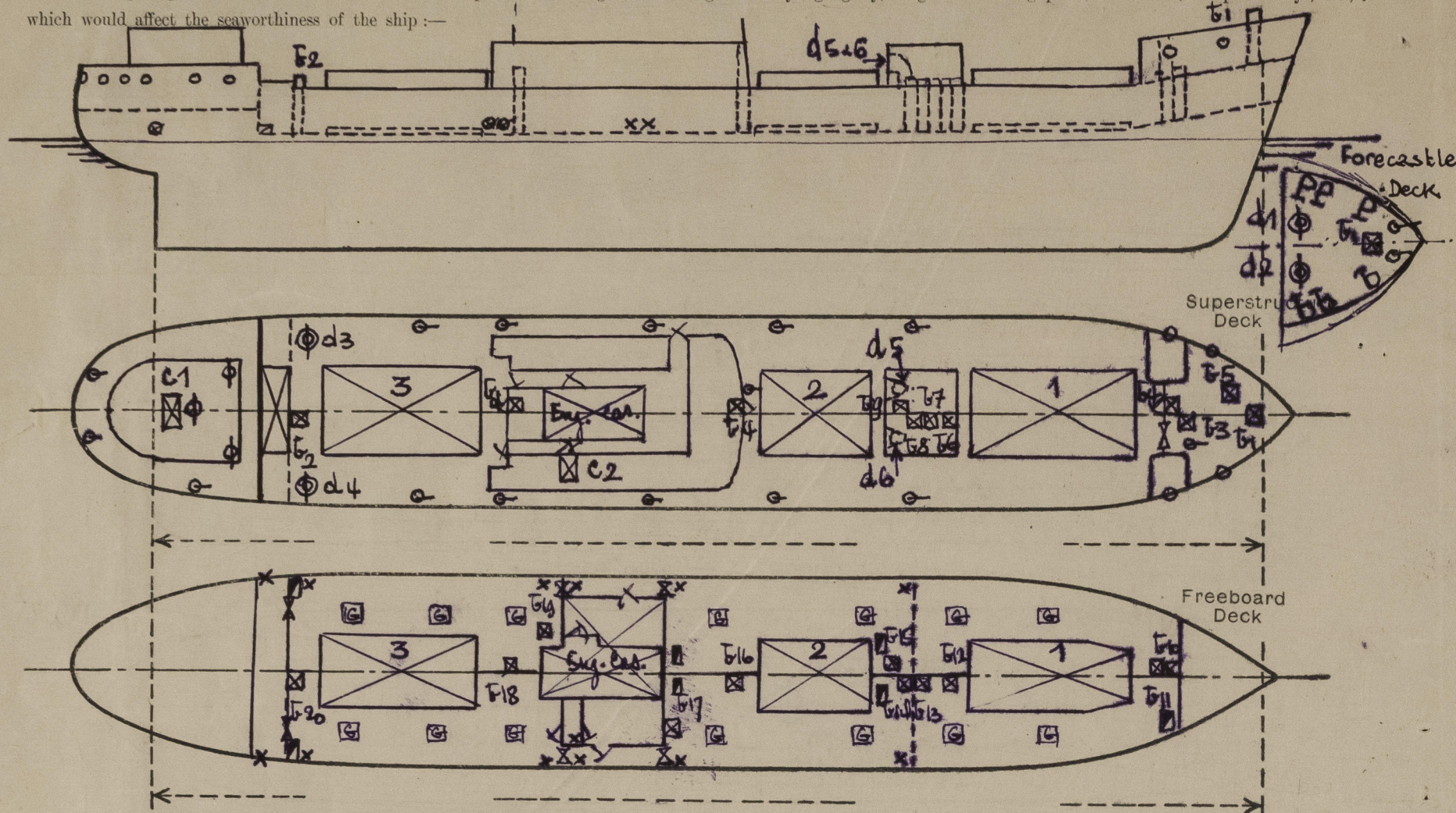

Particulars of fiddle, funnel and ventilator coamings, engine room skylight and other openings in machinery casing tops and their means of closing :-

Funnel, Ventilator coamings and engine room skylight, constructed of steel, efficiently connected to decks. Skylight fitted with hinged steel flaps, painted with annealed glass panels protected by steel plates. Ventilation opening in casing top provided with efficient coaming, covers and tarpaulins.

Particulars of Flush Bulkhead Scuttles: On Foreboard Deck for loading grain cargoes: opening fitted with hinged steel gratings which automatically fall shut and with steel plate covers bolted watertight and permanently attached to deck by chains.

Particulars of Companionways: On Roop Deck (C1) and Shelter Deck (C2) enclosed in steel deck houses with hard wood doors; (C3) (C4) (C5) enclosed in forecastle and midship deck houses and each provided with efficient coamings and hinged steel doors. (C6) (C7) (C8) (C9) in main deck house, coaming 100" x 10" hinged steel covers (C1) exposed on Shelter Deck and (C2) exposed on Shelter Deck, coaming 610 x 8" w.p. E.W. to deck and closed by hinged steel covers and bangles. On Main Deck 11-12-13-14-15-16-17-18-19-20 in steel trunks, coaming 150 x 9" th, closed by hinged steel covers and clips.

Particulars of Ventilators in exposed positions on freeboard and superstructure decks :-

- ① Cargo Hold, Con type Ventilators d 1-2-3-4 : 780 diam x 10 mm th, 900 high coaming, steel covers and bangles on Shelter Deck also d 5 & 6 enclosed in Mast House, sill of opening 1000 closed by efficient steel covers and bangles.
- ② Accommodation, goose neck Vent. d 1-2-3-4-5-6-7-8 : 200 x 12 mm section, 6 mm th, 800 high of galvanised steel, fabricated, and closed by hinged steel covers secured by clips.
- ③ Cargo Hold Ventilating ducts, steel 6 mm th, efficiently connected to decks and bulkheads by welding, and all access opening in ducts closed by steel plates bolted watertight.
- ④ Accommodation, Con type Ventilators : 2 each, diam 6" th, 140" high coamings, closed by screwed down steel covers.

Particulars of Air Pipes in exposed positions on freeboard, raised quarter, or superstructure decks :-

- Forecastle Deck : 2 in 100 100 mm diam. x 760 mm high air and filling pipes closed by screwed flaps.
- Shelter Deck : 8 in 100 100 mm diam. x 760 mm high air pipes hinged steel flaps & clips, wire gauge, canvas covers 5 in 100 90 mm diam. x 750 mm high, closed by steel flaps & clips & canvas covers.
- Roop Deck : 2 in 100 100 mm diam. x 650 mm high air and filling pipes closed by screwed flaps. 1 in 100 90 mm diam. x 650 mm high, closed by steel flaps & clips.

Particulars of Gangway Cargo and Coaling Ports :- None.

- Particulars of Scuppers and Sanitary Discharge Pipes :- X Scuppers ⊗ Sanitary discharges ⊠ Tonnage well scuppers.
- (1) Forecastle deck space drained to Shelter Deck through forecastle bulkhead, drain holes provided with plugs & chain attached. Mast House : as forecastle. Bridge House drained by galvanised pipes and led overboard above F.B. deck through steel N.R. valves at ship's sides. Shelter Deck and Roop Deck drained overboard above F.B. deck through galvanised steel pipes efficiently secured to ship's sides. Roop House drained as Bridge House.
 - (2) Freeboard deck in way of holds drained to hold wells through scuppers fitted with screw down W.T. valves accessible at all times lead to Engine Room bilges where the lower end of the pipes are visible from the lower platform.
 - (3) Freeboard deck in way of Tonnage well : 160 x 90 mm (32.3 sq. in) Scupper (p.s.) from tonnage well led overboard along freeboard deck with cast steel S.D. at ship's side which are controlled from the shelter deck and fitted with open/shut indicator.
 - (4) Raised quarter deck : drained through after peak tank in galvanised steel pipes and to ship's sides through N.R. valves in tank (p.s.).

Particulars of Side Scuttles :-

Shelter Deck : shown thus : Steering gear compartment (aft) 2 in 10, cast brass frame, 150 mm clear, opening type fitted with hinged doors and light. Roop accommodation (p.s.) 5 in 10, description as above. Forecastle : crew room (s.s.a) 1 in 10; carpenter shop (s.s.f) 1 in 10; sail room and paint room on flat side one each, all of description similar to the above.

Vertical distance of Sill of lowest Side Scuttle above top of keel. None below freeboard deck.

Particulars of Guard Rails :-

Shelter Deck : Bulwark : 1000 high x 6 mm (plating), rail bar 150 x 75 x 9 mm angle stays 180 x 7 mm bulb plate spaced 1.320 mm welded to deck. Forecastle Deck : Guard rails, 3 rods 50 x 20 mm with 80 x 12 mm flat standards 1.200 mm apart. Roop Deck : Guard rails of description as above.

Particulars of Gangways, Ladders, etc. :-

Particulars of Freeing Arrangements.						
	Length of Bulwark	Height of Bulwark	Size of Freeing Ports	Number each side	Area each side	Rule area each side
After Well						
Shelter Deck	60.060	1.000	0.710 x 0.200	13	184.6 dm ²	1.444 m ²
Forward Well						

State position of each freeing port ... Positions from forecastle Bulkhead in metres as follows : (F. and A. position and height above deck edge) { After Well : 8.6-15.4-17.8-21.8-24.4-25.8-29.1-31.7-34.4-46.2-51.5-58.2- Height above deck edge : 200 mm. State whether the freeing ports are fitted with shutters, bars, or rails, and give particulars of such : No shutters or rails. Additional area where sheer is less than standard. ✓

PARTICULARS OF PROTECTION TO OPENINGS, ETC.

All the dimensions are in m/m

HATCHWAYS ON FREEBOARD AND SUPERSTRUCTURE DECKS.										
F.B. Deck										
S.D. Deck										
Description of Hatchway	No 1	No 2	No 3	Flush op. for grain	Access Hatch	No 1	No 2	No 3	Trussing Hatch	Access (B) Hatch
Dimensions of Hatchway	11.863 x 5.000	7.909 x 5.000	12.528 x 5.000	520 x 520	600 x 550	4.880 x 5.000	7.920 x 5.000	15.466 x 5.000	1.300 x 4.960	600 x 510
COAMINGS	Height above Deck	240	240	240	230	840	840	840	250	610
	Thickness	11	11	11	10	11	11	11	10	8
	Stiffeners	✓	✓	✓	✓	✓	✓	✓	✓	✓
	Brackets, Stays	✓	✓	✓	✓	✓	✓	✓	✓	✓
HATCH BEAMS	Number	7	4	7		7	4	7		
	Spacing	1585	1585	1585		1586	1586	1586		
	Scantling and Sketch	250x14	250x14	250x14	✓	250x14	250x14	250x14	250x14	250x14
	Bearing Surface	80	80	80		80	80	80	80	80
FORE AND AFTERS	Number	✓	✓	✓	✓	✓	✓	✓	✓	✓
	Spacing	✓	✓	✓	✓	✓	✓	✓	✓	✓
	Unsupported Lengths	✓	✓	✓	✓	✓	✓	✓	✓	✓
	Scantling* and Sketch	✓	✓	✓	✓	✓	✓	✓	✓	✓
HATCH COVERS	Material	Wood	Wood	Wood	Steel	Steel	Wood	Wood	Wood	Steel
	Thickness	65	65	65	7.5	6	65	65	65	6
	How fitted	F&A	F&A	F&A	bolts	braced	F&A	F&A	F&A	braced
	Bearing Surface	60	60	60	Rubber	Rubber	60	60	60	Rubber
Spacing of Cleats	542	542	542	14 1/2 bolts	4 clips	542	542	542	✓	4 clips
Number of Tarpaulins	1	1	1	✓	✓	2	2	2	✓	✓
<p>*Are wood fore and afters steel shod at all bearing surfaces? <i>yes</i></p> <p>Are battens and wedges efficient and in good condition? <i>yes</i></p> <p>Are tarpaulins in good condition and in accordance with rule requirements? <i>yes</i></p> <p>Are lashings provided in accordance with rule requirements? <i>yes, lashing has provided for no 1-2 & 3 cargo hatches on Shelter Deck</i></p>										

Particulars of any special features:—

Sliding Hatch beams on Shelter Deck Hatchways provided with efficient locking arrangements to prevent tripping.

✓ Hatch webs at No 1 hatch on Shelter Deck

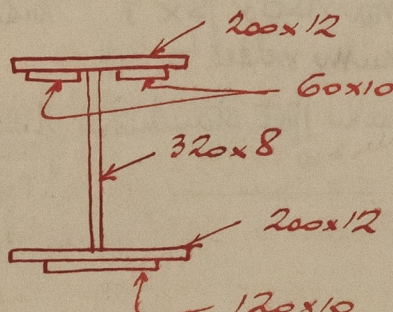

© 2021

Lloyd's Register Foundation