

Free

PRINCIPAL DIMENSIONS:-

LENGTH (OVER ALL)	119.000
LENGTH (BETWEEN PERPENDICULARS)	112.000 (36.741')
BREADTH (MID)	15.000 (31.84')
DEPTH (MID)	9.000 (24.45')
TOTAL LOAD DRAFT (ABOVE TO DECK)	7.510 (24.62')

THREE DECK HEIGHT:-

FROM UPPER DECK TO SECOND DECK	3.000 (9.84')
FROM UPPER DECK TO BRIDGE DECK	2.300 (7.55')
FROM UPPER DECK TO FOLE DECK	2.300 (7.55')
FROM UPPER DECK TO POOP DECK	2.300 (7.55')
FROM BRIDGE DECK TO BOAT DECK	2.300 (7.55')

LENGTH OF SUPERSTRUCTURES

BRIDGE DECK	14.400 (12.86')
FOLE DECK	8.810 (26.47')
POOP DECK	9.840 (31.53')

CLASS: LLOYD'S REGISTER OF SHIPPING

100A1&LM

EQUIPMENT NUMBER:-

L x (B+D)	267.45 x (51.84+29.53) = 29,899
POOP	34 x 31.53 x 7.55 = 179
BRIDGE	3/4 x 112.86 x 7.55 = 639
FOLE	3/4 x 26.57 x 7.55 = 150
DS HOUSE ON BRIDGE DS	1/2 x 78.54 x 7.55 = 296
DS ON BOAT DS	1/2 x 21.02 x 7.55 = 79
TOTAL	31,242

EQUIPMENT:-

ITEM	DECK	SCANTLING
BRIDGE ANCHOR (UNDERLIES)	1	2.8" x 10" EACH
STREAM ANCHOR	1	7.62" (3/4" STOCK)
CHAIN CABLE	1	1/2" x 17.5"
STEEL WIRE FOR STREAM ANCHOR	1	3/8" x 220"
HAIRY WIRE FOR TAIL LINE	2	60" (MANILA) 165"
WASERS	2	20"

DECKS

DECK	STRINGER PLATE	GUNWALE ANGLE	DECK PLATE
UPPER DECK	800 x 10	90 x 90 x 10	8
SECOND DECK	800 x 10	90 x 90 x 10	8
BRIDGE DECK	800 x 10	90 x 90 x 10	8
FOLE DECK	800 x 10	90 x 90 x 10	8
POOP DECK	800 x 10	90 x 90 x 10	8

NOTE: UPPER DECK STRINGER PLATE 24" AT THE BREAKS IN PLATING

BULWARKS:-

DECK	HEIGHT	PLATE	STAY	TOP ANGLE
UPPER DECK	1.70	6	8 BOWED 180	180 x 75 x 13.5
BRIDGE DECK	1.70	6	DS	180 x 75 x 13.5

DECK BEAMS:-

ITEM	SPACED	SCANTLING	BRIDGE
UPPER DECK	2.8" x 10"	200 x 90 x 10	8
SECOND DECK	2.8" x 10"	200 x 90 x 10	8
BRIDGE DECK	2.8" x 10"	200 x 90 x 10	8
FOLE DECK	2.8" x 10"	200 x 90 x 10	8
POOP DECK	2.8" x 10"	200 x 90 x 10	8

DOUBLE BOTTOM

ITEM	SE. B.	AT ENDS	ENGINE SPACE	ROCKER SPACE	NOTE
CENTRE GIRDER	1063 x 12	10	12	14	3
INTERCOSTALS	9	11	13		
MARGIN PLATES	895 x 12	12	15	3-2	
INNER BOTTOM PLATING	12	10	12	3-2	
UNDER STRAKES	11	10	12	3-2	
SOLID FLOORS	9	11	13	15	
TANK END FLOORS	13	13	13		
8" OF OPEN FLOOR	9	9			
CENTRE GIRDER	1063 x 12	10	12	14	3
INTERCOSTALS	9	11	13		
MARGIN PLATES	895 x 12	12	15	3-2	
INNER BOTTOM PLATING	12	10	12	3-2	
UNDER STRAKES	11	10	12	3-2	
SOLID FLOORS	9	11	13	15	
TANK END FLOORS	13	13	13		
8" OF OPEN FLOOR	9	9			
CENTRE GIRDER	1063 x 12	10	12	14	3
INTERCOSTALS	9	11	13		
MARGIN PLATES	895 x 12	12	15	3-2	
INNER BOTTOM PLATING	12	10	12	3-2	
UNDER STRAKES	11	10	12	3-2	
SOLID FLOORS	9	11	13	15	
TANK END FLOORS	13	13	13		
8" OF OPEN FLOOR	9	9			

NOTE: ADDITIONAL INTERCOSTAL SIDE GIRDERS TO BE FITTED IN ENGINE SPACE AND FORWARD OF 1/2 AS PER PLAN. SOLID FLOORS TO BE FITTED ON EVERY FRAME IN ENGINE SPACE UNDER BOLLER BEAM AND FORWARD OF 1/2 AS, AND ON EVERY 4" FRAME ELSEWHERE.

SHELL PLATING

ITEM	1/2 L. B.	AT ENDS	ROCK OF RIV. IN END GUN.
PLATE KEEL	1300 x 19	19	4-3
BOTTOM SHELL A-D	16	11	3-2
DS FORWARD OF 1/2 AS	16		3
SIDE SHELL E-H	16	11	3-2
SHEER STRAKE J	1800 x 19	11	4-2
BRIDGE SIDE PLATING L-M	15	18 (ENGINE END) 4-3	
FOLE SIDE PLATING	10		2
POOP SIDE PLATING	13		3
UNDER BOLLER BEAM	16		3
OTHER PLATES OUTSIDE FRAME	15		3

NOTE: DOUBLING PLATES (60") TO BE FITTED ON SINGE STRAKE AT BREAKS OF BRIDGE

ENGINE CASEING

DECK	QUANING PL.	CABING PL.	TOP PL.	TOP BEAM
BOAT DECK	10	7	7	7
BRIDGE DECK	10	7	7	7
UPPER DECK	11	8	7	7
SECOND DECK	11	8	7	7

COAL BUNKER

ITEM	LONG 8" B.	TRANS 8" B.
LOWEST STRAKE	10	8
OTHER STRAKES	8	8
BOUNDARY ANGLE	75 x 75 x 12	75 x 75 x 12
STIFFENERS	125 x 75 x 10	100 x 12 FB

FRAMES

FRAME SPACING	WHERE USED	SCANTLING
FRAMES 2-11 810	BETWEEN A.P. 8" AND 11" FROM ITEM 1	250 x 90 x 12 3
FRAMES 12-13 650	BETWEEN 11" AND 12" FROM ITEM 1	300 x 90 x 12 7
FRAMES 14-15 700	BETWEEN 12" AND 14" FROM ITEM 1	300 x 90 x 12 7
FRAMES 16-17 750	BETWEEN 14" AND 16" FROM ITEM 1	300 x 90 x 12 7
FRAMES 18-19 800	COAL BUNKER	300 x 90 x 12 7
FRAMES 20-21 850	EDGE BEAM TANK	280 x 90 x 11 7
FRAMES 22-23 900	AFT PEAK TANK	280 x 90 x 11 7
FRAMES 24-25 950	THICKEN DECK	180 x 75 x 8.5 7
FRAMES 26-27 1000	INTERMEDIATE FRAMES IN SUPERSTRUCTURE	150 x 75 x 8 7
FRAMES 28-29 1050	BRIDGE	125 x 75 x 10 7
FRAMES 30-31 1100	POOP	125 x 75 x 10 7

NOTE: 11" FRAMES TO BE FITTED IN ENGINE SPACE AS PER PLAN.

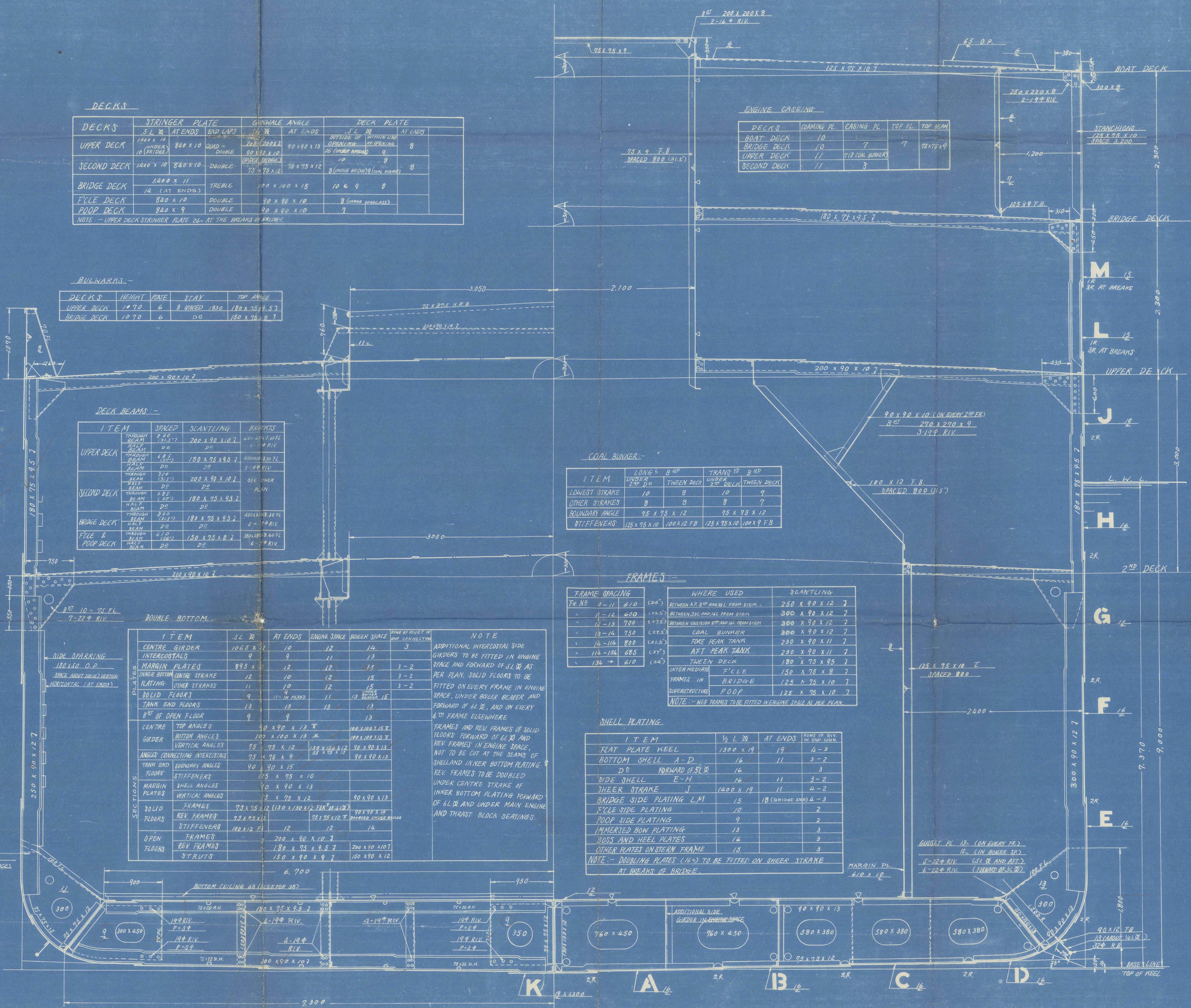
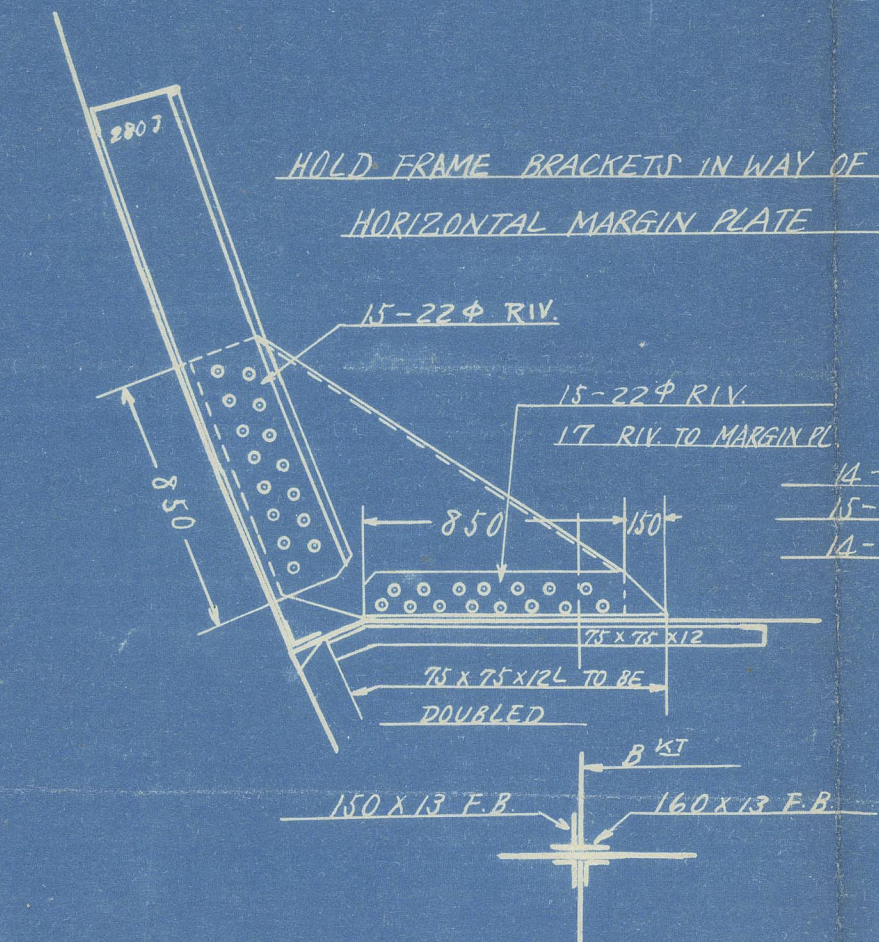

Designed by Kawasaki Dock Yard

雪川丸
25.1.12.
英式=訂正 横型

FOR APPROVAL

LLOYD'S REGISTER OF SHIPPING
RECEIVED

YUKIKAWA MARU

MIDSHIP SECTION

SCALE 1/25

KAWASAKI HEAVY INDUSTRIES CO. LTD.
SHIPBUILDING YARD
KOBAYASHI, JAPAN

SHIPBUILDING DEPARTMENT DESIGN SECTION

CHIEF OF DEPARTMENT

CHECKED

DATE JUN. 12. 1950.

DRAWING NO.

尺度 1/25
川崎重工業株式会社造船部
設計課
設計者 佐藤 清
校核者 佐藤 清
承認者 佐藤 清
25.1.12.
Lloyd's Register

RECORDS DEPT.
LONDON

2

Lloyd's Register
Foundation

013536-013544-002