

# PARETE A 7300 DALLA MEZZ. A SIN. NAVE

MONTANTI 180 x 12 SALVATI STENO 100 x 80

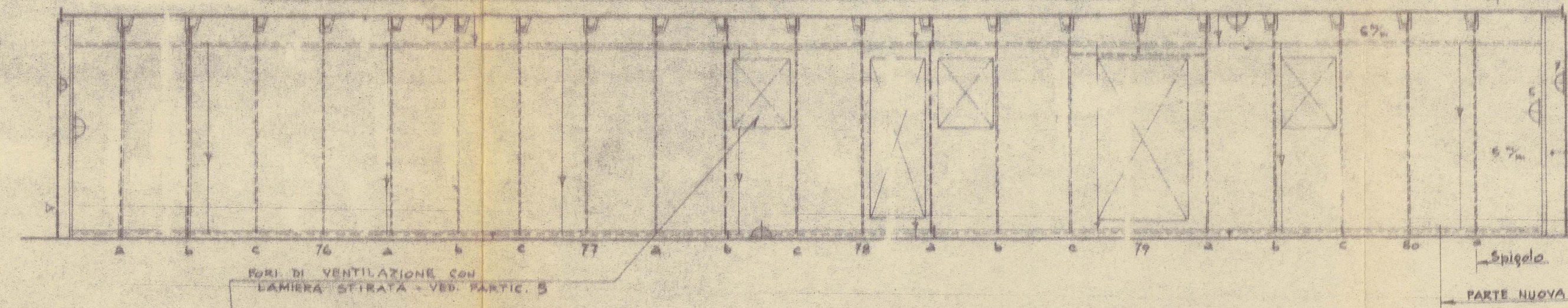

## ANGUILLA A 3935 DALLA MEZZ. - Ds. E Sn. SIMM.

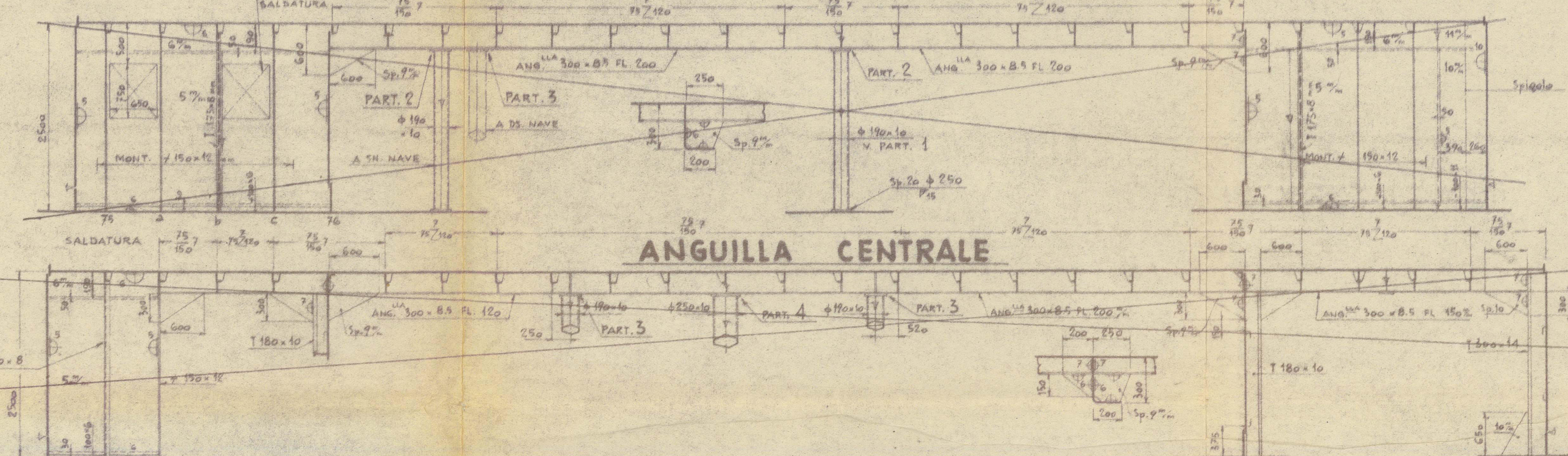

## ANGUILLA CENTRALE

## TETTO TUGA I ORDINE

## PART. BAGLI RINFORZATI

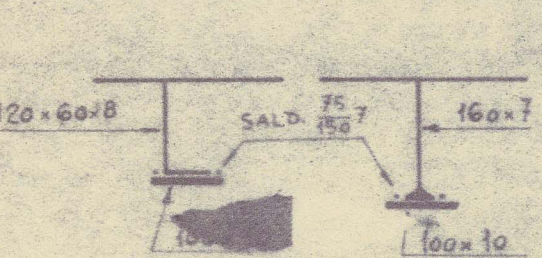

## PARTIC. A.

FINIRE IL PLO. INTERNO DELLA FALCETTA A. PAVI DELLA FACCIA INTERNA DELLA PARATA. POPPIERA ESISTENTE

SCHEMA SALDATURA BAGLI E MONTANTI PARETI INTERNE

# PARETE A 4100 DALLA MEZZ. NAVE

Ds. e Sn. SIMMETRICO

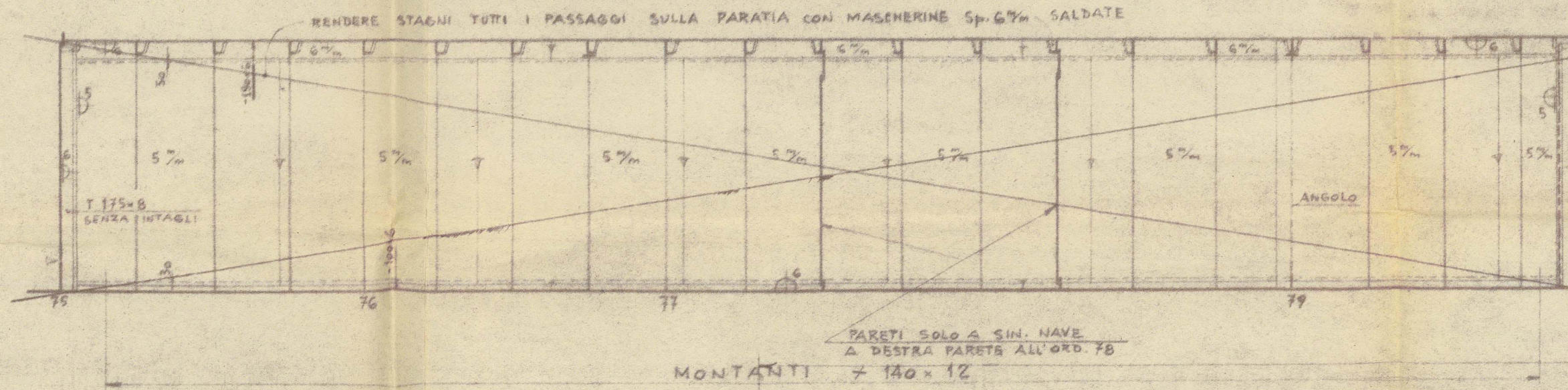

# PARETE A 7300 DALLA MEZZ. A DESTRA N.

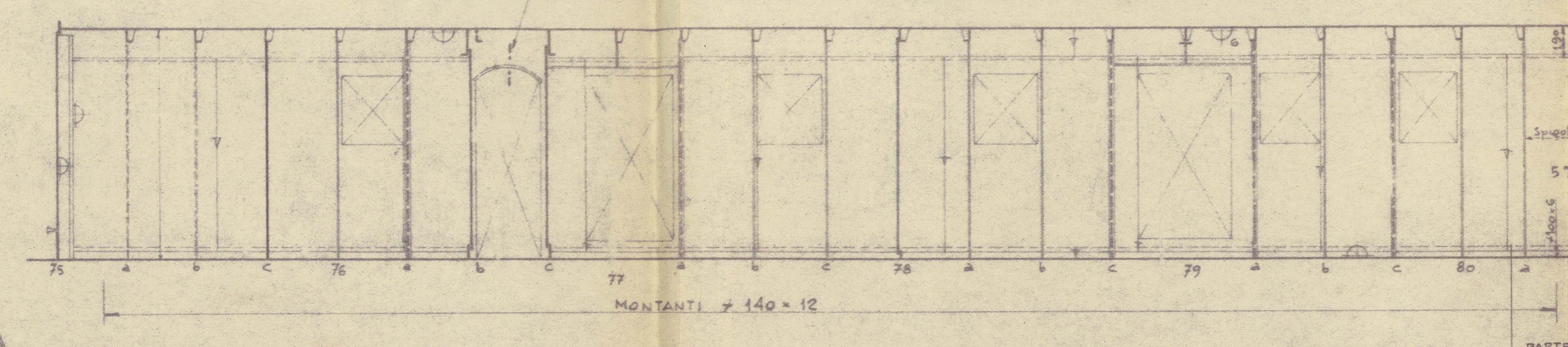

## PARETE ORD. 76 V. DA POPPA

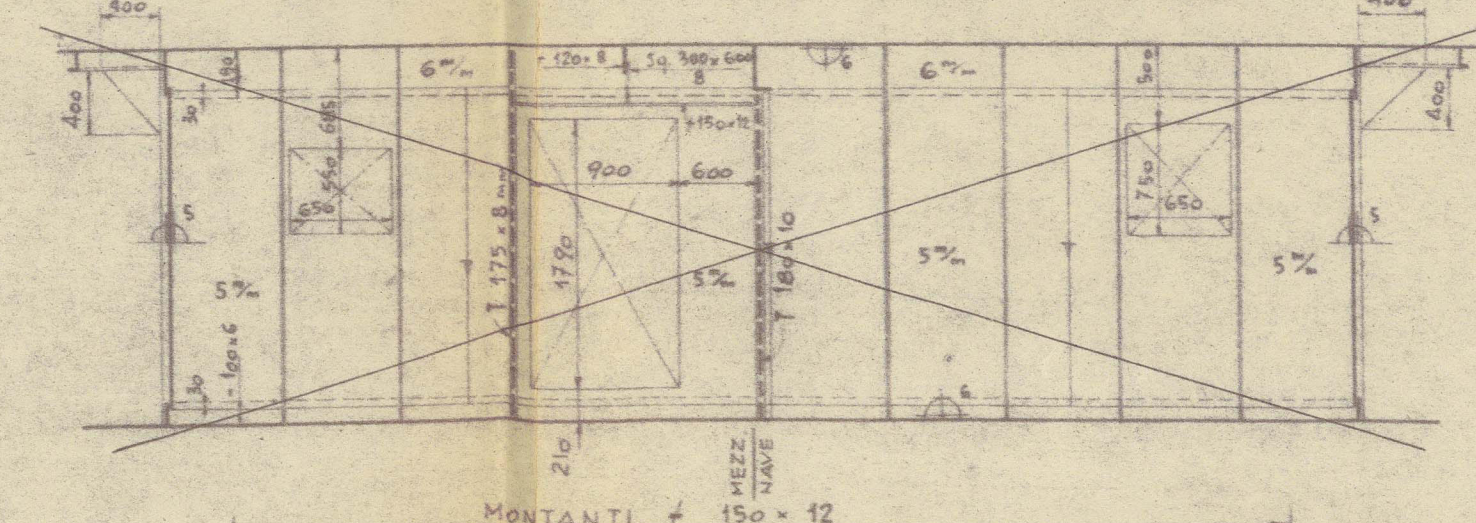

## PARETE ORD. 80 V. DA POPPA

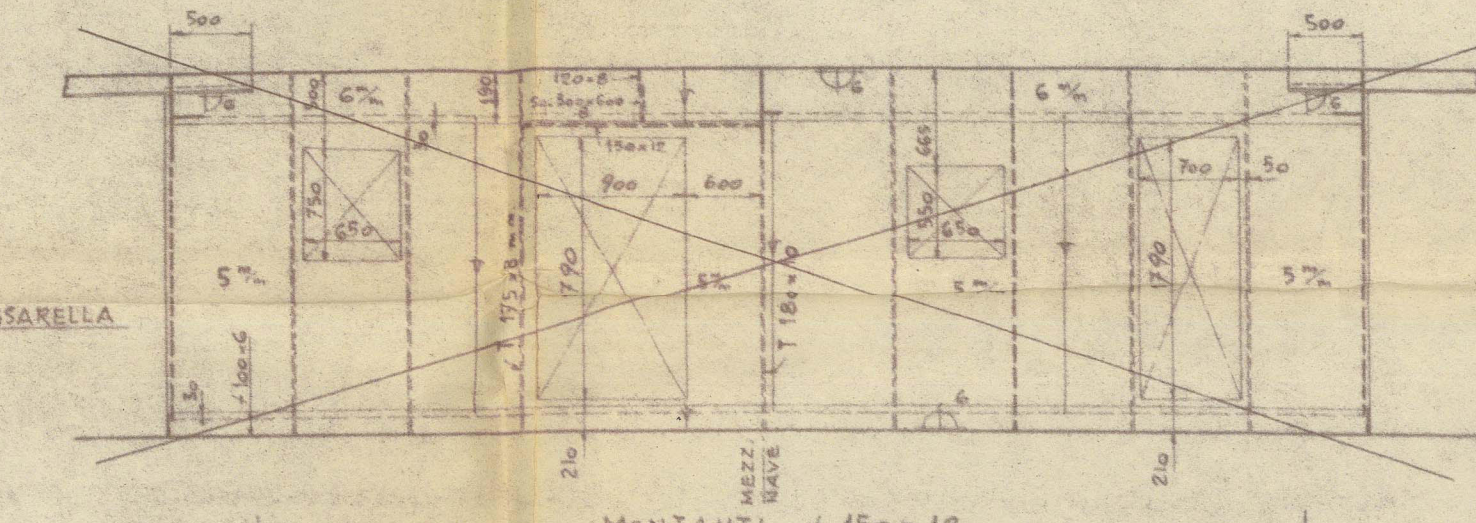

## PAR. ORD. 77b e 78a A Sn.

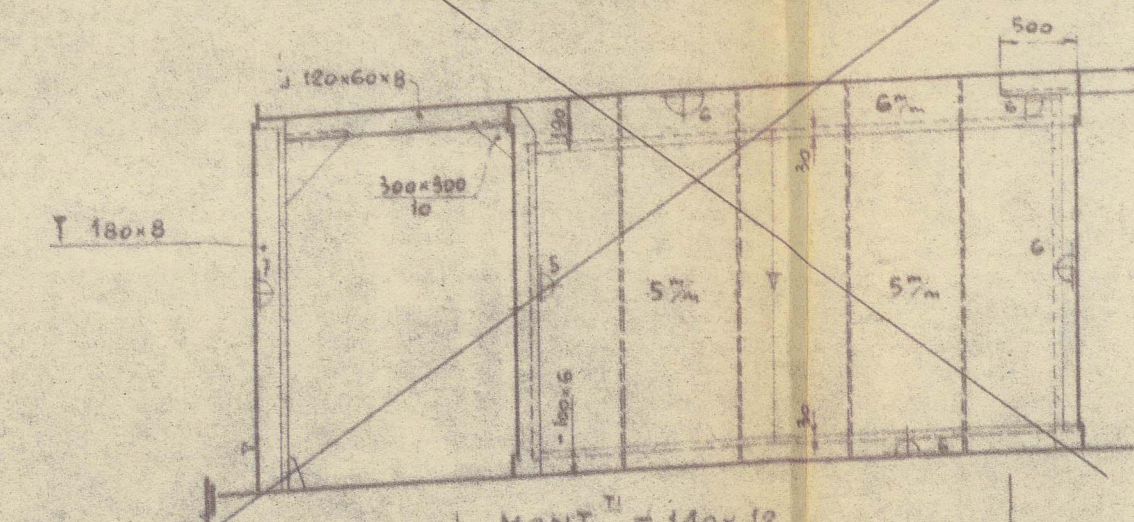

## PAR. ORD. 78 A Ds.

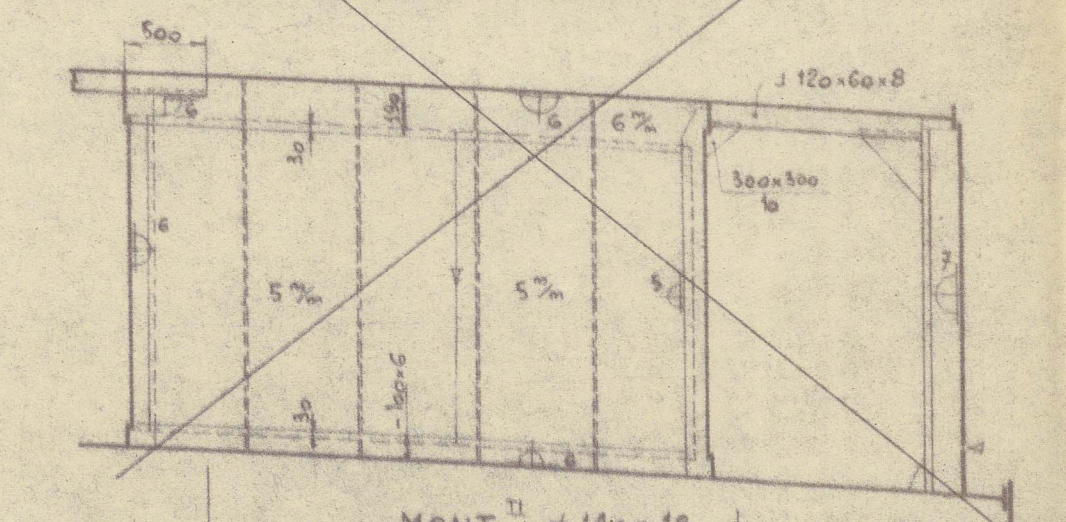

## PAR. A 1625 DALLA MEZZ. A Ds. N.

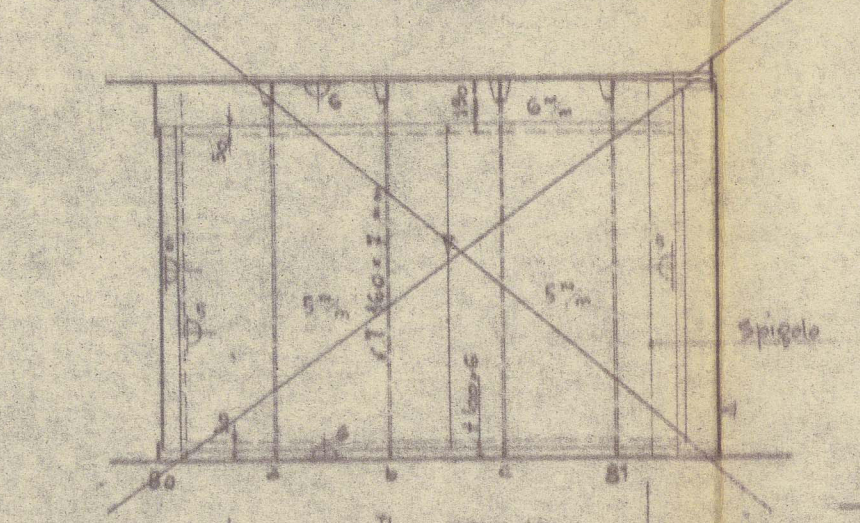

## SEZ. N-N

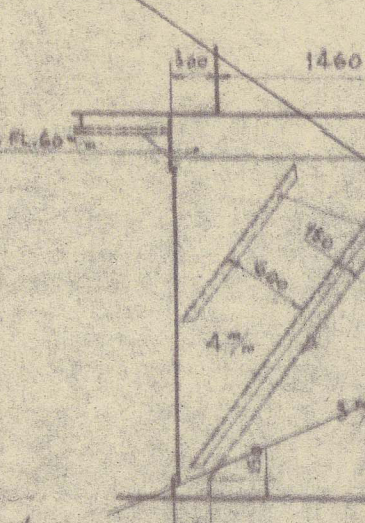

## SEZ. O-O

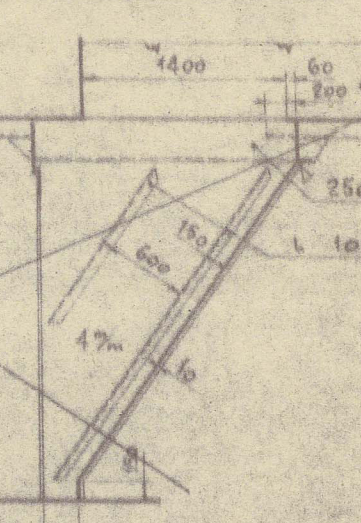

## VISTA P.P.

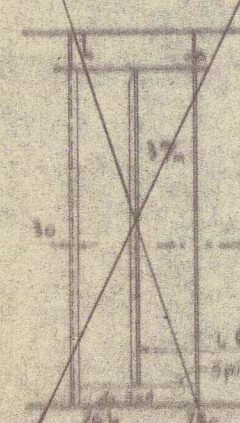

# SVIL. PARETE PERIMETRALE SIN. VISTA DALLA MEZZ. - DESTRA SIMM.

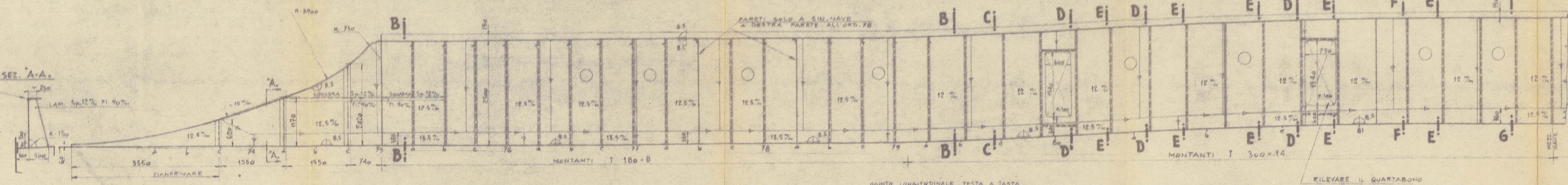

## SVIL. PARETE PERIM. POPPIERA V. DA PRORA

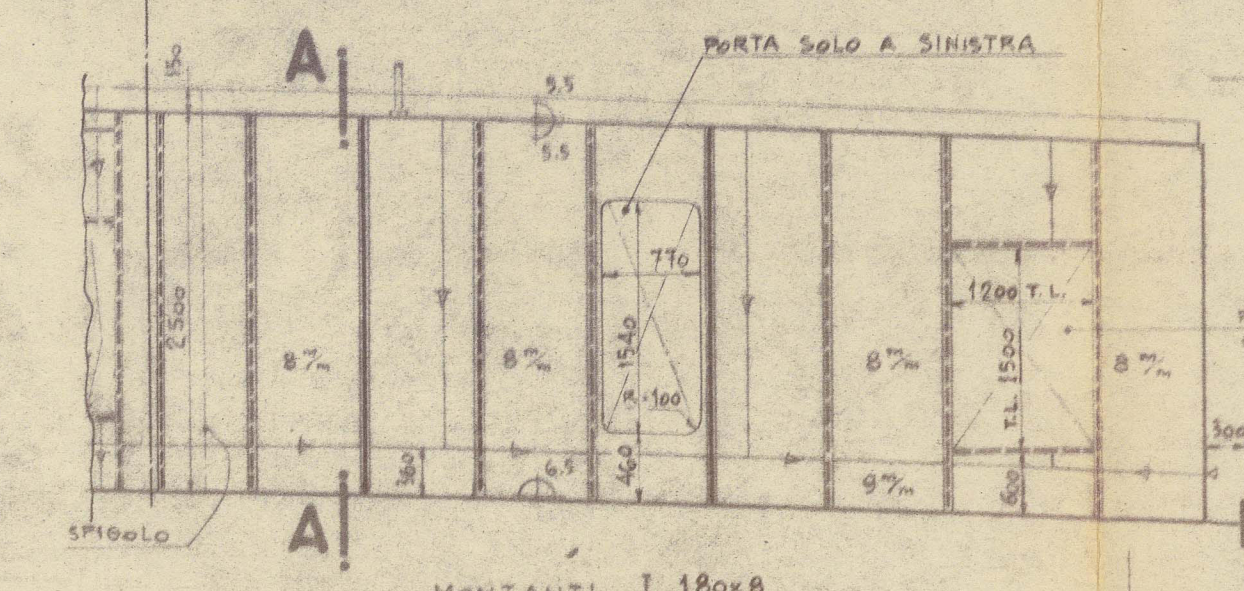

## PIANTA TUGA I ORDINE

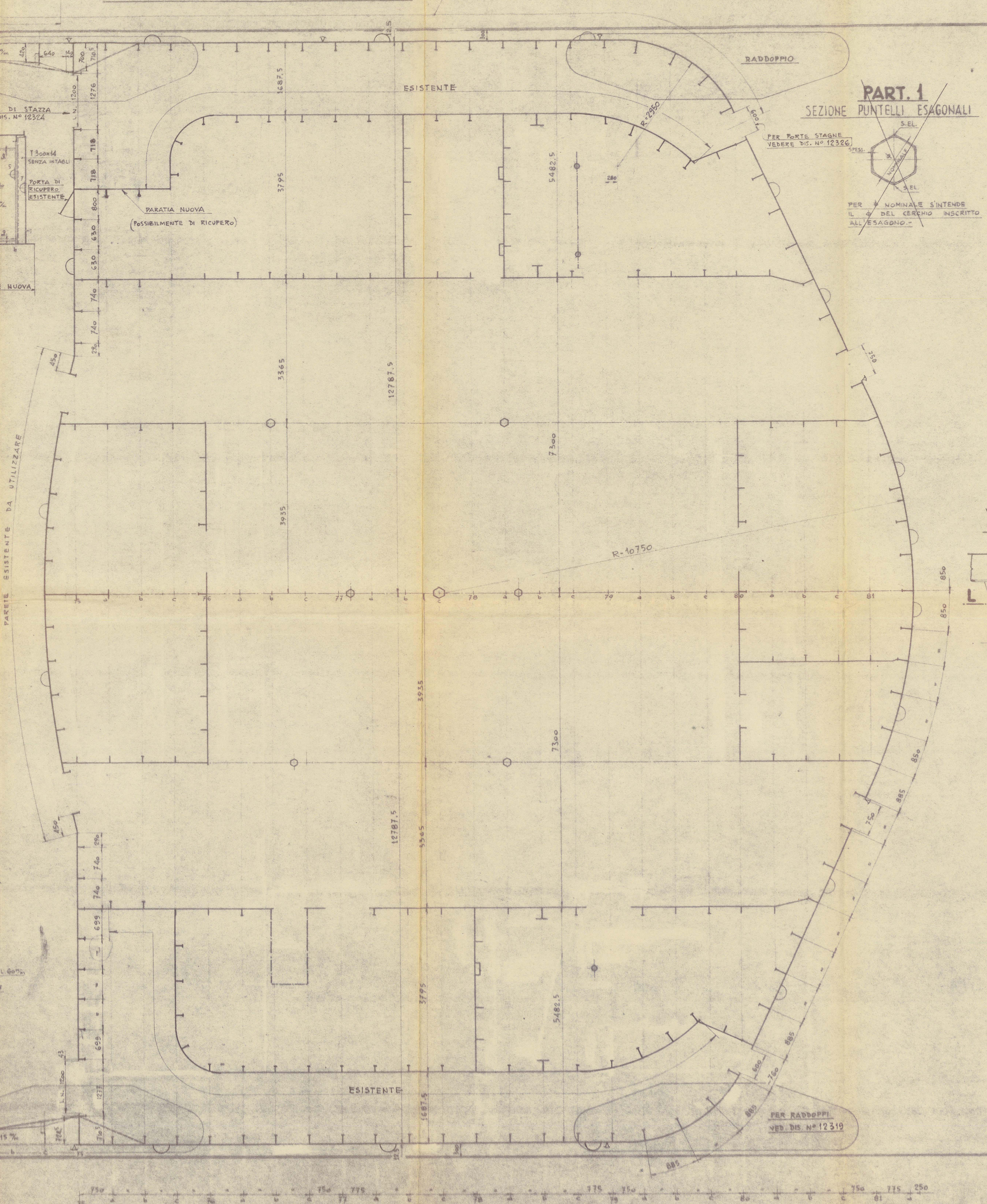

## SEZIONE 'Y-Y'

PARTIC. DELLA FALCETTA

SCALA 1:1.5

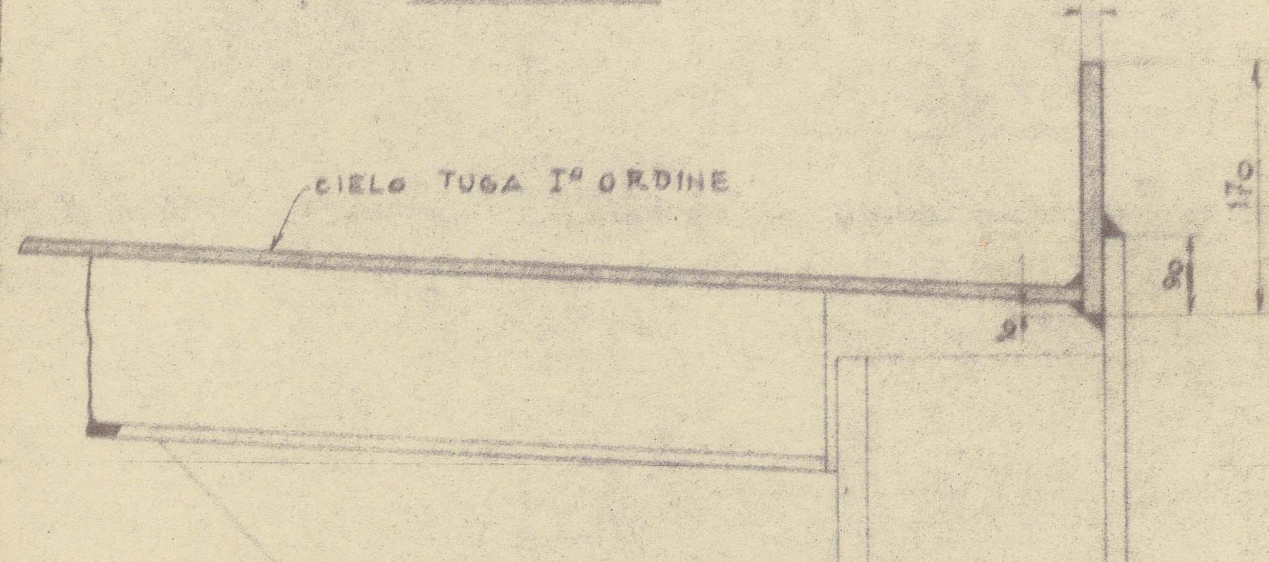

## PARTIC. UNIONE BAGLI

SEZIONE 'X-X'

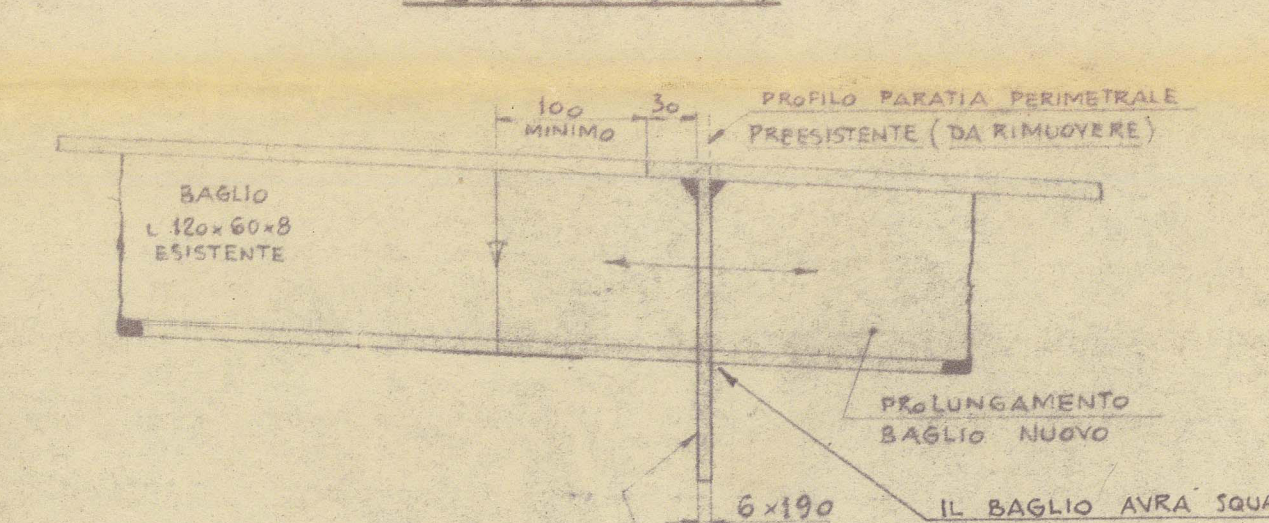

## PART. 2

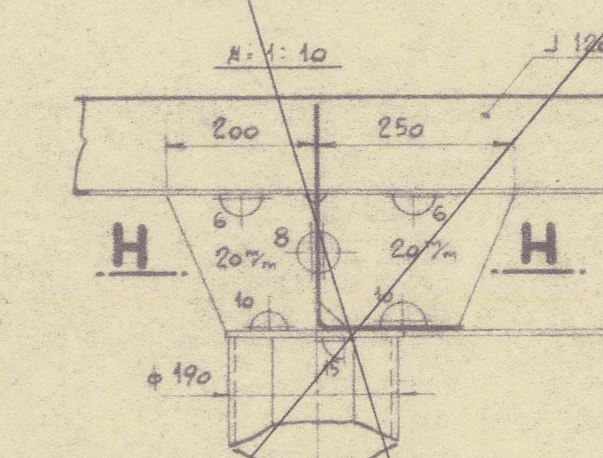

## SEZ. H-H

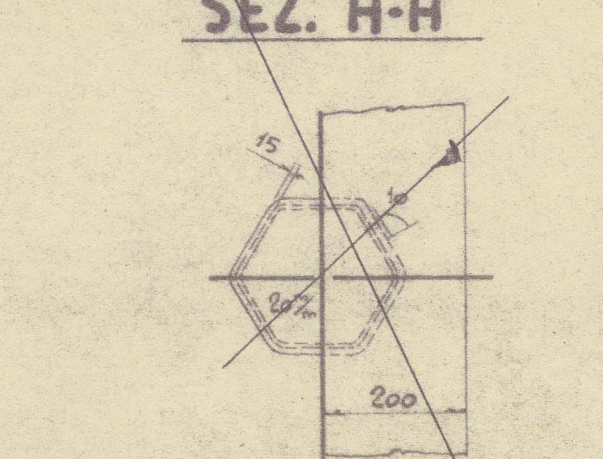

## PART. 4

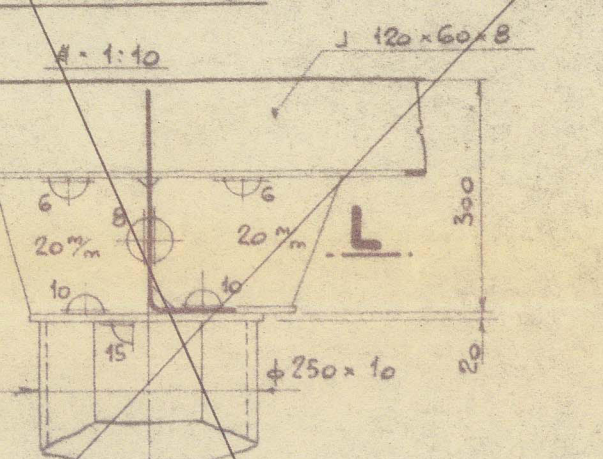

## SEZ. L-L

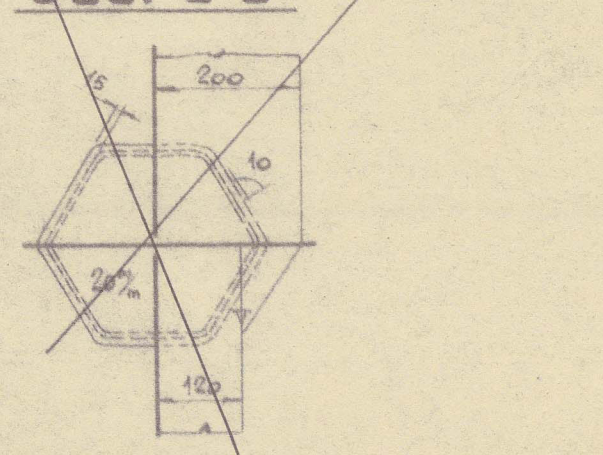

## PART. 3

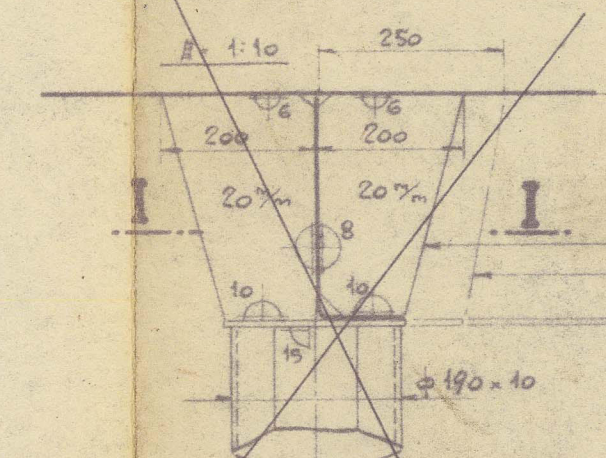

## SEZ. I-I

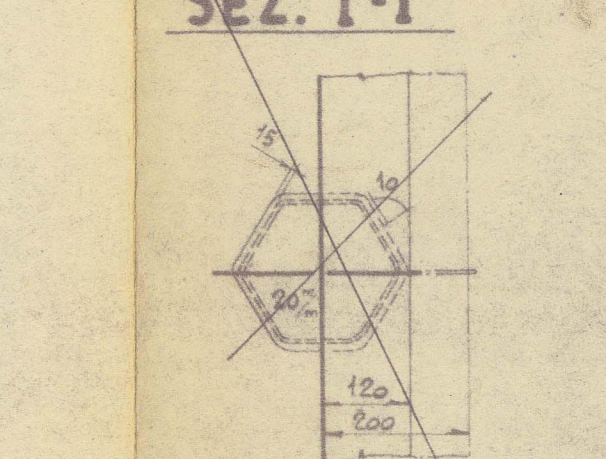

## PART. 5

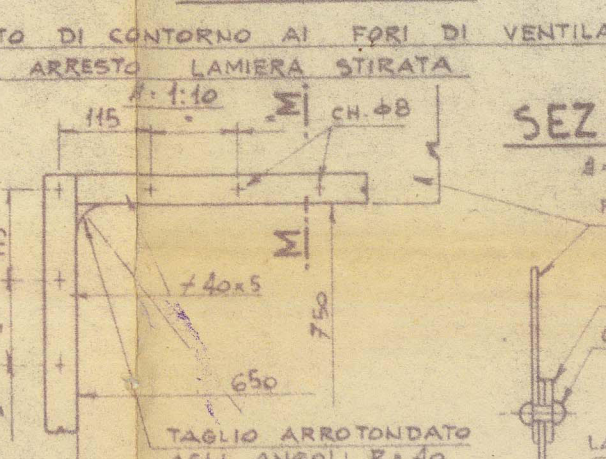

## SEZ. M-M

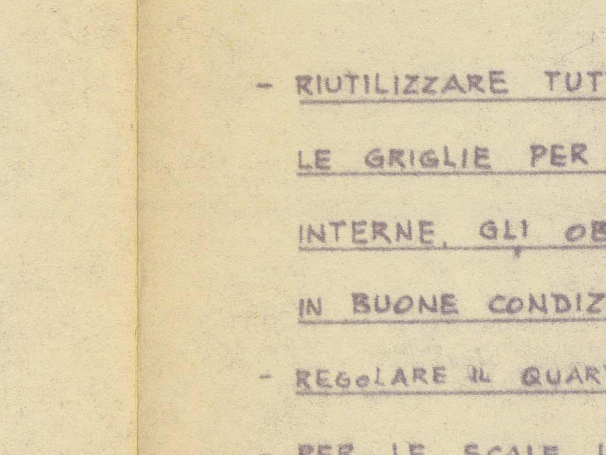

- RUTILIZZARE TUTTE LE PORTE ESTERNE ED INTERNE
- LE GRIGIE PER APERTURE INTERNE, LE SCALE ESTERNE ED INTERNE GLI ORLO, E TUTTI GLI ALTRI ACCESSORI DI ALLESTIMENTO IN BUONE CONDIZIONI
- REGOLARE IL QUARTABORDO PER LE PORTE NUOVE SU QUELLE ESISTENTI
- PER LE SCALE INTERNE VED. DIS. C.R.D.A. N° 442/2 - N° 62 D.R.N.
- PER PAVESATA VED. DIS. C.R.D.A. N° 146 - N° 25 D.R.N.
- PER RADDOPPI CASSERO VED. DIS. N° 12319
- COMPLETARE IL PONTE CASSERO PER LA PARTE TINTOGGIATA
- APPLICANDO LA FALCETTA DA 170 x 8 COME INDICATO NEL PARTIGIANE
- APPROVATO DAL LLOYD'S REGISTER IN DATA 3-9-57
- APPROVATO DALL'AMERICAN BUREAU IN DATA
- APPROVATO DAL R.I.N.A. IN DATA



SS/45 "more Adriaticum"
TO ACCOMPANY... Gen. .... Rpt. No 22976
Dated 21/1/58.
SUBJECT:- Alterations to bridge House

①

4 Drawings

013186-013191-0120



© 2021

Lloyd's Register  
Foundation