

22 SEP 1958

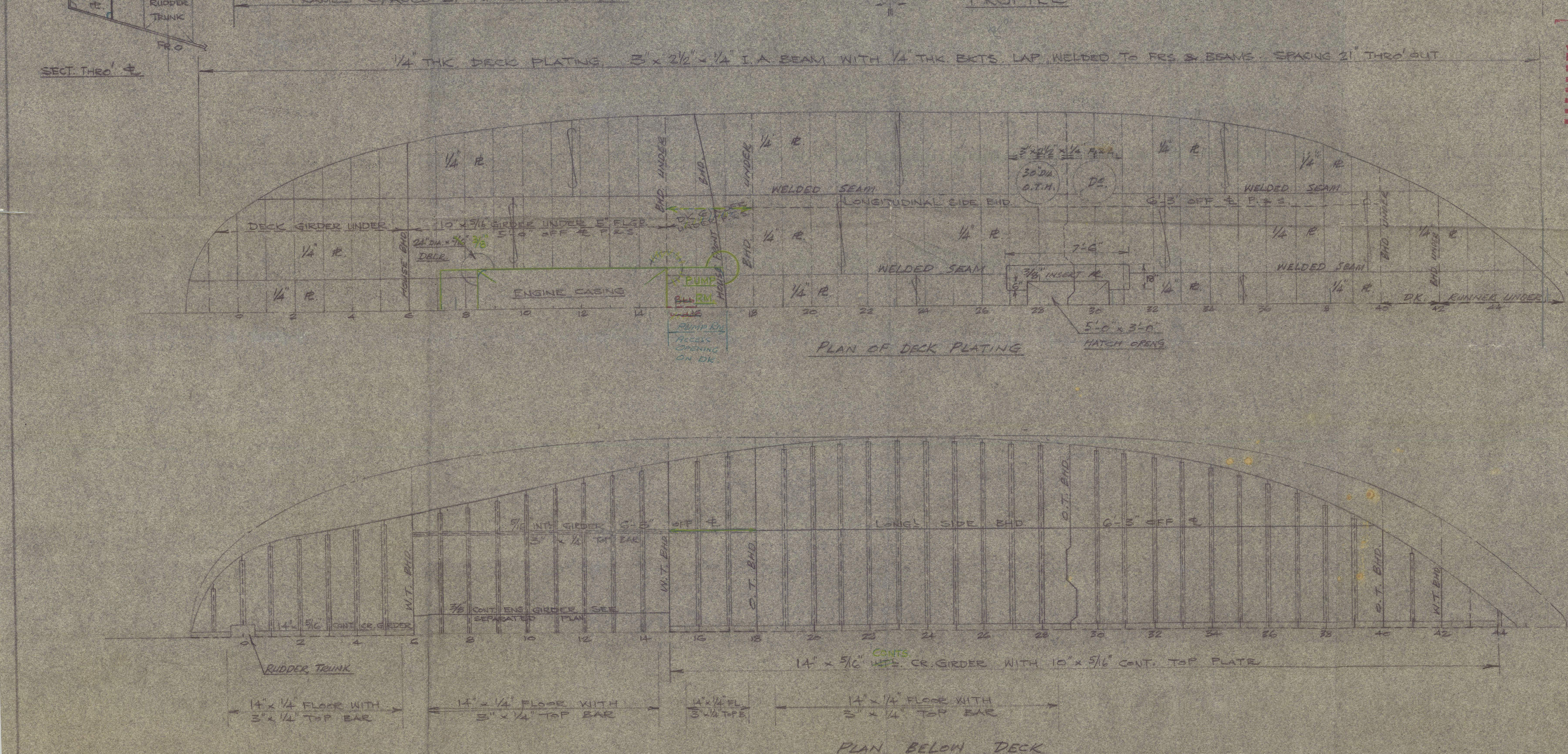

Any openings not shown on this approved plan which may be cut in the deck or shell plating are to be properly formed and adequate reinforcement provided to the structural satisfaction. The loss of structural area of longitudinal material is to be restored by doubling or increasing thickness of plating in way of and around such openings. Adequate compensation is also to be fitted for the cutting off of other strength members in the structure as may be necessary.

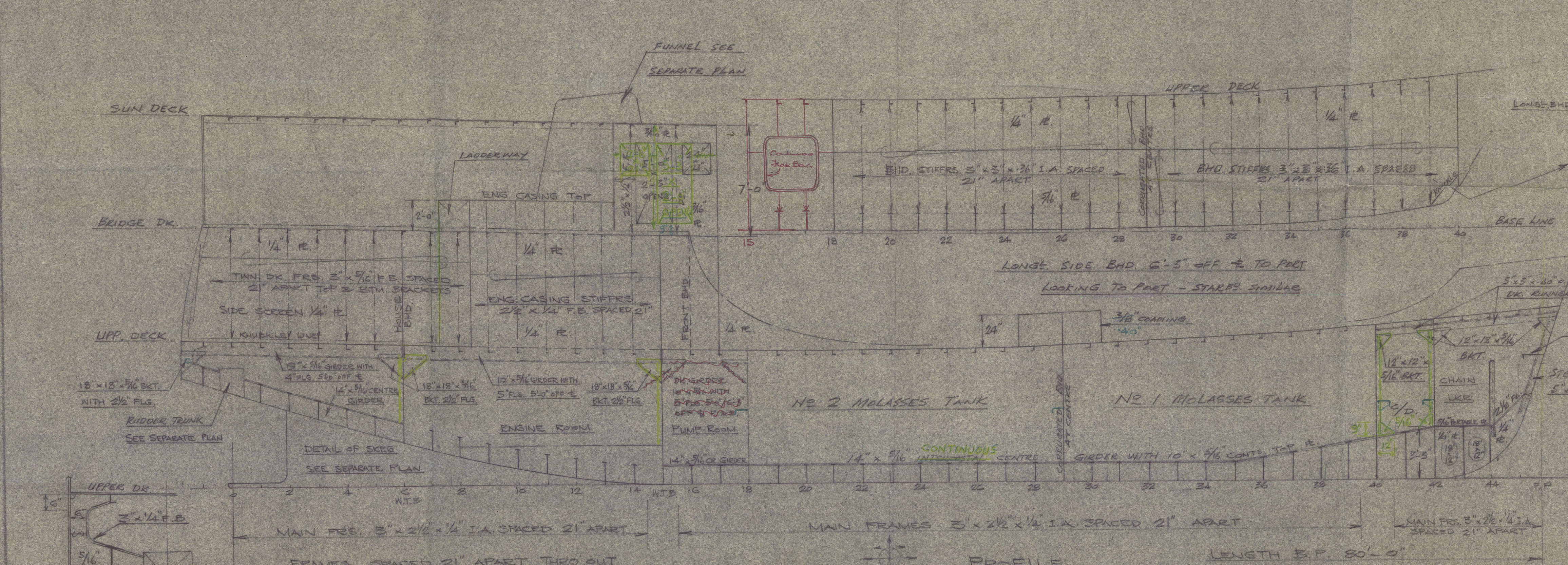
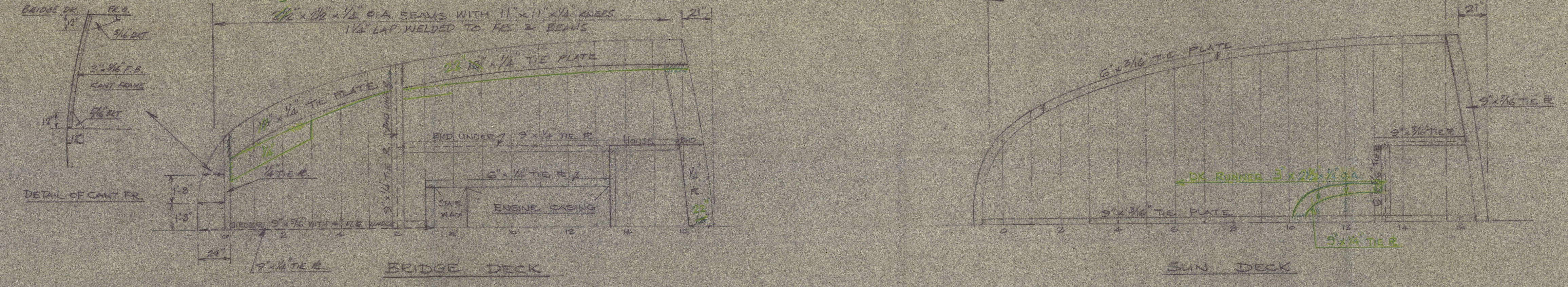
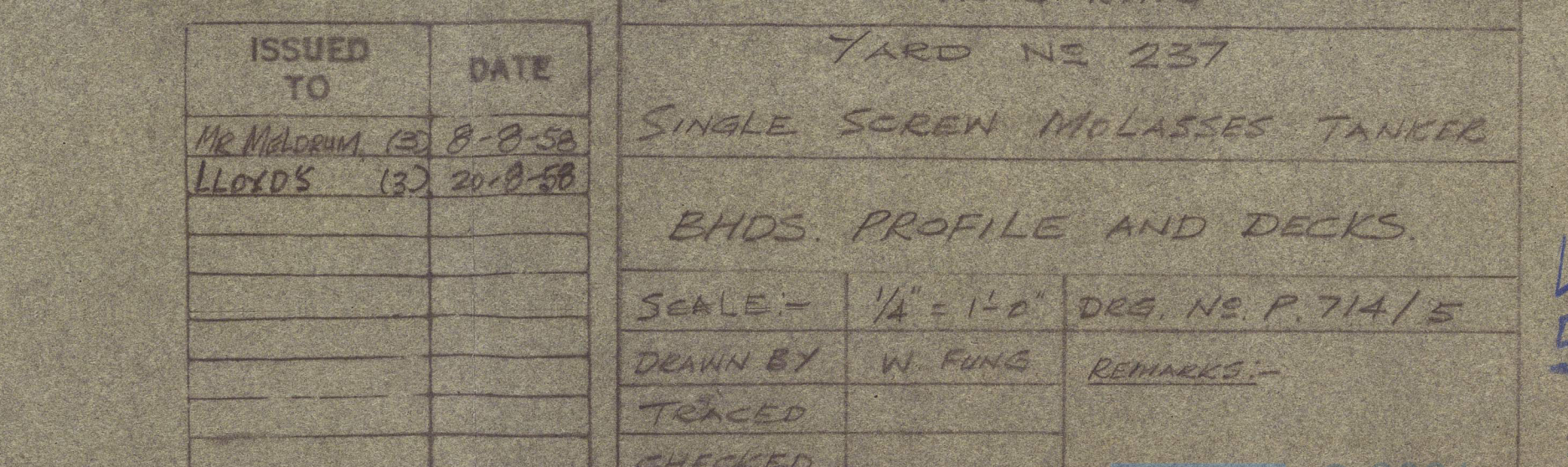
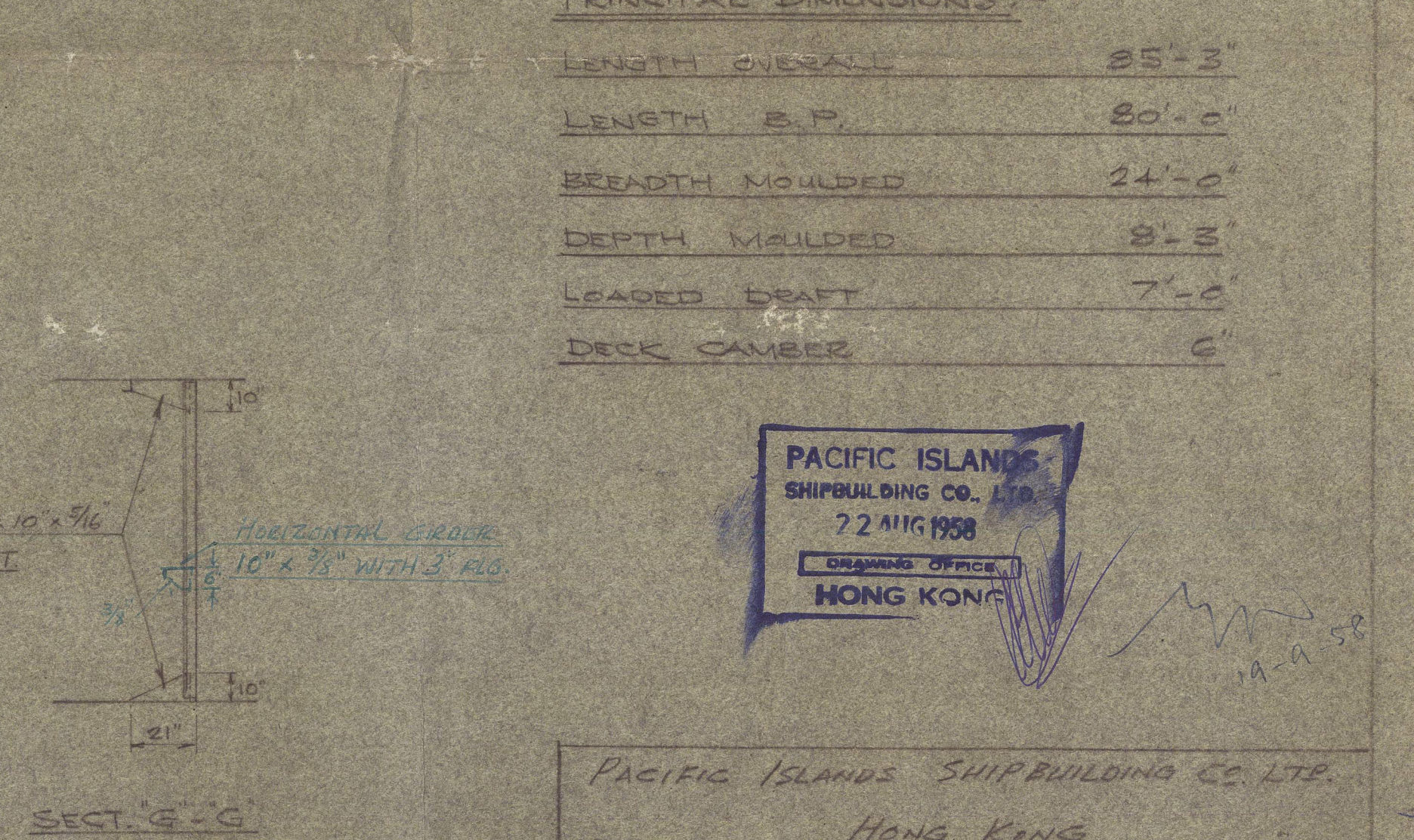
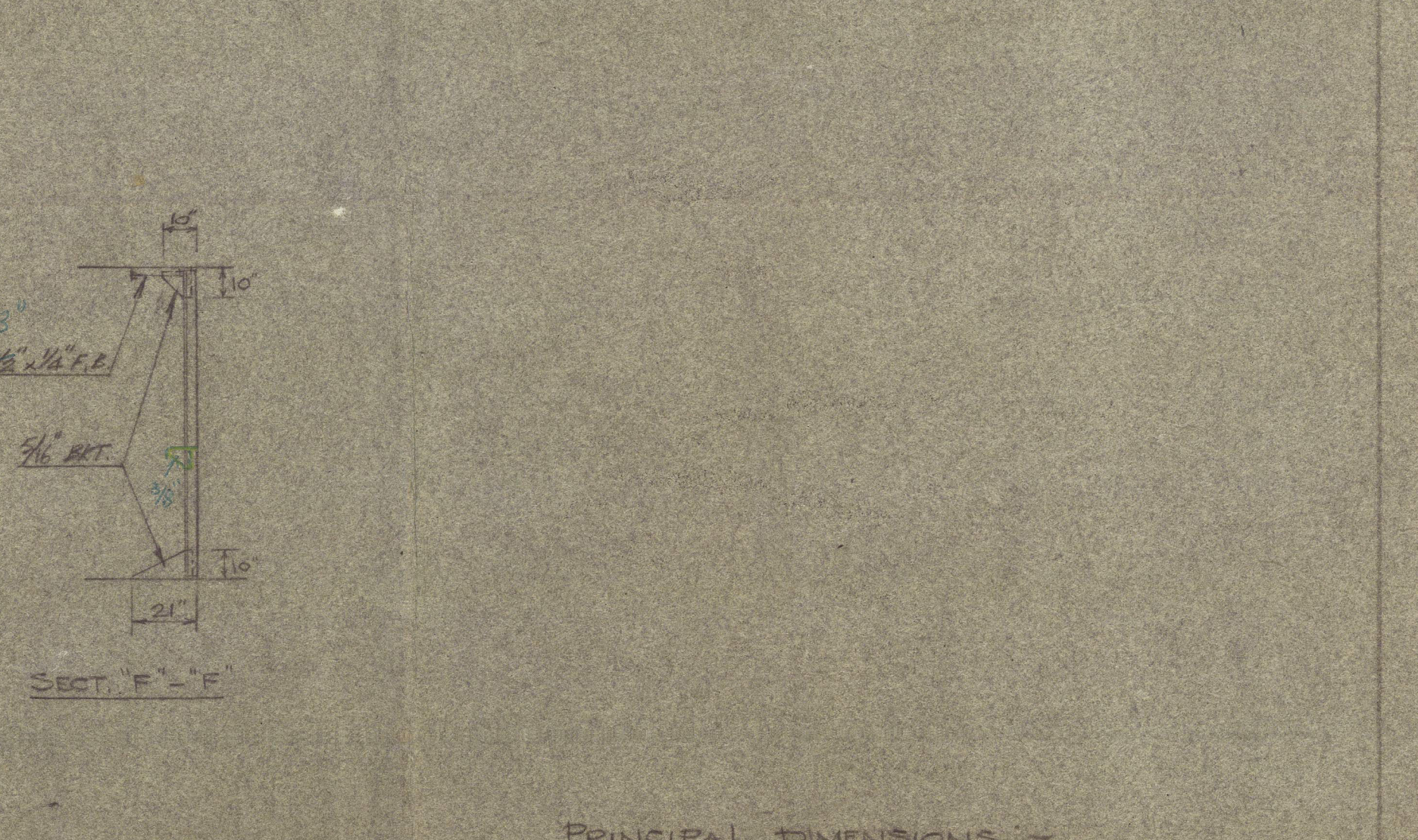
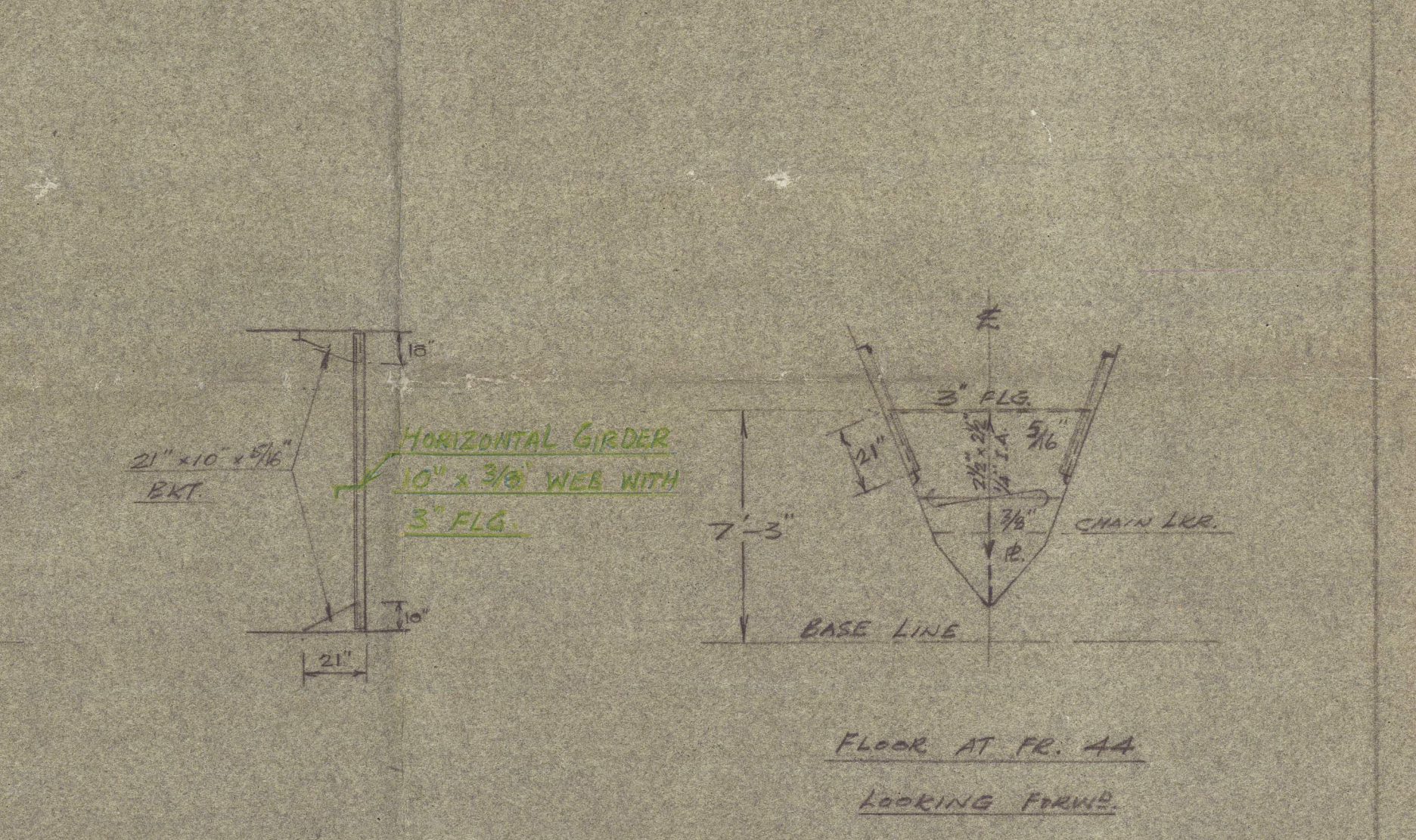
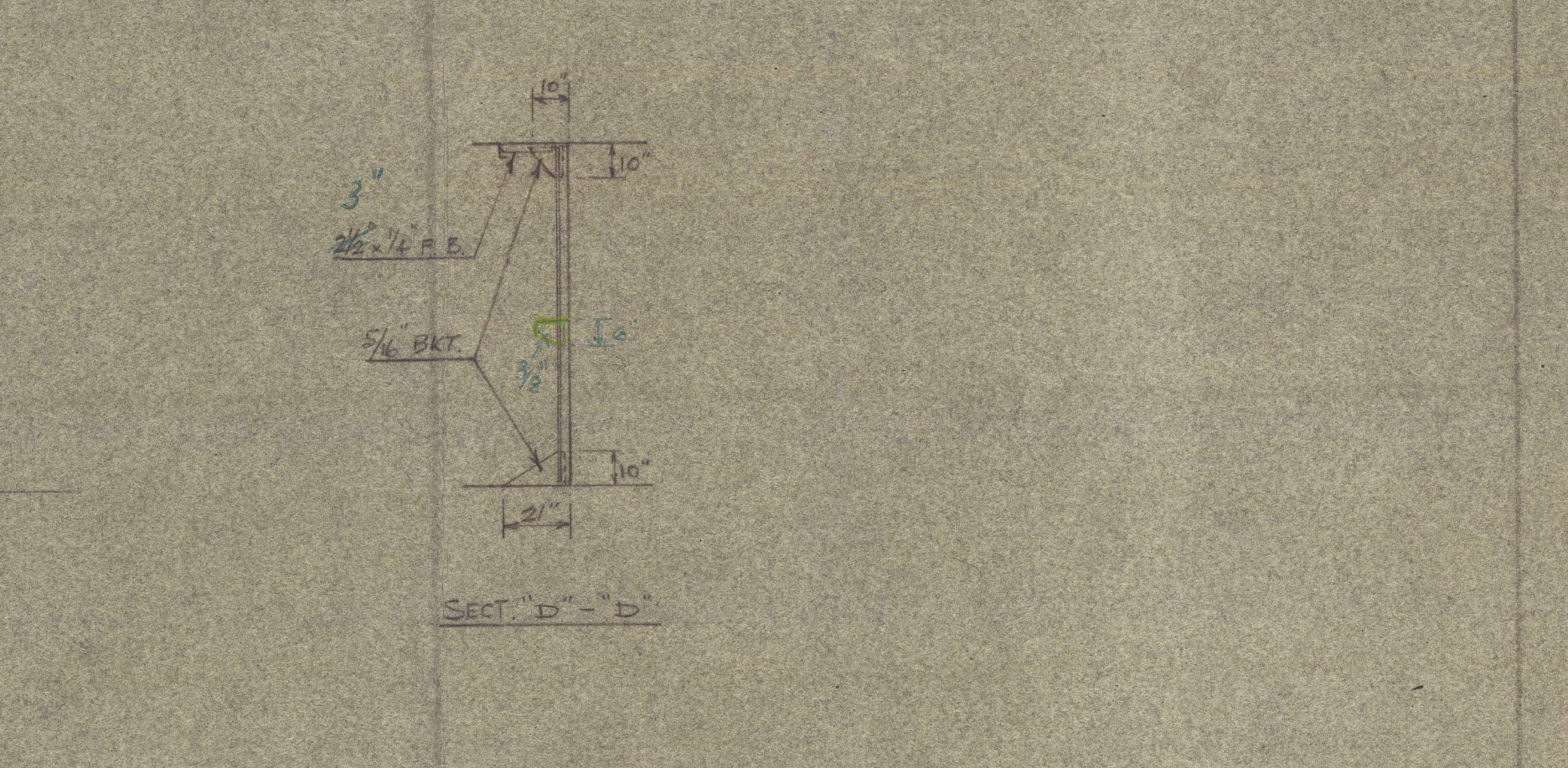
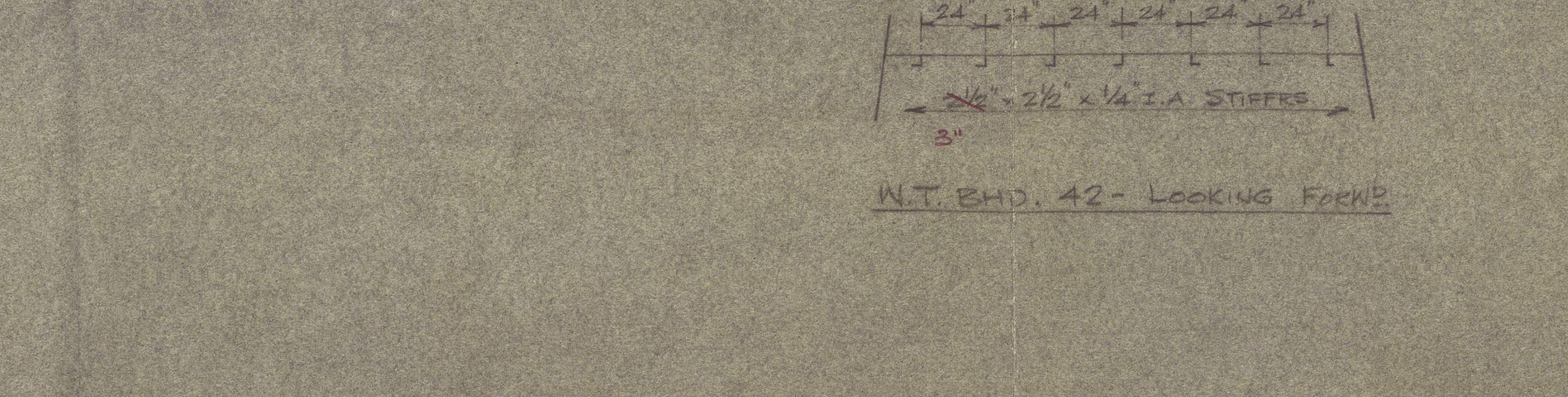
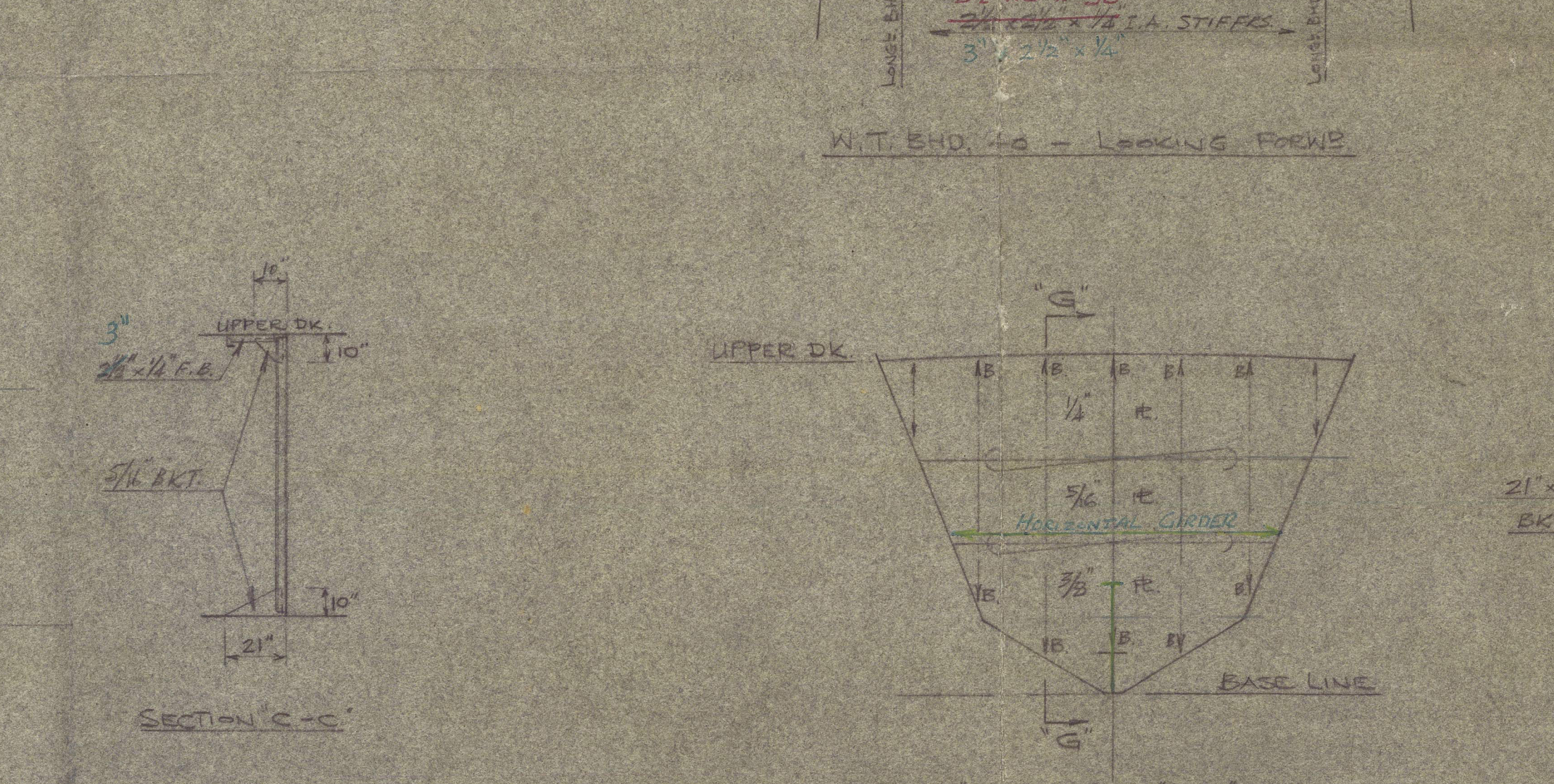
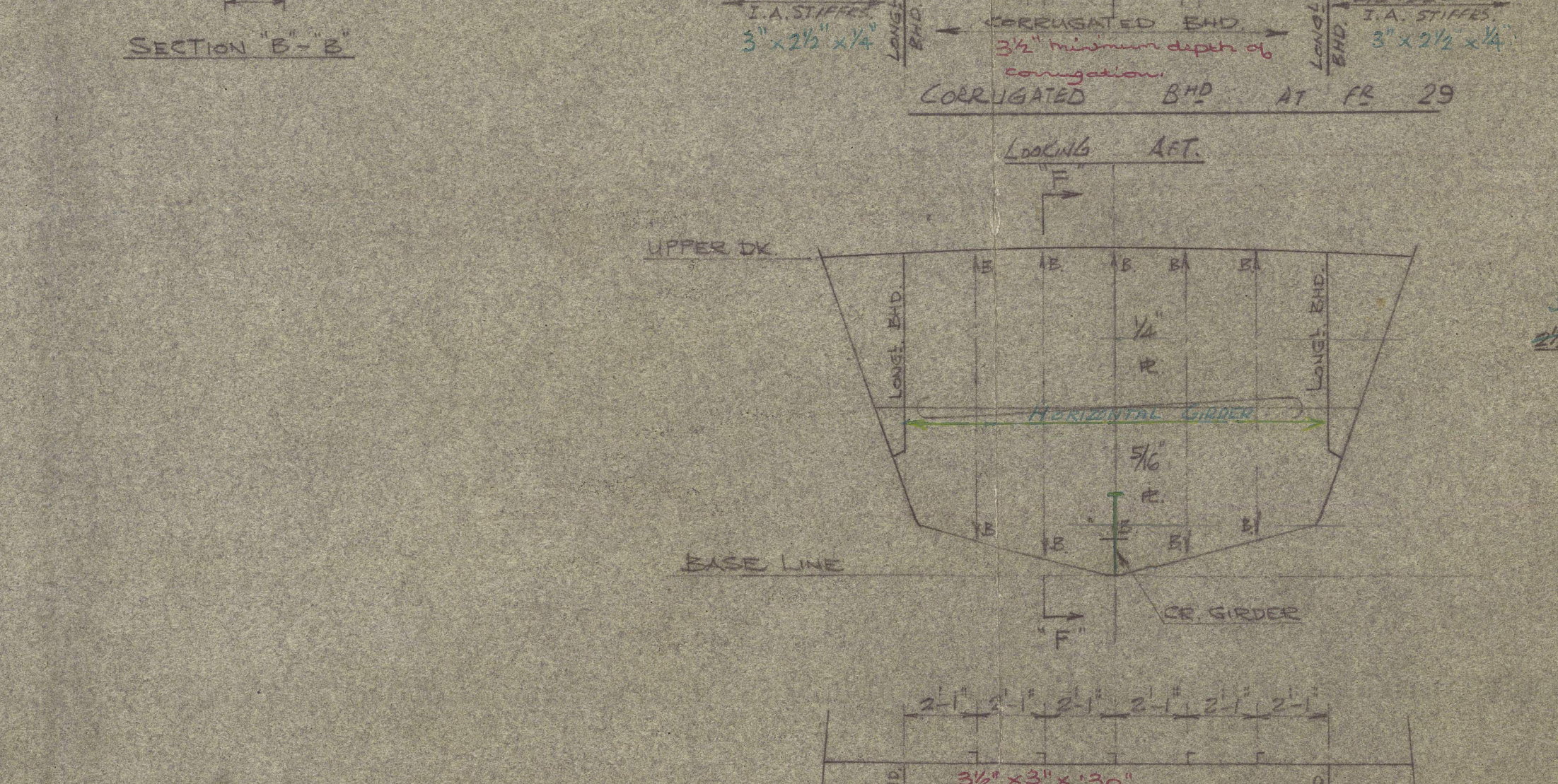
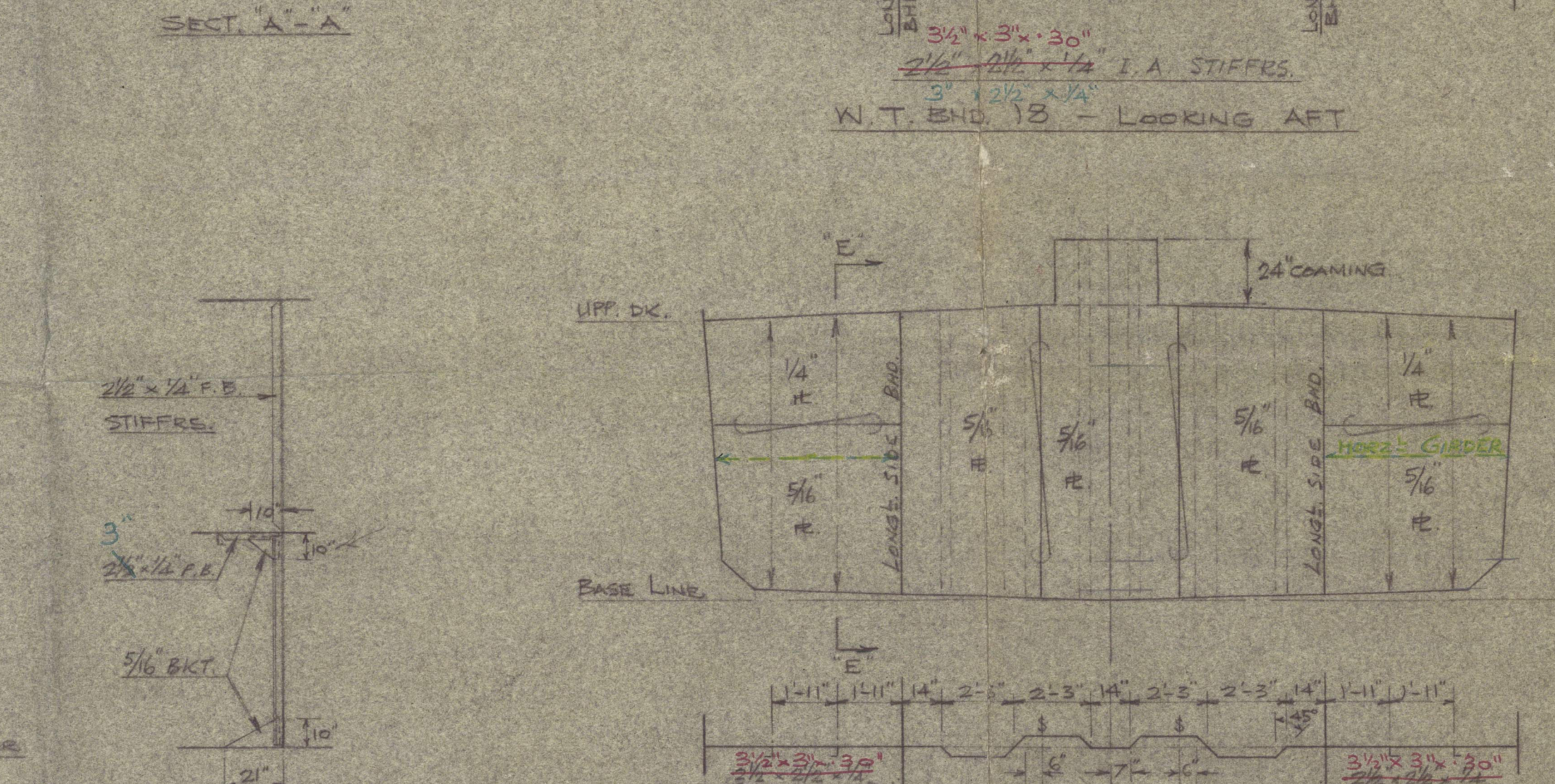
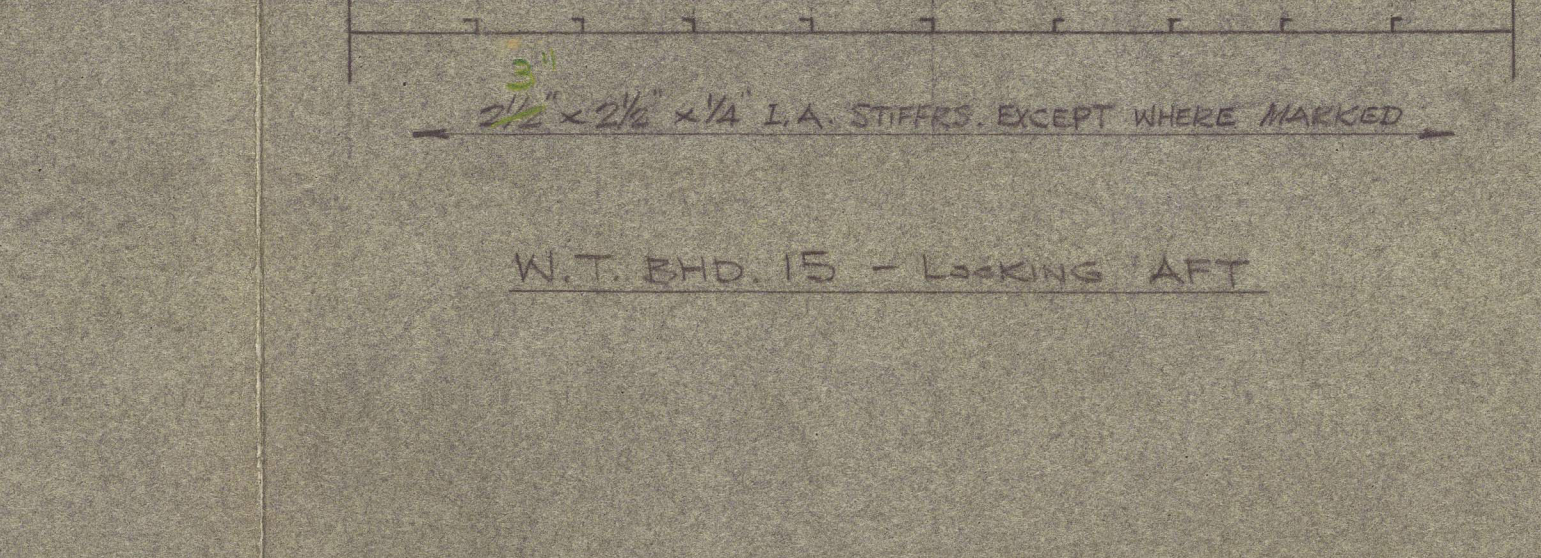
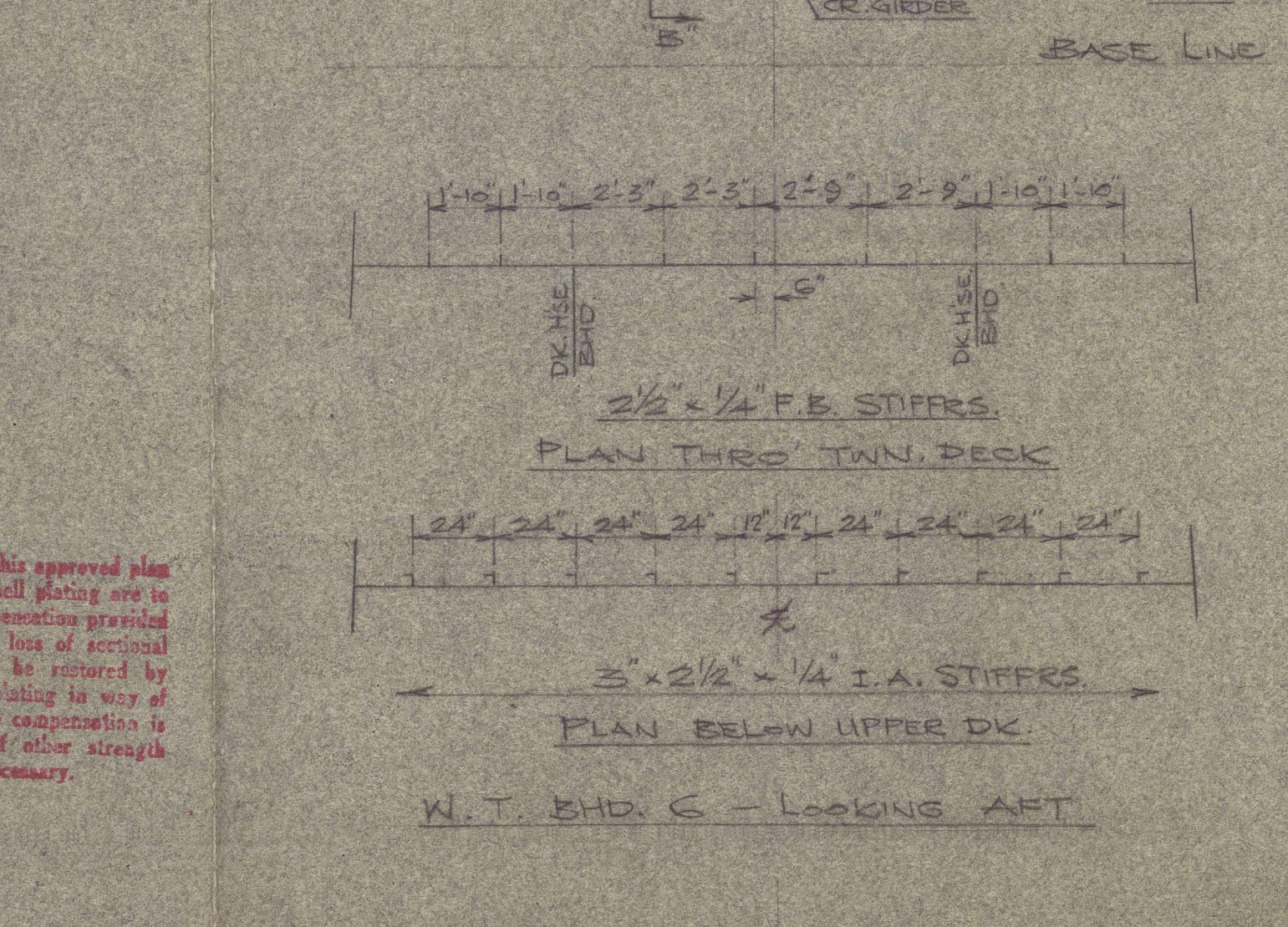
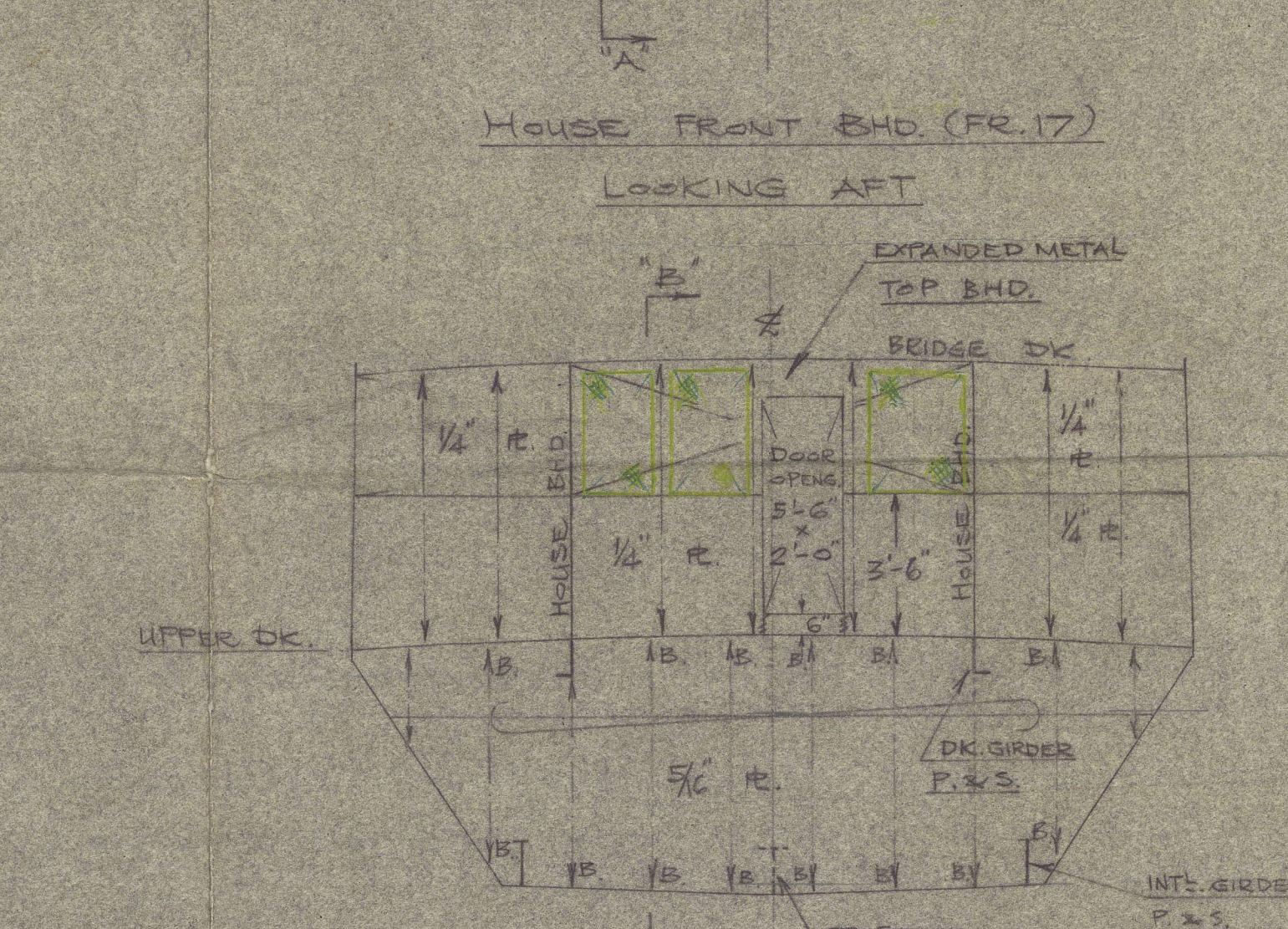
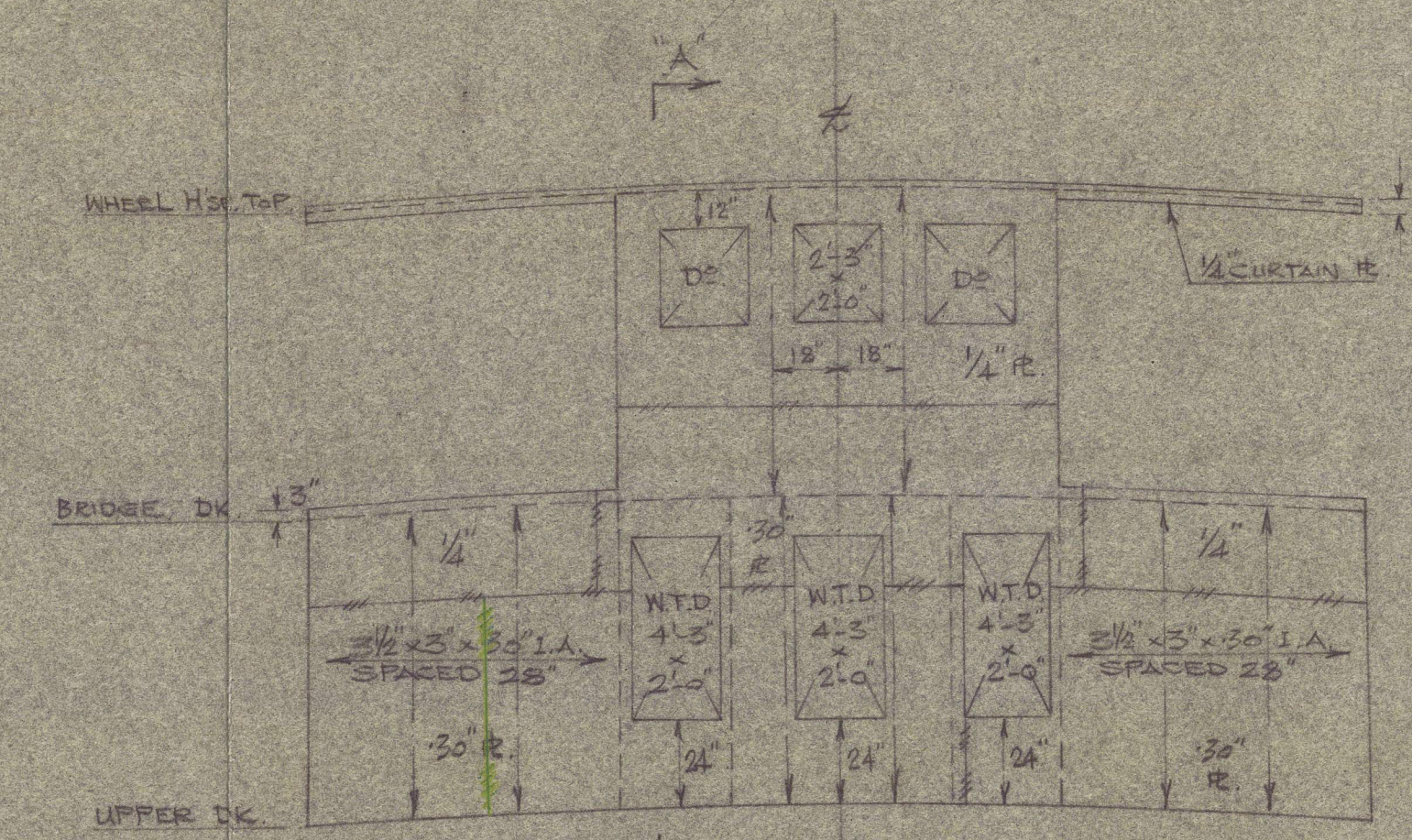

PRINCIPAL DIMENSIONS:-

LENGTH OVERALL	85'-3"
LENGTH B.P.	80'-0"
BREADTH MOULDED	24'-0"
DEPTH MOULDED	8'-3"
LEADED DECK	7'-0"
DECK CAMBER	6"

PACIFIC ISLANDS SHIPBUILDING CO. LTD.  
72 HONG KONG

PACIFIC ISLANDS SHIPBUILDING CO. LTD.  
HONG KONG

ISSUED TO	DATE
Mr. Macdonald, CB	8-8-58
LLOYDS	(32) 20-8-58
CHECKED	
DATE	5-8-58

YARD NO. 237  
SINGLE SCREEN MOLASSES TANKER  
BHDS. PROFILE AND DECKS  
SCALE - 1/4" = 1'-0"  
DRAWN BY W. KONG  
REMARKS -  
DES. NO. P. 714/E



M.S. "FIONETTA" ★

PACIFIC ISLANDS S.B.CO. LTD.

YARD No. 237.

HONG KONG REPORT No. 14664

BULKHEADS, PROFILE AND DECKS

RECORDS DEPT.  
LONDON.



© 2021

Lloyd's Register  
Foundation

012948-012953-0116