

LLOYD'S REGISTER OF SHIPPING

SURVEYS FOR FREEBOARD

(CONDITIONS OF ASSIGNMENT)

Ship's Name "YESILIRMAK 3" Port of Survey ROTTERDAM
Official Number -- Surveyor's Signature *Amelkhan*
Nationality and Port of Registry Turkey, Istanbul Date of Survey during building

Disposition a

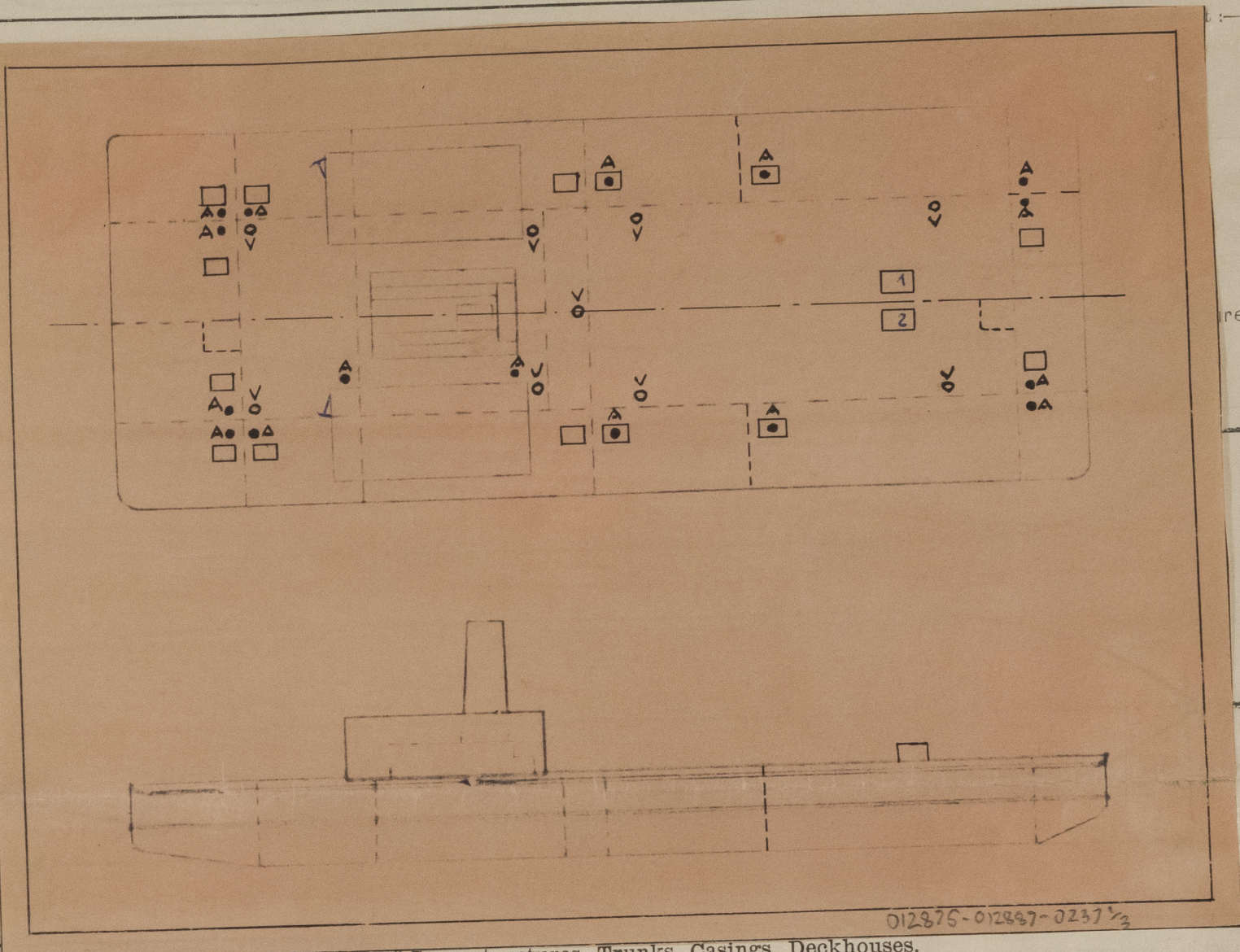

012876-012887-0237 1/2

Particulars of Superstructures, Trunks, Casings, Deckhouses.

| | Coaming | Plating | Stiffeners | Spacing | End Attachments of Stiffeners | Size of Openings | Height of Sills | Height, Beam to Beam |
|---|---------|---------|-------------|---------|-------------------------------|------------------|-----------------|----------------------|
| Poop Bulkhead | | | | | | | | |
| Raised Quarter Deck Bulkhead ... | | | | | | | | |
| Bridge, After Bulkhead | | | | | | | | |
| Bridge, Forward Bulkhead | | | | | | | | |
| Forecastle Bulkhead | | | | | | | | |
| Trunk, Aft | | | | | | | | |
| Trunk, Forward | | | | | | | | |
| Exposed Machinery Casings on Free-board or Raised Quarter Decks ... | | | | | top- welded | | | |
| Exposed Machinery Casings on Super-structure Decks | front | 6 | 50 x 40 x 5 | 630 | heel - unatt. | - | - | 2200 |
| Machinery Casings within Superstruc-tures not fitted with Class I Closing Appliances | sides | 6 | 50 x 40 x 5 | 650 | top - bracket | | | |
| | | | | | heel - welded | - | - | 2200 |
| | | | | | top - welded | | | |
| 2 Deckhouses and Pump Room Entrances 1 port & 1 starboard | aft | 6 | 50 x 40 x 5 | 630 | heel - unatt. | 1250x600 | 610 | 2200 |

Particulars of Closing Appliances (state if capable of being manipulated from both sides).

| | |
|---|--|
| Poop Bulkhead | |
| Raised Quarter Deck Bulkhead ... | |
| Bridge, After Bulkhead | |
| Bridge, Forward Bulkhead | |
| Forecastle Bulkhead | |
| Exposed Machinery Casings on Free-board or Raised Quarter Decks ... | |
| Exposed Machinery Casings on Super-structure Decks | |
| Machinery Casings within Superstruc-tures not fitted with Class I Closing Appliances | |
| Each Deckhouses and Pump Room Entrances | Hinged steel weathertight door, O.B.S. |

PARTICULARS OF PROTECTION TO OPENINGS, ETC.

The following diagrams should be used to indicate the positions of cargo and coaling hatchways, gangway, cargo and coaling ports, side scuttles, scuppers, ventilators, companionways, etc., which would affect the seaworthiness of the ship :—

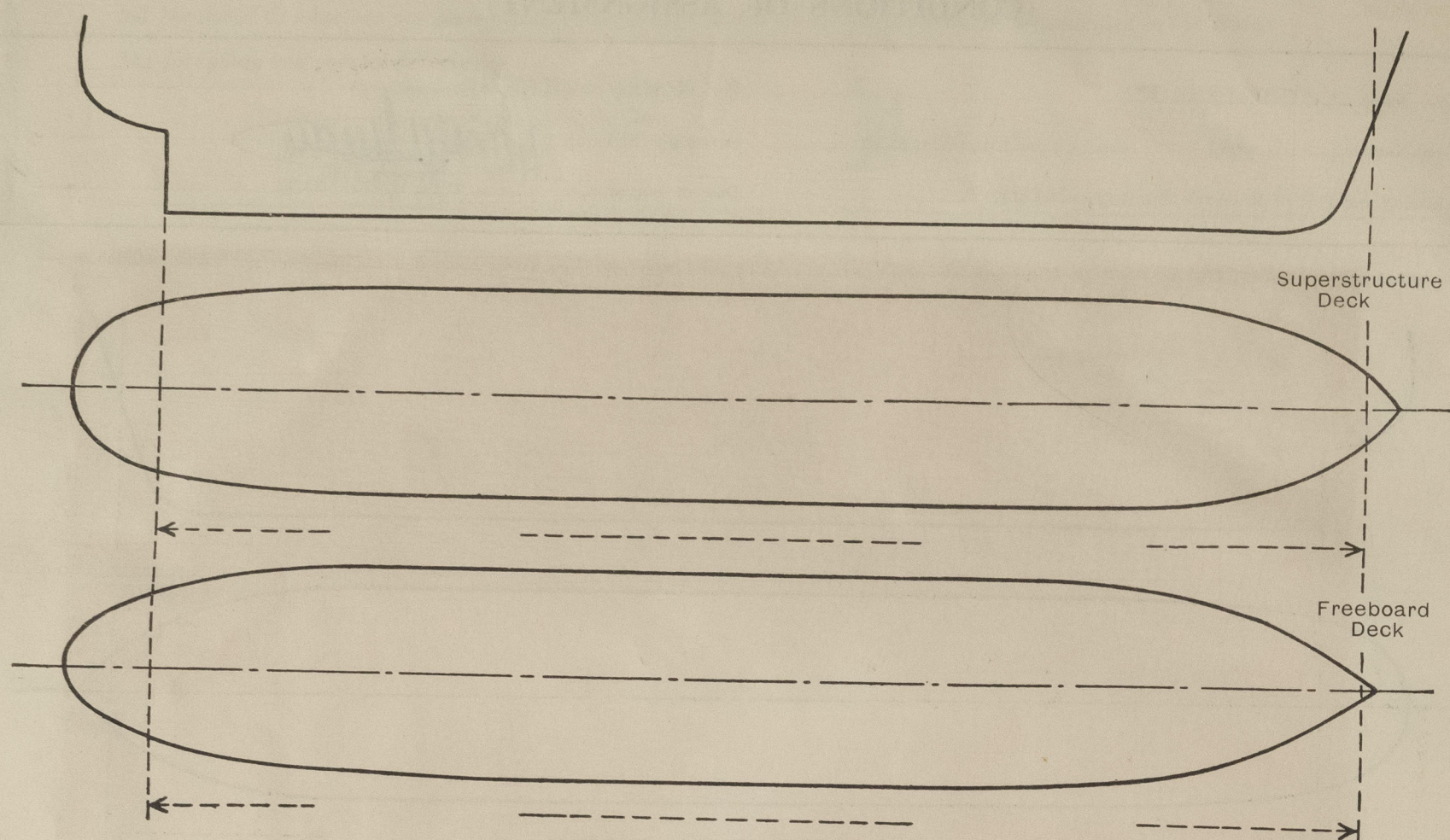

Particulars of fiddle, funnel and ventilator coamings, engine room skylight and other openings in machinery casing tops and their means of closing :—

No fiddle, strong steel funnel of substantial construction on skylight, skylight 6 mm., provided with 8 hinged flaps of 5 mm. steel without bulleyes, operable from outside only.

Particulars of Flush Bunker Scuttles :— None

Particulars of Companionways :— (see under deckhouse page 1)
(including those incorporated in deckhouses and masthouses)

Particulars of Ventilators in exposed positions on freeboard and superstructure decks :—

| No | Position | Diam. | Height | Thickness | Compartment | Types and means of closing |
|----|----------------|--------|--------|-----------|---------------|---|
| 6 | weatherdeck | 6.1/2" | 610 ✓ | 7 | storerooms | screwdown mushroom covers |
| 2 | weatherdeck | 300 | 520 ✓ | 8.1/2 | boilerroom | airducts wooden plugs canvas covers. |
| 4 | p.s. deckhouse | 6.1/2 | 310 ✓ | 7 | accommodation | screwdown mushrooms canvas covers |
| 1 | p.s. deckhouse | 3" | 500 ✓ | 4 | galley | pipe ventilator wood plugs & canvas cover |
| 4 | s.s. deckhouse | 4" | 230 ✓ | 6 | accommodation | screwdown mushroom canvas covers |

Particulars of Air Pipes in exposed positions on freeboard, raised quarter, or superstructure decks :—

| No | Position | Diam. | Height | Thickness | Compartment | Type - closing |
|----|-------------|--------|--------|-----------|--|----------------------------------|
| 5 | weatherdeck | 8" | 610 ✓ | 7 | ballast tanks, feedw. t.fuel oil bunker(gauge) | Sc.D.steel cap with canvas cover |
| 8 | weatherdeck | 2.1/2" | 610 ✓ | 3,65 | drytanks | gooseneck wooden cover |
| 1 | weatherdeck | 2" | 610 ✓ | 3,65 | daily fuel oil tank | patent gas cap cover |
| 1 | weatherdeck | 2" | 610 ✓ | 3,65 | daily feedw.tank | steel cap canvas |

Particulars of Gangway Cargo and Coaling Ports :— None

Particulars of Scuppers and Sanitary Discharge Pipes :—

One sanitary discharge pipe ϕ 4" leading from p.s. deckhouse to bottom with S.D.N.R. valve, operable inside side tank.

One sanitary discharge pipe ϕ 2" leading from s.s. deckhouse to shell with S.D.N.R. valve, operable inside side tank.

Particulars of Side Scuttles and Deadlights :—

No side scuttles.

In each deckhouse 6 bronze framed 10" side scuttles with portable steel covers 5 mm., and 2 deadlights 8" bronze framed.

Vertical distance of Sill of lowest Side Scuttle above top of keel None
Distance from amidships to centre of lowest Side Scuttle None

Particulars of Guard Rails and Bulwarks :— None

Particulars of Gangways, Lifelines, etc. :— None

Particulars of Freeing Arrangements.

| | Length of Bulwark | Height of Bulwark | Size of Freeing Ports | Number each side | Area each side | Rule area each side |
|------------------|-------------------|-------------------|-----------------------|------------------|----------------|---------------------|
| After Well ... | None | | | | | |
| Forward Well ... | None | | | | | |

State position of each freeing port ... After Well :—

(F. and A. position and height above deck edge) Forward Well :—

None

State whether the freeing ports are fitted with shutters, bars, or rails, and give particulars of such :—

Additional area where sheer is less than standard. No sheer.

PARTICULARS OF PROTECTION TO OPENINGS, ETC.

| HATCHWAYS ON FREEBOARD AND SUPERSTRUCTURE DECKS. | | | | | | | | | |
|---|-----|-----------------------|---------|-----------|-----------------------------------|--|--|--|--|
| Description of Hatchway | ... | ... | ... | 1 and 2 | | | | | |
| Dimensions of Hatchway | ... | ... | ... | 1435x1020 | | | | | |
| COAMINGS | { | Height above Deck | ... | 610 | | | | | |
| | | Thickness | { Sides | ... | 8 | | | | |
| | | | { Ends | ... | | | | | |
| | | Stiffeners | { Sides | ... | 100x75x8 | | | | |
| | | Brackets, Stays | { Ends | ... | | | | | |
| HATCH BEAMS | { | Number | ... | ... | | | | | |
| | | Spacing | ... | ... | | | | | |
| | | Scantling and Sketch | ... | | | | | | |
| | | Bearing Surface | ... | | | | | | |
| FORE AND AFTERS | { | Number | ... | ... | | | | | |
| | | Spacing | ... | ... | | | | | |
| | | Unsupported Lengths | ... | | | | | | |
| | | Scantling* and Sketch | ... | | | | | | |
| | | Bearing Surface | ... | | | | | | |
| HATCH COVERS | { | Material | ... | ... | steel stiff. 50x6 | | | | |
| | | Thickness | ... | ... | 6.1/2 | | | | |
| | | How fitted | ... | ... | 6 steel 3/4" toggles W.T. packing | | | | |
| | | Bearing Surface | ... | ... | | | | | |
| Spacing of Cleats | ... | ... | ... | | | | | | |
| Number of Tarpaulins | ... | ... | ... | | | | | | |
| <p>*Are wood fore and afters steel shod at all bearing surfaces?</p> <p>Are battens and wedges efficient and in good condition?</p> <p>Are tarpaulins in good condition and in accordance with rule requirements?</p> <p>Are lashings provided in accordance with rule requirements?</p> <p>Are wood covers fitted with galvanised end bands?</p> | | | | | | | | | |

Particulars of any special features:— (Timber Deck-cargo Fittings, Skylights, Sewage Systems, Ash Ejectors, Rubbish Shoots, etc.)

A total number of 14 manhole covers ^{one} fitted on each dry (buoyancy) tank; angle frame of 65x65x8 welded on deck with 3/4" steel cover W.T. jointing between, secured by 5/8" bolts at W.T. spacing.

One semi rotary handpump fitted for drainage of each chainlocker 2" galv. steel pipeline leading to weatherdeck.



© 2021

Lloyd's Register
Foundation